

Existing

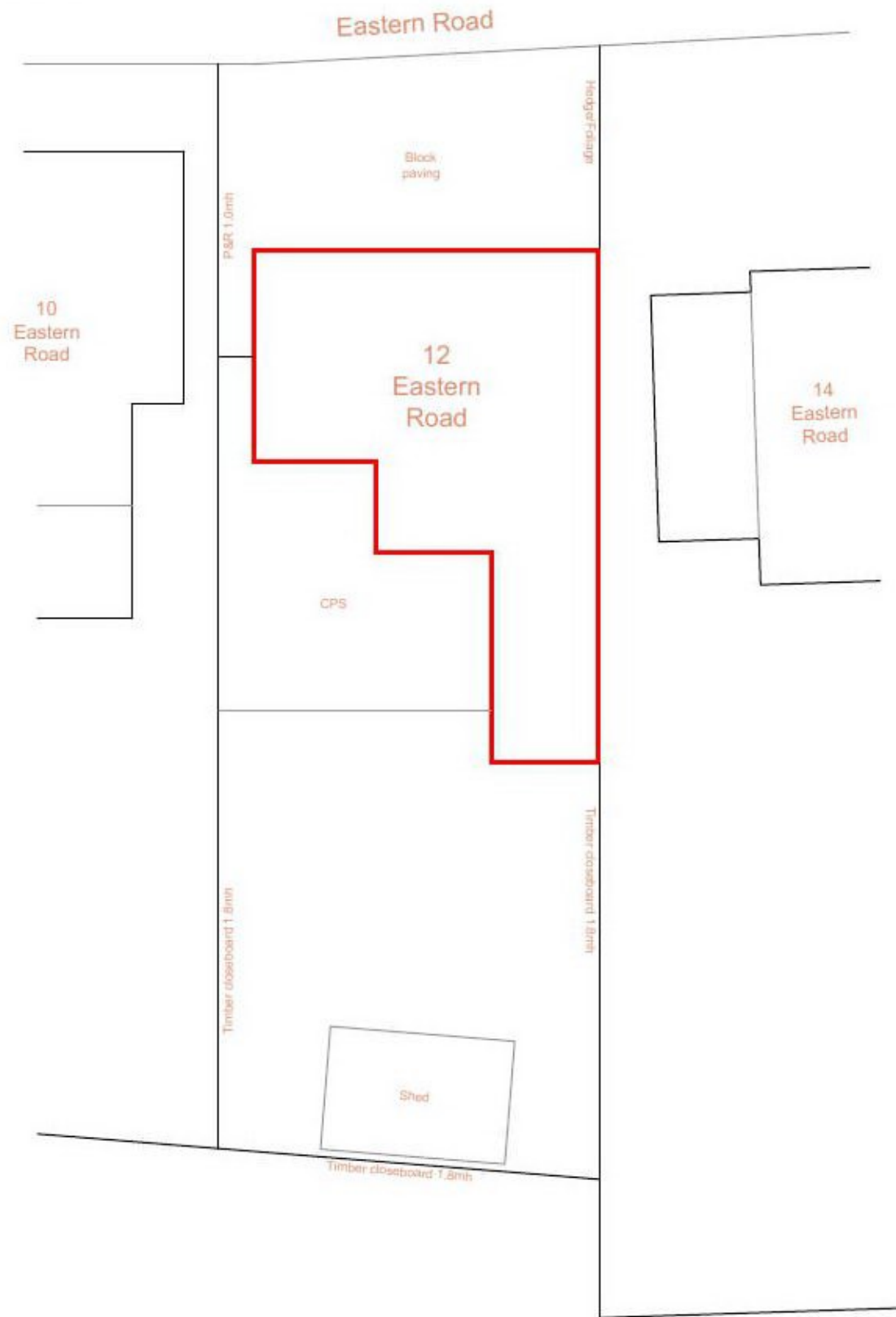

Proposed

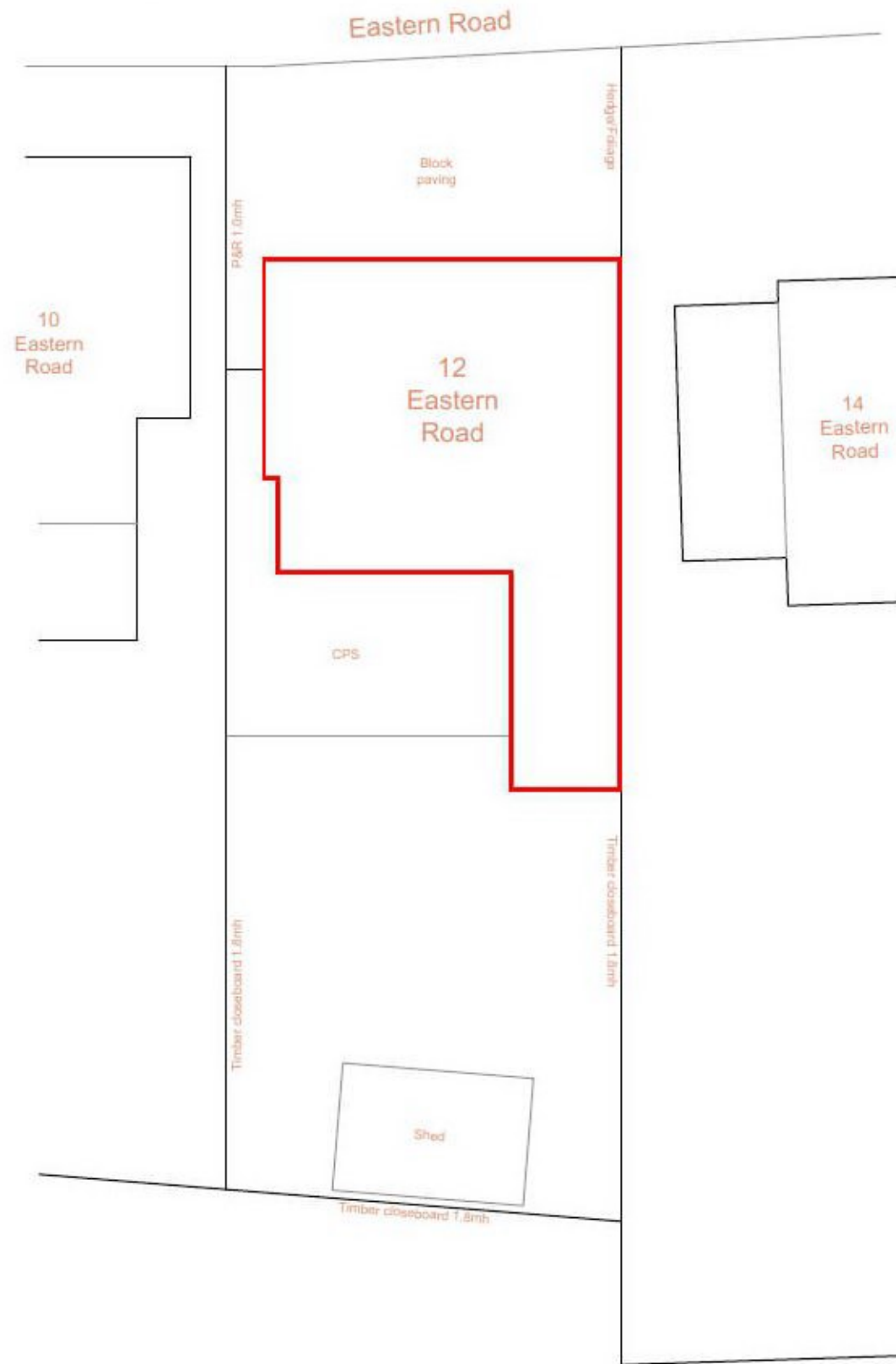

Please note:
 This drawing is to be used as a aid to achieve planning / building regs approval and as a guide for the proposed works . Dimensions, levels and existing construction materials are to be checked on site prior to construction of proposed works. Therefore, design can be subject to amendment.
 All structural work to be overseen by a structural engineer.

Important note: All measurements to be checked on site before any construction takes place. Do not scale from this drawing.

AGC Consultants 14 Seafeld Ave. Mistley Essex CO11 1UE	
Client	David & Lesley Taylor
Project title	Rear extension at: 12 Eastern Road, Brightlingsea CO7 0HU
Drawing title	Site plans
Scale	1:200@A3
Date	21/07/21
Dwg No	0344/PL/05
Rev No	