

**EXISTING SITE LAYOUT**

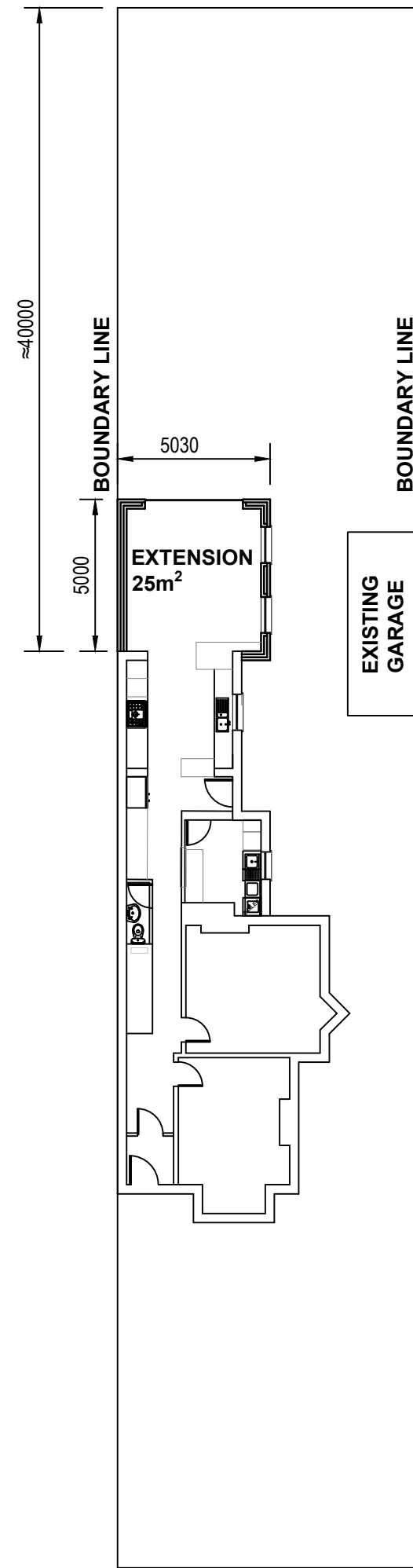

**PROPOSED SITE LAYOUT**

- GENERALLY:
1. ALL WORKS TO COMPLY WITH CURRENT BUILDING REGULATIONS & ANY RELEVANT BRITISH STANDARDS OR CODES OF PRACTICES, TO COMPLETE SATISFACTION OF THE BUILDING CONTROL OFFICER.
  2. ALL DIMENSIONS TO BE CHECKED ON SITE BY ALL CONTRACTORS BEFORE MANUFACTURING OR ORDERING OR WORK IS PUT IN HAND -IF IN DOUBT, ASK.
  3. PROVIDE FOR ANY & ALL PROTECTION, NEEDLING, STRUTTING, PROPPING, SHORING, SUPPORTING ADJACENT WORK, ETC., AND ANCILLARY WORKS ASSOCIATED WITH OPERATIONS EXECUTED IN THE NORMAL COURSE OF EVENTS & GOOD BUILDING PRACTICE. IT IS THE RESPONSIBILITY OF THE CONTRACTOR TO ENSURE THAT WORK IS CARRIED OUT IN A SAFE AND SATISFACTORY MANNER IN ACCORDANCE WITH THE HEALTH AND SAFETY AT WORK ACT, COSHH REGULATIONS AND THE REQUIREMENTS OF THE CDM REGULATIONS.

- WORKMANSHIP:
4. PROVIDE DRAUGHT-PROOFING AND SEALING MEASURES AROUND ALL OPENINGS, INCLUDING WINDOWS, DOORS, SCREENS, SERVICES PIPEWORK, LOFT HATCHES, ETC., IN ACCORDANCE WITH APPROVED DOCUMENT 'L1', AS NECESSARY.
  5. WORKMANSHIP ON BUILDING SITES TO BS8000. DRAINAGE, EXCAVATION AND FILLING TO BS8301/6031. CONCRETE, FOUNDATIONS AND FLOORSLABS TO BS8110/8004/8103. MASONRY, CONCRETE BRICKS AND BLOCKS TO BS5390/6073/5628. DAMP PROOF COURSES TO BS8215/8102/6398/743/ AVOIDING PITCH POLYMER. CARPENTRY, JOINERY AND PARTITIONING TO BS5268/1186/5234. INTERNAL PLASTERING AND TILING TO BS1191/5.

- POST CONSTRUCTION:
6. THE CONTRACTOR IS REQUIRED TO PROVIDE A SIGNED DECLARATION (REGARDING THE QUALITY OF CONSTRUCTION) TO DEMONSTRATE THE CONSTRUCTION OF THE BUILDING FABRIC IS CONSISTENT WITH THE DESIGN.
  7. THE CONTRACTOR IS TO ARRANGE FOR AND ENSURE THAT ALL BUILDING SERVICES INSTALLATIONS ARE PROPERLY COMMISSIONED AND SUFFICIENT INFORMATION WILL BE PASSED ON TO THE OCCUPIER OF THE BUILDING TO ENABLE CORRECT AND MOST ENERGY EFFICIENT OPERATION AND MAINTENANCE OF ALL FIXED BUILDING SERVICES.

REV	AMENDMENTS	DATE	INTS
STATUS			
<b>PLANNING</b>			
CLIENT			
<b>BRINDLE</b>			
PROJECT			
<b>REAR EXTENSION 107 BLACKPOOL ROAD</b>			
DRAWING TITLE			
<b>EXISTING &amp; PROPOSED SITE PLAN</b>			
DRAWN	<b>PMB</b>	CHECKED	<b>PMB</b>
DATE	<b>06/2021</b>	SCALE@A3	<b>1:200</b>
DRAWING NUMBER			REV
<b>2021/01/02</b>			<b>-</b>