

VELUX OR EQUIVALENT ROOFLIGHT WITH DOUBLE JOISTS EACH SIDE. SEE SPECIFICATION FOR DETAILS.

DRESS ROOF FINISH OVER SW FILLET AND UP WALL MIN 150mm AND TUCK UNDER COPING.

SEE STRUCTURAL CALCULATION FOR SIZE OF STEEL BEAM, AND SPECIFICATION FOR FIRE PROTECTION.

INSTALL DUCTING INTO SUB FLOOR TO PROVIDE CROSS VENTILATION TO EXISTING FLOOR. SEE SPECIFICATION.

A142 M5 MESH TO FLANING FOUND/FL.
2 x 150mm DEEP CONCRETE
LINTELS BEARING
150mm EACH END.

DRAIN PROTECTION AT WALLS 120

REMOVE PENDENT TO TUCK ROOF FINISH INTO BRICK JOINT.
CODE B LEAD FLASHING OVER.

DRESS ROOF FINISH OVER BATTEN TO FORM DRIP INTO GUTTER FALLING 4m 200 TO RW PIPE.

CANTIC CHIT OR EQUIVALENT UNTEL BEARING MIN 150mm EACH END.

ENSURE STEP DOES NOT BRIDGE DPC.

EXISTING DRAIN RUN SURROUNDED IN PEAS SHINGLE OF CONCRETE, AS DIRECTED BY INSPECTOR.

EXISTING CONSTRUCTION SHADED

NEW ROOF JOISTS SUPPORTED ON TO ITOX BOM. TIMBERS BOLTED TO WALL FOR FULL LENGTH OF EXTENSION TO RELIEVE ANY EXTRA LOAD ON THE EXISTING UNTEL.

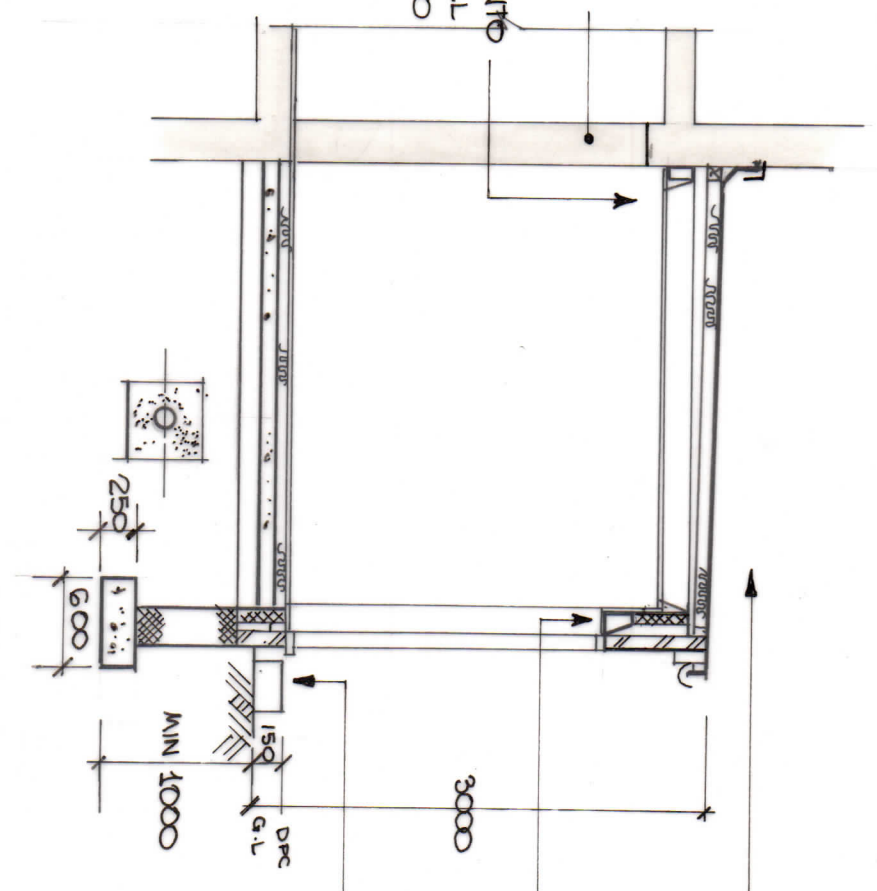

36 WESTBROOKE ROAD SIDCUP DA15 7PH
SINGLE STOREY REAR EXTENSION
DRAWING No AM/1718/7/6
SECTIONS A-A AND B-B
DATE JUNE 2017 SCALE 1:50