

Proposed Ground Floor Layout.

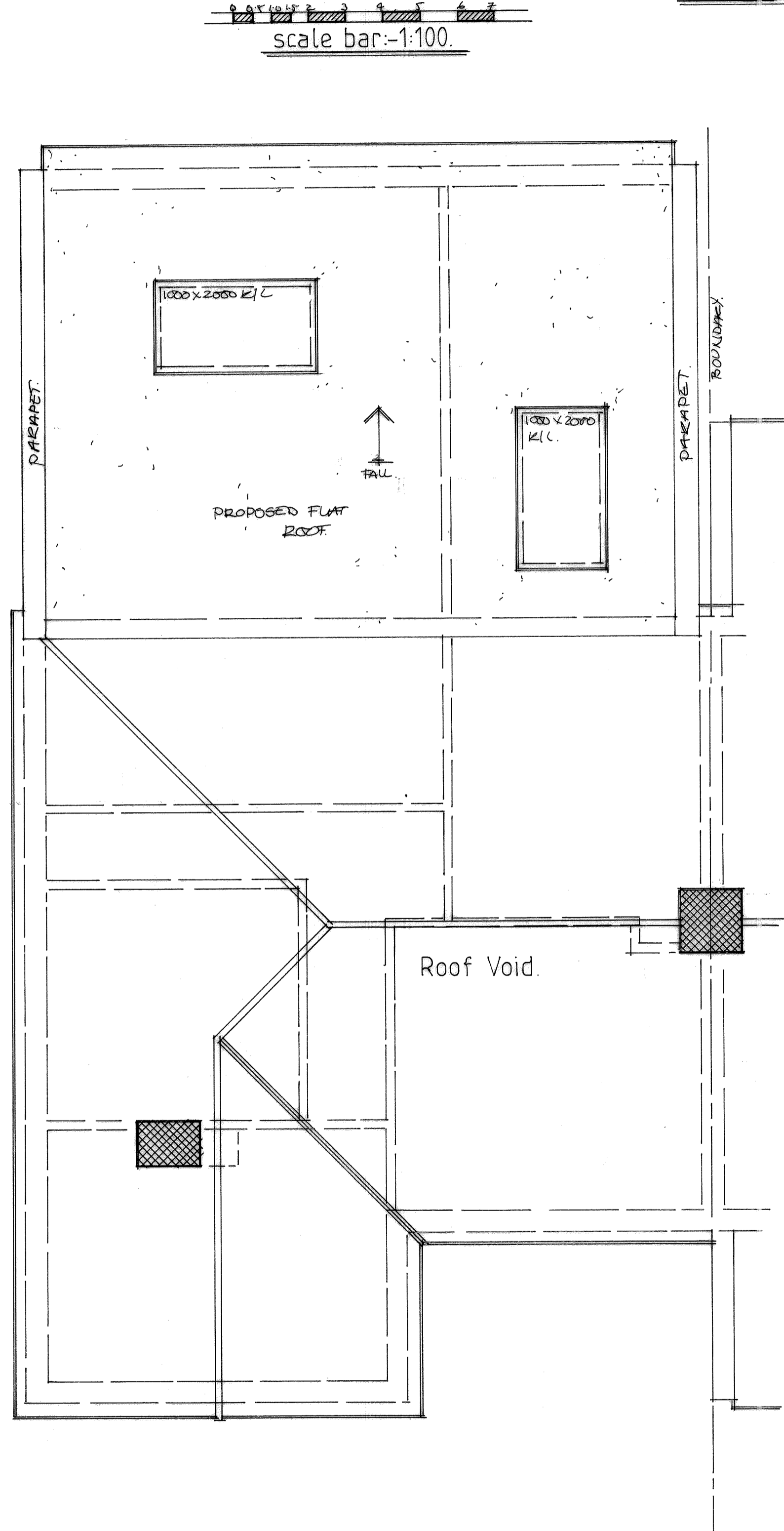

Proposed Roof Layout.

Russell A Broad & Associates.
 *Architecture*Surveying*Supervision*
 approved designs since 1986.
 The Architectural Design Studio,
 127, Crayford Road, Crayford,
 Kent. DA1 4AS
 Mobile:- 07931 150805.
 Email:- RussellBroad1986@gmail.com

Project:-
**Proposed Single Storey
 Rear Extension with
 Alterations.**

Project Address:-
**10, Kipling Road,
 Bexleyheath,
 Kent. DA7 4SG.**
 For:-
Mr & Mrs. M. Basi

Drawn: <i>R.A.B.</i>	Submitted:-	Approved:-
-------------------------	-------------	------------

Date:- Apr. 2021	Scale:- 1:50, 1:100.
---------------------	-------------------------

Do Not Scale From Drawing.
 All Dimensions are to be Checked on Site.
 All Works to Relevant Codes of Practice & B.S.'s.
 Client and Contractor to ensure compliance with
 C.D.M., Health & Safety Regulations & Party Wall
 Agreement Act where applicable.

Project Ref:- 81132.	Drawing Number:- 02	Rev
-------------------------	------------------------	-----