

**KEY**

- SITE BOUNDARY
- 1 STOREY
- 1.5 STOREY - RESIDENTIAL
- 2 STOREY - RESIDENTIAL
- 1 STOREY - SUBSTATION
- TREES / FOLIAGE
- HIGH VOLTAGE CABLE
- POTENTIAL OVERLOOKING
- SUNPATH
- SLOPE OF SITE
- NATURAL TREE BELT BARRIER
- EXISTING TREES RETAINED
- ACCESS ONTO SITE
- PRIMARY VEHICLE ROUTE
- KEY VIEWS FROM SITE

**GENERAL NOTES:**

1. ALL DIMENSIONS TO BE VERIFIED ON SITE AND ANY DISCREPANCIES REPORTED BACK TO RDT ARCHITECTS.
2. COPYRIGHT OF THIS DRAWING IS RESERVED BY RDT ARCHITECTS.
3. THIS DRAWING IS FOR PLANNING PURPOSES ONLY.

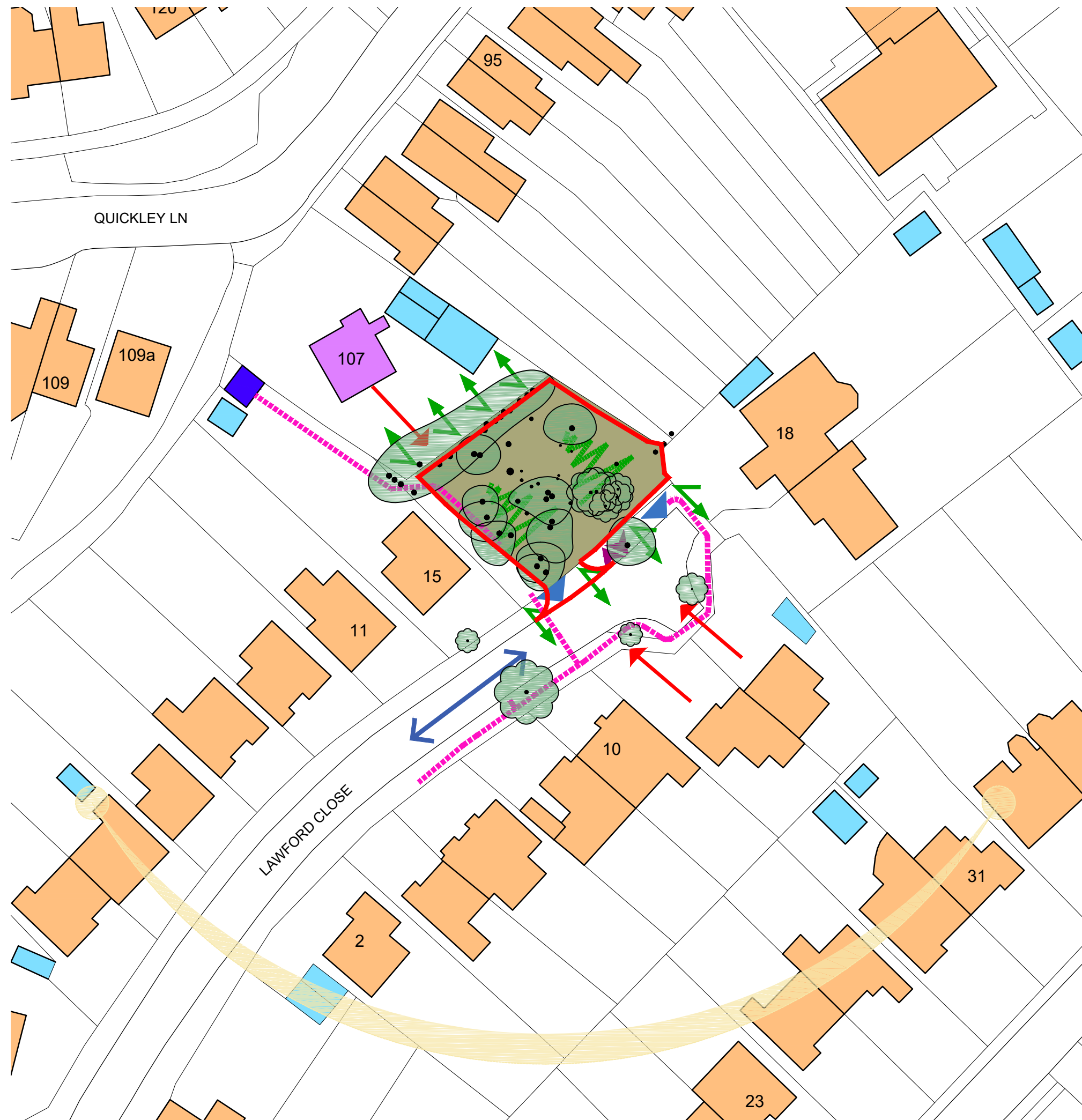
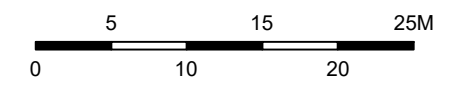
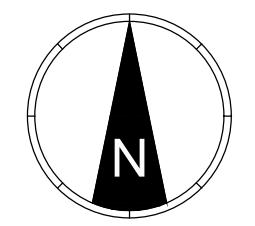

PL1	PLANNING ISSUE	GH	04.08.21
REV	DESCRIPTION	BY	DATE
PROJECT WORK STAGE			
<b>PLANNING</b>			
CLIENT			
TROUT RISE DEVELOPMENTS LTD			
PROJECT			
LAND AT LAWFORD CLOSE, CHORLEYWOOD, WD3 5PG			
DRWG TITLE			
EXISTING SITE CONSTRAINTS PLAN			
PROJECT	ORIGINATOR	ZONE	LEVEL
1159TPL	RDT	ZZ	XX
DR	A	0800	
STATUS			
-			
SUITABILITY DESCRIPTION			
-			
DRAWN BY	DATE	SCALE	CHECKED BY
GH	AUG 21	1:500	CC
RDT PROJECT REF.		PAPER SIZE	REVISION
1159		A3	PL1

1 Harrier Court, Woodside Road  
Lower Woodside, Bedfordshire LU1 4DQ  
T: +44(0)1582 461060  
E: rdt@rdtarchitects.co.uk  
www.rdtarchitects.co.uk

**EXISTING SITE CONSTRAINTS PLAN**