

# FAIRHURST

## Ordnance Survey Plan

Published 1980

Source map scale - 1:2,500

The historical maps shown were reproduced from maps predominantly held at the scale adopted for England, Wales and Scotland in the 1840's. In 1854 the 1:2,500 scale was adopted for mapping urban areas and by 1896 it covered the whole of what were considered to be the cultivated parts of Great Britain. The published date given below is often some years later than the surveyed date. Before 1938, all OS maps were based on the Cassini Projection, with independent surveys of a single county or group of counties, giving rise to significant inaccuracies in outlying areas.

## Map Name(s) and Date(s)

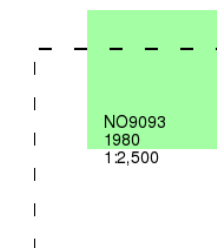

## Historical Map - Segment B6

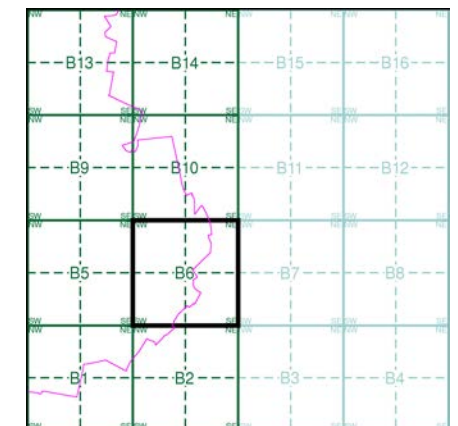

## Order Details

Order Number: 34325749\_1\_1  
Customer Ref: New Community at Chapelton of Elswick  
National Grid Reference: 390070, 794240  
Slice: B  
Site Area (Ha): 857.96  
Search Buffer (m): 0

## Site Details

New Community at Chapelton of Elswick, btw Newtonhill and Portlethen, Aberdeenshire



Tel: 0844 844 9952  
Fax: 0844 844 9951  
Web: www.envirocheck.co.uk

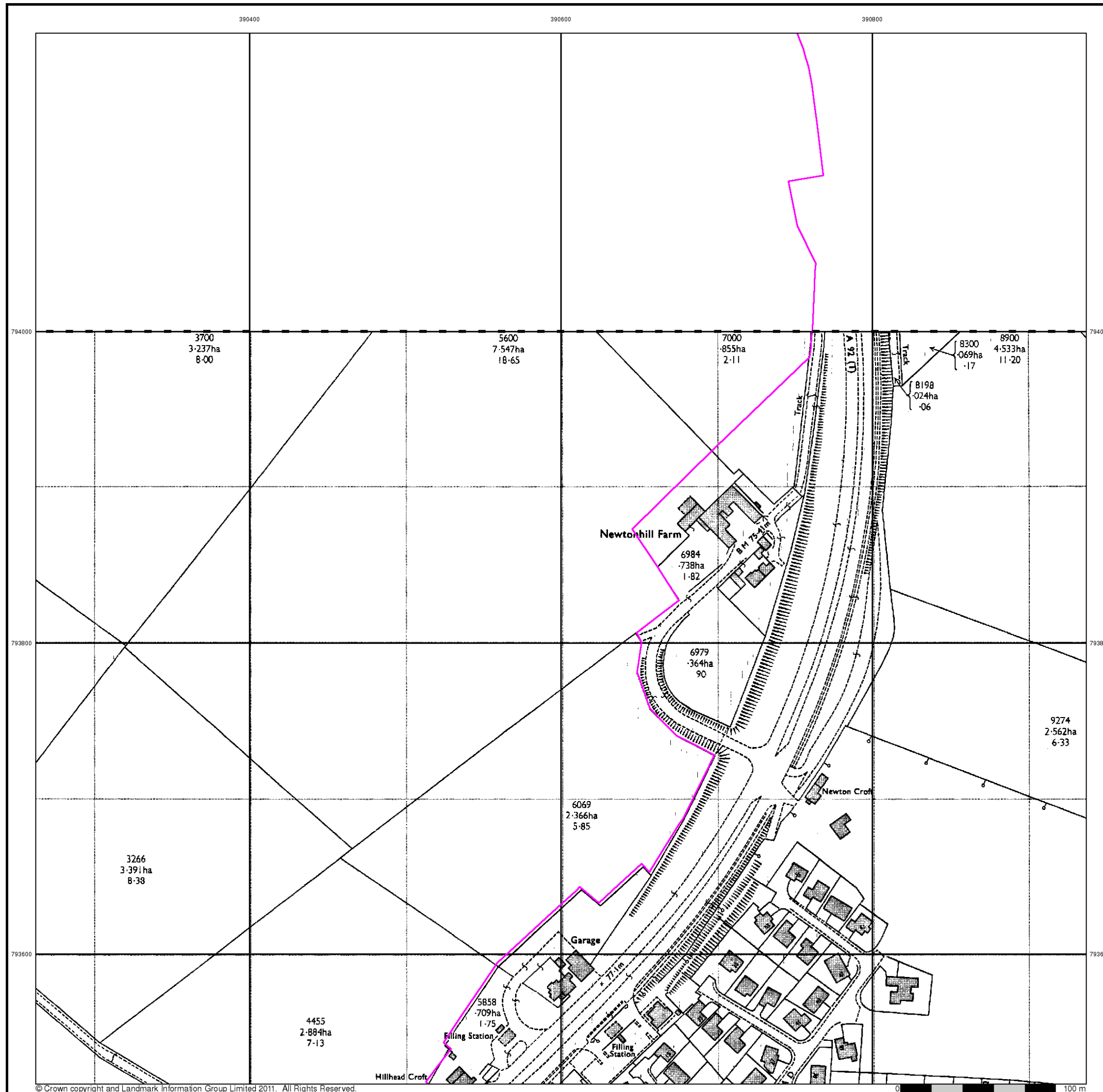

# FAIRHURST

## Additional SIMs

Published 1982

Source map scale - 1:2,500

The SIM cards (Ordnance Survey's 'Survey of Information on Microfilm') are further, minor editions of mapping which were produced and published in between the main editions as an area was updated. They date from 1947 to 1994, and contain detailed information on buildings, roads and land-use. These maps were produced at both 1:2,500 and 1:1,250 scales.

## Map Name(s) and Date(s)

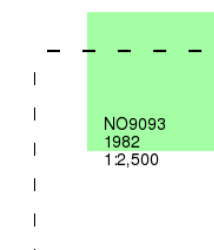

## Historical Map - Segment B6

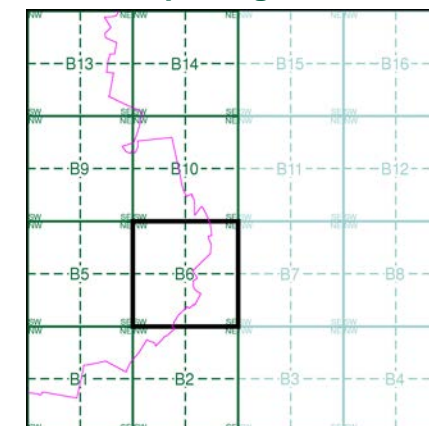

## Order Details

Order Number: 34325749\_1\_1  
Customer Ref: New Community at Chapelton of Elswick  
National Grid Reference: 390070, 794240  
Slice: B  
Site Area (Ha): 857.96  
Search Buffer (m): 0

## Site Details

New Community at, Chapelton of Elswick, btw Newtonhill and Portlethen, Aberdeenshire



Tel: 0844 844 9952  
Fax: 0844 844 9951  
Web: www.envirocheck.co.uk

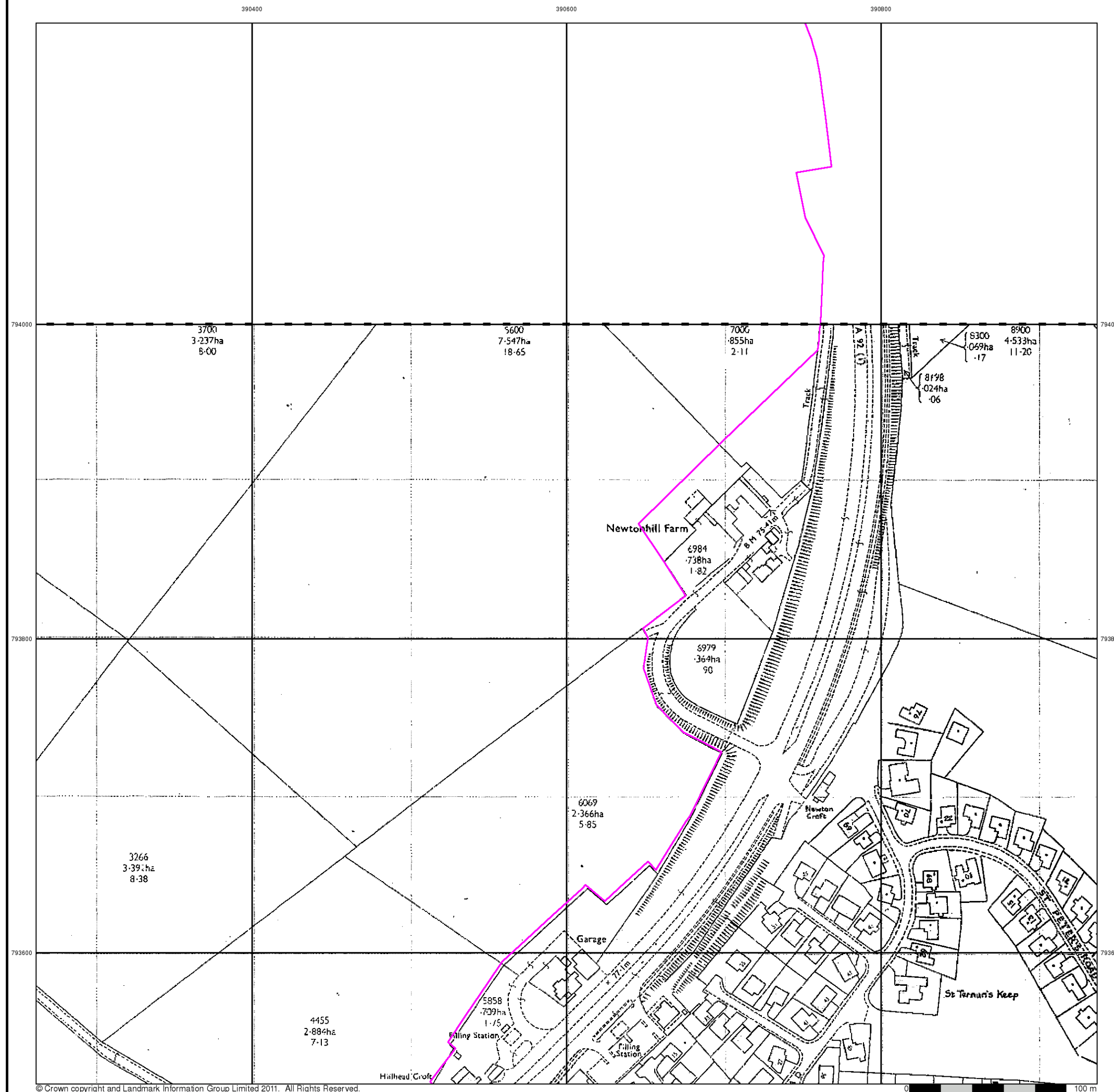

# FAIRHURST

## Additional SIMs

Published 1985

Source map scale - 1:2,500

The SIM cards (Ordnance Survey's 'Survey of Information on Microfilm') are further, minor editions of mapping which were produced and published in between the main editions as an area was updated. They date from 1947 to 1994, and contain detailed information on buildings, roads and land-use. These maps were produced at both 1:2,500 and 1:1,250 scales.

## Map Name(s) and Date(s)

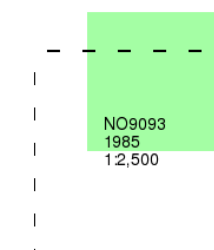

## Historical Map - Segment B6

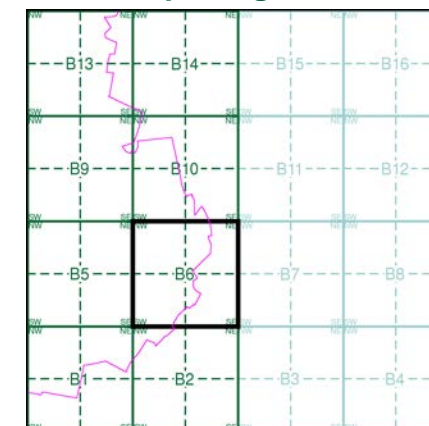

## Order Details

Order Number: 34325749\_1\_1  
Customer Ref: New Community at Chapelton of Elswick  
National Grid Reference: 390070, 794240  
Slice: B  
Site Area (Ha): 857.96  
Search Buffer (m): 0

## Site Details

New Community at, Chapelton of Elswick, btw Newtonhill and Portlethen, Aberdeenshire



Tel: 0844 844 9952  
Fax: 0844 844 9951  
Web: www.envirocheck.co.uk

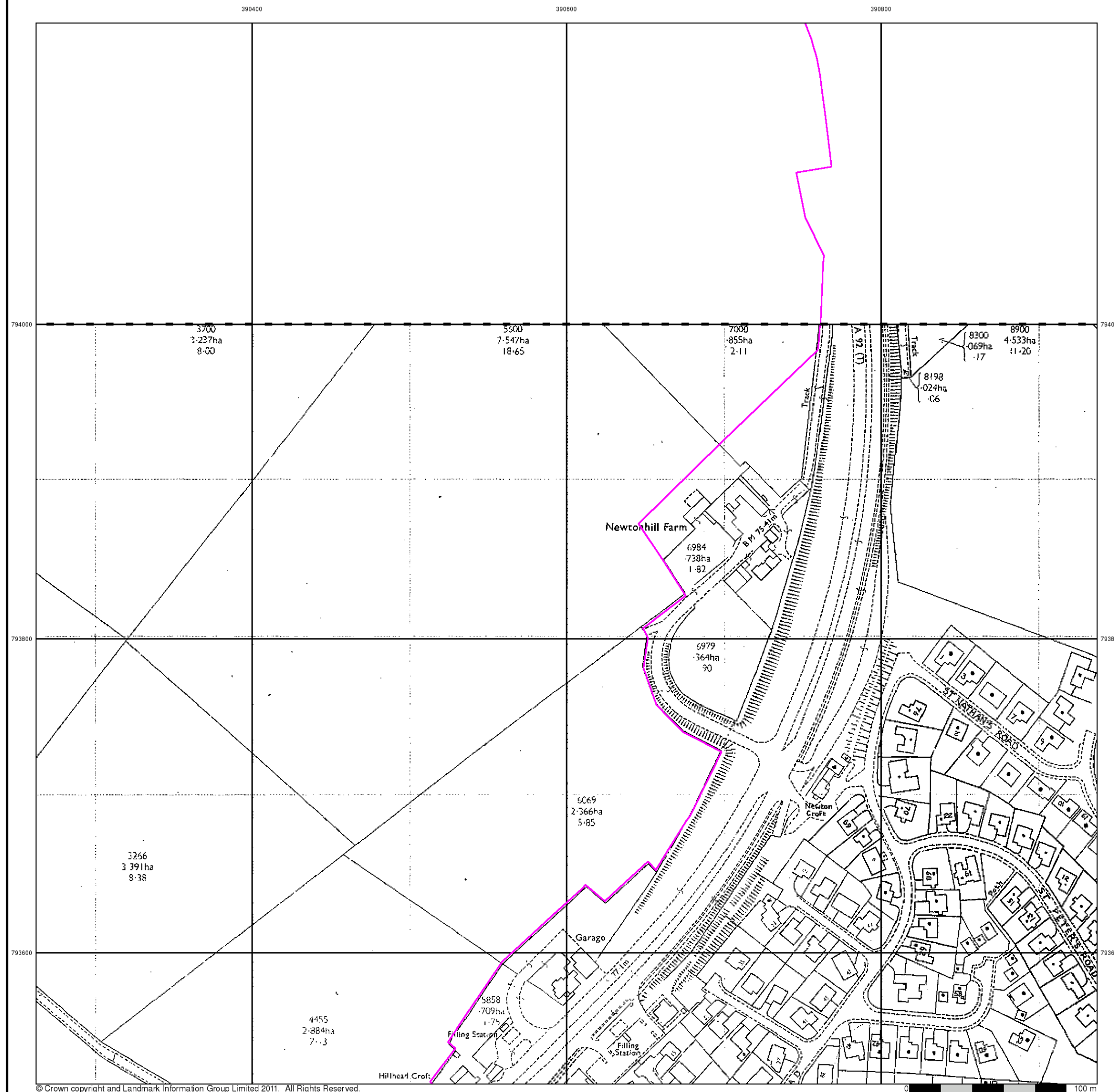



# FAIRHURST

## Additional SIMs

Published 1989

Source map scale - 1:2,500

The SIM cards (Ordnance Survey's 'Survey of Information on Microfilm') are further, minor editions of mapping which were produced and published in between the main editions as an area was updated. They date from 1947 to 1994, and contain detailed information on buildings, roads and land-use. These maps were produced at both 1:2,500 and 1:1,250 scales.

## Map Name(s) and Date(s)

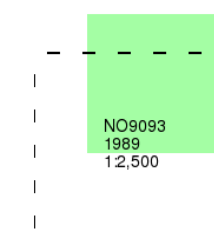

## Historical Map - Segment B6

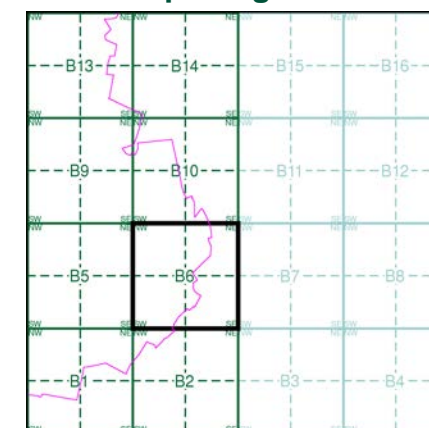

## Order Details

Order Number: 34325749\_1\_1  
Customer Ref: New Community at Chapelton of Elswick  
National Grid Reference: 390070, 794240  
Slice: B  
Site Area (Ha): 857.96  
Search Buffer (m): 0

## Site Details

New Community at, Chapelton of Elswick, btw Newtonhill and Portlethen, Aberdeenshire



Tel: 0844 844 9952  
Fax: 0844 844 9951  
Web: www.envirocheck.co.uk



# FAIRHURST

## Additional SIMs

Published 1990

Source map scale - 1:2,500

The SIM cards (Ordnance Survey's 'Survey of Information on Microfilm') are further, minor editions of mapping which were produced and published in between the main editions as an area was updated. They date from 1947 to 1994, and contain detailed information on buildings, roads and land-use. These maps were produced at both 1:2,500 and 1:1,250 scales.

## Map Name(s) and Date(s)

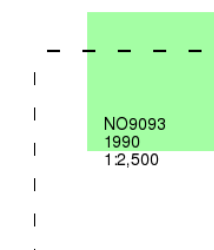

## Historical Map - Segment B6

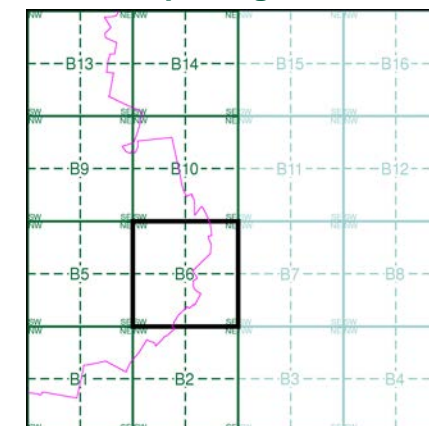

## Order Details

Order Number: 34325749\_1\_1  
Customer Ref: New Community at Chapelton of Elsick  
National Grid Reference: 390070, 794240  
Slice: B  
Site Area (Ha): 857.96  
Search Buffer (m): 0

## Site Details

New Community at, Chapelton of Elsick, btw Newtonhill and Portlethen, Aberdeenshire



Tel: 0844 844 9952  
Fax: 0844 844 9951  
Web: www.envirocheck.co.uk



# FAIRHURST

## Additional SIMs

Published 1992

Source map scale - 1:2,500

The SIM cards (Ordnance Survey's 'Survey of Information on Microfilm') are further, minor editions of mapping which were produced and published in between the main editions as an area was updated. They date from 1947 to 1994, and contain detailed information on buildings, roads and land-use. These maps were produced at both 1:2,500 and 1:1,250 scales.

## Map Name(s) and Date(s)

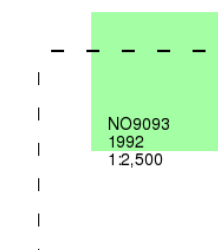

## Historical Map - Segment B6

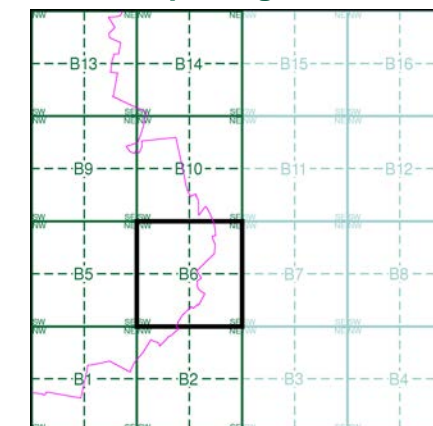

## Order Details

Order Number: 34325749\_1\_1  
Customer Ref: New Community at Chapelton of Elswick  
National Grid Reference: 390070, 794240  
Slice: B  
Site Area (Ha): 857.96  
Search Buffer (m): 0

## Site Details

New Community at, Chapelton of Elswick, btw Newtonhill and Portlethen, Aberdeenshire



Tel: 0844 844 9952  
Fax: 0844 844 9951  
Web: www.envirocheck.co.uk





# FAIRHURST

## Large-Scale National Grid Data

Published 1995

Source map scale - 1:2,500

'Large Scale National Grid Data' superseded SIM cards (Ordnance Survey's 'Survey of Information on Microfilm') in 1992, and continued to be produced until 1999. These maps were the fore-runners of digital mapping and so provide detailed information on houses and roads, but tend to show less topographic features such as vegetation. These maps were produced at both 1:2,500 and 1:1,250 scales.

### Map Name(s) and Date(s)

NO9094	1995	1:2,500
NO9093	1995	1:2,500

### Historical Map - Segment B6

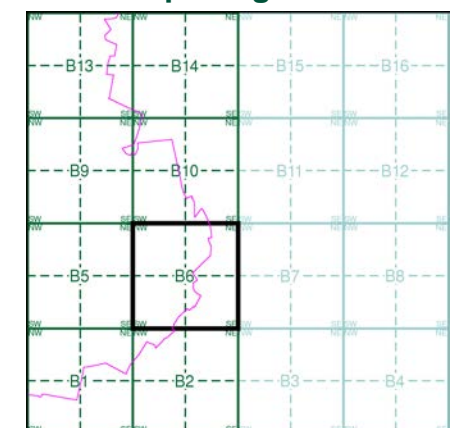

### Order Details

Order Number: 34325749\_1\_1  
Customer Ref: New Community at Chapelton of Elswick  
National Grid Reference: 390070, 794240  
Slice: B  
Site Area (Ha): 857.96  
Search Buffer (m): 0

### Site Details

New Community at, Chapelton of Elswick, btw Newtonhill and Portlethen, Aberdeenshire



Tel: 0844 844 9952  
Fax: 0844 844 9951  
Web: [www.envirocheck.co.uk](http://www.envirocheck.co.uk)



# FAIRHURST

## Large-Scale National Grid Data

Published 1995

Source map scale - 1:2,500

'Large Scale National Grid Data' superseded SIM cards (Ordnance Survey's 'Survey of Information on Microfilm') in 1992, and continued to be produced until 1999. These maps were the fore-runners of digital mapping and so provide detailed information on houses and roads, but tend to show less topographic features such as vegetation. These maps were produced at both 1:2,500 and 1:1,250 scales.

### Map Name(s) and Date(s)

NO9094	1995	1:2,500
NO9093	1995	1:2,500

### Historical Map - Segment B6

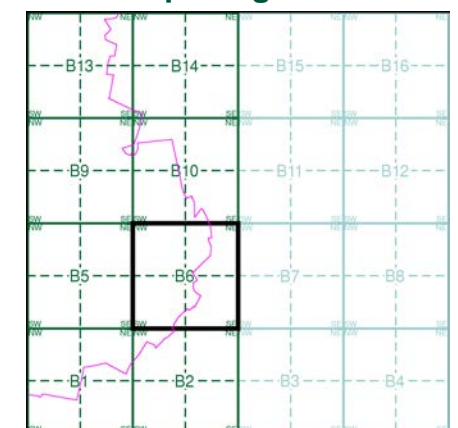

### Order Details

Order Number: 34325749\_1\_1  
Customer Ref: New Community at Chapelton of Elswick  
National Grid Reference: 390070, 794240  
Slice: B  
Site Area (Ha): 857.96  
Search Buffer (m): 0

### Site Details

New Community at, Chapelton of Elswick, btw Newtonhill and Portlethen, Aberdeenshire



Tel: 0844 844 9952  
Fax: 0844 844 9951  
Web: www.envirocheck.co.uk





# FAIRHURST

## Large-Scale National Grid Data

Published 1997

Source map scale - 1:2,500

'Large Scale National Grid Data' superseded SIM cards (Ordnance Survey's 'Survey of Information on Microfilm') in 1992, and continued to be produced until 1999. These maps were the fore-runners of digital mapping and so provide detailed information on houses and roads, but tend to show less topographic features such as vegetation. These maps were produced at both 1:2,500 and 1:1,250 scales.

### Map Name(s) and Date(s)

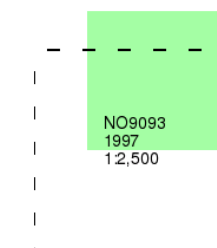

### Historical Map - Segment B6

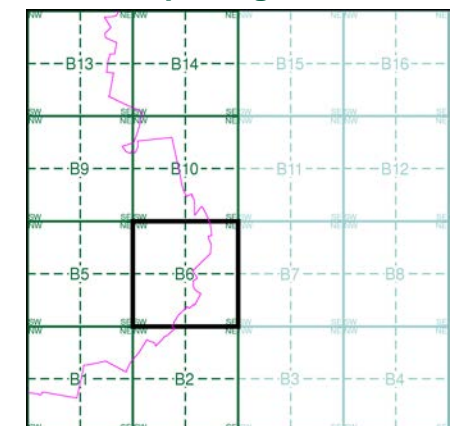

### Order Details

Order Number: 34325749\_1\_1  
Customer Ref: New Community at Chapelton of Elswick  
National Grid Reference: 390070, 794240  
Slice: B  
Site Area (Ha): 857.96  
Search Buffer (m): 0

### Site Details

New Community at, Chapelton of Elswick, btw Newtonhill and Portlethen, Aberdeenshire



Tel: 0844 844 9952  
Fax: 0844 844 9951  
Web: [www.envirocheck.co.uk](http://www.envirocheck.co.uk)

