

Application for Conservation Area Consent for installation of an Air Source Heat Pump Appliance.

Grounds Plan Alteration proposal

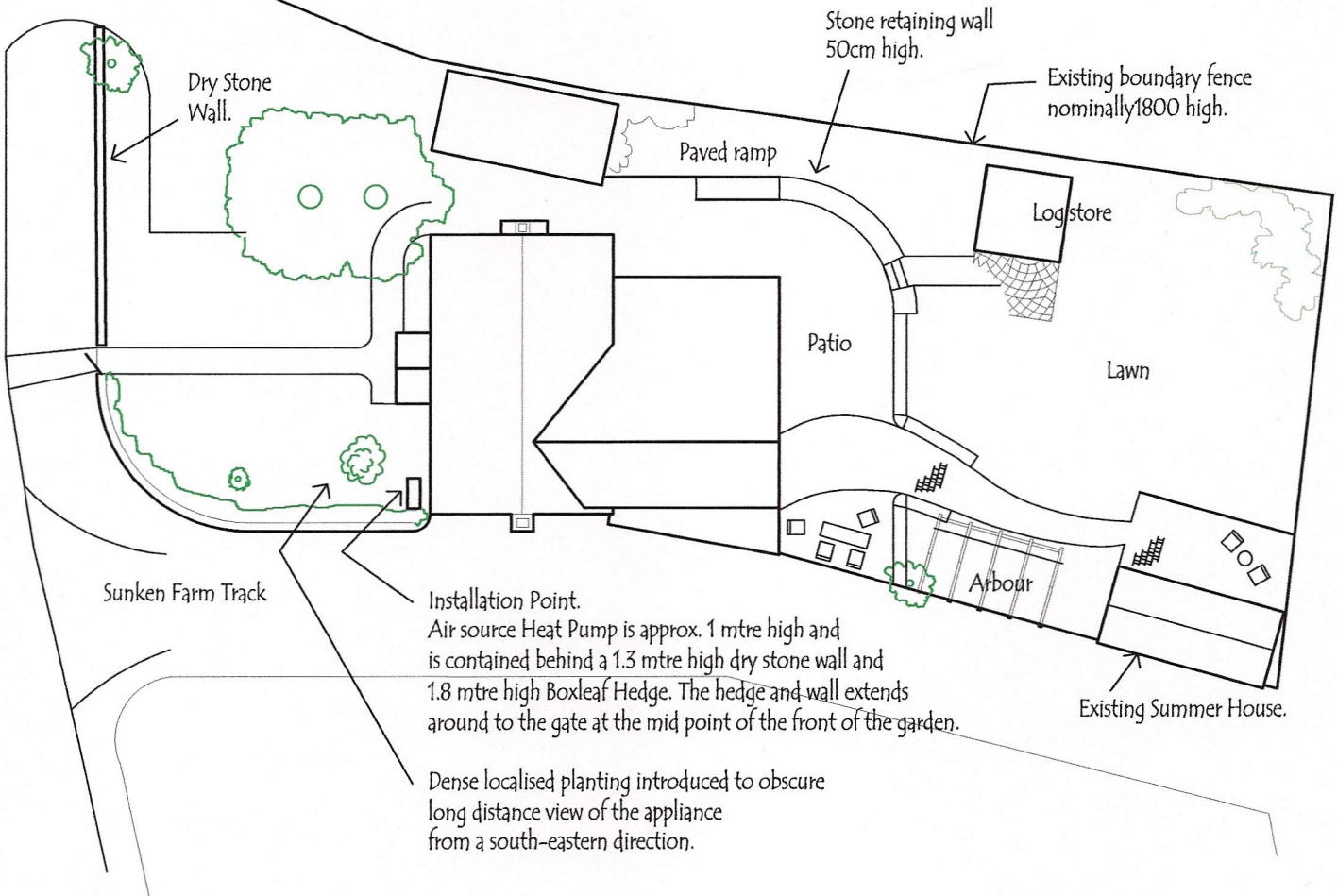

North Elevation of Alteration proposal

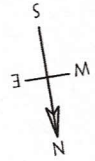
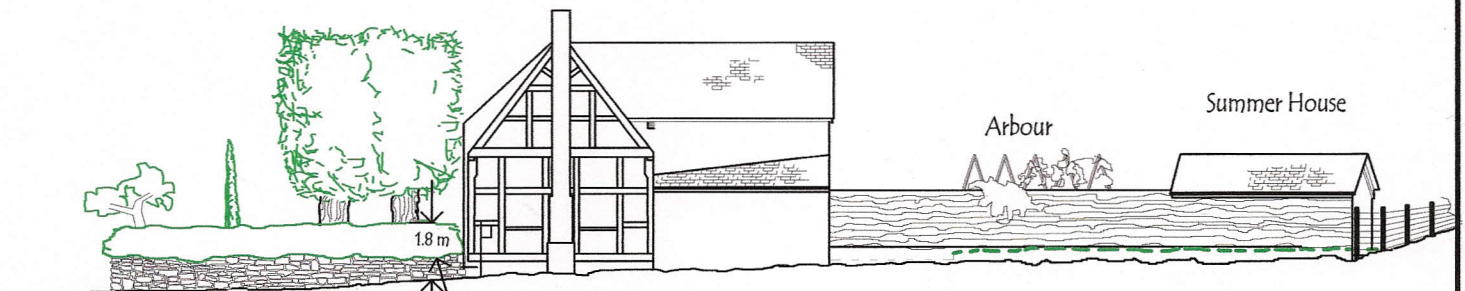

Pavement level at main road is 1.17metres below garden level at the appliance installation point.

The Air Source Heat Pump is situated behind a wall and hedge which extends along the length of the side track and curves around the boundary fronting the main road.

The Air Source appliance also replaces the need for a Gas or oil tank which would be sited in the front garden if a conventional Boiler system was installed.