

1. MEMBER LEDGER  
 ExFJ - Existing 1st floor joist span. Improve joist end bearings using bearing rail R1 as section A-A.  
 ExTB - Existing floor tie beam  
 ExWP - Existing wall plate - see section A-A.  
 ExFB - Existing 1st floor beams  
 TB1 - Provide new 12mm dia. stainless or galvanised steel tie bars - see section A-A  
 P1 - Provide new min. 125 x 150 wide oak or douglas fir posts to support rotated inner edge of ExWP off sole plate/plinth - see section B-B. Note - if using oak used seasoned not green timber as green often experiences significant shrinkage as it dries out which in this instance may compromise the maintaining of flush continuous bearings with the rotated head plate.  
 R1 - Provide new 150 x 75 seasoned oak or douglas fir bearing rail to 1st floor joists, spanning between P1 posts, see section A-A & B-B. Note - 75mm thickness is minimum requirement, use wider section if loose joists do not gain sufficient bearing on rail - builder to confirm on site.

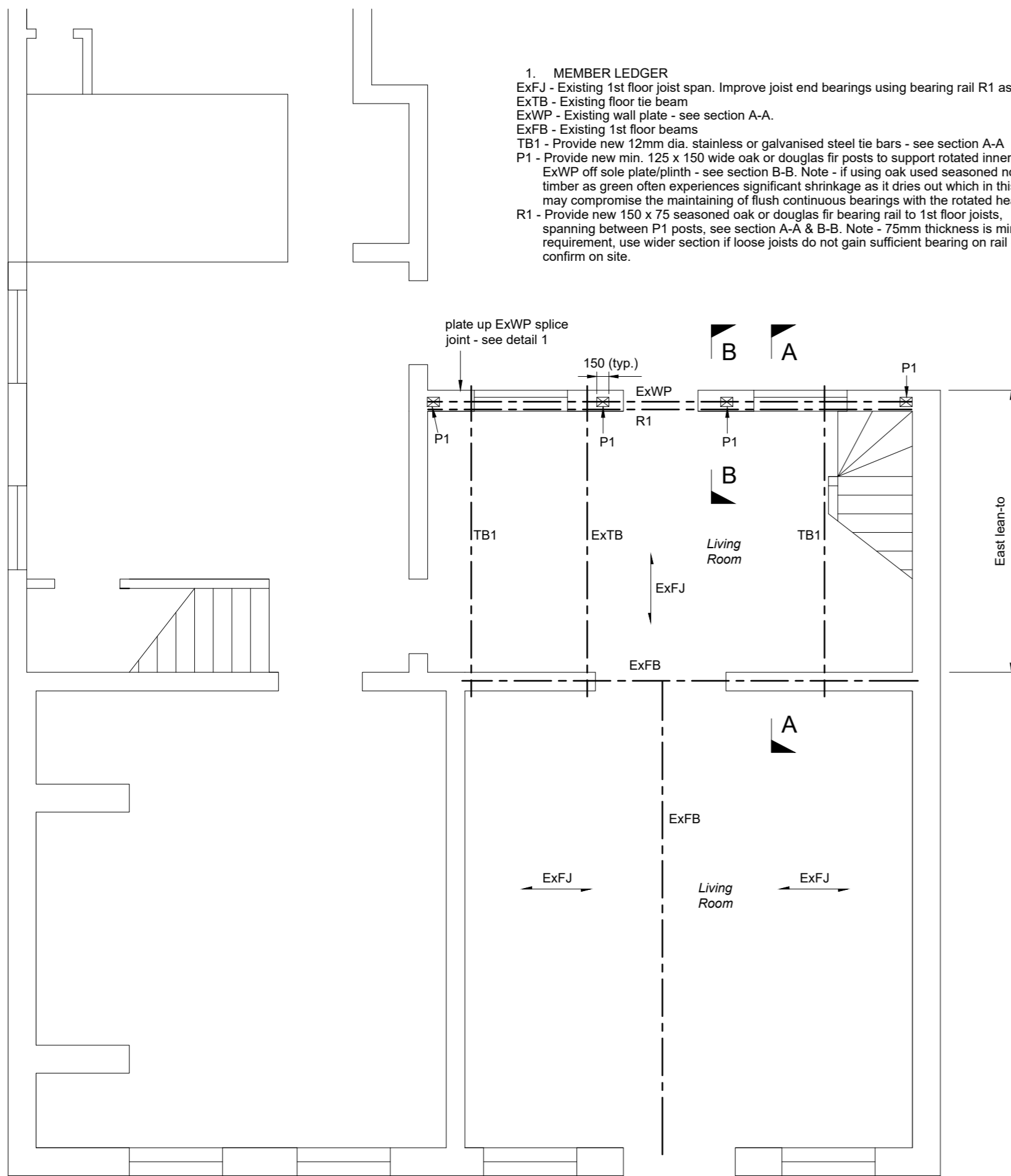

Key Plan - Ground Floor As Proposed

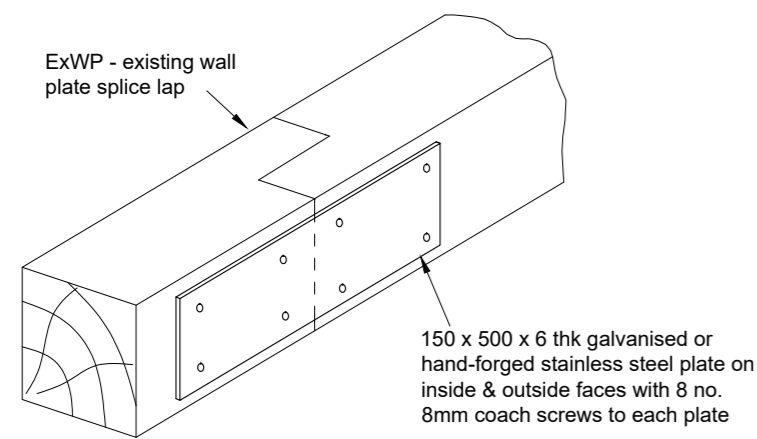

Detail 1 - Wall Plate Splice Joint Strengthening

**DRAWINGS ARE INDICATIVE ONLY - THEY ARE NOT TO SCALE. DO NOT SCALE DIMENSIONS FROM THIS DRAWING**

These structural details are provided on the basis that the work will be carried out by an experienced contractor familiar with the general requirements of the Building Regulations, CDM Regulations and usual good building practice.

All setting out dimensions relating to any existing structures are to be verified by the contractor on site prior to ordering any materials.

NOTE - DISCREPANCIES BETWEEN THIS DRAWING OR SITE CONDITIONS ARE TO BE REPORTED TO ADAM POWER ASSOCIATES IMMEDIATELY. THE CONTRACTOR SHALL AWAIT INSTRUCTION FROM US PRIOR TO PROCEEDING WITH ANY FURTHER WORKS ON SITE

CONSTRUCTION (Design & Management) REGULATIONS 2015: The structural design has been carried out with due consideration for safety during construction, occupation and maintenance of the finished structure. The Works contains no extraordinary hazards or risks that are not present during routine construction operations or would readily be apparent to a competent contractor. The project does not involve specialist methods or sequence of operations.

Unless specifically detailed on this drawing, all Temporary Works shall be designed and detailed by the Contractor in accordance with BS5975:2019.

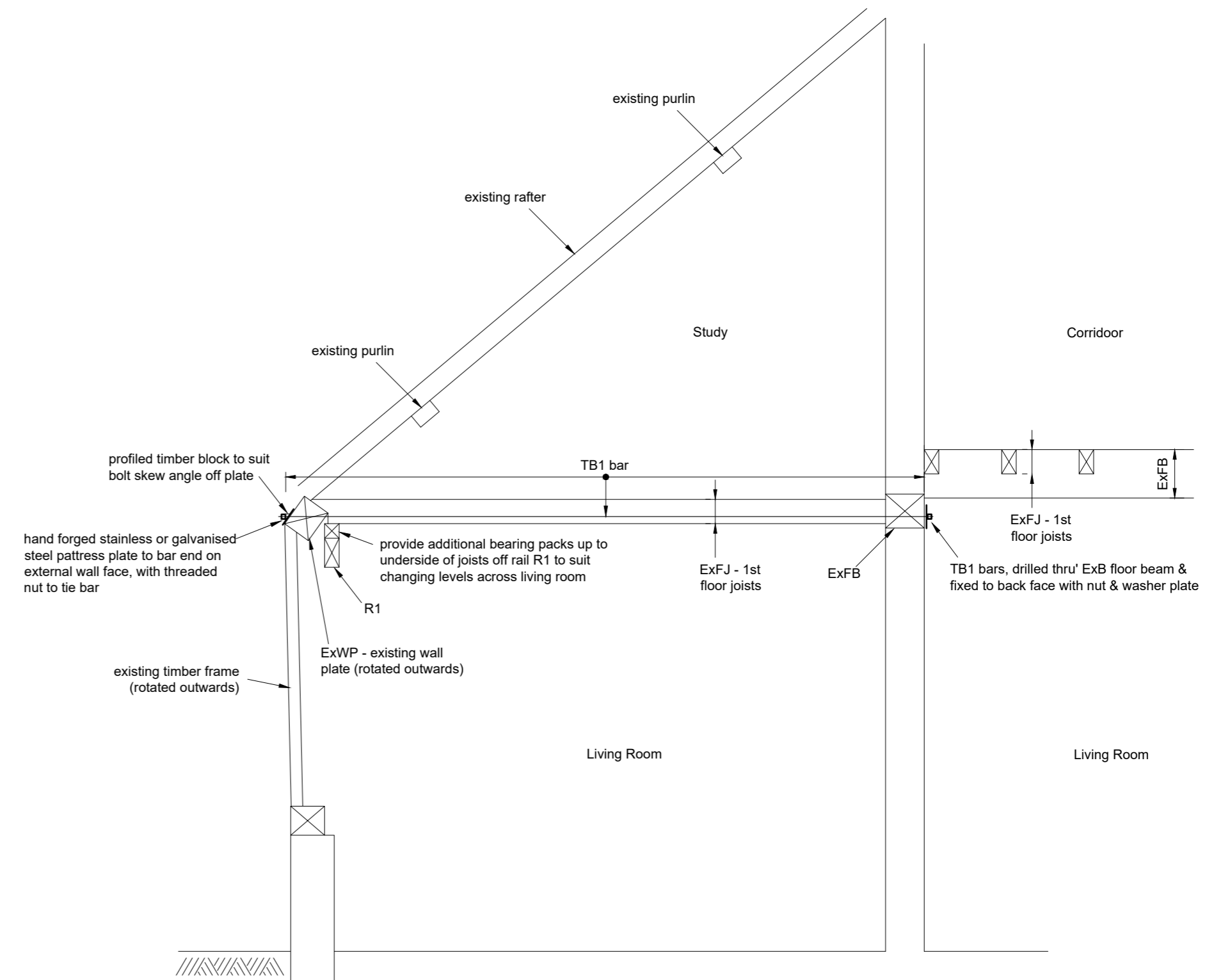

Section A-A  
Typ. View on TB1 Bar

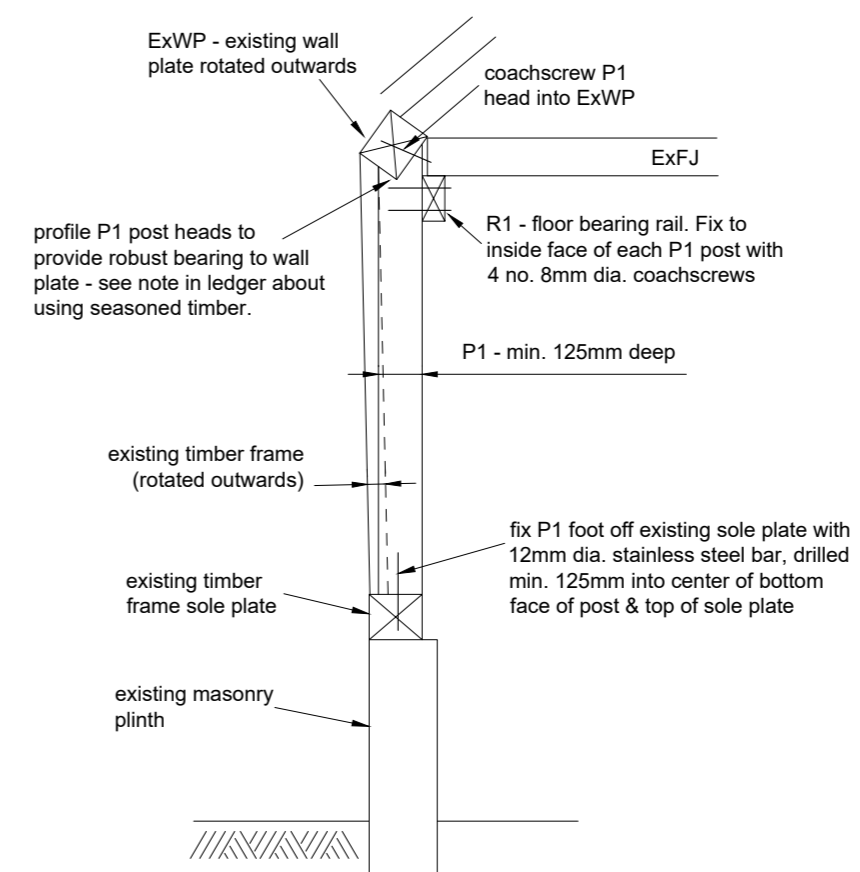

Section B-B  
Typ. View on P1 Posts

Rev	Date	Details
-	-	-
In the event of any queries please contact: Jason Albanie BSc IEng MICE		
 <b>ADAM POWER ASSOCIATES (RICKINGHALL)</b> Consulting Civil/Structural Engineers The Old Chapel, The Street, Rickingham, Suffolk IP22 1BN Tel 01953 668664 Adam Power Associates (Rickingham) is the trading name of Protek Consulting Ltd. email: jasona@adampower.co.uk Direct dial: 01953 660282		
<b>Title</b> 205 The Street, Thornham Magna Remedial Works - Structural Data		
For	S. Dawkins	Date 25-May-21
Job No.	Drq No.	CAD Plot Scale
R/21/077	D1	not to scale
		Rev -