

SECTION THROUGH BALCONY FOR NEW FLOOR...

Metal balustrade formed with 40mm square section and infilled with steel mesh to client choice welded with a 25mm frame .
 Posts to have 75mm square base to allow screw fixing down through chipboard floor to new joists forming new floor. min 2x75mm long screws.

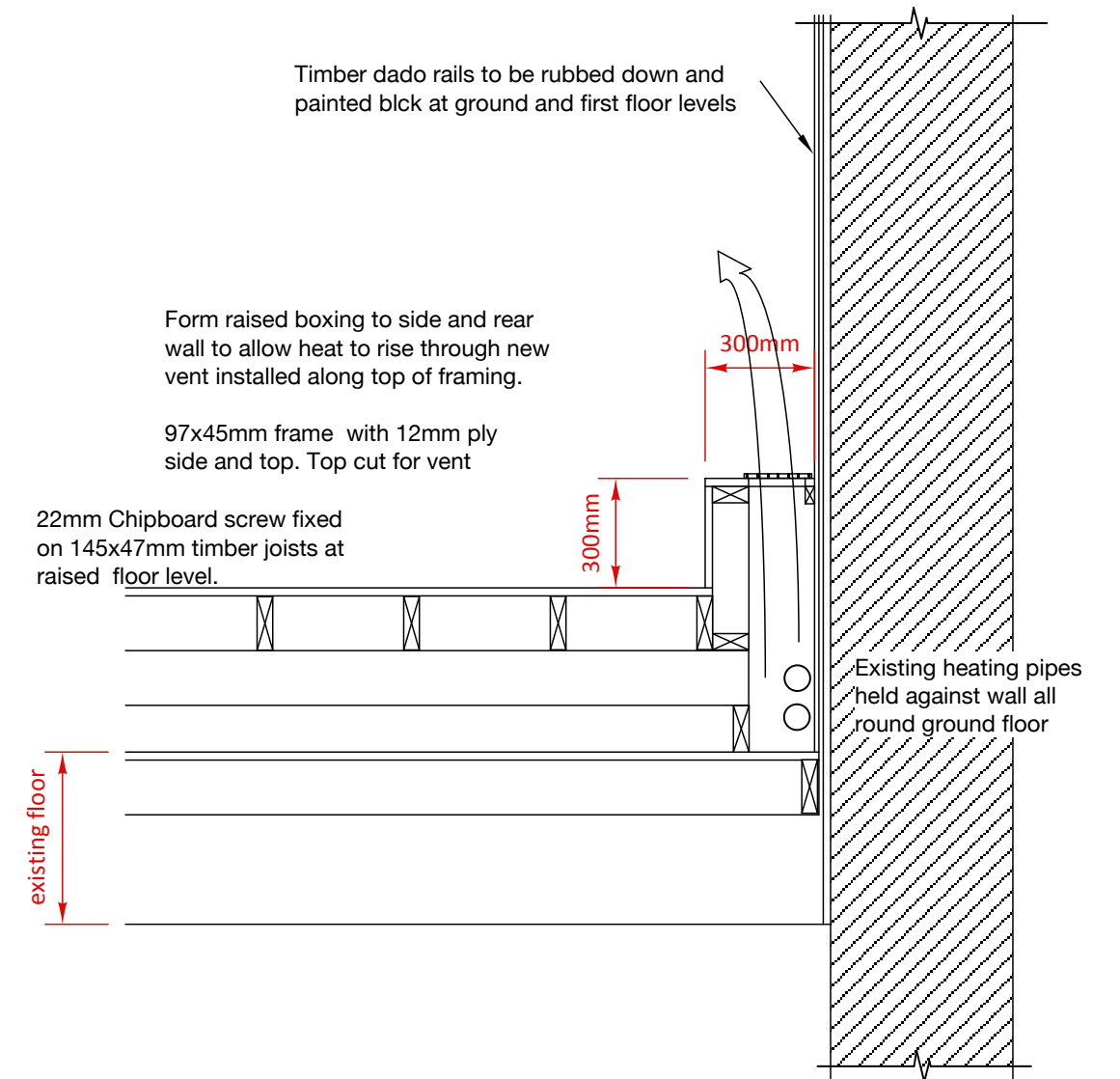

SECTION AT WALL VENT...

Scale 1:20



Client	Margaret Cassidy	Address	9 Skipness Drive, Glasgow
Project	St Kenneths Church Conversion to Sports Leisure Facility	Dwg	A1490.21.09
Title	Section at balcony, vent	Date	27.06.21
		Scale	1:20

KEITH EDWARDS ARCHITECT

2 CALEDON STREET, GLASGOW
 G12 9DX tel : 0141 341 0694