

EXISTING

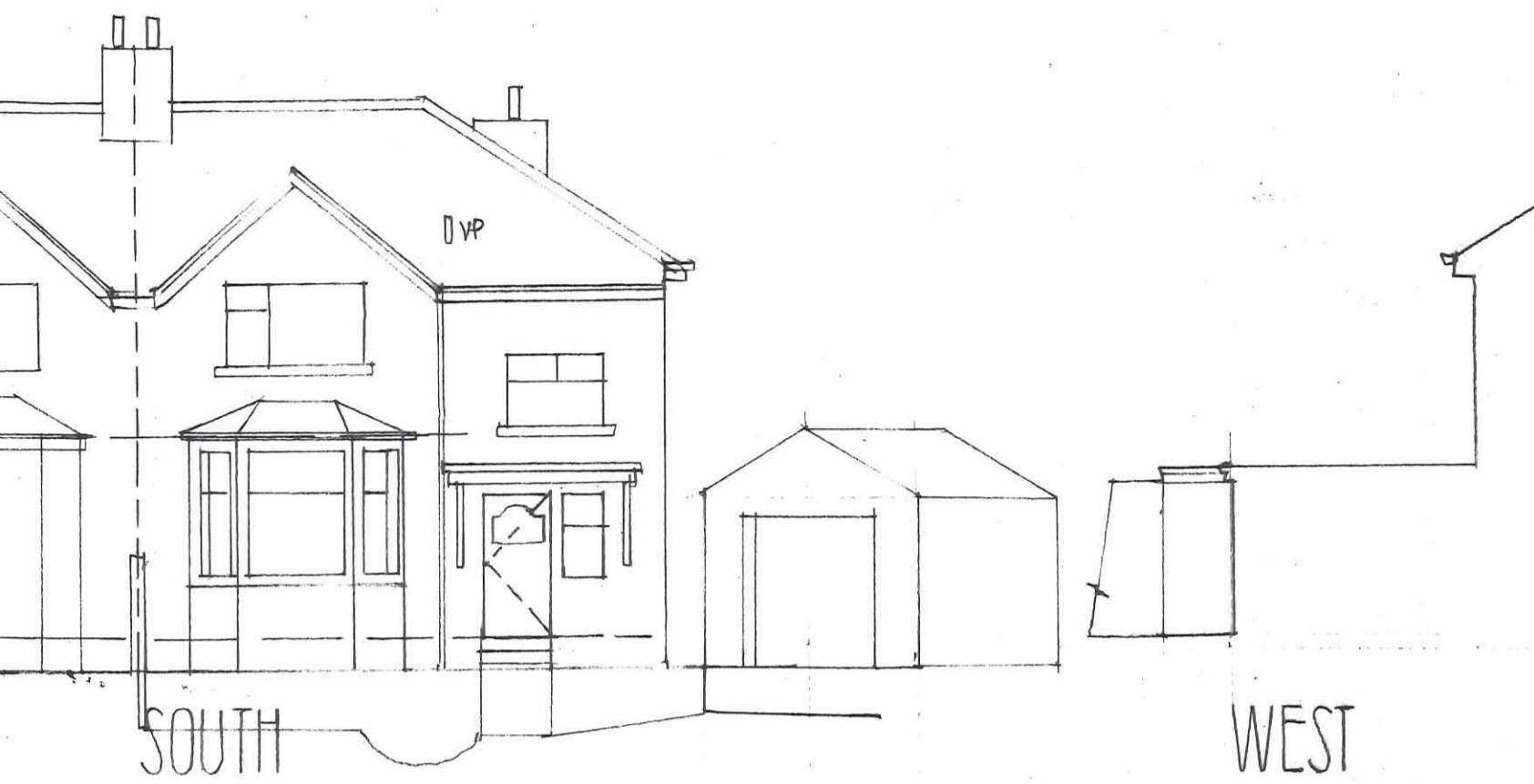

PROPOSED

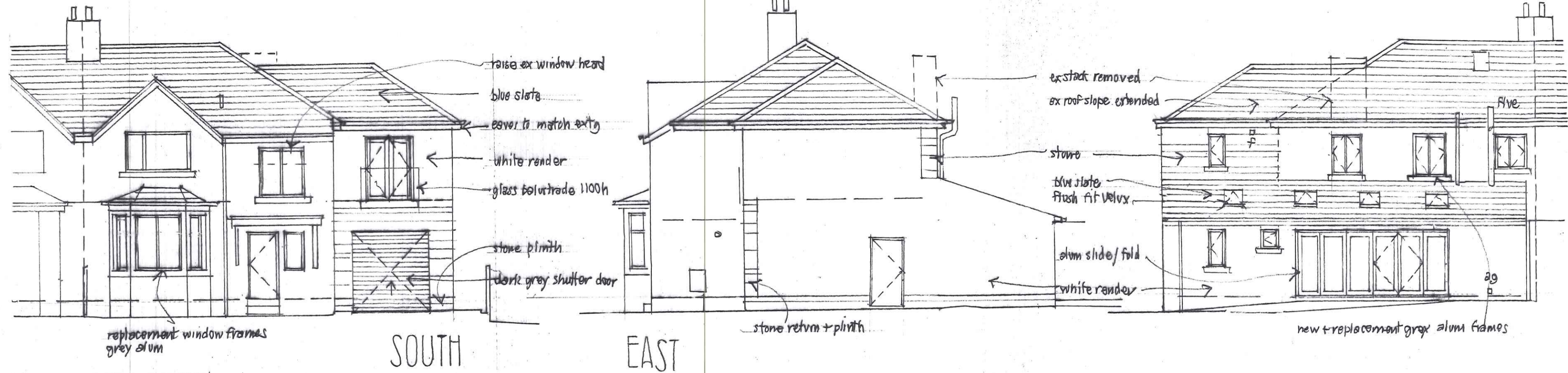

LOCATION 1:2500 BD23 1ND

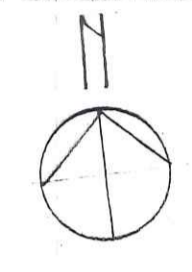

SITE/ROOF 1:500

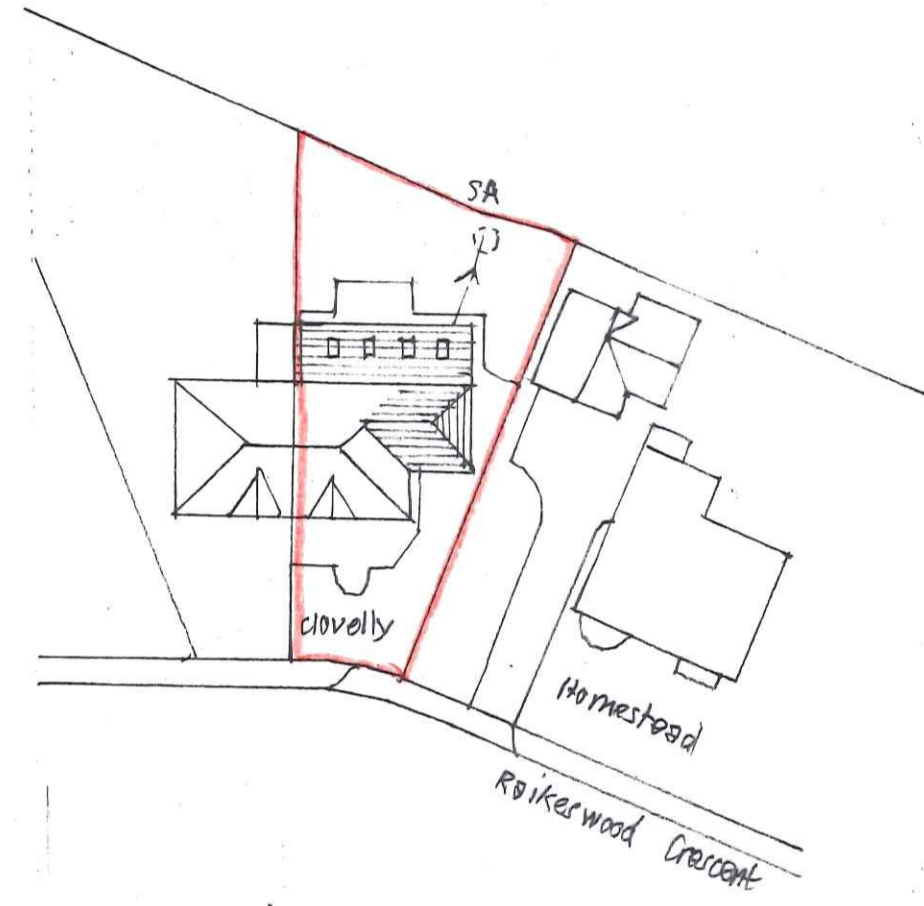

exterior materials:
roof - blue slate
walls - reclaimed stone + white render
new goods - PVC to match ext
windows - dark grey aluminium



EXTENSION CLOVELLY
RAIKESWOOD CRESCENT SKIPTON
scale 1:100 July 2021

JW
JOHN & JENNIFER WHARTON ARCHITECT DESIGNER
Craven House
Brook View
Carlisleton
SKIPTON
North Yorkshire BD23 3EX tel 01756 792708

2986

