

LOMBARD DRIVE

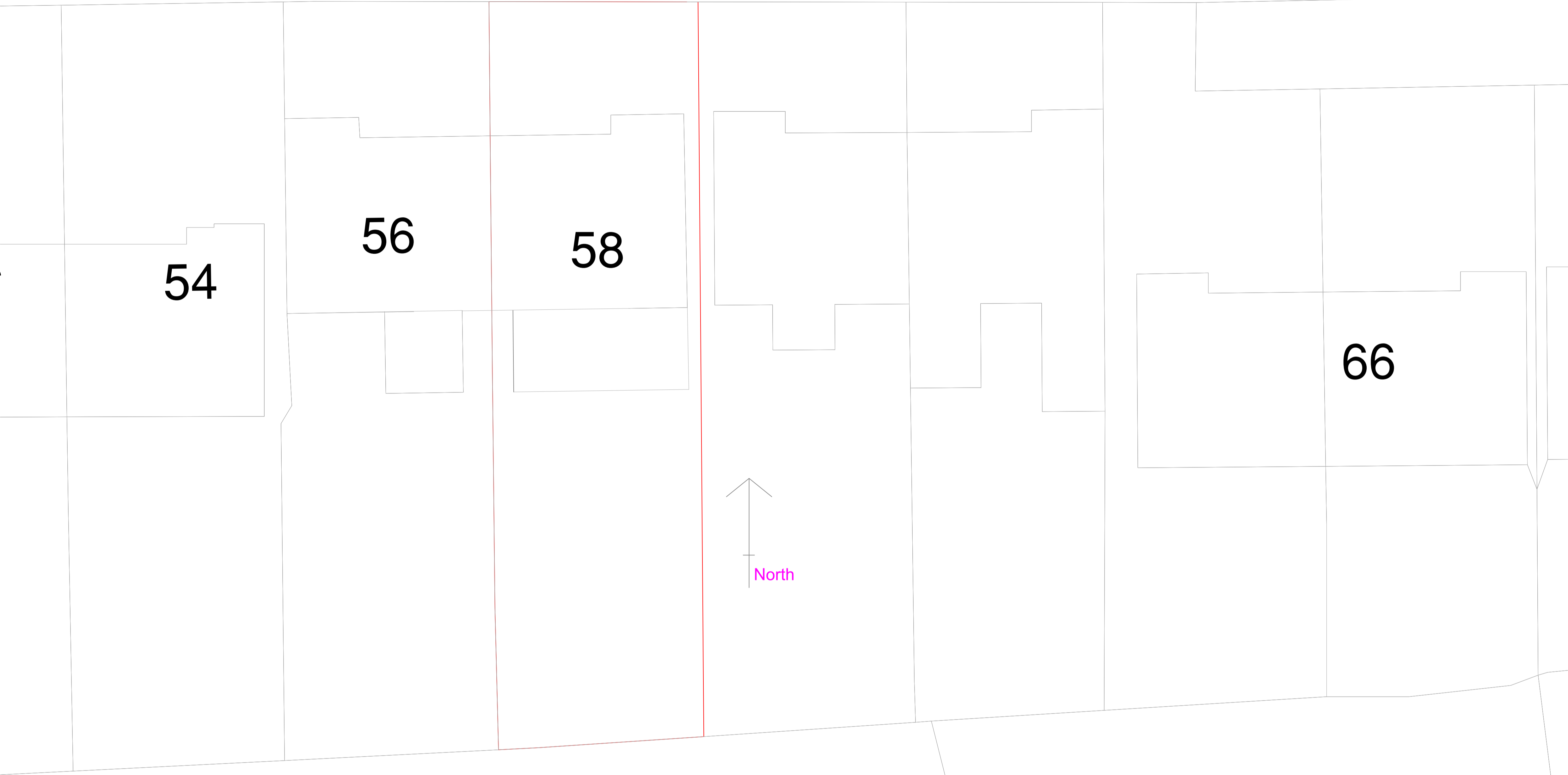

Existing Site Plan

--	--	--	--

Issue	Date	By	Checked
-------	------	----	---------

Drawing Status **Planning**

Plot ID

Scale **1:100** Date **September 2020**

Job No. **2012** Drawing No. **2012/03** Issue **-**

Project **58 Lombard Drive, Chester le Street**

Title **Site Plan**
7 Axwell Park School
Houses, Blaydon on
Tyne, Gateshead,
NE216RN
tel 07497098696

WKisharchitects