

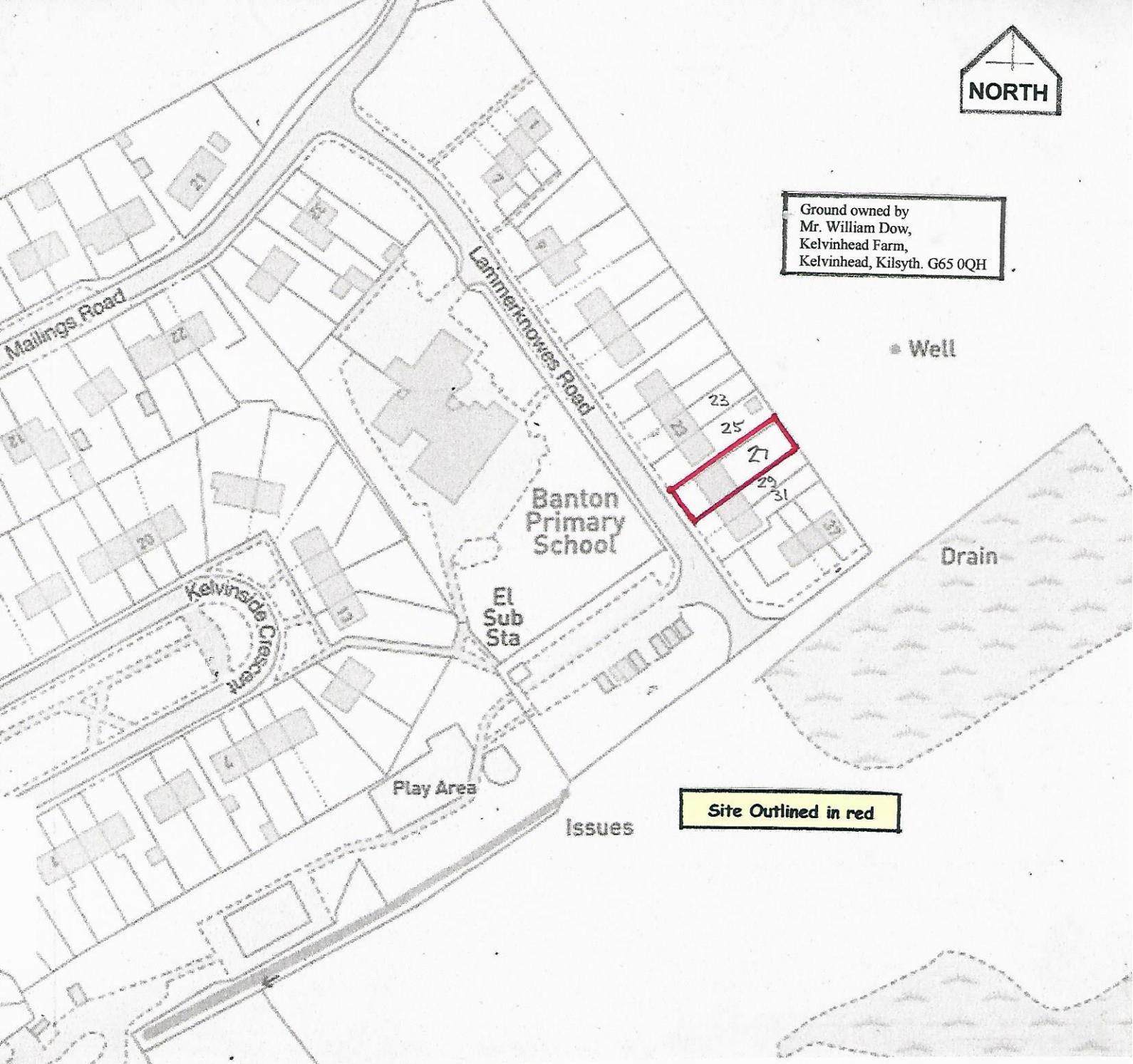

Ground owned by
Mr. William Dow,
Kelvinhead Farm,
Kelvinhead, Kilsyth. G65 0QH

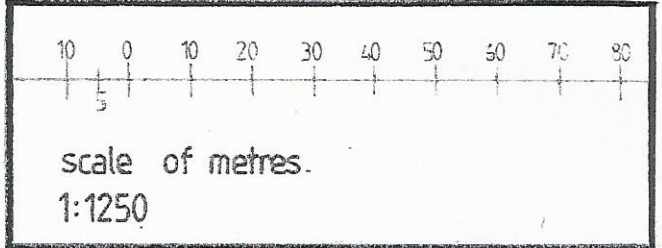

Site Outlined in red



Project Proposed New Front Porch Extension to House at 27 Lammerknowes Road, Banton. G65 0QT. for Mr. S. Walker.		Drawing <h1>LOCATION PLAN</h1>			ADR (Design) Ltd The Nurseries 5 Tak-Ma-Doon Road KILSYTH G65 0RS Telephone/Fax 01236 827749
Date 08:21	Scale 1:1250	Job No. 406	Drawing No. 406/02	Rev.	
Drawn By Dr					