

Existing Site Plan

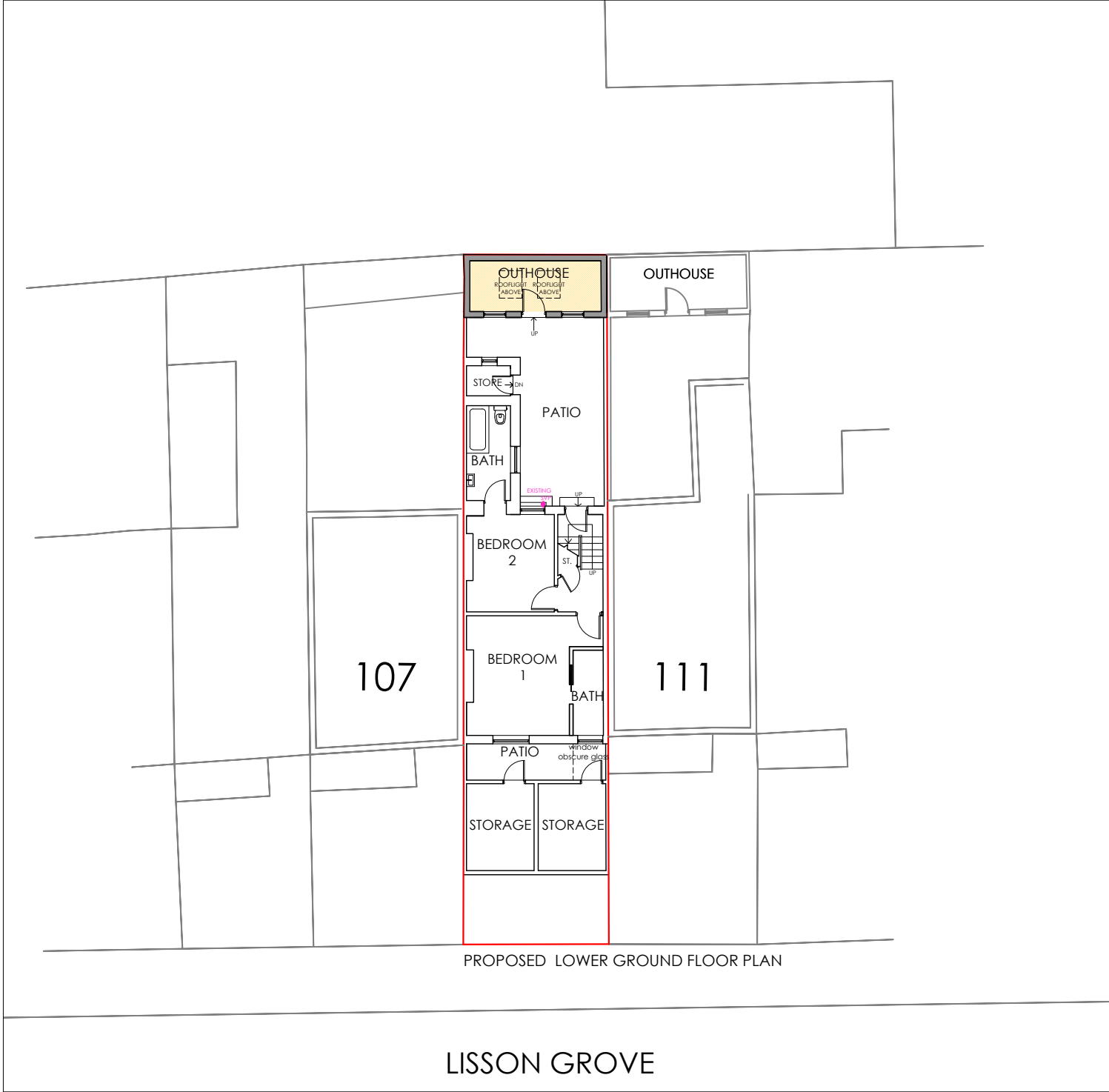

Proposed Site Plan

PROJECT	DWG NO.	SCALE	DETAIL	07.07.2021							PROJECT NO.	<div>PR Architecture Ltd. Chartered Architect</div> <div>120, Pinner Road, Harrow, HA1 4JD. Tel: 0208 357 2304</div>
109 LISSON GROVE, LONDON, NW1 6UP	01	1:200 @ A3	EXISTING AND PROPOSED SITE PLANS	SUBMITTED TO PLANNING							16.51	
SITE PLANS												