



Front Elevation



Front Elevation



Side Elevation



Rear Elevation



Rear Elevation

7 windows to be replaced in total.
 Existing windows are white painted timber, sliding sash.
 Proposed windows are white woodgrain, PVCU, tilt & turn, double glazed, toughened sealed units.
 Examples of PVCU casement windows exist on Stafford House, Balkeach Street, which is a C Listed Building within the conservation area.
 Examples of PVCU tilt & turn windows exist on Emlea, Balkeach Street which is a non listed building within the conservation area.

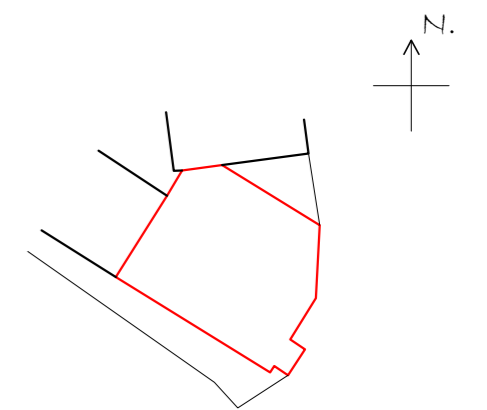

Site Plan
1:500

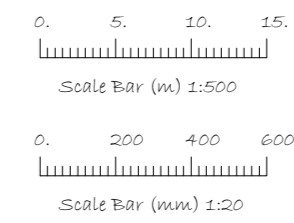
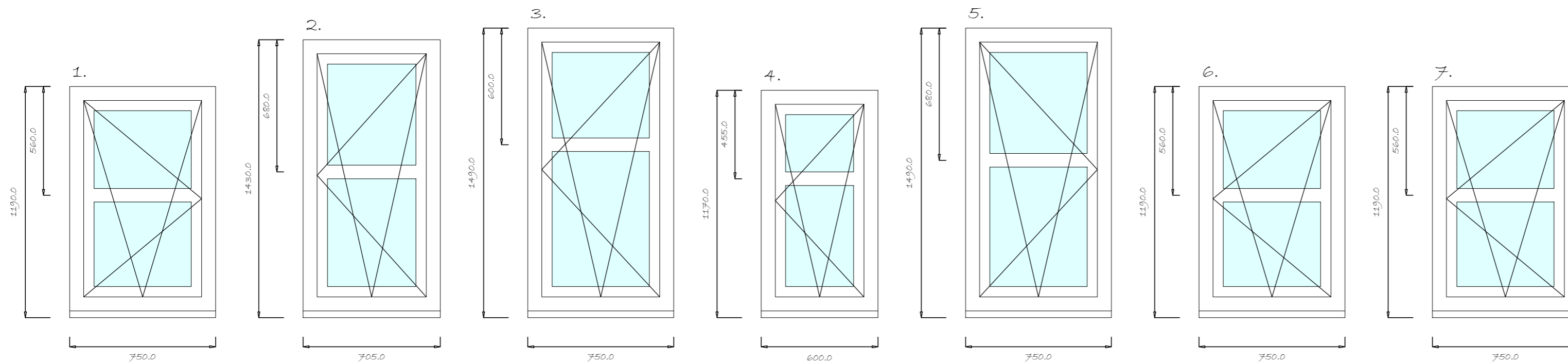

Mrs. H. Lockhart,
29B Balkeach Street,
Dunee, FK16 6DE.

Proposed Replacement Windows

Scale: 1:20 20/8/21

Ref: 30334066/1

John Gordon Associates Ltd.
3 Dean Acres,
Courie,
Fife, KY12 9XS
Tel: 01333 250 134
E-mail: gordonassociates@sky.com

Copyright of this drawing, and all other associated drawings, is owned by John Gordon Associates Ltd at the above address.