

490200E

SURVEY STATIONS				
Name	Easting	Northing	Height	Remark
A	490229.369	159889.551	105.195	Mark
B	490246.301	159918.659	105.394	Nail

08/07/2021

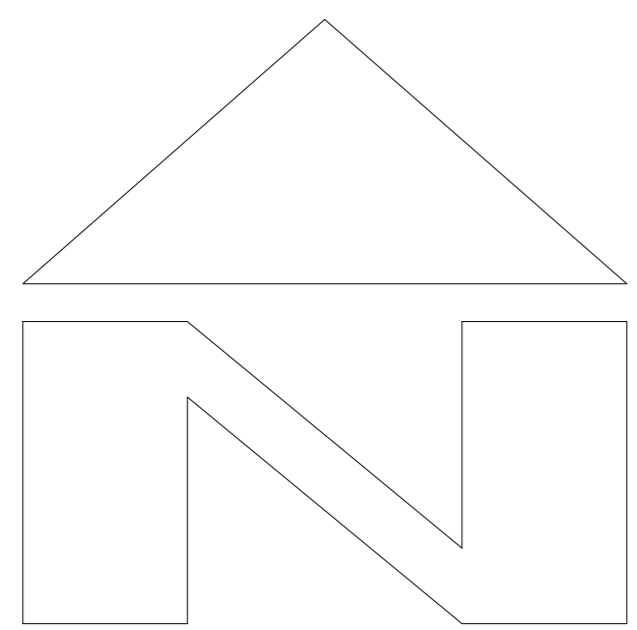

159900N

159900N

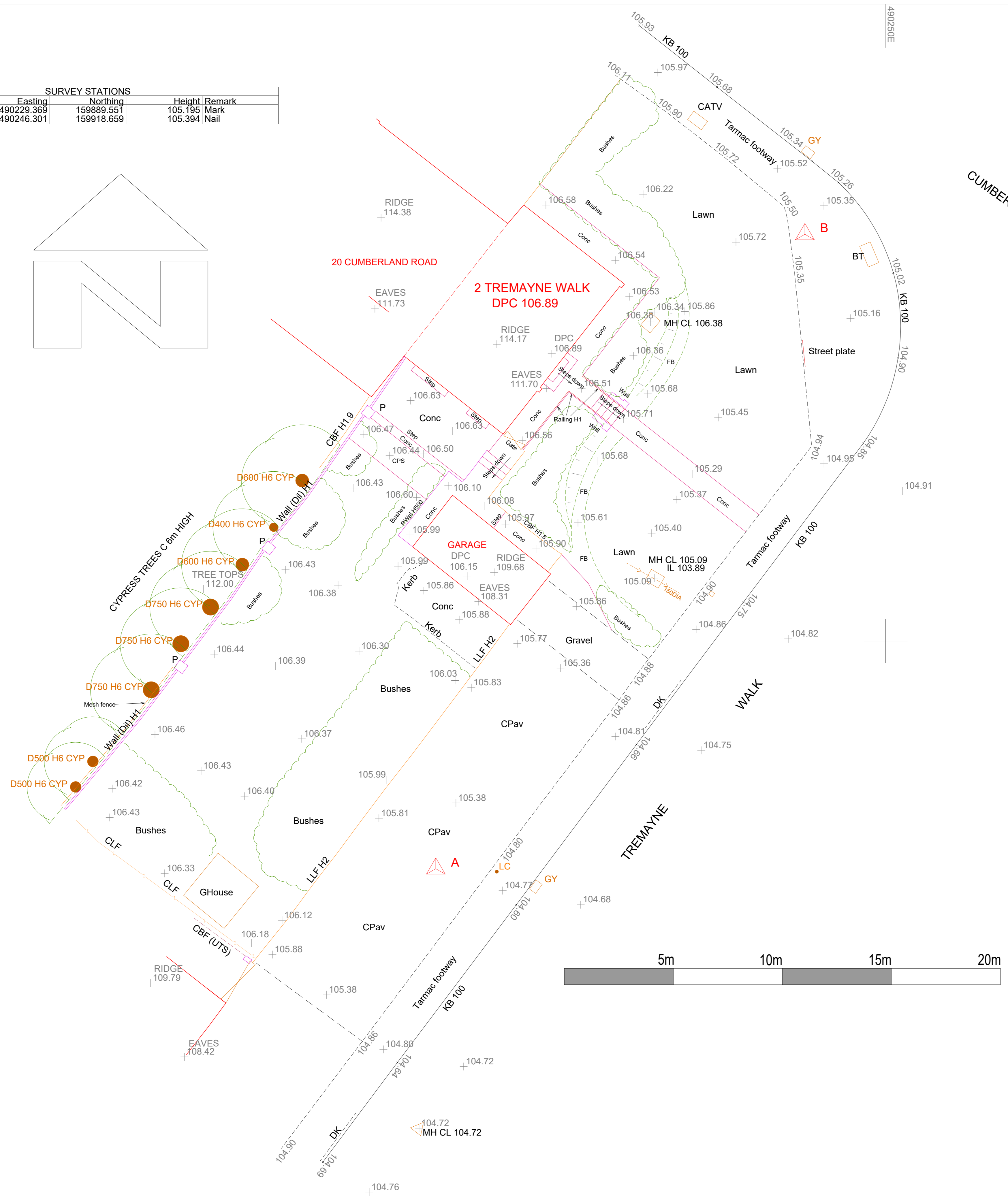

ABBREVIATIONS:  
 CATV = Cable TV  
 CBF = Crazy boarded fence  
 CLF = Chain link fence  
 CPav = Crazy paving  
 CPS = Concrete paving slabs  
 DK = Dropped kerb  
 FB = Flower bed  
 GHouse = Greenhouse  
 LC = Lamp column  
 MH CL = Manhole/cover level  
 PMF = Post and mesh fence  
 P = Plaster  
 UTS = Unable to survey

TREES:  
 D = Trunk diameter  
 H = Height  
 CYP = Cypress  
 (Check with arboriculturalist for formal species identification)

- This survey has been orientated to the Ordnance Survey National Grid (OSGB36) via GNSS/GLONASS RTK observations. A true OS coordinate has been established at Station A. The scale factor of this survey is 1.0.
- All levels are orthometric heights related to the OSGB36 datum, computed using the Leica Smart Net RTK Network.
- Surveyed boundary features are not necessarily legal boundaries.
- Dimensions should not be scaled. All dimensions should be checked on site before any fabrication / construction.
- Copyright of all data produced by Trigon Survey & Investigation Ltd shall remain with Trigon Survey & Investigation Ltd unless otherwise specifically agreed.
- Information provided should not be altered or modified in any way. It should not be used for any purpose other than for which it was intended and should not be issued to other parties without prior agreement of Trigon Survey & Investigation Ltd.
- If the AutoCAD drawing is being read by any system other than AutoCAD it should be checked against a hard copy. Trigon Survey & Investigation Ltd cannot accept liability for omissions.
- No underground services, storage tanks etc. have been surveyed, except where indicated.



Rev A Date 10/08/21 Cypress tree canopies

Trigon Survey & Investigation Ltd Basingstoke, Hants, RG24 7AS Tel. 01256 352794 Mob.07864 269005 email: admin@trigonsurvey.co.uk Web:www.trigonsurvey.co.uk	Drg. No:	21-452/01 Rev A
	Date:	08/08/21
	Scale:	Scale 1 to 200 @ A1 Size
	Sheet:	1 of 1
<b>2 TREMAYNE WALK          CAMBERLEY, GU15 1AH          TOPOGRAPHICAL SURVEY</b>	Surveyed:	V.Snook
	Drawn:	V.Snook
	Checked:	V.Snook
Client: Mr P.Wentworth	Sheet size:	Sheet size A1

490200E

490250E

RIDGE +113.93

RIDGE +113.47 EAVES +111.42

EAVES +109.64

RIDGE +112.07

EAVES +109.98

EAVES +110.06

RIDGE +112.65

CUMBERLAND ROAD

WALK

TREMAYNE

20 CUMBERLAND ROAD

2 TREMAYNE WALK  
DPC 106.89

GARAGE

GHouse

CYPRESS TREES C 6m HIGH

D500 H6 CYP

D750 H6 CYP

D750 H6 CYP

D600 H6 CYP

D600 H6 CYP

D400 H6 CYP

MH CL 104.72

MH CL 106.38

MH CL 105.09  
IL 103.89

RIDGE +114.17

RIDGE +114.38

EAVES +111.73

EAVES +111.70

EAVES +106.63

EAVES +106.44

EAVES +106.43

EAVES +106.43

EAVES +106.42

EAVES +106.43

EAVES +106.43

EAVES +106.42

EAVES +106.43

EAVES +106.43

EAVES +106.42

EAVES +106.42

EAVES +108.42

EAVES +108.42

EAVES +108.42

EAVES +108.42

EAVES +108.42

105.93 KB 100

106.11 +105.97

105.90 CATV

105.72 Tarmac footway

105.50 +105.35

105.35 BT

105.16 Street plate

104.94 KB 100

104.85 KB 100

104.95 KB 100

104.91 Tarmac footway

104.82 KB 100

104.86 S/L POU

104.82 DK

104.86 WALK

104.75 TREMAYNE

104.81 CPav

104.75 RIDGE

104.82 EAVES

104.86 RIDGE

104.72 MH CL 104.72

104.76 CPav

104.72 MH CL 104.72

104.76 CPav

104.72 MH CL 104.72

104.76 CPav

104.72 MH CL 104.72

104.76 CPav