

NORTH

SCALE

0 1.0 2.0 3.0m

0 2 4 6 8 10ft

REV.	DESCRIPTION	DATE

STATION ROAD

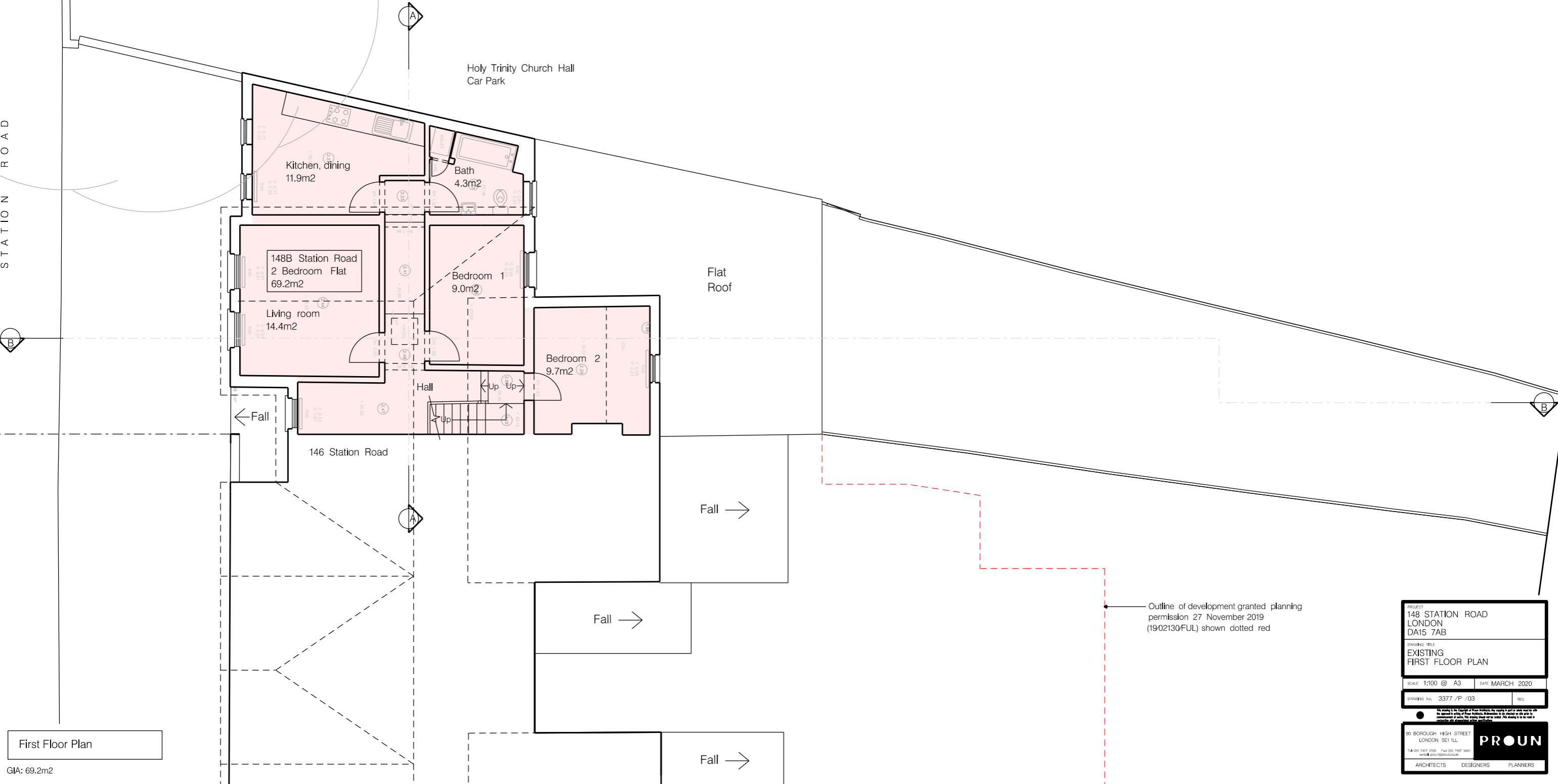

First Floor Plan

GIA: 69.2m<sup>2</sup>

Outline of development granted planning permission 27 November 2019 (1902130FUL) shown dotted red

PROJECT	
148 STATION ROAD LONDON DA15 7AB	
DRAWING TITLE	
EXISTING FIRST FLOOR PLAN	
SCALE 1:100 @ A3	DATE MARCH 2020
DRAWING No. 3377 /P /03	REV.
<small>We warrant to the Council of First Applicants, the validity to permit of any use for the development in accordance with the approved planning permission. We warrant to the Council of First Applicants, the validity to permit of any use for the development in accordance with the approved planning permission.</small>	
90 BOROUGH HIGH STREET LONDON SE1 1LL <b>PROUN</b> <small>144 0207 7417 3700 Fax 0207 7417 3800 www.proun.co.uk</small>	
ARCHITECTS	DESIGNERS PLANNERS