

NORTH

SCALE

REV.	DESCRIPTION	DATE

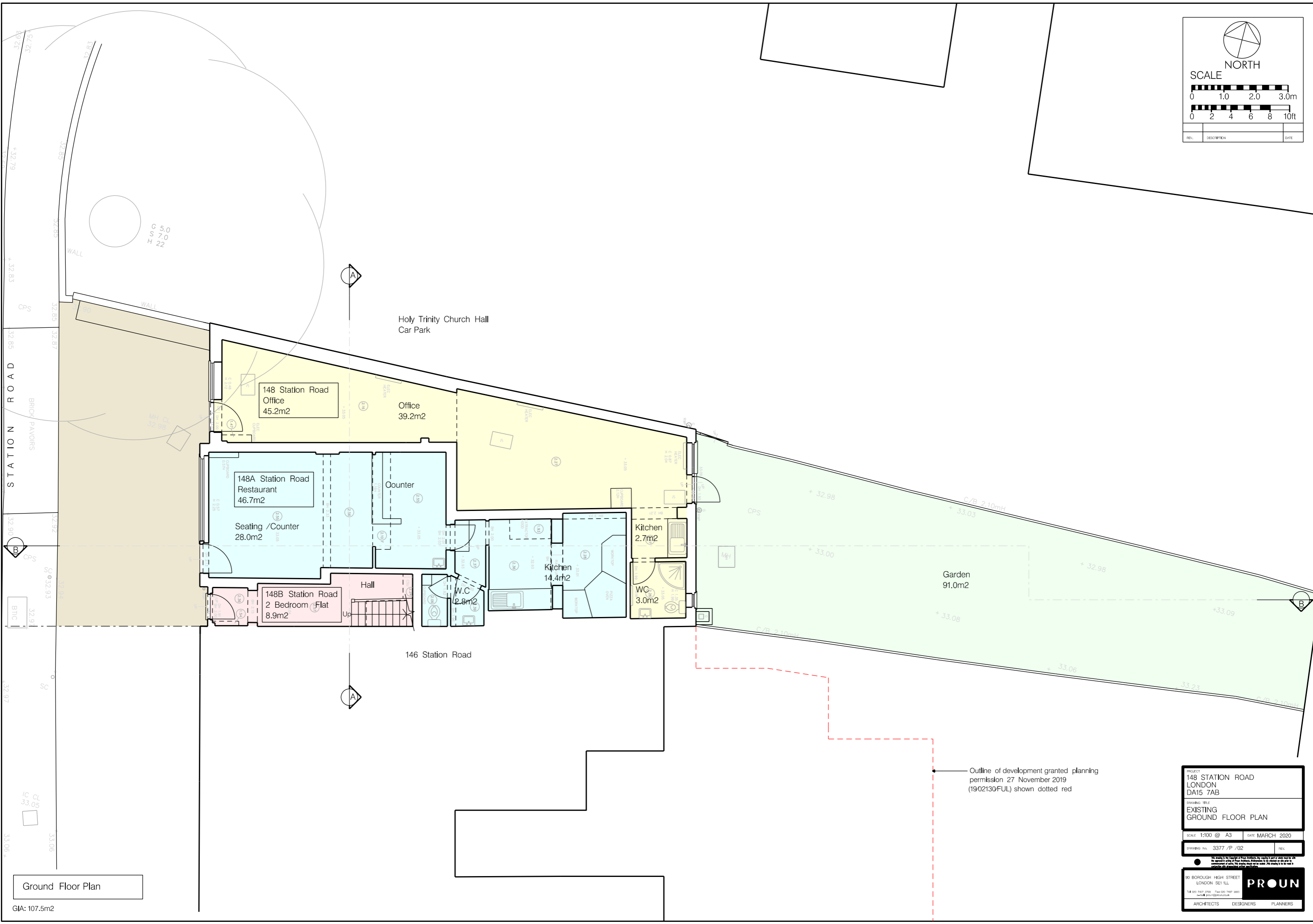

Ground Floor Plan

GIA: 107.5m²

Outline of development granted planning permission 27 November 2019 (1902130FUL) shown dotted red

PROJECT
148 STATION ROAD
LONDON
DA15 7AB

DRAWING TITLE
EXISTING
GROUND FLOOR PLAN

SCALE 1:100 @ A3 DATE MARCH 2020

DRAWING No. 3377 /P /02 REV.

We warrant to the Council of First Applicants, the validity to permit and use for the site in accordance with the planning permission. We warrant to the Council of First Applicants, the validity to permit and use for the site in accordance with the planning permission. We warrant to the Council of First Applicants, the validity to permit and use for the site in accordance with the planning permission.

90 BOROUGH HIGH STREET
LONDON SE1 1LL

144 0202 7417 3700 Fax 0202 7417 3800
www.proun.co.uk

PROUN
ARCHITECTS DESIGNERS PLANNERS