

NORTH

SCALE

0 1.0 2.0 3.0m

0 2 4 6 8 10ft

REV.	DESCRIPTION	DATE

STATION ROAD

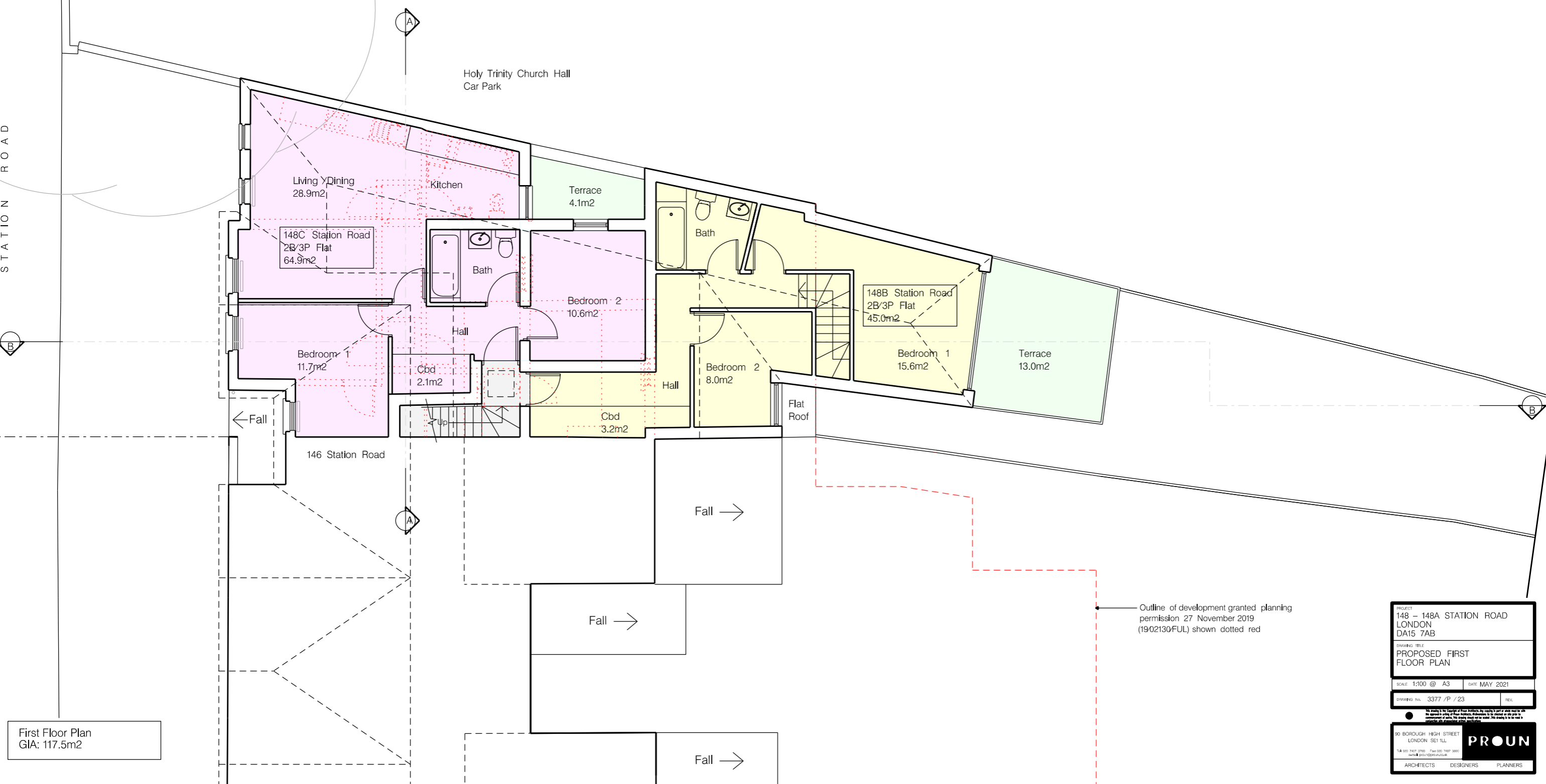

First Floor Plan
GIA: 117.5m²

Outline of development granted planning permission 27 November 2019 (1902130FUL) shown dotted red

PROJECT
148 - 148A STATION ROAD
LONDON
DA15 7AB

DRAWING TITLE
PROPOSED FIRST FLOOR PLAN

SCALE 1:100 @ A3 DATE MAY 2021

DRAWING No. 3377 / P / 23

90 BOROUGH HIGH STREET
LONDON SE1 1LL

148 020 7437 3700 Fax 020 7437 3800
www.prounplanning.com

PROUN
ARCHITECTS DESIGNERS PLANNERS