

NOTE:  
ALL EXISTING LINTOLS TO REAR WALL TO BE INSPECTED & CONFIRMED SUITABLE BY L.A TO TAKE ADDITIONAL LOADS.

ALL NEW WALLS TO BE TIED TO EXISTING USING 'FURFIX' STAINLESS STEEL CHANNEL SYSTEM BOLTED DIRECTLY TO BRICKWORK.

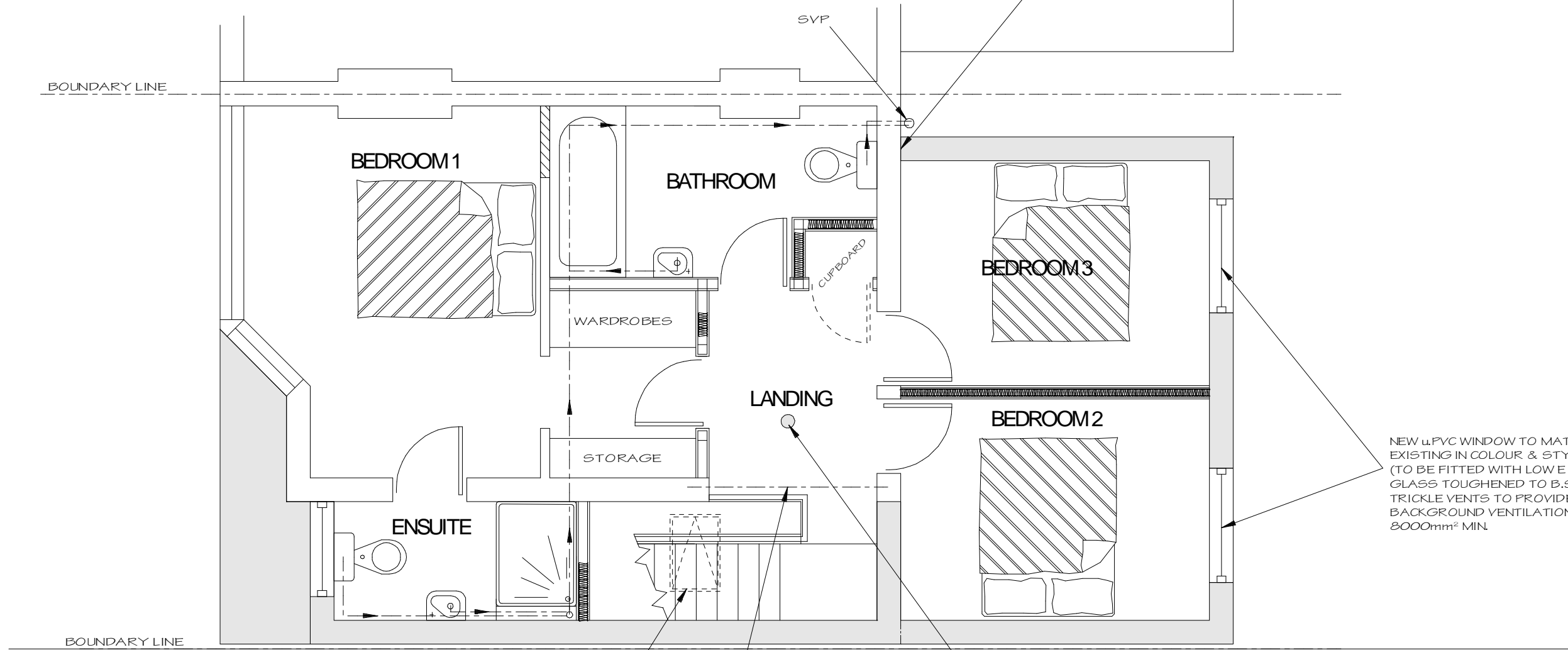

NEW uPVC WINDOW TO MATCH EXISTING IN COLOUR & STYLE. (TO BE FITTED WITH LOW E SAFETY GLASS TOUGHENED TO B.S 6206) TRICKLE VENTS TO PROVIDE BACKGROUND VENTILATION 8000mm² MIN.

ROOFLIGHT ABOVE STAIR WELL

MANS SMOKE ALARM ON INDEPENDANT CIRCUIT

FORM LARGER OPENING TO LANDING AREA WITH LINTOL ABOVE

**PROPOSED FIRST FLOOR**

TRAY DPC OVER GALV. M.S.CATNIC LINTOL (CN81) OVER OPENINGS.TYPICAL 150 MIN.END BEARING ← ALL CATNIC LINTOLS TO BE INSULATED.



**TWO STOREY EXTENSION TO SIDE & REAR AT 53 CLINTON AVENUE WELLING KENT DA16 2DY FOR MISS S ALLINGTON & MR. J .BINGHAM**



SCALE 1:50  
DATE JUNE 2021  
DRG.No DH21/117/03

REV. A