

NOTE:  
ALL EXISTING LINTOLS TO REAR WALL TO BE INSPECTED & CONFIRMED SUITABLE BY L.A TO TAKE ADDITIONAL LOADS.

NOTE:  
THERE WILL BE NO ENCROACHMENT ONTO NEIGHBOURING PROPERTY

ALL NEW WALLS TO BE TIED TO EXISTING USING 'FURFIX' STAINLESS STEEL CHANNEL SYSTEM BOLTED DIRECTLY TO BRICKWORK.

OUTLINE OF ADJACENT EXTENSION

BOUNDARY LINE

BOUNDARY LINE

LOUNGE

FAMILY ROOM

KITCHEN

PORCH

HALL

WC

EX. MANHOLE  
I.L - 0.600 (APPROX)

SVP

NEW BI-FOLD WINDOW TO MATCH EXISTING IN COLOUR & STYLE.  
(TO BE FITTED WITH LOW E SAFETY GLASS TOUGHENED TO B.S 6206)  
TRICKLE VENTS TO PROVIDE BACKGROUND VENTILATION  
3000mm<sup>2</sup> MIN.

MAINS SMOKE ALARM ON INDEPENDANT CIRCUIT

EX. MANHOLE  
I.L - 0.500 (APPROX)

PROPOSED GROUND FLOOR

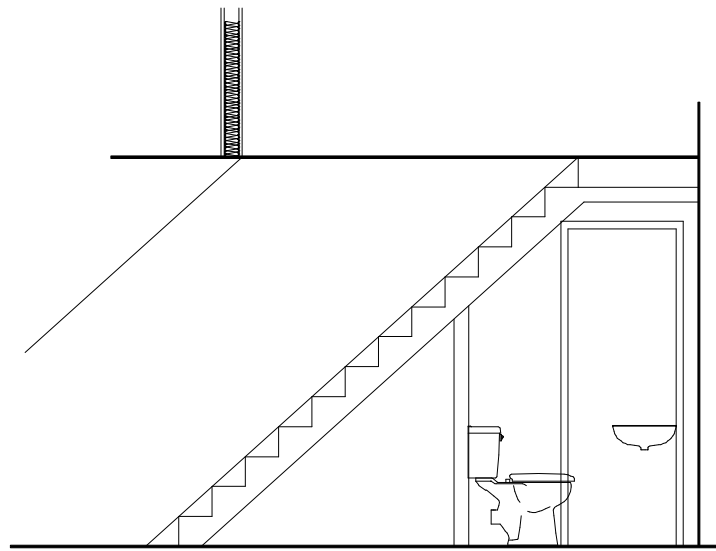

UNDERSTAIR WC



**TWO STOREY EXTENSION  
TO SIDE & REAR AT  
53 CLINTON AVENUE  
WELLING  
KENT DA16 2DY  
FOR MISS S ALLINGTON & MR. J .BINGHAM**



SCALE 1:50  
DATE JUNE 2021  
DRG.No DH21/117/02

REV. A