

AL-SECTION A-A - LONGSECTION
SCALE: H 1:500, V 1:100. DATUM: 13.000

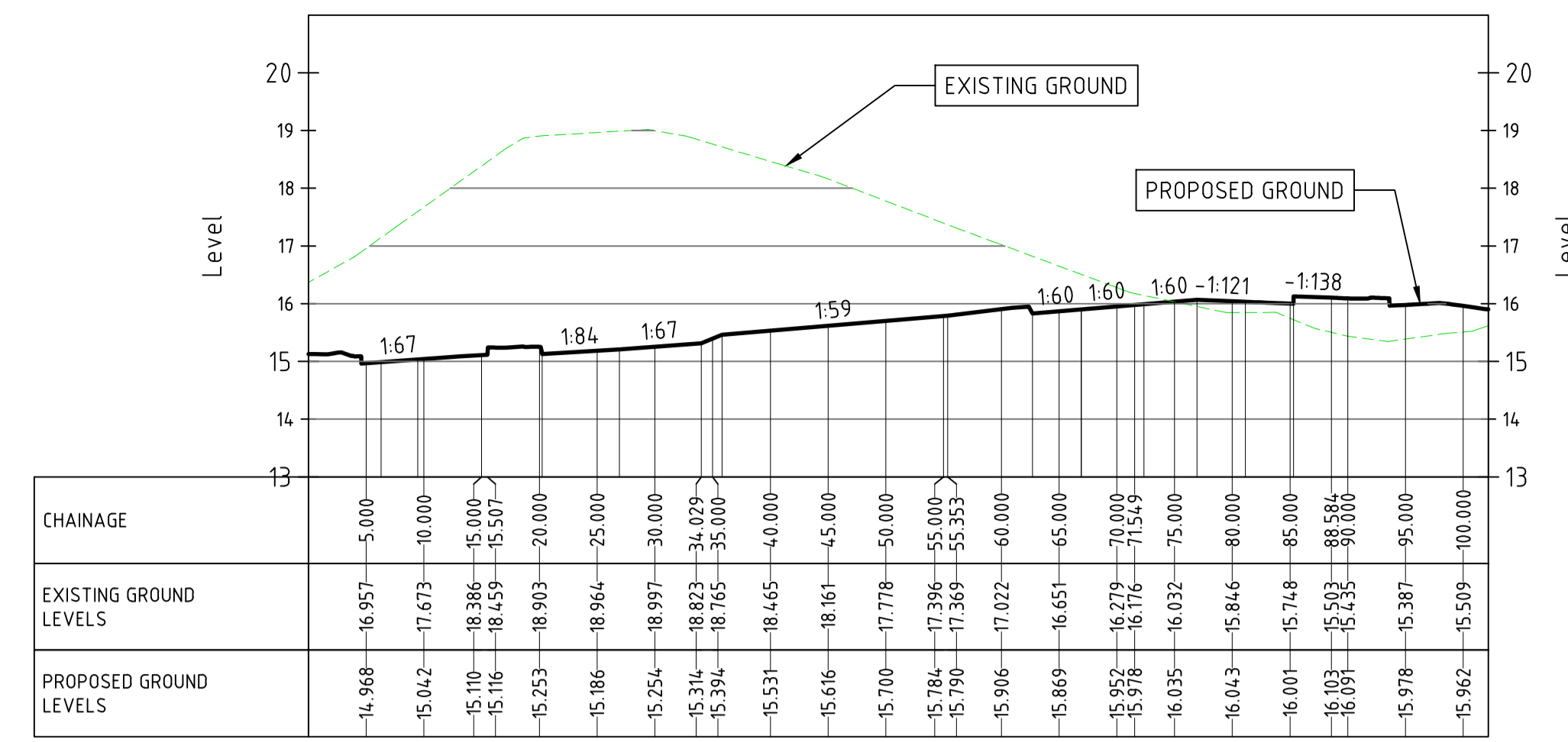

AL-SECTION C-C - LONGSECTION
SCALE: H 1:500, V 1:100. DATUM: 13.000

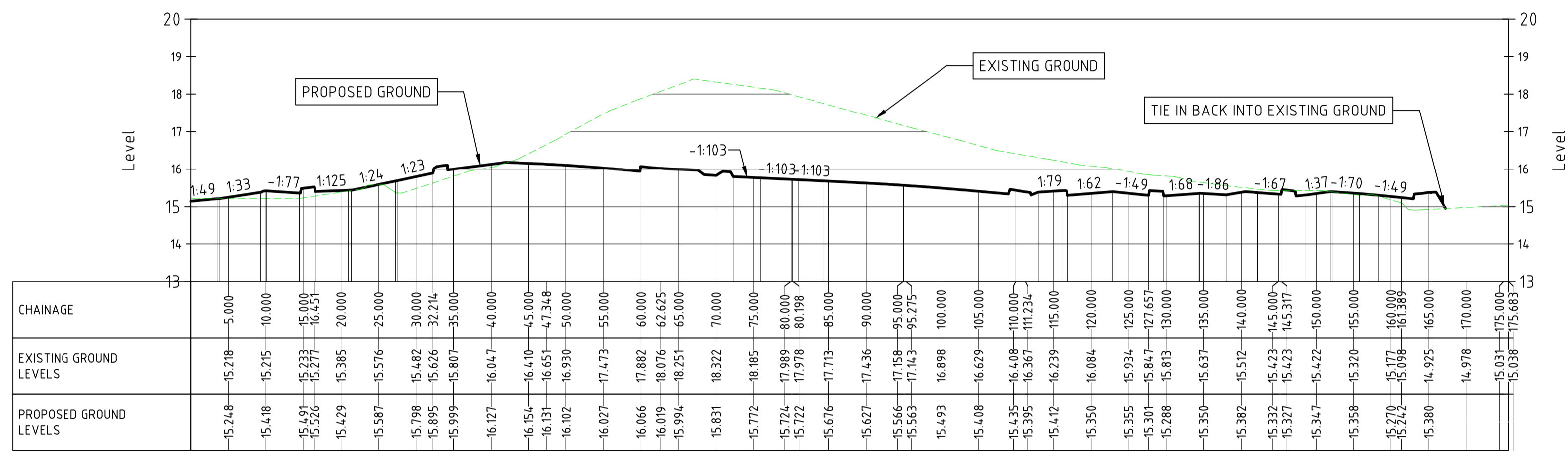

AL-SECTION B-B - LONGSECTION
SCALE: H 1:500, V 1:100. DATUM: 13.000

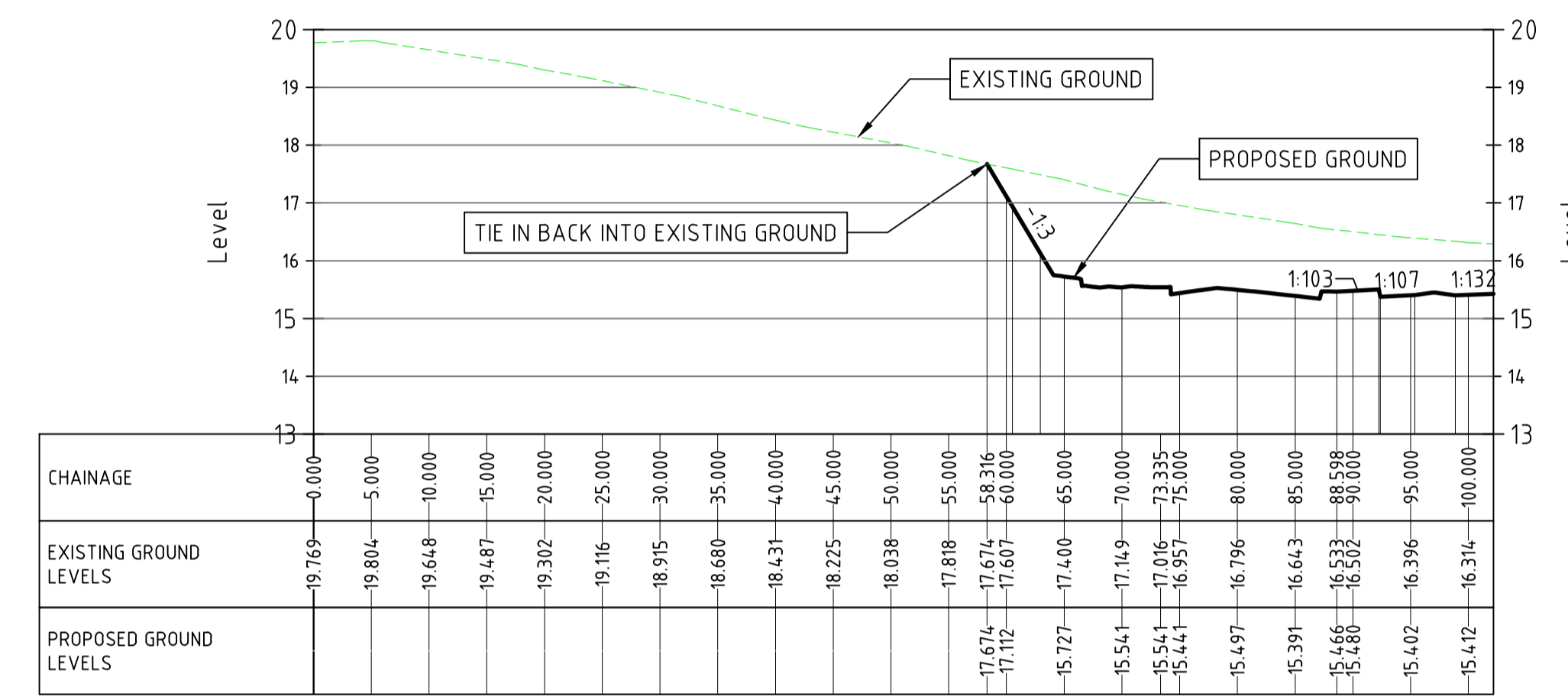

AL-SECTION D-D - LONGSECTION
SCALE: H 1:500, V 1:100. DATUM: 13.000

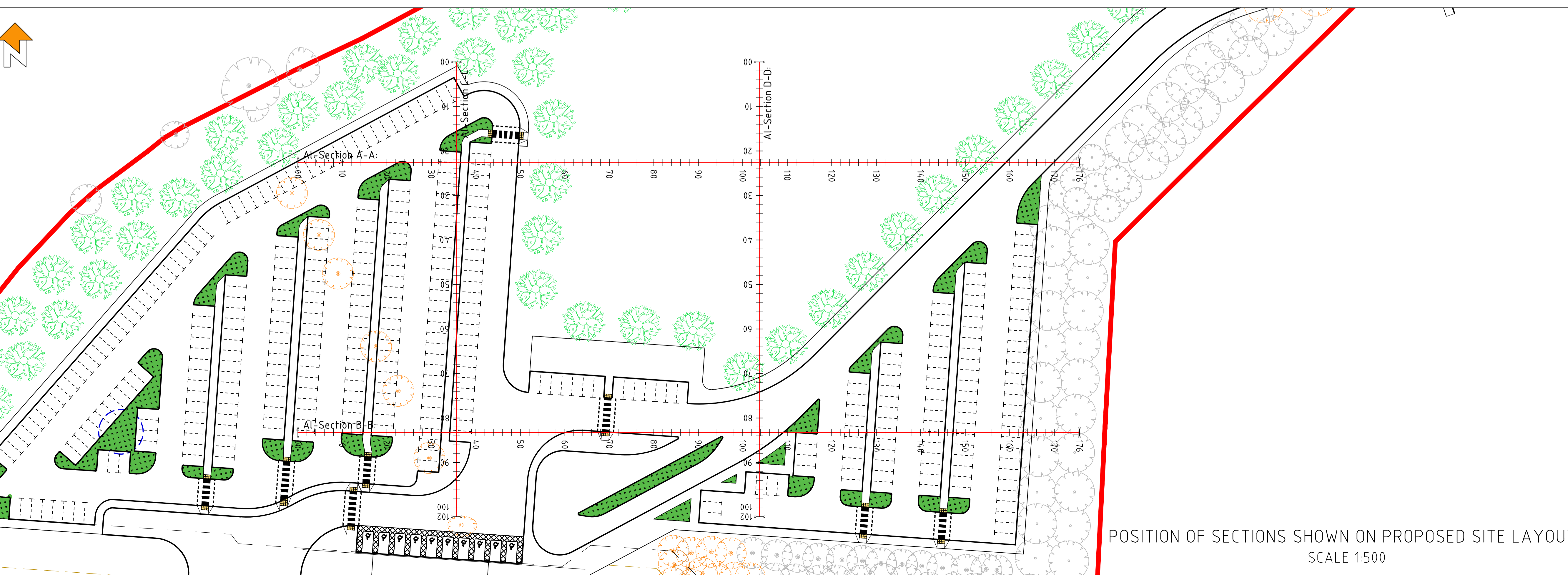

Do not scale from drawings. Verify all dimensions on site prior to construction. This drawing is to be read in conjunction with all relevant documents and drawings. Report all discrepancies to MoJ immediately.

No unauthorised use, disclosure, storage or copying.

Residual Risk
This symbol identifies a Residual Risk that is recorded on the Design Risk Register and is relevant to this drawing.

Derogation
This symbol identifies a Derogation that is recorded on the Derogation Schedule and is relevant to this drawing.

The above symbols can only be read when this drawing is in colour print.

KEY
PROPOSED SITE BOUNDARY

Rev	Date	Description
P01	2021.06.30	FIRST ISSUE FOR RMA

Project Status
RIBA Stage 3

Client
Ministry of Justice

Project
New Prisons Programme

Ministry of Justice, 102 Petty France, London, SW1H 9AJ

Project Description / Site
New Prisons Programme
Full Sutton 2

Project Address
Land at Moor Lane
Full Sutton
York, YO41 1PS

Building Type
Site Infrastructure

Drawing Title
Proposed Earthworks-Mound Sections

Originator Logo PICK EVERARD	Drawn By MHA	Date 30.06.21
	Checked By PCA	Date 30.06.21
	Approved By PCA	Date 30.06.21
Drawing Number 664015-1275-PEV-FNC0011-ZZ-DR-C-0604	Delref D0100	
Sheet No. 01 of 01	Scale AS SHOWN	Orig. Sheet Size @ A1
Data Security Classification OFFICIAL	Rev. P01	Suitability S3