



This symbol identifies a Residual Risk that is recorded on the Design Risk Register and is relevant to this drawing.

This drawing must be read in conjunction with the following project CDM documents:
664015-1275-PEV-FNC0011-XX-HS-C-0003_Design Risk Assessment-Stage 3

This symbol identifies a Derogation that is recorded on the Derogation Schedule and is relevant to this drawing.

This drawing must be read in conjunction with the following project Derogation documents:
N/A

The above symbols can only be read when this drawing is in colour print

SW DRAINAGE SHEET 01 664015-1275-PEV-FNC0011-ZZ-DR-C-0551	SW DRAINAGE SHEET 02 664015-1275-PEV-FNC0011-ZZ-DR-C-0552	SW DRAINAGE SHEET 03 664015-1275-PEV-FNC0011-ZZ-DR-C-0553	SW DRAINAGE SHEET 04 664015-1275-PEV-FNC0011-ZZ-DR-C-0554	SW DRAINAGE SHEET 05 664015-1275-PEV-FNC0011-ZZ-DR-C-0555
SW DRAINAGE SHEET 06 664015-1275-PEV-FNC0011-ZZ-DR-C-0556	SW DRAINAGE SHEET 07 664015-1275-PEV-FNC0011-ZZ-DR-C-0557	SW DRAINAGE SHEET 08 664015-1275-PEV-FNC0011-ZZ-DR-C-0558	SW DRAINAGE SHEET 09 664015-1275-PEV-FNC0011-ZZ-DR-C-0559	SW DRAINAGE SHEET 10 664015-1275-PEV-FNC0011-ZZ-DR-C-0560
SW DRAINAGE SHEET 11 664015-1275-PEV-FNC0011-ZZ-DR-C-0561	SW DRAINAGE SHEET 12 664015-1275-PEV-FNC0011-ZZ-DR-C-0562	SW DRAINAGE SHEET 13 664015-1275-PEV-FNC0011-ZZ-DR-C-0563	SW DRAINAGE SHEET 14 664015-1275-PEV-FNC0011-ZZ-DR-C-0564	SW DRAINAGE SHEET 15 664015-1275-PEV-FNC0011-ZZ-DR-C-0565

KEY PLAN
SCALE 1:5000

PRINT IN COLOUR

- NOTES:
- ALL DRAINAGE WORKS TO BE CONSTRUCTED TO DESIGN AND CONSTRUCTION GUIDANCE FOR FOUL AND SURFACE WATER SEWERS, BUILDING REGULATIONS PART H, MOJ TECHNICAL SPECIFICATION STD/X/SPEC/010 ISSUE 006 AND PICK EVERARD DRAINAGE SPECIFICATION.
 - ALL SEWERS AND DRAINS TO HAVE A CLASS Z BED AND SURROUND AT A DEPTH OF COVER TO PIPE SOFFIT OF LESS THAN 1.2m UNDER PAVED AREAS AND BUILDINGS AND 0.9m IN VERGE. IN ALL OTHER AREAS, ALL SEWERS AND DRAINS SHALL HAVE A CLASS S BED, UNLESS STATED OTHERWISE ON THE DRAWINGS.
 - ALL SEWERS TO BE BACKFILLED WITH TYPE 1 GRANULAR MATERIAL UNDER PAVED AREAS, ROADS AND HARDSTANDINGS OR AS-DUG MATERIAL IN VERGE AREAS.
 - MANHOLE COVERS AND FRAMES WITHIN VEHICULAR LOADED AREAS TO BE D400 RATED AND C250 IN ALL OTHER AREAS TO BS EN 124-1994. ALL COVERS TO BE DUCTILE IRON.
 - SVP LOCATIONS AND LATERALS ARE NOT SHOWN. TO BE CONFIRMED BY THE M&E ENGINEER AT THE DETAIL DESIGN STAGE.
 - DRAINAGE SYSTEM TO BE SUBJECT TO INSPECTION INTERIM AND FINAL TESTS IN ACCORDANCE WITH MOJ TECHNICAL SPECIFICATION STD/X/SPEC/010 ISSUE 6 AND BS EN 75
 - ALL PIPEWORK:
 - VITRIFIED CLAY UP TO 225mm DIAMETER
 - OVER 225mm - CONCRETE TO BS EN 1916 AND 1911
 - BELOW CONCRETE FLOOR SLABS - CAST IRON TO BS 43 OR DUCTILE IRON TO BS 598
 - SAMPLE CHAMBER TO BE BUILT DOWNSTREAM OF DOG KENNELS
 - ALL SOLID DOG FAECES TO BE REMOVED AND DISPOSED OF APPROPRIATELY BEFORE ENTERING INTO THE FOUL DRAINAGE SYSTEM
 - FOUL WATER STRATEGY IS SUBJECT TO YORKSHIRE WATER APPROVAL. FOR DETAILS REFER TO FOUL WATER DRAINAGE STRATEGY REPORT
664015-1275-PEV-FNC0011-ZZ-RP-C-0553

KEY:

- PROPOSED GRAVITY FOUL SEWER.
- PROPOSED FW RISING MAIN.
- MoJ PROPERTY LINE.
- FW ACCESS CHAMBER.
- EXISTING FW CHAMBER.
- EXISTING YW FW SEWER.
- EXISTING RISING MAIN FW SEWER.

P02	2021.06.03	SITE LAYOUT UPDATED.
P01	2021.03.16	FIRST ISSUE FOR RIBA STAGE 3 APPROVAL.
Rev	Date	Description

Project Status
RIBA Stage 3

Client Project
Ministry of Justice **New Prisons Programme**
Ministry of Justice, 102 Petty France, London, SW1H 9AJ

Project Description / Site
New Prisons Programme
Full Sutton 2

Project Address
Land at Moor Lane
Full Sutton
York, YO41 1PS

Building Type
Site Infrastructure

Drawing Title
Proposed Foul Water Drainage-Sheet 01

Originator Logo	Drawn By	NKN	Date	16.03.21
	Checked By	PCA	Date	16.03.21
	Approved By	PCA	Date	16.03.21

Drawing Number
664015-1275-PEV-FNC0011-ZZ-DR-C-0551 Delref
D0100

Sheet No.	Scale	Orig. Sheet Size	Rev.
01 of 11	1:250; 1:5000	@ A1	P02

Data Security Classification
OFFICIAL Suitability
S3

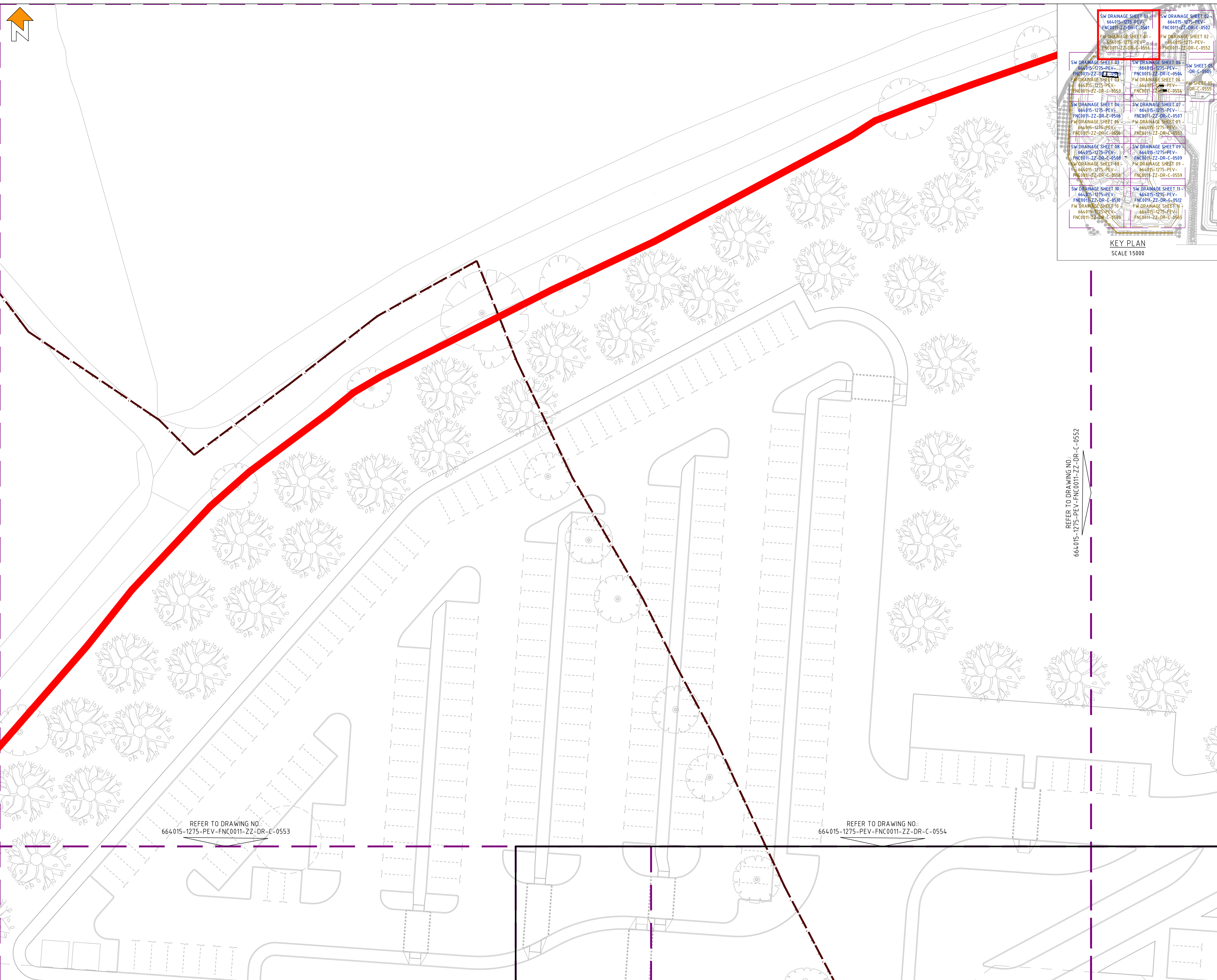

REFER TO DRAWING NO:
664015-1275-PEV-FNC0011-ZZ-DR-C-0552

REFER TO DRAWING NO:
664015-1275-PEV-FNC0011-ZZ-DR-C-0553

REFER TO DRAWING NO:
664015-1275-PEV-FNC0011-ZZ-DR-C-0554