

# OFFICE 5

## KEY

- ○ ○ Spots on Tracks
- ⊙ Single Pendant Light
- ▬ Pendant Linear Track
- ▨ LED Wall mounted
- Wall mounted light
- ⤴ One way switch
- ⤴<sup>2</sup> Two way switch
- ⚡ Double 13A switched socket
- ⤴ Manual Call Point

### General Notes:

- Do not scale from this drawing - All dimensions shown are indicative and are to be checked on site by contractor
- This drawing must be read in conjunction with all consultants drawings, architectural specifications and schedules
- All construction materials and workmanship are to be in accordance with the building regulation codes and the relevant current standards
- Contractors must verify all dimensions on site prior to the commencement of any works, ordering of materials or the preparation of shop drawings
- Any modifications to the setting out made by the contractor shall be confirmed through the architect
- Any discrepancies, errors or omissions in these drawings or specification shall be conveyed to the architect before proceeding
- All electrical & mechanical works to comply with the relevant authorities and standards and read in conjunction with The Design Collectives drawings and specification



EXISTING OFFICE 5 PHOTOGRAPH

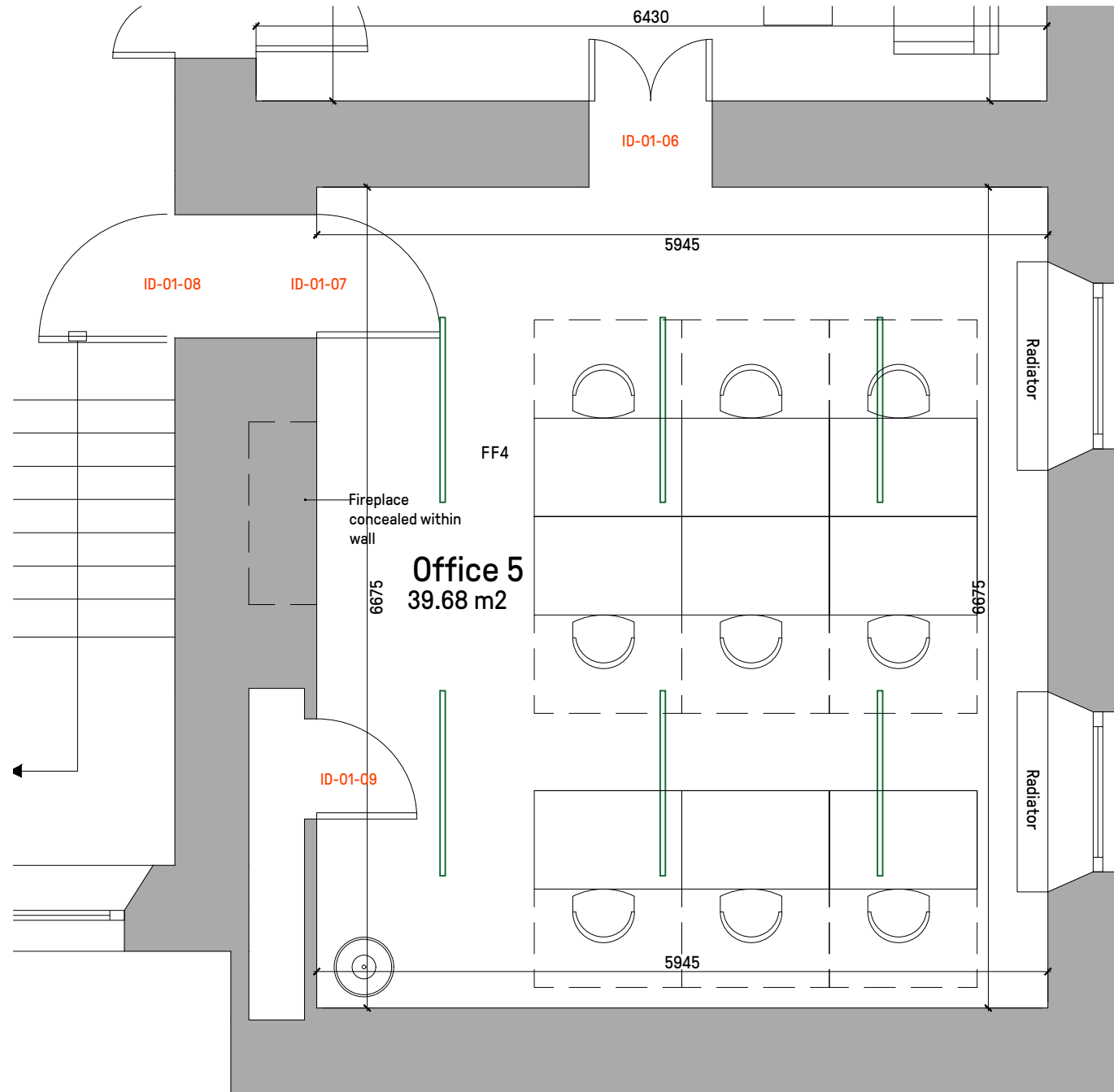

- Do not scale from this drawing, except for planning purposes.
- Check all dimensions on site.
- Subject to survey.
- Subject to site inspection.
- Site boundary lines are indicative only.

Rev	Date	By	Description
A	19.07.2021	DR	Revised Dimensions following Survey

Revision Schedule

project  
**TYTTENHANGER HOUSE  
ST ALBANS  
AL4 OPF**

title  
**OFFICE 5  
PROPOSED LAYOUT**

sheet number  
**425**

drawing status  
**TENDER**

contract no. client ref.

scale 1:50 @ A3	date JUNE 21	drawn by DR	checked by CG
project no. P18-205	drawing number 425	revision A	originator-zone-level-type-role-sheet number



Level 2 Irongate House  
30 Dukes Place  
London EC3A 7LP

T: +44 (0)20 7539 1200  
E: hq@cgluk.com  
www.cgluk.com

