

OFFICE 4

General Notes:

- Do not scale from this drawing - All dimensions shown are indicative and are to be checked on site by contractor
- This drawing must be read in conjunction with all consultants drawings, architectural specifications and schedules
- All construction materials and workmanship are to be in accordance with the building regulation codes and the relevant current standards
- Contractors must verify all dimensions on site prior to the commencement of any works, ordering of materials or the preparation of shop drawings
- Any modifications to the setting out made by the contractor shall be confirmed through the architect
- Any discrepancies, errors or omissions in these drawings or specification shall be conveyed to the architect before proceeding
- All electrical & mechanical works to comply with the relevant authorities and standards and read in conjunction with The Design Collectives drawings and specification

KEY

- ○ ○ Spots on Tracks
- ⊕ Single Pendant Light
- ▬ Pendant Linear Track
- ▨ LED Wall mounted
- Wall mounted light
- ⤴ One way switch
- ⤴² Two way switch
- ⚡ Double 13A switched socket
- 📞 Manual Call Point



EXISTING OFFICE 4 PHOTOGRAPH

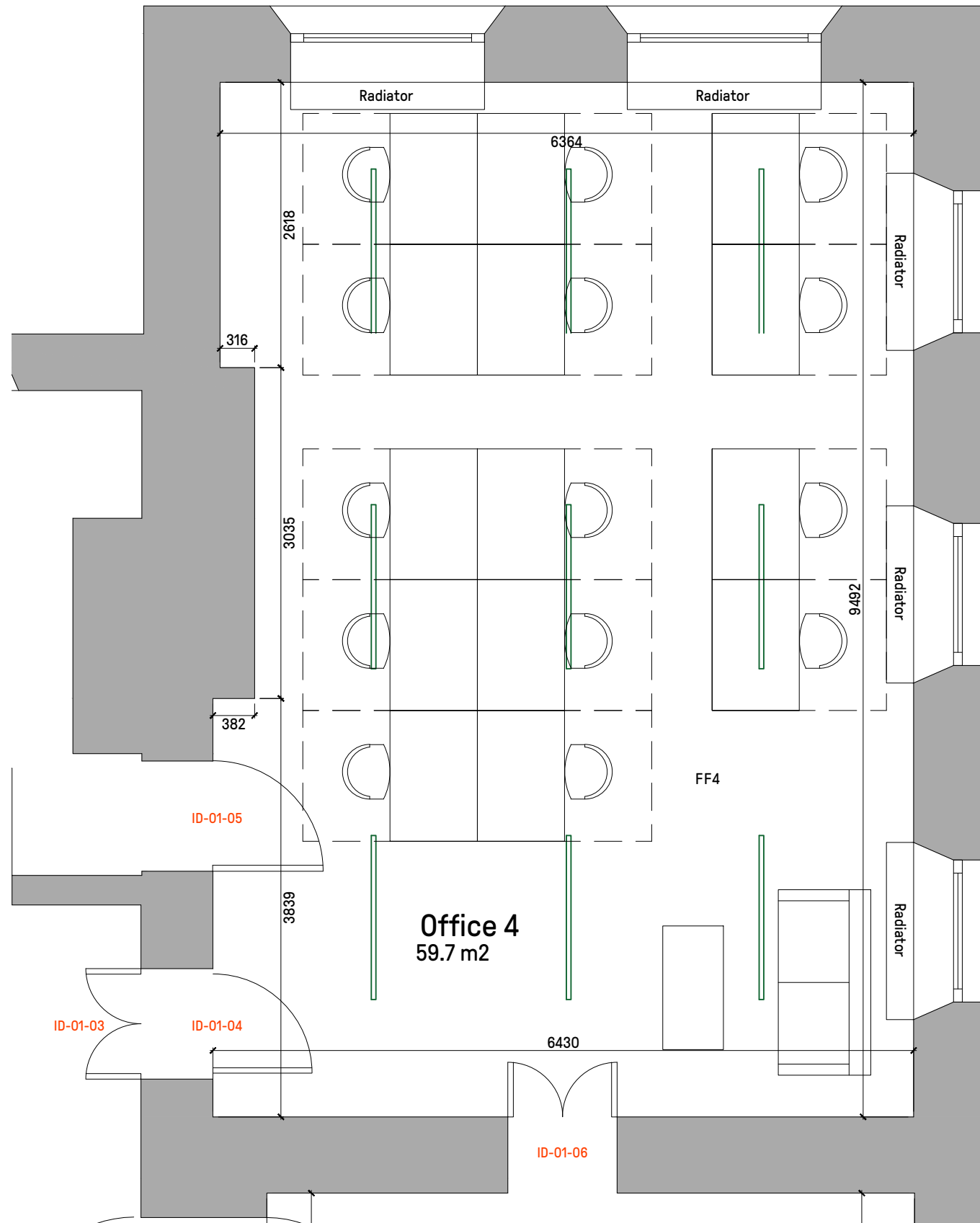

- Do not scale from this drawing, except for planning purposes.
- Check all dimensions on site.
- Subject to survey.
- Subject to site inspection.
- Site boundary lines are indicative only.

Rev	Date	By	Description
Revision Schedule			

project
**TYTTENHANGER HOUSE
 ST ALBANS
 AL4 OPF**

title
**OFFICE 4
 PROPOSED LAYOUT**

sheet number
423

drawing status
TENDER

contract no. client ref.

scale 1:50 @ A3	date JUNE 21	drawn by DR	checked by CG
project no. P18-205	drawing number 423	revision -	originator-zone-level-type-role-sheet number



Level 2 Irongate House
 30 Dukes Place
 London EC3A 7LP
 T: +44 (0)20 7539 1200
 E: hq@cgluk.com
 www.cgluk.com