

NOTES: 1. Do not scale off this drawing unless a scale bar is provided. 2. Any ambiguities, omissions and errors on this drawing should be notified immediately to the Architect before the commencement of works on site. 3. Dimensions are in millimetres unless otherwise stated. 4. Dimensions, unless otherwise indicated, are to the face of unfinished block walls or to the finished plaster face of stud partitions. 5. Dimensions are to be checked on site. Discrepancies are to be notified immediately to the Architect before the commencement of works on site. 6. All levels are in meters unless otherwise stated. 7. This drawing is to be read in conjunction with all other relevant drawings and specifications for this project. ! Denotes a significant hazard or difficult to manage procedure. Please refer to Designer Hazard Register for further information regarding mitigation of hazards.

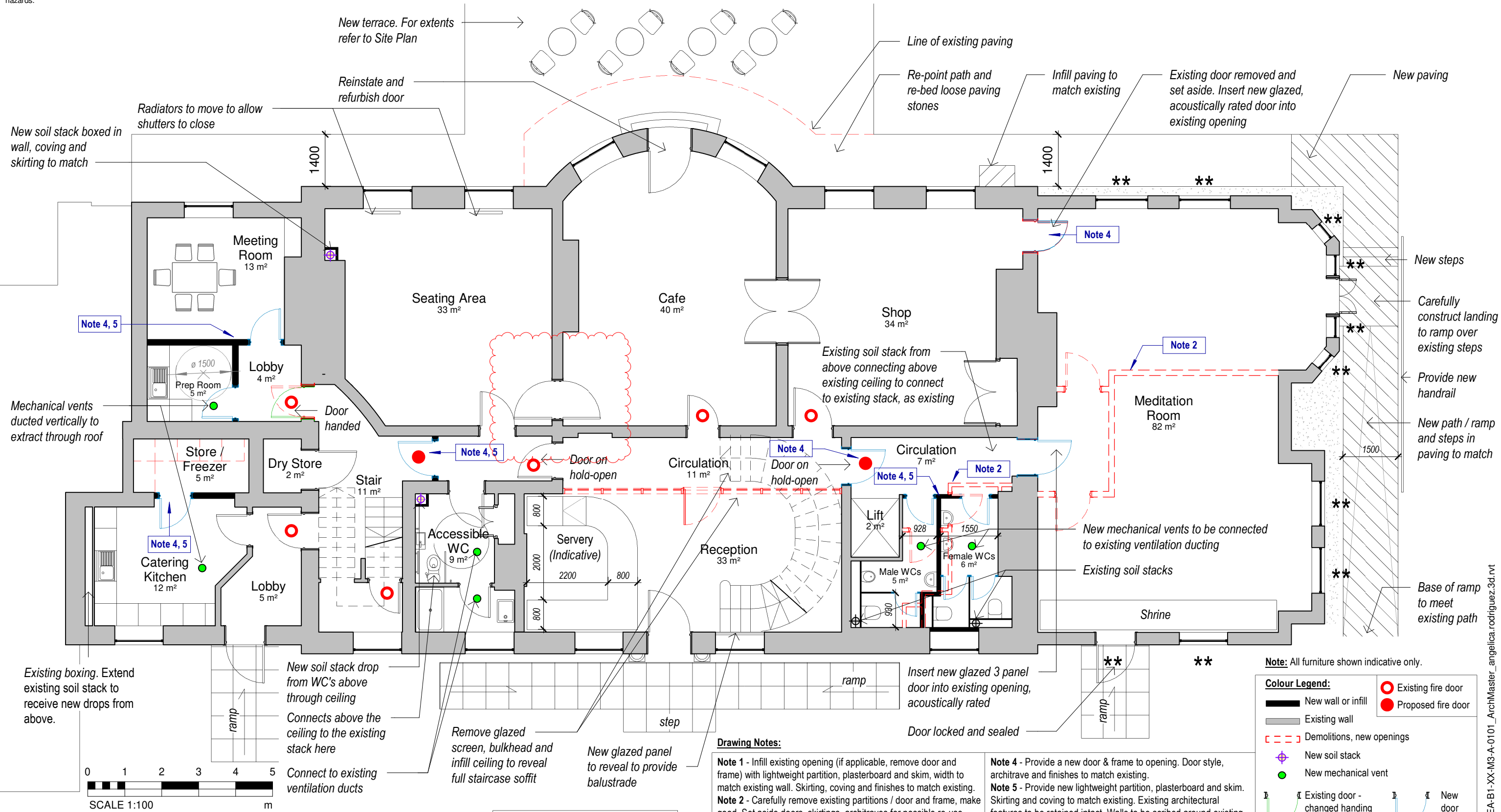

**1 Proposed Ground Floor Plan**  
1 : 100

**Drawing Notes:**

**Note 1** - Infill existing opening (if applicable, remove door and frame) with lightweight partition, plasterboard and skim, width to match existing wall. Skirting, coving and finishes to match existing.  
**Note 2** - Carefully remove existing partitions / door and frame, make good. Set aside doors, skirtings, architraves for possible re-use.  
**Note 3** - Carefully form new opening, make good.

**Note 4** - Provide a new door & frame to opening. Door style, architrave and finishes to match existing.  
**Note 5** - Provide new lightweight partition, plasterboard and skim. Skirting and coving to match existing. Existing architectural features to be retained intact. Walls to be scribed around existing coving, skirting and other features. Finishes to match existing.

**Doors:** Existing doors required to be fire rated to be upgraded with applied intumescent treatment and new seals.

**Note:** All furniture shown indicative only.

**Colour Legend:**

- Existing fire door (Red circle)
- Proposed fire door (Red circle with dot)
- New wall or infill (Thick black line)
- Existing wall (Thin grey line)
- Demolitions, new openings (Red dashed line)
- New soil stack (Green circle with cross)
- New mechanical vent (Green dot)
- Existing door - changed handing (Blue arrow)
- New door (Blue arrow)

**FRANKLIN ELLIS ARCHITECTS**  
 Architecture / Landscape / Interiors / Graphics / Project Management  
 0115 941 8475  
 enquiry@franklinellis.co.uk  
 www.franklinellis.co.uk  
 The Old Pump House  
 5 The Ropewalk, Nottingham, NG1 5DU

PARTNER/ASSOCIATE Name: \_\_\_\_\_ PROJECT LEAD Name: \_\_\_\_\_

Rev	Date	Description	Issuer	Checker
P2	2021-02-18	Issued for comments	AL	DRF
P3	2021-05-27	Updated following Client's feedback. Issued for comments	AL	DRF
P4	2021-06-07	Updated and issued for comments	AL	DRF
P5	2021-06-10	Fire door annotation added	AL	DRF
P6	2021-08-10	Removed reopening of former door. No longer removing second eaves door	ST	DRF

PROJECT NAME: **Gedling House**  
 CLIENT / USER NAME: \_\_\_\_\_  
 SHEET NAME: **GA Plan Proposed 00 Ground Floor**

PROJECT No.: **20-0042**  
 SHEET: **A3 L**

FULL REFERENCE Identification / Location: **GHN-FEA-B1-00-DP-A-2200**

Project Code: \_\_\_\_\_ Originator Code: \_\_\_\_\_ Volume /Zone: \_\_\_\_\_ Level/Location: \_\_\_\_\_ Doc Type: \_\_\_\_\_ Role /Dis: \_\_\_\_\_ Number: \_\_\_\_\_

SCALE: **1 : 100** STATUS: **S3 Preliminary** REVISION: **P6**

C:\Users\angelicarodriguez\Documents\GHN-FEA-B1-XX-M3-A-0101\_ArchMaster\_angelica.rodriguez.3d.rvt