

This drawing has been prepared to obtain statutory Local Authority Consent. All sizes to be confirmed on site prior to commencing work.
w: www.andrewallanarchitecture.com
e: info@andrewallanarchitecture.com
t: 01383 730500

| DATE: | PROJECT NO: | ISSUE STAGE: | Rev | Details | Date |
|----------------|----------------|--------------|-----|---------|------|
| September 2021 | 21/0048 | Planning | | | |
| TECHNICIAN: | SCALE(S): | SHEET SIZE: | | | |
| SF | 1:500 & 1:1250 | A4 | | | |

©Crown Copyright and database rights 2021 OS Licence no. 100057546

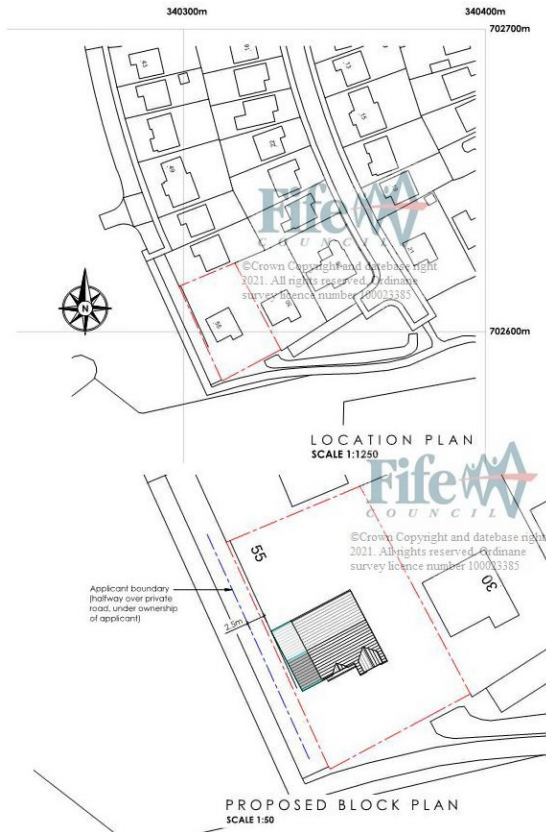

**andrew allan
architecture** limited

PROJECT:
Proposed double storey extension to side of property

ADDRESS:
Mr & Mrs Brickwood
55 Clover Way
Blairhall
KY12 9JY

**DRAWING
NUMBER**
SP1