

NB EXACT LOCATION OF FW SEWER TO BE
 CONFIRMED ON SITE BY CONTRACTOR

Premises Referred to

Penwauun

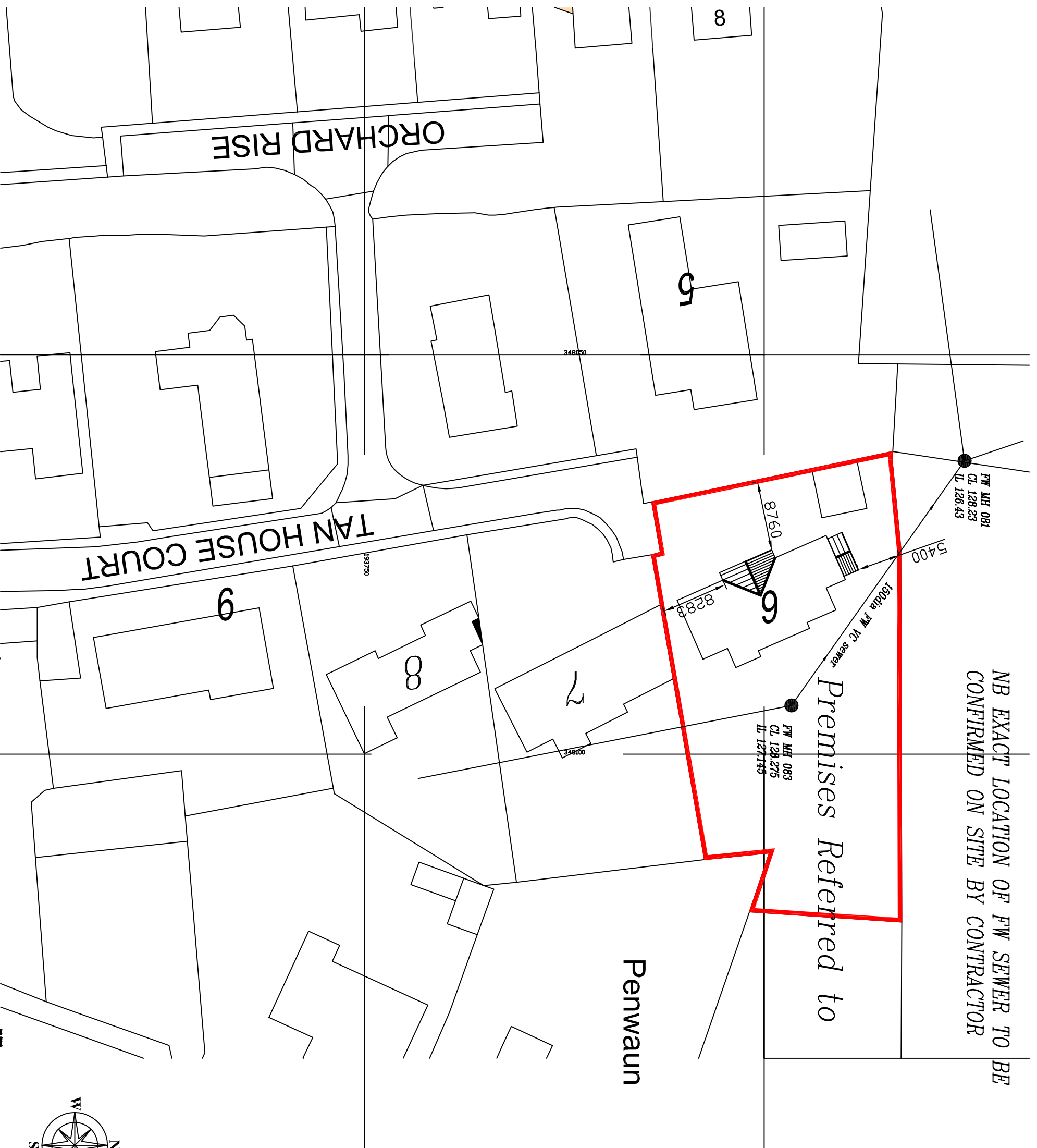

PLEASE READ THE FOLLOWING INSTRUCTIONS VERY CAREFULLY & ENSURE THEY ARE IMPLEMENTED.

DO NOT SCALE.
 All measurements & levels shown are subject to checking on site by the contractor. Figured dimensions to take precedence over scaled.
 All working dimensions must be taken from, checked &/or verified by the main contractor on site prior to the manufacture of all items & the placing of all work in hand.

Working dimensions must not be scaled from this drawing. In all cases of doubt or discrepancy please refer to the architect, surveyor, supervising officer or consultant for instructions.

The main contractor must ensure that all appropriate architects, surveyors, supervising officer, consultants &/or specialists drawings are read in conjunction with this drawing.

All work is to comply with the current building regulations, local authorities bye-laws stipulations & requirements of statutory bodies.

Serve all notices to the authorities concerned.
 All work is to comply with the current editions of the British Standards Institution codes of practice.

All materials & components to comply with the current editions of the Building Standards Institution specifications.

Prior to commencing work, the contractor is required to communicate with the relevant authorities, bring them to site & to locate the positions and lines of all services (e.g. water, gas, electricity, telephone, redistribution, sewage etc.) on, over, under & around the site which could in any way affect the positioning of the buildings. Copies of the correspondence & a full report of the findings must be forwarded to the architect, surveyor, supervising officer or consultant before building works commence.

This drawing is copyright.

AMENDMENTS

rev.	date	description
1	22/05/20	FW sewer added
2	18/09/20	Site extension reduced, front entrance amended

M. John Crowther & Associates.
 Architect, Surveyors
 Planning Consultants

7 Blackrock Road, Portskewell, Monmouthshire, NP23 5TN
 (0291) 423626 Mob: 0797965488 email: crowthidm@gmail.com
 THIS DRAWING IS COPYRIGHT AND IS NOT TO BE REPRODUCED WITHOUT OUR PERMISSION.

Site
 Proposed Alterations and Extensions
 6 Tan House Court, Shirenewton,
 Monmouthshire. NP16 6AH

Element/Worksection
 Site Location Plan

Drawn	Date	CAD Ref
MC	15/05/20	C:\CAD\1519\1519-5B

Checked	Date	Drawing No.
		1519-5B

Ordnance Survey, (c) Crown Copyright 2020. All rights reserved. Licence number 100022432