

This drawing is copyright of CLARK & MASLIN Ltd and may not be copied or reproduced without permission.  
 Figured dimensions are to be taken in preference to scaled dimensions.  
 Large scale drawings to have preference to small scale drawings.  
 Dimensions for fixed-in items are to be checked on site prior to manufacture.

REV	DETAIL OF REVISION	BY	DATE
A	AMENDED TO PLANNING COMMENTS	HH	13/09/21

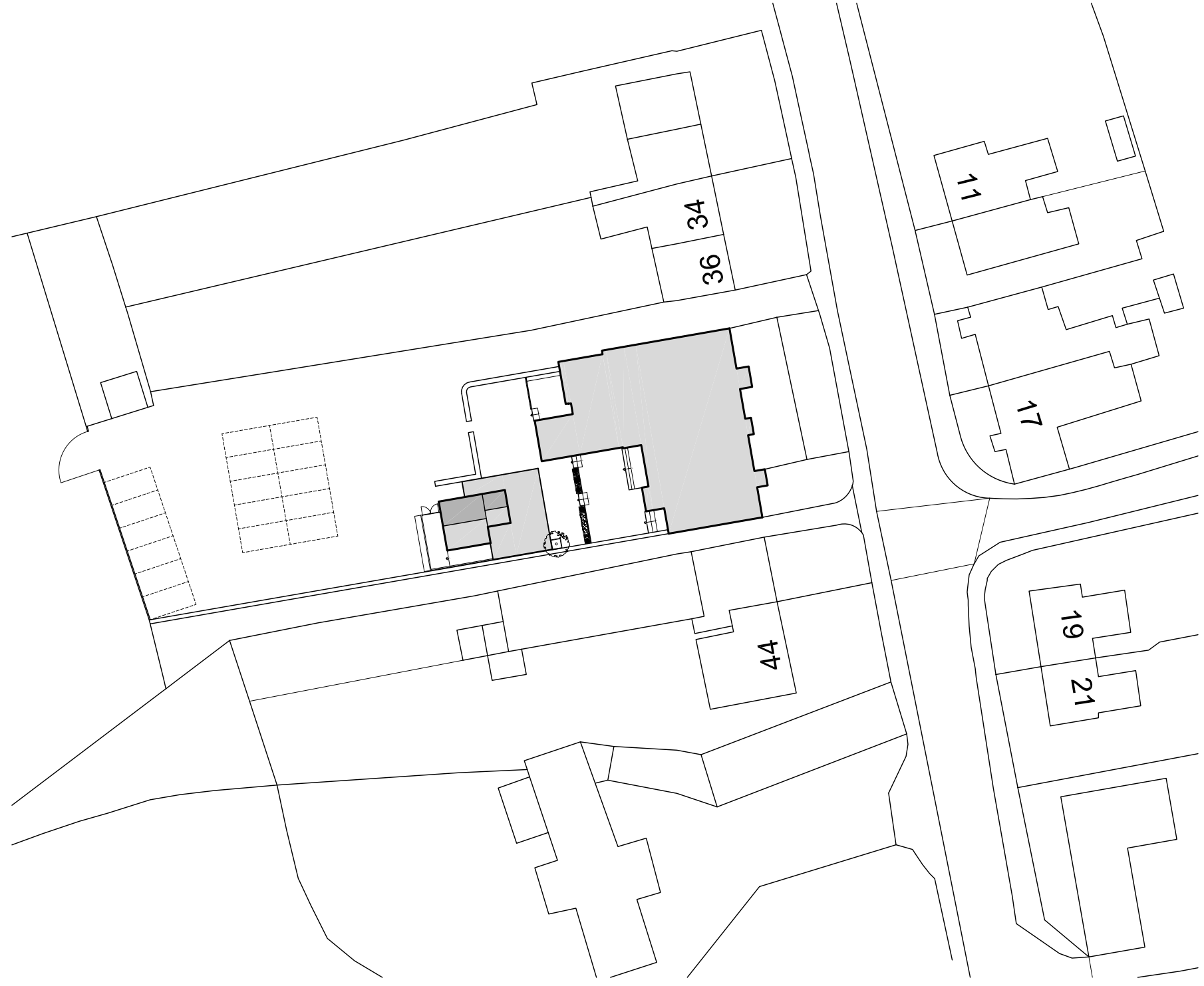

## SURVEY DRAWING

**CLARK & MASLIN**  
 Unit 5, Charlton Business Park  
 Cruswell Road, Malmesbury  
 Wiltshire, SN16 9RU  
 Telephone: 01666 822911  
 www.clarkandmaslin.co.uk  
 Planning Architecture Conservation

Client  
 CAT AND CUSTARD POT INN

Project  
 PROPOSED EXTENSION & ALTERATIONS,  
 THE STREET, SHIPTON MOYNE, TETBURY,  
 GLOS. GL8 8PN

Description  
 EXISTING BLOCK PLAN

Scale 1:500	PG Size A3	Drawn HH	Date APR '20
----------------	---------------	-------------	-----------------

Drawing No 5235/04	Revision A
-----------------------	---------------