

Note: CONTRACTOR TO VERIFY ALL SIZES ON SITE BEFORE COMMENCEMENT

Notes:

These notes do not comprise a full specification. The drawings are for building regulation purposes only and are not working plans. They do not comprise of a complete specification for the whole of the works. Their primary function is to assist the local authority inspector to determine compliance in line with building regulation standards.

Where further clarifications are required contractor shall refer to the client for details and instruction.

All dimensions must be checked by the contractor and any discrepancies noted in writing to AHA Designs.

All works must be carried out in accordance with current Building Regulations, Codes of Practice and Planning Officers requirements.

All materials must comply with current British Standards in situations used.

- Proposed Materials:
- Roof: Local Slate
- Elevations: Timber Framed/Rendered Finish
- Windows: Anthracite Aluminum
- Roofline: White UPVC
- Rainwater Goods: Black PVC

Revisions Table:

| | | |
|-------|-----------------|---------|
| | | |
| | | |
| | | |
| Rev.1 | Scale Bar Added | 31.7.18 |



AHA Designs
Transforming ideas into reality

Horton Farm Bungalow, Broadworthy, EX22 7RB
07833941924 01409 231842 www.ahadesigns.co.uk

Project Name & Address:

New Build

Land at (E)243451, (N)100342

What3Words: precluded.chicken.universe
Postcode (near) : EX21 5UF

Drawing Title:

Proposed Floorplan

| | | | |
|------------|--------|------------|-------------|
| Paper Size | Scale: | Date: | Drawing No: |
| A3 | 1:100 | 07/07/2021 | AHA-08 |

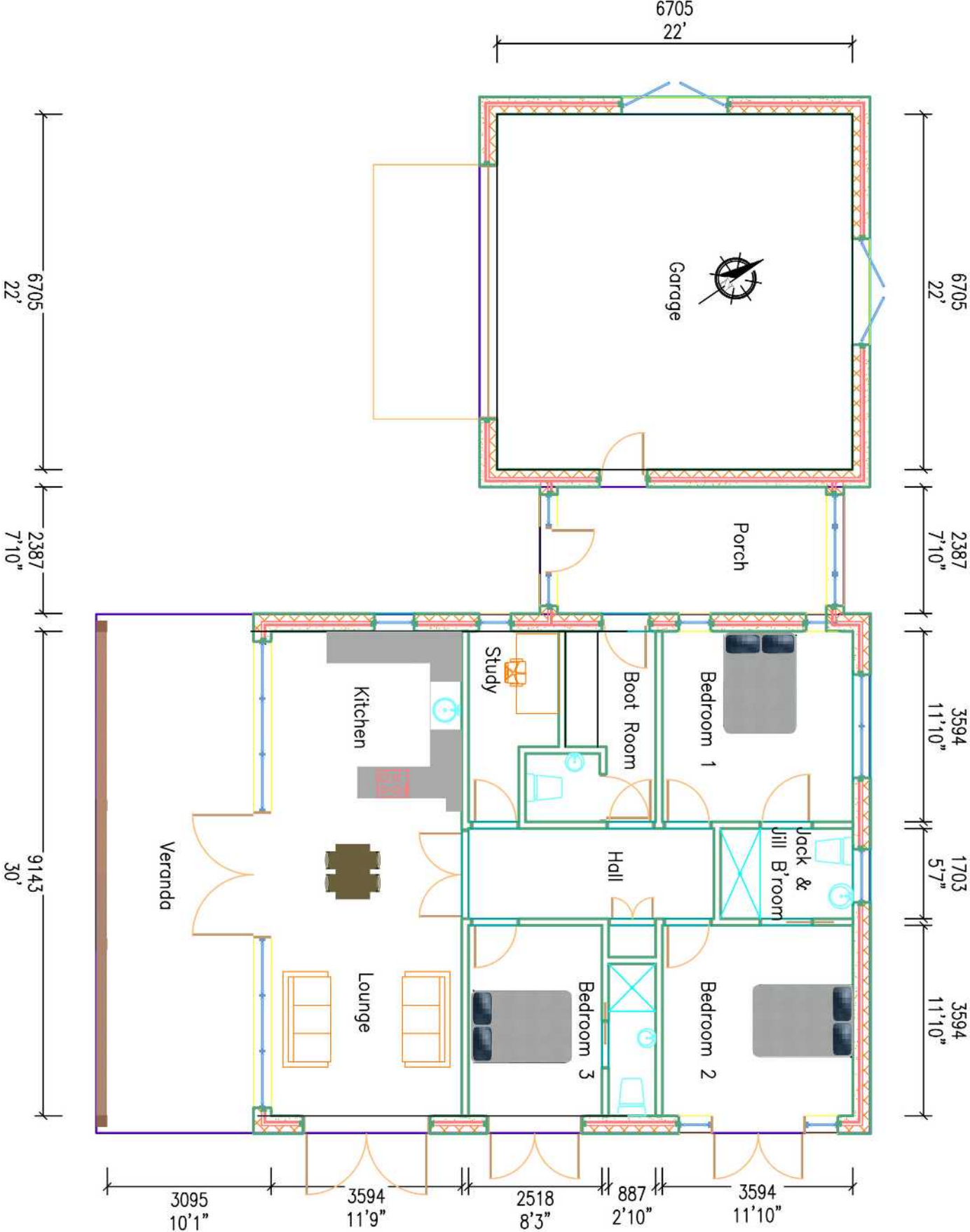

AHA Designs 2020 Reproduction of these drawings is strictly prohibited without prior permission