

Piece

Hall

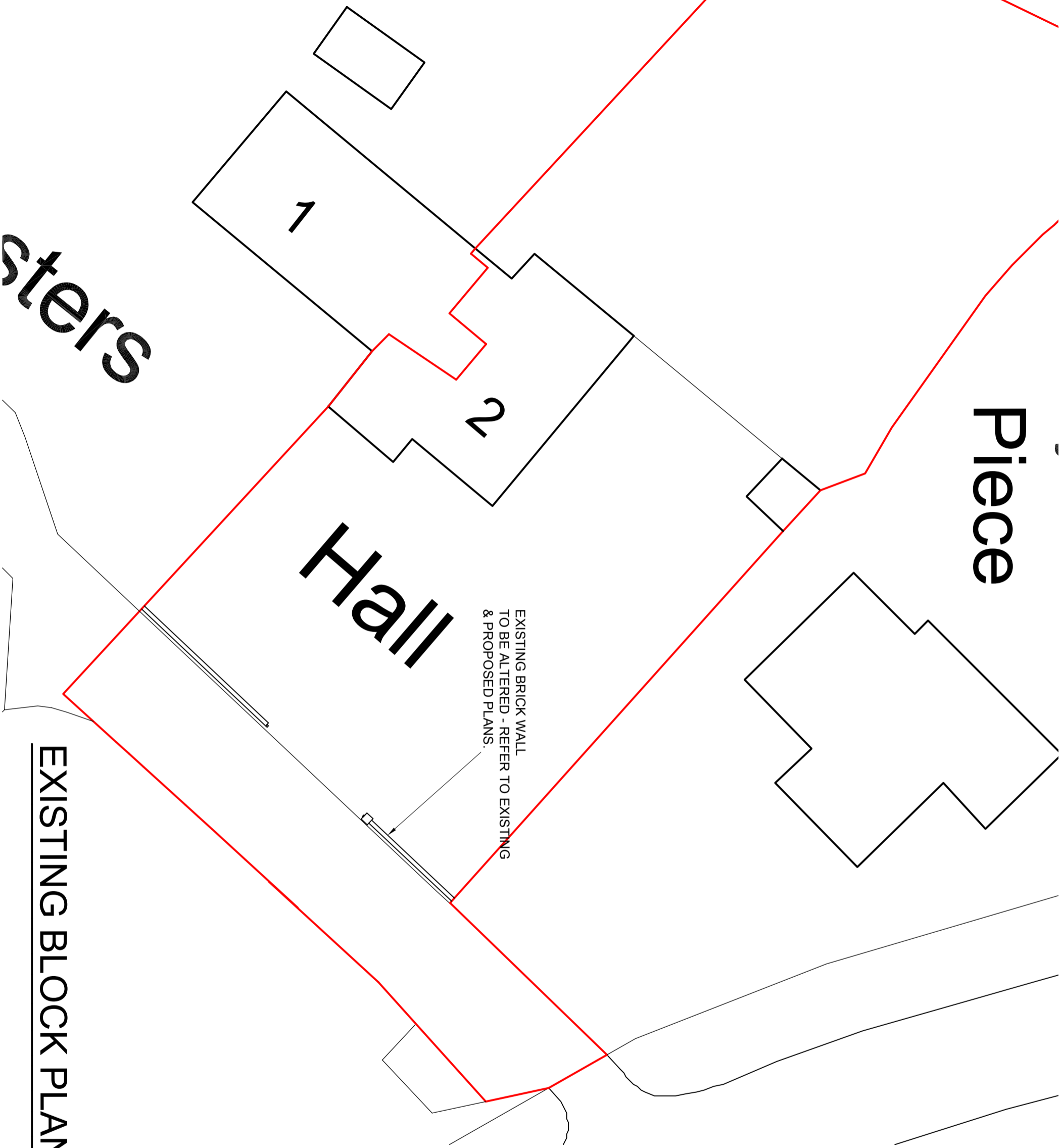

EXISTING BRICK WALL
TO BE ALTERED - REFER TO EXISTING
& PROPOSED PLANS.

Foysters

EXISTING BLOCK PLAN

REVISIONS:

DESIGN: -

DRAWING TITLE:
BLOCK PLAN

DRG NO:
101

DATE:
JUNE 2021

REV: .

SCALE:
1:200

DRAWN BY:
S.A

CLIENT:
MR & MRS BODI

ADDRESS:
**2 FOYSTERS HALL,
MONKS ELEIGH,
SUFFOLK,
IP7 7AX**

CLIENT TELEPHONE:

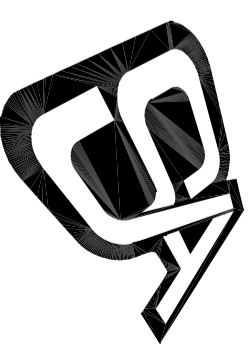

Steven James Allen
South Suffolk Business Centre,
Alexandra Road, Sudbury,
Suffolk, CO10 2ZX.

Tel: 07790 325613 / Steve@SJA.uk.com

DRAWING STATUS:

FEASIBILITY PLANNING BUILDING REGULATIONS.

All work to be carried out to comply with
1. The latest building regulations approved documents.
2. N.H.B.C.
3. T.R.A.D.A. for timber frames.

Copyright: The design and the design are the copyright of Steven James Allen and are made available on the express condition that they shall not be copied or used for purposes other than that specified in the drawing status box by/for the client, as specified on the drawing, without the express permission of Steven James Allen. © Steven James Allen.