

FLOOR PLANS UNITS D - G

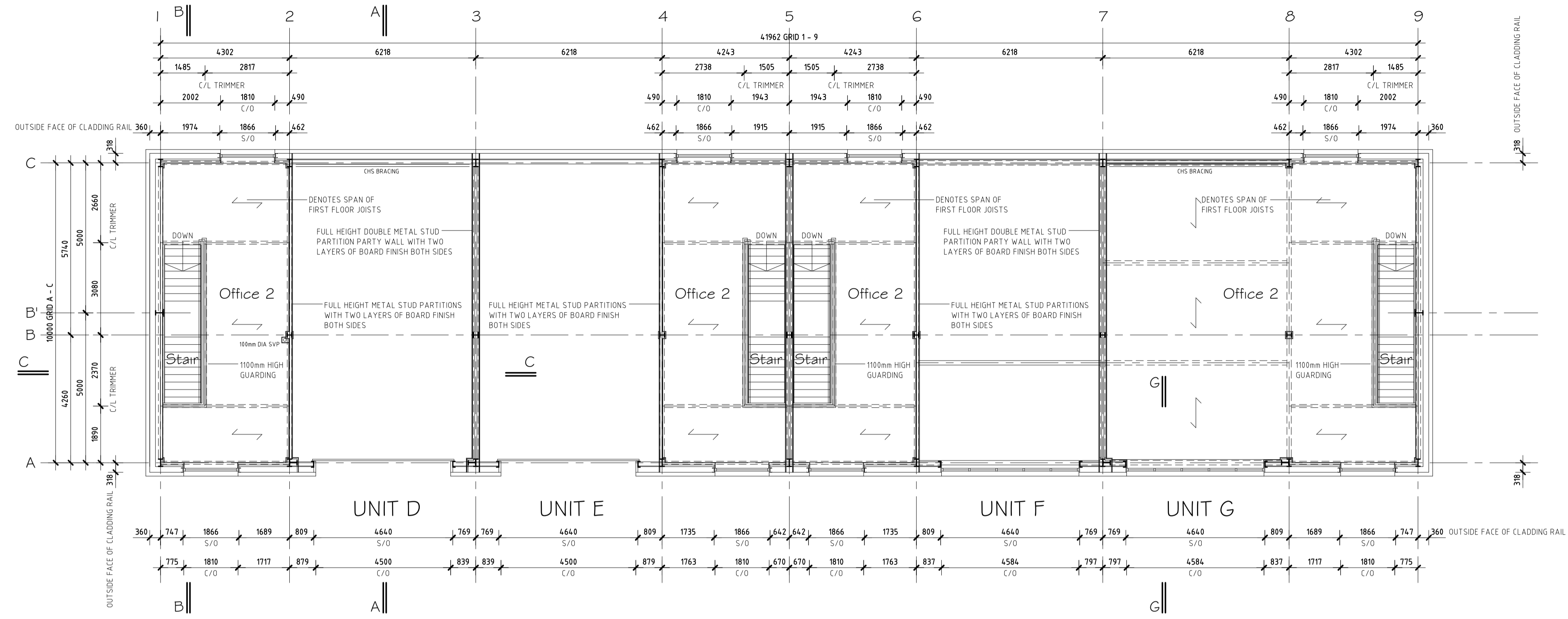

First Floor Plan

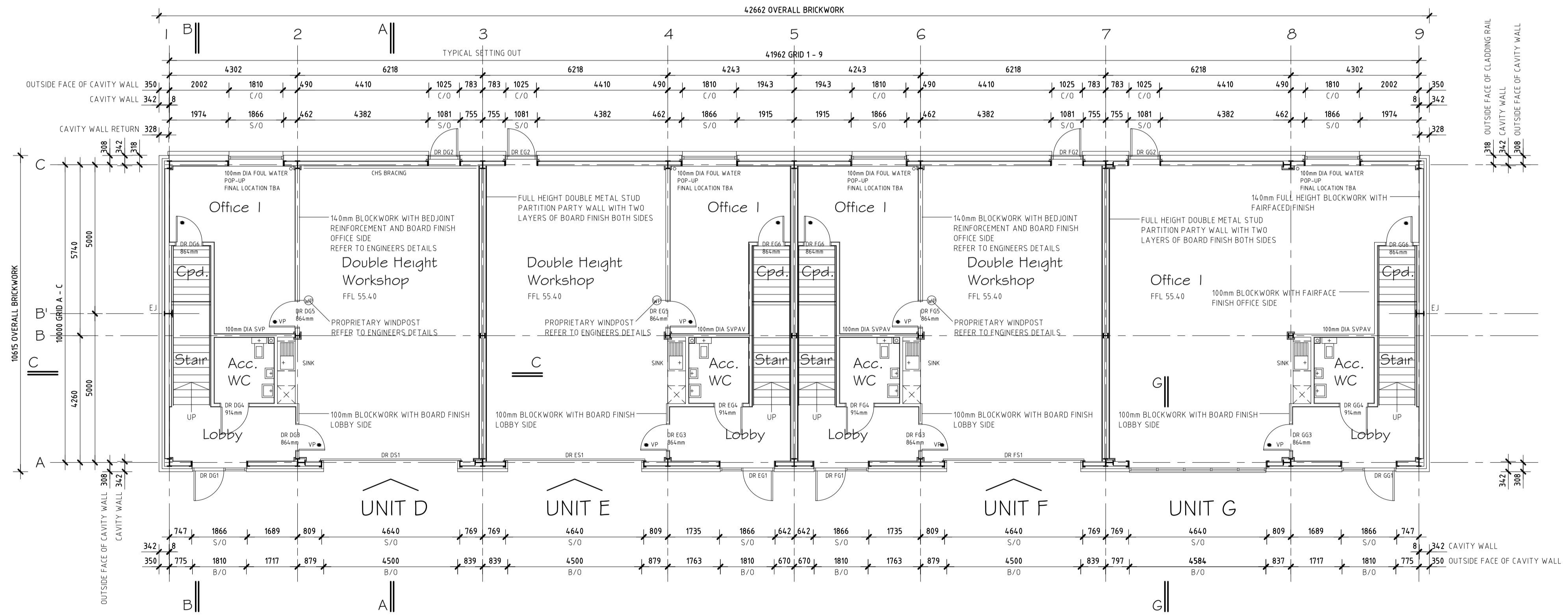

Ground Floor Plan

GENERAL NOTE
 S/O DENOTES STRUCTURAL OPENING AT DOOR/WINDOW OPENINGS TO ACCOMMODATE INSULATED FLASHINGS
 25mm RIGID INSULATION BOARD AT PEDESTRIAN DOOR AND WINDOW OPENINGS
 70mm RIGID INSULATION BOARD AT VEHICLE ACCESS DOOR OPENINGS
 B/O DENOTES CLEAR OPENING AT DOOR/WINDOW OPENINGS WITHIN BRICKWORK
 C/O DENOTES CLEAR OPENING WIDTH AT DOOR/WINDOW OPENINGS WITHIN CLADDING

- REV P8 PRELIMINARY ISSUE
MINOR AMENDMENT TO UNIT G 13.01.2020
- REV P7 PRELIMINARY ISSUE
UNITS D-G AMENDED TO SUIT CLIENTS REQUIREMENTS 20.12.19
- REV P6 PRELIMINARY ISSUE
WALLS INCREASED FROM 100mm TO 140mm THICK WITH WIND POSTS BETWEEN OFFICE 1 AND WORKSHOP TO SUIT ENGINEERS REQUIREMENTS 29.08.17
- REV P5 PRELIMINARY ISSUE
VEHICLE ACCESS DOOR PFC POSTS MOVED 08.08.17
- REV P4 PRELIMINARY ISSUE
STEELWORK ARRANGEMENT REVISED TO SUIT STRUCTURAL STEELWORK RE-DESIGN 18.05.17
- REV P3 PRELIMINARY ISSUE
ACCESSIBLE TOILETS HANDED 10.03.17
- REV P2 PRELIMINARY ISSUE 02.02.17
- REV P1 PRELIMINARY ISSUE 13.01.17

PRELIMINARY ISSUE

PROJECT
 Proposed Commercial Development
 at Elm Farm Park
 Great Green, Thurston
 Bury St Edmunds, IP3 1 3SH
 for HAYDON HOLDINGS LTD

SCALE 1:100@A1 DATE Jan. 2017
 DRAWN CHK/D/AUTH.

David Clarke & Associates

TURRET HOUSE
 TURRET LANE
 IPSWICH
 IP4 1DL

Tel: 01473 213563
 Email: mail@dcaipswich.co.uk

DCA
 BUILDING DESIGN
 CONSULTANTS LTD

DRAWING NUMBER REVISION
4620-10 P8

© THIS DRAWING MUST NOT BE REPRODUCED IN WHOLE OR IN PART WITHOUT WRITTEN CONSENT. DO NOT SCALE FROM THIS DRAWING. ALL DIMENSIONS ARE TO BE CHECKED AND VERIFIED ON SITE AND ALL DISCREPANCIES REPORTED TO DAVID CLARKE AND ASSOCIATES PRIOR TO CONSTRUCTION WORK TAKING PLACE.
 FLOOR PLANS UNITS D - G