

ARBORICULTURAL REPORT

- CONTENTS:**
1. INTRODUCTION
 2. TREE SURVEY
 3. ARBORICULTURAL IMPLICATIONS & IMPACT ASSESSMENT

1. INTRODUCTION

Background: LSDP were appointed to prepare an Arboricultural Survey & Report to satisfy local authority requirements, relating to a proposed B1 Development. The report is based on survey information collected during April 2015.

The Site: The site comprises part of an agricultural field to the east of the existing business park. The site is bordered to the north by the garden of a residential property, to the east by an access road, with agricultural land beyond; and to the south by agricultural land.

2. TREE SURVEY

Generally: Three field maple trees and two hedgerows are recorded in the survey, one of the trees is in poor condition and recorded as 'C' Category, the other trees and hedgerows are recorded as 'B' category.

BS 5837: 2012 survey information:

Ref: T1 & T2 Field maple
 Stem Dia: 450mm
 Height: 10M (approx)
 Canopy: Spread as indicated on drawing. Clearance 3.5m above ground-level of site, no significant branches overhanging site.
 Physiology: Normal, given species, age and location.
 Structural Condition: No significant defects.
 Comments: Pair of small trees bolted from hedgerow
 Category: The trees have moderate cultural and conservation value, forming part of a traditional field hedgerow and are recorded as 'B3' category (moderate cultural value).

Ref: T3 Field maple
 Stem Dia: 400mm
 Height: 9M (approx)
 Canopy: Spread as indicated on drawing. Clearance 3.5m above ground-level of site, no significant branches overhanging site.
 Physiology: Upper branches and stem are dead.
 Structural Condition: Fair - i.e. if dead wood is removed.
 Comments: Small trees bolted from hedgerow
 Category: Similar value to T1 and T2, but with shorter life expectancy, hence 'C3' (low cultural value)

Ref: H1 & H2 Hedgerows
 Stem Dia: NA
 Height: 4-5M (H1) & 2M (H2)
 Canopy: Spread as indicated on drawing.
 Physiology: Normal, given species, age and location.
 Structural Condition: No significant defects.
 Comments: Hedgerows bordering site to north and east.
 Category: The hedgerows provide screening and enclosure and have cultural value, being traditional landscape elements and are recorded as 'B2' / 'B3' category (moderate landscape and cultural value).

3. ARBORICULTURAL IMPLICATIONS & IMPACT ASSESSMENT

Generally: The proposed development does not significantly affect the constraints posed by the existing trees and hedges and it is considered that the development will have no significant adverse impact on them.

PLANTING SPECIFICATION

GENERALLY

- Timing:** Planting shall be implemented during the first planting season from mid-November to mid-March following substantial development completion or phases thereof.
- Plant Stock:** Plant stock must be in strict accordance with the schedule of plants shown on the drawing. All plants are to be supplied by nurseries registered with the HTA Nursery certification scheme in accordance with the National Plant Specification.
- British Standard:** All tree and shrub planting and turfing shall be carried out in accordance with the relevant British Standards.
- Planting Conditions:** No planting shall take place when the ground is frozen, wet or waterlogged or in excessively windy conditions, or in any other conditions that could adversely affect the successful establishment of plant material. All plants on site to be protected from adverse weather conditions.
- Planting Positions:** All plants must be planted in the exact locations shown on the drawings; if this is not possible due to site layout changes or unmarked service runs etc. then changes must be agreed and confirmed in writing by the Contract Administrator.
- Watering Prior to Planting:** All container grown and root balled planting stock shall be thoroughly watered before planting on the same day as the planting operation.

PLANTING BEDS

- Bed Widths:** Shrub beds shall be 1m minimum width, where space allows. Hedge beds shall be 700mm for single row hedges and 1m for double-row hedges.
- Herbicide Application:** Spray planting beds with translocated herbicide if there is any pernicious perennial weed growth. Allow weed growth to die off and repeat treatments if necessary to ensure that planted areas are free from perennial weed growth prior to further cultivation. Spraying to be carried out in accordance with COSHH regulations 1994.
- Cultivation:** Cultivate all planting beds to 300mm depth to form an open textured free draining growing medium. Remove all stones and other debris larger than 100mm and remove all litter and vegetative matter. Incorporate Fisons 'Ficote' 140 day 16,10,10 slow release fertiliser at a rate of 100 grams per m² in accordance with the manufacturer's instructions. Incorporate compost at 25 litres per m², compost to be of a peat free type. Areas of existing soil that have become compacted shall be broken up and loosened by hand forking or deep ripping to a depth of 600mm in accordance with the relevant British Standards.
- Finished Surface:** Rake all shrub and hedge beds to form an even surface. Remove all surface stones and other debris larger than 50mm. NB ensure that final soil levels within 300mm of edge of all beds are 70mm below adjacent surfaces, to stop mulch moving from bed. Water lightly if the soil is dry prior to planting.
- Planting:** Container grown shrubs shall be pit planted, small open ground stock may be notch planted. Following planting, lightly firm the soil around the base of the plant.
- Wood Chip Mulch:** Mulch shall be coarse wood chips with no fines. Spread wood chip mulch to an even depth of 50mm over entire planted area.
- Pruning:** Immediately after planting shrubs and hedging, carefully remove all damaged, dead or diseased branches and remove any weak, thin or malformed growth in a manner and at a point appropriate for the species.
- Watering:** Water in each plant position with 15 litres, or to field capacity upon planting, or at the end of the day during which the planting was carried out.

TREES

- Excavation:** Excavate pits so that the diameter / depth of the pit allows a gap of approximately 150mm between the extent of the roots and the side of the pit. Remove all stones and other debris over 100mm diameter and all vegetative material. Remove any excavated material that is not suitable to form an open textured free draining growing medium and replace with topsoil.
- Cultivation:** Loosen sides and bottom of pit to encourage drainage. Mix backfill with 100 grams of Fisons 'Ficote' 140 day 16,10,10 slow release fertiliser, in accordance with the manufacturer's instructions and 25 litres of compost, compost to be of a peat free type. Areas of existing soil that have become compacted shall be broken up and loosened by hand forking or deep ripping to a depth of 900mm to a minimum of a 1m radius from the proposed tree position, in accordance with the relevant British Standards.
- Single Staking Standard and Feathered trees. NB: Only stake smaller stock size trees if entirely necessary to support to tree:** Stake trees with a single stake, 1.8m long x 100mm diameter, driven vertically into base of pit. Finished height of stake to be 800mm above finished ground level, cut stake if necessary to achieve this height.
- Planting:** Position trees, and fix to stakes using biodegradable tree tie with spacing device. Ties to be nailed 25mm from top of stake. Backfill tree pit with clean topsoil and firm in after planting.
- Mulching: Trees pits in shrub beds - include mulch as per adjacent shrub planting. Tree pits in grass areas -** Ensure finished soil level is 100mm below adjacent grass surface to a radius of 500mm from the base of the tree, thus forming a neat circle. Spread 80mm depth of coarse wood chip mulch over surface of pit.

TURF

- Herbicide Application:** Spray areas with translocated herbicide if there is any pernicious perennial weed growth. Allow weed growth to die off and repeat treatments if necessary to ensure that areas are free from perennial weed growth prior to further cultivation. Spraying to be carried out in accordance with COSHH regulations 1994. NB herbicide application should be carried out approximately six weeks after soil rotovation i.e. once dormant weed seed and existing vegetation has begun to generate new growth.
- Cultivation - Areas that have been recently topsoiled:** Rotovate all areas to 150mm depth. Rake to create a fine tilth and even surface. Remove all stones and organic debris greater than 20mm diameter and all vegetative material. If ground conditions are dry and soil is loose, then lightly consolidate area with garden roller or similar to eliminate soft spots, then lightly re-rake surface. If ground conditions are wet, then either allow area to dry prior to cultivating, or spread 5-10 mm of sharp sand over area prior to laying turf and ensure that area is not walked on for 3-4 weeks after turf has been laid, in order to allow ground to settle evenly - scaffold boards can be placed over the lawn to allow access during this period. NB ensure that final level of grass areas within 500mm of edge are 10mm below adjacent paved surfaces, to allow mowing and surface water run off.
- Turf:** Supply turf and ensure that any stored rolls are kept moist at all times. If ground is dry then water lightly prior to laying turf. Lay turf and firm in with a light roller 'medalton' ground conditions are not wet. Water finished area to field capacity. Turf to be Rolawn 'Medalton' or similar and approved.

MAINTENANCE

- Maintenance period:** Carry out the following maintenance operations until planting is established. Ensure that maintenance operations are carried out as necessary to keep the works in a tidy condition throughout the maintenance period.
- Weed control:** Allow all weed growth by hand or treat with spot herbicide applications, taking care to avoid spray drift. Spraying to be carried out in accordance with COSHH regulations 1994. All arisings to be removed from site.
- Litter removal:** Remove from site all litter and other debris during each maintenance visit.
- Pruning:** Prune off dead, damaged, diseased or misshapen growth from shrubs and trees to promote good habit and shape.
- Replacement:** Replace or make good immediately, any soft landscape item that fails, or does not develop full foliage during the maintenance period.
- Watering:** Water soft landscape items as necessary throughout the maintenance period, to ensure establishment. Replace or make good immediately, any soft landscape item that fails due to lack of water.

PLANT SCHEDULE

SHRUBS	QTY	CODE	PLANT NAME	STOCK	SIZE	SPACING
46No. Abe Hop			Abelia x grandiflora 'Hopleys'	C 3L	30-40cm	3/m ²
90No. Lon May			Lonicera nitida 'Maygreen'	C 3L	30-40cm	3/m ²

TREES	QTY	CODE	PLANT NAME	STOCK	FORM	GIRTH/HEIGHT
11No. Ame Rob F			Amelanchier arborea "Robin Hill"	C 15L	FTH	150-180cm
8No. Cor col F			Corylus colurna	C 15L	FTH	150-180cm
3No. Pyr pyr F			Pyrus pyraeaster	C 15L	FTH	150-180cm
6No. Que rob F			Quercus robur	C 15L	FTH	150-180cm

HEDGES	QTY	CODE	PLANT NAME	STOCK	SIZE
107m Hornbeam Hedge			Carpinus betulus	1+1	60-90cm
535No. Plants spaced @ 5/m in a Double Staggered Row					

HEDGE MIXES	PERCENT	QTY	PLANT NAME	STOCK	SIZE	SPECIFICATION
114m HEDGE MIX 1			planted @ 5/m in a Double Staggered Row			
40%	228No.		Acer campestre	Bare root	60-90cm	1+1
50%	285No.		Crataegus monogyna	Bare root	60-90cm	1+1
4%	23No.		Corylus avellana	Bare root	60-90cm	1+1
2%	11No.		Cornus sanguinea	Bare root	60-90cm	1+1
2%	11No.		Prunus cerasifera	Bare root	60-90cm	1+1
2%	11No.		Rosa canina	Bare root	60-90cm	1+1

64m ECO SHRUB HEDGE MIX	PLANT NAME	STOCK	SIZE	SPECIFICATION
10%	32No. Cornus sanguinea	Bare root	60-90cm	1+1
30%	96No. Ligustrum vulgare	Bare root	60-90cm	1+1
10%	32No. Euonymus europaeus	Bare root	60-90cm	1+1
25%	80No. syringa vulgaris	Bare root	60-90cm	1+1
25%	80No. Viburnum opulus	Bare root	60-90cm	1+1

SCHEDULE OF QUANTITIES

2194m ²	Grass areas
284m ²	Hedges
60m ²	Shrubs
28No.	Trees

Mature Black Poplar, considered to be outside of area affected by development. Stem diameter noted for calculation of RPA, tree not surveyed in detail

Plantation of young silver birch (indicative outline)

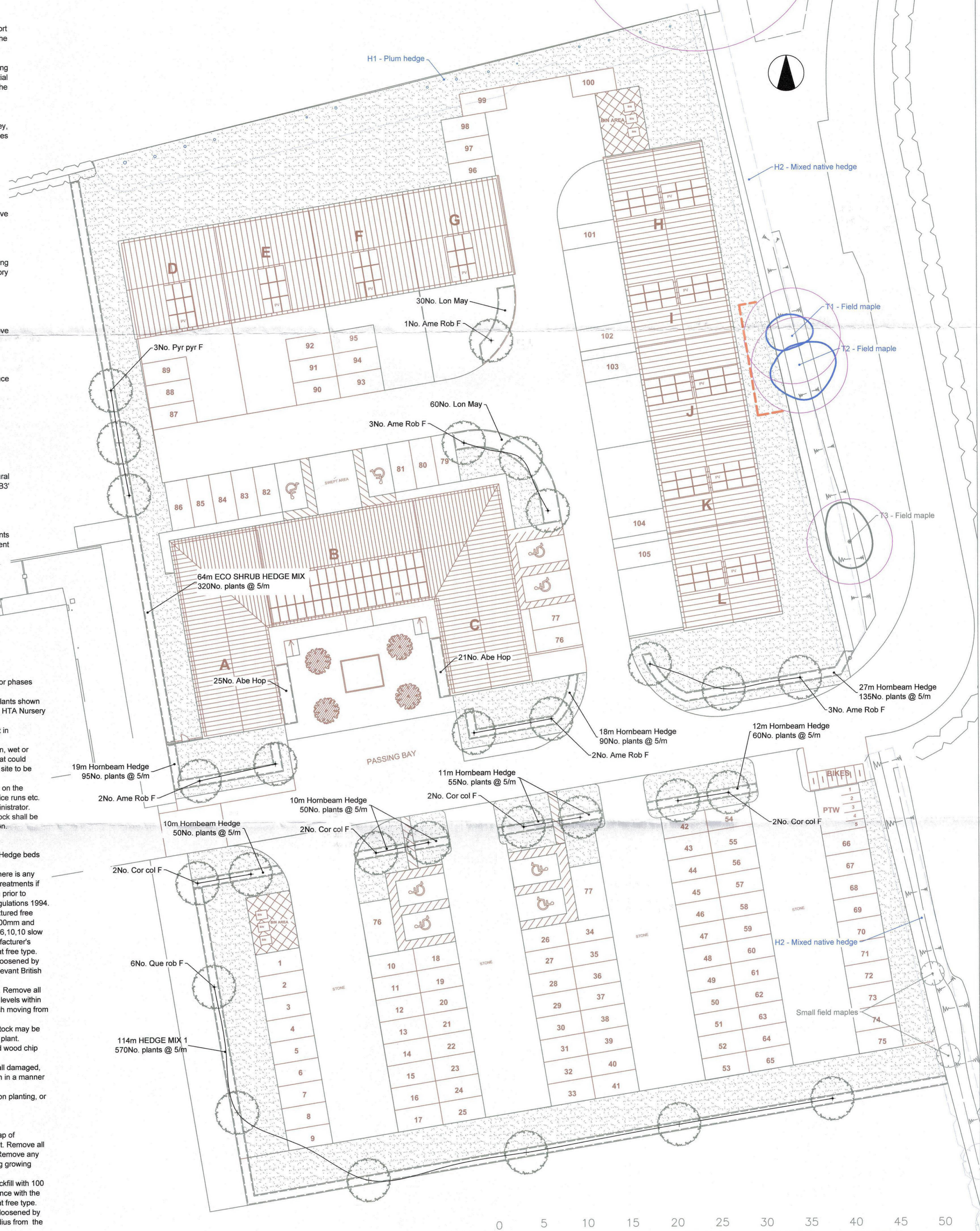

KEY

- Shrub planting
- Hedge planting
- Proposed tree
- Grass areas
- Existing Tree - 'B' Categor
- Existing Tree - 'C' Category
- Root Protection Area (RPA)
- Tree recorded on topographic survey, but considered to be outside of area affected by development
- Tree Protection Barrier: To be weldmesh panels installed in accordance with BS 5837: 2012 Fig 2

Revisions:



Land & Sculpture Design Partnership
 LANDSCAPE ARCHITECTURE · SCULPTURE · ARBORICULTURE

CLIENT : Hayden Holdings Ltd
 SITE : Proposed B1 Scheme, Elm Farm Park, Thurston
 DRG : Tree Protection Plan, AIA & Landscape Proposal
 DRN BY : GH
 SCALE : 1:250 @ A1
 DATE : June 2015
 No : LSDP 11239.01

OCTAGON HOUSE - THE WATER RUN - HITCHAM - IPSWICH - IP7 7LN
 T : 01479 740272 · E : LSDP@btinternet.com