

Produced on 09 March 2021 from the Ordnance Survey National Geographic Database and incorporating surveyed revision available at this date.
This map shows the area bounded by 280454 695516,280596 695516,280596 695658,280454 695658,280454 695516
Reproduction in whole or part is prohibited without the prior permission of Ordnance Survey.
Crown copyright 2021. Supplied by copla ltd trading as UKPlanningMaps.com a licensed Ordnance Survey partner (100054135).
Data licence expires 09 March 2022. Unique plan reference: v2c/589014/798648



DR AND DR WILLIAMS

**PROPOSED
REPOSITIONING OF EXISTING ACCESS**

**15 CAUSEWAYHEAD ROAD, STIRLING
LOCATION PLAN**

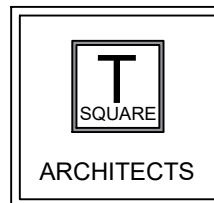

Architecture - Design - Planning

39 Allanvale Road
Bridge of Allan
Stirling
FK9 4PA

Mob: 07596906412

E-mail: daire.gibbons@tsquare-architects.co.uk Web: www.tsquare-architects.co.uk

scale 1:1250	date 18.09.21	drawn: CG	status: P
proj no. 2020-834	Dwg no. T-101	REV -	