

CAUSEWAY

10000

BUS

BUS STOP

BIN

FIBRE CABLE BOX

5100
EXISTING
OPENING IN
BOUNDARY
WALL

PARKING

FRONT
DOOR

15

EXISTING SITE PLAN

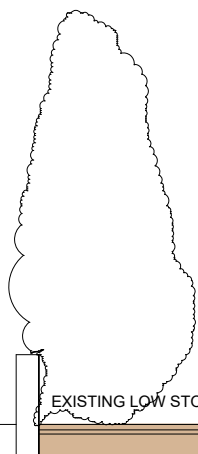

EXISTING ACCESS OPENING IN WALL

FIBRE CABLE BOX

BIN

EXISTING BUS STOP

EXISTING ELEVATION
SCALE IN METERS 1:100

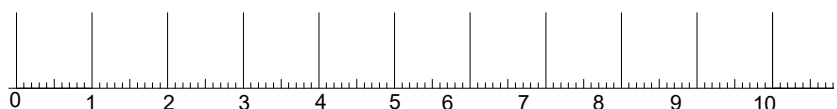

DR AND DR WILLIAMS

PROPOSED
REPOSITIONING OF EXISTING ACCESS

15 CAUSEWAYHEAD ROAD, STIRLING
EXISTING PLAN AND ELEVATION

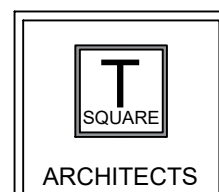

Architecture - Design - Planning
39 Allanvale Road
Bridge of Allan
Stirling
FK9 4PA
Mob: 07596906412
E-mail: claire.gibbons@tsquare-architects.co.uk Web: www.tsquare-architects.co.uk

scale	1:100	date	18.09.21	drawn:	CG	status:	P
proj no.	2020-834	Dwg no.	T201	REV	-		