

NB Responsibility is not accepted for errors made by others scaling from this drawing. All construction information should be taken from figured dimensions only

A3

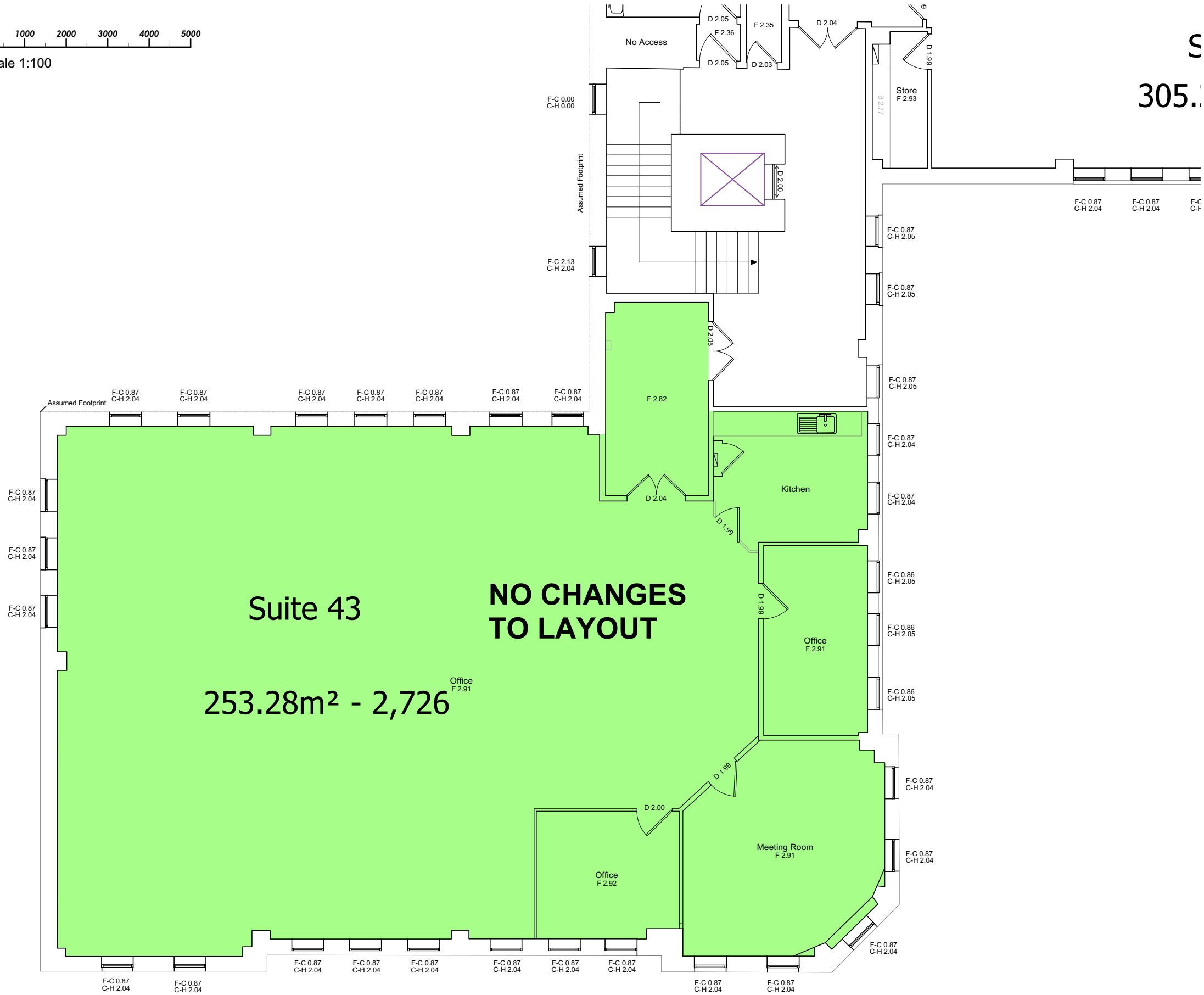

Rev	Description	By	Date
-----	-------------	----	------



Project ST. JOHN'S SHOPPING CENTRE PERTH, PH1 5UB		
Client UNIVERSITIES SUPERANNUATION SCHEME LTD		
Title ST. MARTIN'S HOUSE - SECOND FLOOR SUITE 43		
Drawn by GJS	Surveyor BSM	Date FEBRUARY 2016

Scale 1:100, @ A3	
Drawing Number G172TBA-A01-001	Revision

Initial indicative drawings only subject to a full feasibility study including Structural, Mechanical, Fire Engineers Reports and Building Regulation / Warrant Legislation.
Layouts shown were supplied by a 3rd party; Workman LLP therefore take no responsibility for the accuracy or information taken from them.