

No.25 High Street, Alton, Hampshire, GU34 1AW.

NOTES:
 The contractor, sub-contractor or supplier is to check all dimensions and levels before commencing any work. ANY DISCREPANCIES ARE TO BE REPORTED TO THE ARCHITECT IMMEDIATELY. This drawing is copyright and may not be copied, traced, altered or reproduced without the express written permission of the Architectural Designer.

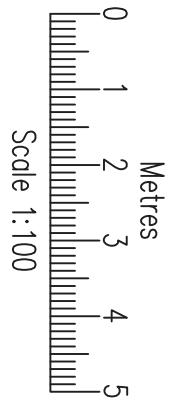
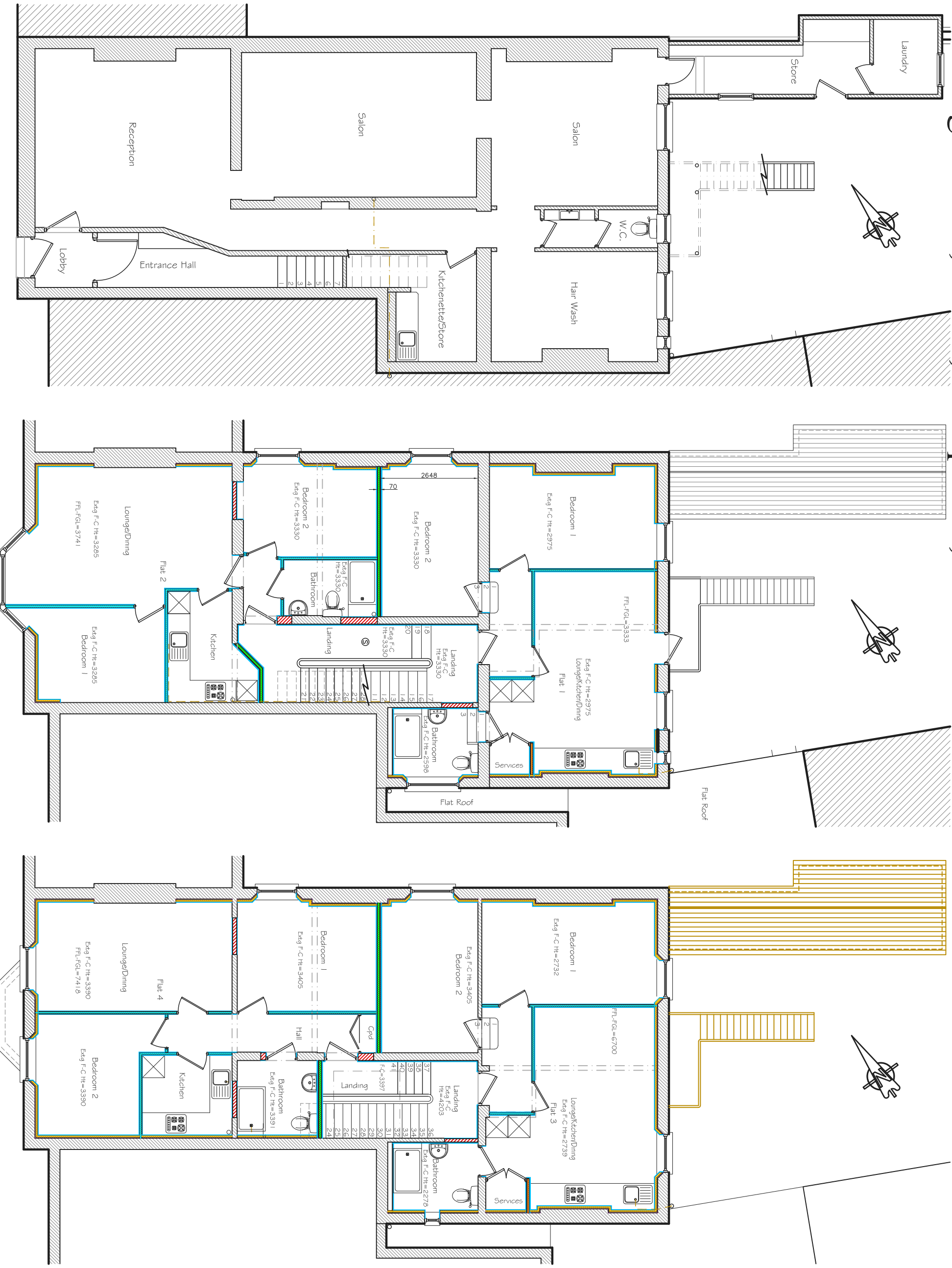

L.M.D.
 DESIGNS Ltd.
 ARCHITECTURAL
 & INTERIOR DESIGN
 No.4 Foxcombe Close,
 Swanmore,
 Hampshire SO32 2UJ
 Tel: 07876 712622
 Email: Lmdrchitecture@aol.com

Job Title
**Proposed Extension at No.25,
 High St, Alton, Hampshire, GU34 1AW.**
 Client
25 High Street Alton Ltd.
 Drawing Title
**Planning
 Floor Plans
 Previously Approved**

DAO REF: 221902-25-High-St-Alton.dwg Scale 1:100
 Drawn: SLV Amended Checked: Date Aug '21
 Job No. 221902 Draw No. 103 Rev. A

Previously Approved Ground Floor Plan 1:100 @ A3

Previously Approved First Floor Plan 1:100 @ A3

Previously Approved Second Floor Plan 1:100 @ A3