

Note!

The below describes the modifications to the property since Mr. Rashid has taken control of the property.

- ① - Counter tops installed for the purpose of hot drink preparation and cash handling.
- ② - Fixed seating installed in cafe.
- ③ - Refrigerated display case removed and counter top installed in place.
- ④ - Existing circular columns boxes - renewed faces installed.
- ⑤ - Additional booth installed .
- ⑥ - Refrigerated / wooden display cases installed for display of food and drinks.
- ⑦ - Door to washing area replaced.
- ⑧ - Two cubicles installed in female WC.
- ⑨ - Hand wash basin installed in female WC.
- ⑩ - Partition wall and door installed in male WC.
- ⑪ - Dual hand wash basin installed in male WC.
- ⑫ - Shower removed and male toilet installed.

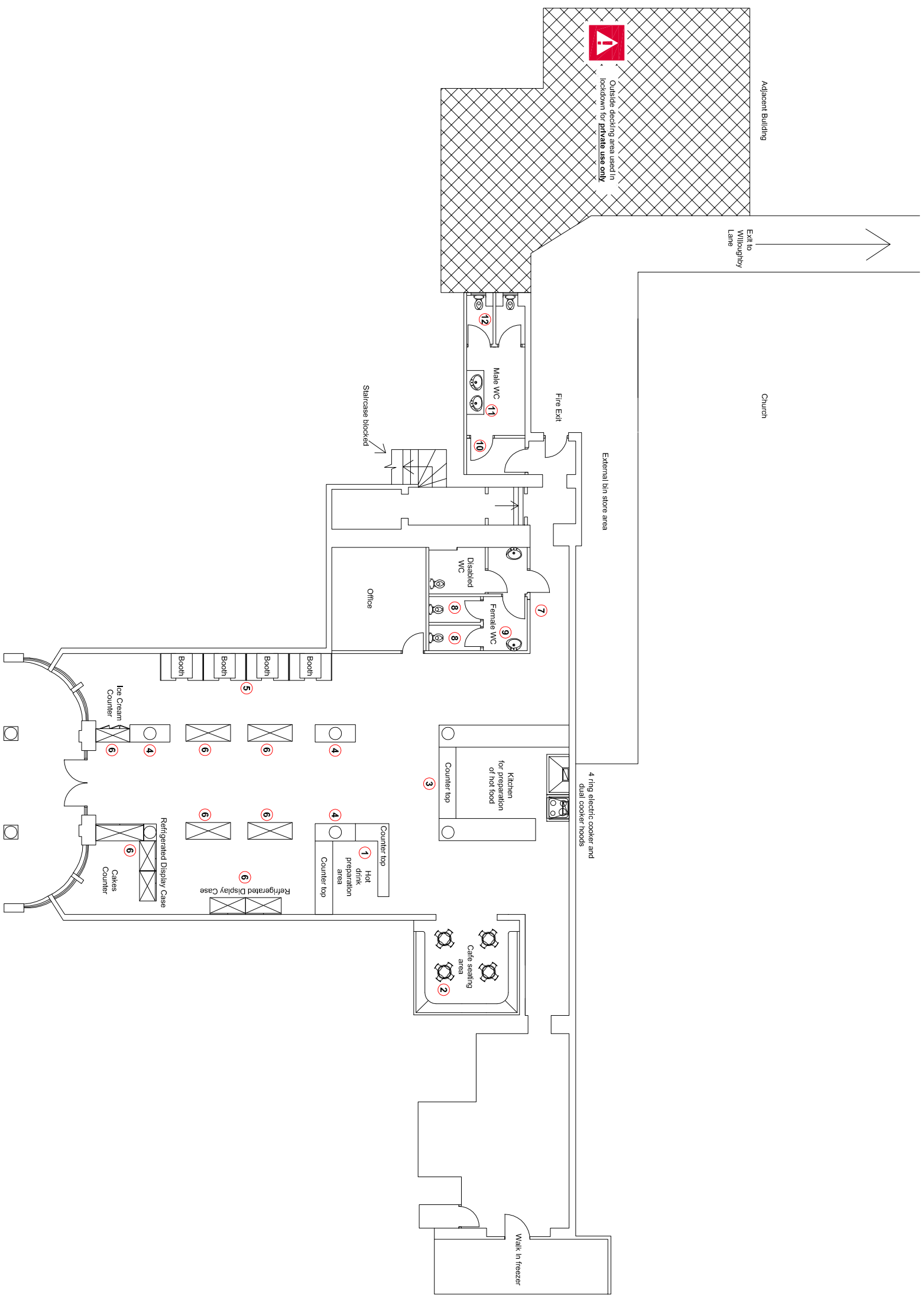

Status - For Info Only
08/2021

General Arrangement Drawing

<p>RB-D The View Glasgow, G2 1 2JH Phone: +44 (0)7528 818031</p>		<p>RB Designs Mail: rdesigns@btinternet.com</p>	
Client	Mr. Rashid / Annesland Mansion	Drawn By	RB
Project	1601 Great Western Road	Checked	RB
Date	07/2019	Scale	1:100
Title	Shop Layout	Sheet	1
Scale	1:100	Revision	2
Project No.	04-0036125-A001		