

Legend:

- Survey Extents
- Category A Trees (Stem and Canopy Spread)
- Category B Trees (Stem and Canopy Spread)
- Category C Trees (Stem and Canopy Spread)
- Category U Trees (Stem and Canopy Spread)
- Root Protection Area
- Tree Protection Fencing
- Construction Exclusion Zone (area required to protect retained trees roots and canopy)
- Indicative location of replacement planting

Replacement planting is proposed in mitigation for the loss of the apple and lilac within the site. Replacement species will be Apple (*Malus* sp.) Pear (*Pyrus* sp) and or plum (*Prunus* sp.)

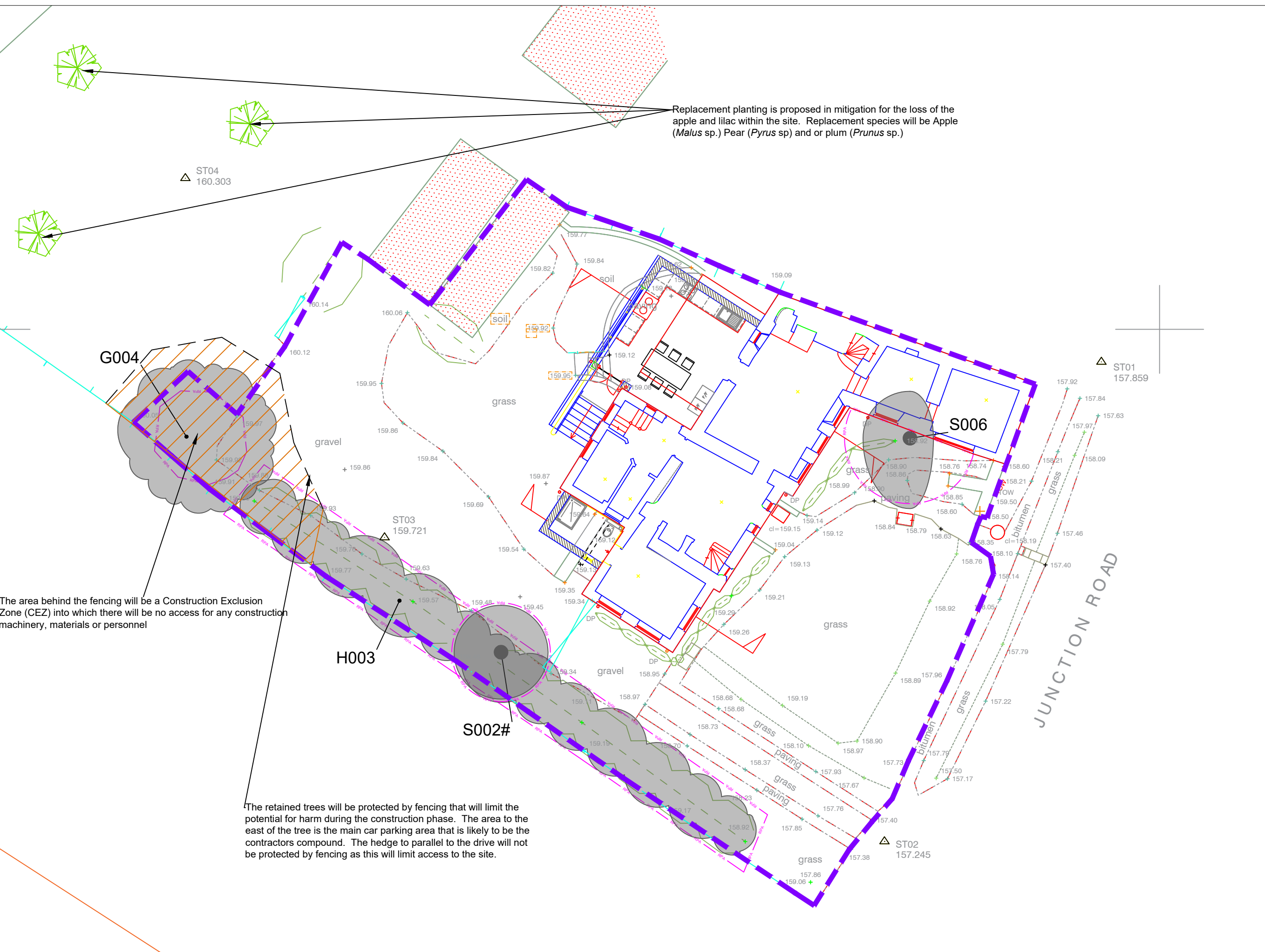

The area behind the fencing will be a Construction Exclusion Zone (CEZ) into which there will be no access for any construction machinery, materials or personnel

The retained trees will be protected by fencing that will limit the potential for harm during the construction phase. The area to the east of the tree is the main car parking area that is likely to be the contractors compound. The hedge to parallel to the drive will not be protected by fencing as this will limit access to the site.

The original of this drawing was produced in colour - a monochrome copy should not be relied upon.

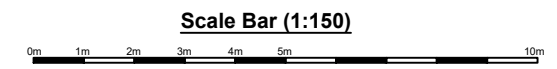

CLIENT:	Mr & Mrs Covington	
PROJECT/SITE:	Barley Cottage Churchill	
TITLE:	Tree Protection Plan	
MAP REF:	74-BAR-DRW-TPP	
REVISION:	01	
LAYOUT:	Site Layout	
DATE:	07.09.2021	PRODUCED BY: NB
SCALE:	1:150@A3	REVIEWED BY: -