

NOTES

1. TO BE READ IN CONJUNCTION WITH THE STANDARD LANDSCAPING SPECIFICATION.
2. ALL WORK TO BE CARRIED OUT TO THE SATISFACTION OF THE LANDSCAPE ARCHITECT AND IN ACCORDANCE WITH THE RELEVANT CURRENT BRITISH STANDARDS.
3. NO PLANTING PORTION SHALL BE ALTERED WITHOUT THE APPROVAL OF THE LOCAL PLANNING AUTHORITY AND LANDSCAPE ARCHITECT.
4. LANDSCAPE AREAS SHALL BE TOP SOILED TO THE FOLLOWING MINIMUM DEPTHS (GRAVELLED AREAS - 150mm, GRASS AREAS - 150mm, STANDARD TREES 1000 X 1000 X 800mm - 150mm, STANDARD TREES 1000 X 1000 X 1000mm, ALL TOPSOIL, TO BESSID GENERAL GRADE, TOP SOILED AREAS TO BE CULTIVATED BY HAND OR MACHINE PRIOR TO PLANTING WITH MAXIMUM COMPACTON BY MACHINES, TREE PITS SHALL INCORPORATE TREE FERTILISER TO MANUFACTURERS SPECIFICATION.
5. ALL AREAS OF PUBLIC OPEN SPACE AND BACK GARDENS SHALL BE PROTECTED FROM COMPACTION ASSOCIATED WITH DEVELOPMENT. IN ACCORDANCE WITH BS 5877 (PART 1:2.2), IF COMPACTION HAS OCCURRED SOIL SHALL BE BRITTED TO A SUFFICIENT LEVEL TO BREAK ANY SUBSOIL PAN BEFORE CULTIVATION. FOR NON-TREE TREES RECOMENDATION WITH REMEDIATED AREAS SHALL BE ADVISED BY THE LOCAL PLANNING AUTHORITY OF A MINIMUM TREE PIT 400mm DEEP BY 700mm AND LOOSENING THE SUBSOIL LAYER FOR A FURTHER 300-400mm. THE PIT SHALL THEN BE REFILLED WITH HIGH TOP GRADE TOP SOIL AS ABOVE.
6. ALL TREES SHALL BE SECURED WITH IRRODERIVABLE TIES. SPACING THE FROM TRUNK TREE TIES, THE STOPS FROM OF ONE JOINTED WITH PROSPERATING BETWEEN THE END AND FOOT AND SECURED FROM BELOW THE TOP OF THE PLANT WITH BRASS OR ALUMINUM RINGS. INSTRUCTIONS TO STAKE THE END STAKES IN ABOVE THE SHOULDER LINE, STAKES SHALL BE FITTED AT LEAST 400mm INTO GROUND, STAKES SHINE FOR STAKES AND DOUBLE FOR HEAVY STAKES AND ABOVE STAKES SHALL BE REINFORCED WITH BRASS OR ALUMINUM TIES. TIES, WHEN TREES ARE ESTABLISHED, EACH TREE TREE PIT SHALL INCORPORATE A DEEP HOSE BRITTS TO FACILITATE A HOSE BEING REACHED TO AROUND THE TREE TRUNK. ALL TREES PLANTED IN GARDENS SHALL BE FITTED WITH WOODEN TRUNK GUARDS.
7. ALL PROPOSED NATIVE TREES AND SHRUBS SHALL, WHERE POSSIBLE, BE OBTAINED WITH LOCAL PROVENANCE.
8. ALL PLANT MATERIAL PROCESSED ARE TO CONFORM TO THE RELEVANT BRITISH STANDARDS (VARIOUS CODES OF PRACTICE AND THE SPECIFICATION.
9. ALL SHRUBS ARE TO BE PLANTED WITH AT LEAST 3 STRONG BRANCHES AND SUPPLIED CONTAINER GROWN, SHRUBS TO BE PLANTED IN ROLLS 800 BROAD TO ACCOMMODATE THE PLANT WITH ROOT DURING THE ROOTS (40% SHOWN) PLANTS TO BE PLANTED, WATERED IN AND DECONTAMINATED BRANCHES REMOVED AFTER PLANTING.
10. PLANTING SHALL BE APPLIED AT MANUFACTURERS RECOMMENDED QUANTITIES DURING PLANTING.
11. A 150mm DEEP FERTILISER SHALL BE APPLIED AFTER PLANTING IN ACCORDANCE WITH MANUFACTURERS INSTRUCTIONS.
12. BEFORE PLANTING, ROTAVATE AND LEVEL TOPSOIL AS REQUIRED, REMOVE DEBRIS AND STONES ABOVE 50mm DIA, AND PREPARE FERTILISER TO MANUFACTURERS SPECIFICATION. TIE SHALL BE WEED FREE, LAY FROM PLANTS (100mm DIA) WITH BRASS OR ALUMINUM AND WELL BUTTED UP. FINISHED COMPACTED LEVELS TO BE A MINIMUM OF 100mm ABOVE ADJACENT HARD SURFACES, WATER AS NECESSARY TO AVOID DRAINAGE.
13. GRASS SEED SHALL BE SOWN DURING MAY/JUNE, OR SEPTEMBER. TOP SOIL TO BE ROTAVATED AND LEVELLED AS REQUIRED, REMOVED DEBRIS AND STONES ABOVE 25mm DIA, PREPARED FERTILISER TO BE APPLIED AT MANUFACTURERS SPECIFICATION. SEED TO BE APPLIED AT A MINIMUM OF 100mm PER SQUARE METRE. AREA TO BE LIGHTLY RAKED OVER AND WATERED WHERE POSSIBLE AFTER SOWING TO AID ESTABLISHMENT. FINISHED COMPACTED LEVELS AS ABOVE.
14. WHERE APPROPRIATE HEDGE SPECIES SHALL BE PLANTED TO UP TO ONE THIRD, TO PROMOTE BURNY GROWTH.
15. TREE POSITIONS HAVE BEEN CHOSEN IN ACCORDANCE WITH PRACTICE NOTE 42 OF THE NLA. G. RAISE FOUNDATIONS IN EX. THEREFORE TREE AND SHRUB POSITIONS WILL NOT EFFECT FOUNDATIONS.
16. ALL PREPARATIONS, BOTH HAND AND MPT UNDERGROUND TREES MUST BE CARRIED OUT BY HAND TO PROTECT ROOTS.
17. PLANTING WILL COMMENCE DURING THE WINTER PLANTING SEASON (AND NOT BE MAXIMA AFTER EARLY SPRING). COMPLETION OF THE SITE AND COMPLETED DURING THE NEXT PLANTING SEASON WITH COMPLETION IN COMPLETED.
18. ANY TREE, SHRUB OR AREA OF TURF SHALL BE REPLACED WITHIN A PERIOD OF FIVE YEARS IF THEY DIE WITHIN THE NEXT PLANTING SEASON WITH ANOTHER SUCH PLANT OF SIMILAR SIZE AND SPECIES.
19. PLANT OR PLANT BASED MATERIAL SHALL NOT BE USED WHERE POSSIBLE ON SITE.
20. WHERE POSSIBLE, ALL PLANTS SHALL BE OBTAINED IN A PLANT FREE COMPART WHEN CONTAINER GROWN PLANTS ARE SPECIFIED.

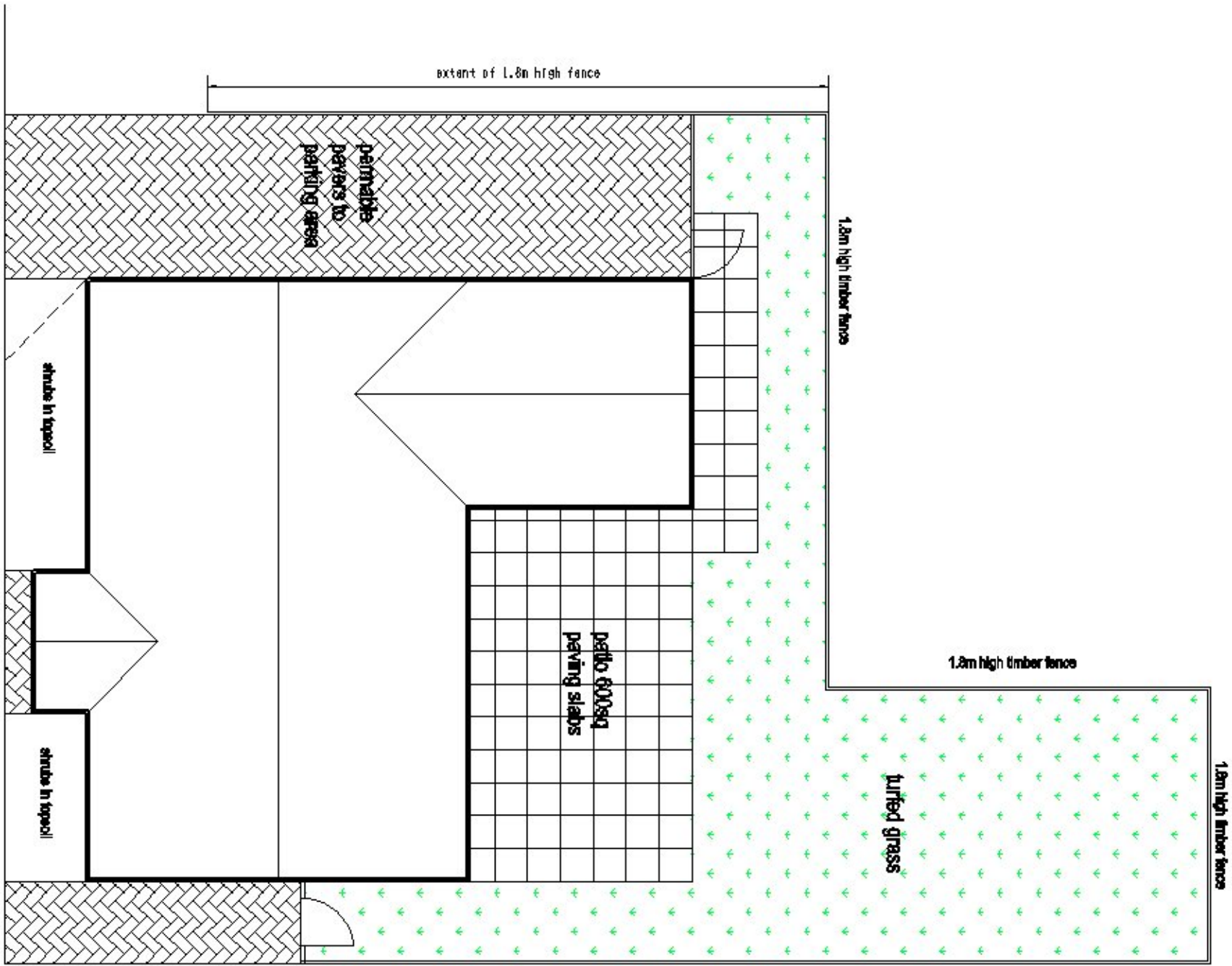

Landscaping Plan

1:100

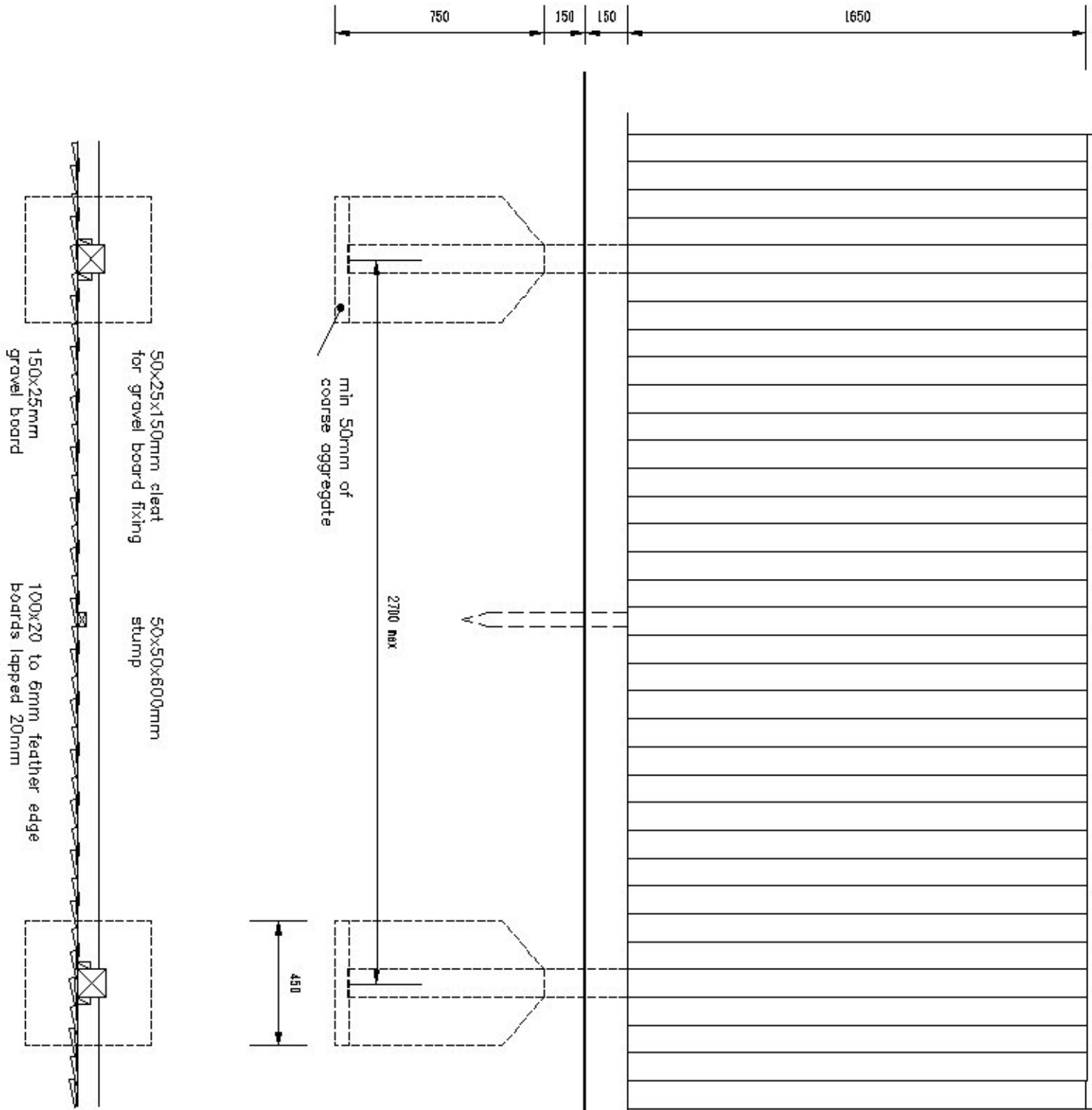
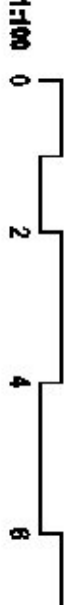

all timber to be treated
softwood all nails to be
sherrodized

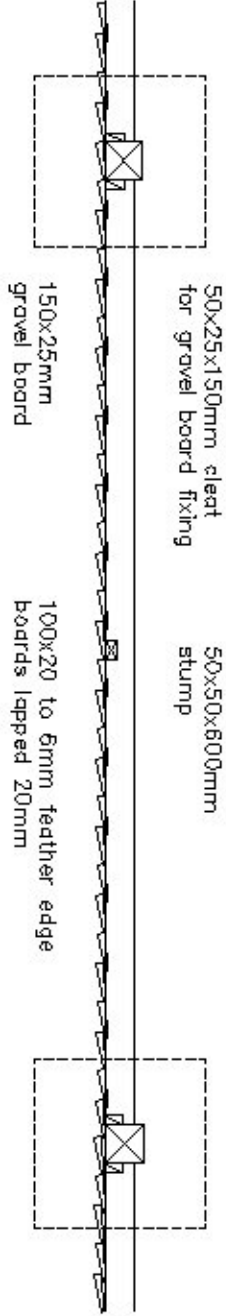

MDL



Landscaping plan

Project Land at Arthur Ransome Way
Walton on the Naze

Client Agria New Homes Limited

Date 08.2021

Scale print at A1 Draw DL

Drawing 208 PL 02 Rev

MDL DESIGN LTD
HOLFIELD, THE DITCH, CHELSEA, SW15 2ES
020 7581 1111
www.mdl-design.co.uk
MDL DESIGN LTD is a limited liability company registered in England and Wales. The company number is 11111111. The company is registered with the Architects Registration Board (ARB) and the Landscape Institute (LI). The company is a member of the Chartered Institute of Building (CIOB) and the Chartered Institute of Design Engineers (CIDE). The company is a member of the Chartered Institute of Marketing (CIM) and the Chartered Institute of Public Relations (CIPR). The company is a member of the Chartered Institute of Management Education (CIMA) and the Chartered Institute of Personnel and Development (CIPD). The company is a member of the Chartered Institute of Procurement and Supply (CIPS) and the Chartered Institute of Purchasing and Supply (CIPS).