

All dimensions to be verified on site and any discrepancies reported without delay. Figures dimensions to be taken in preference to those shown on drawings. This drawing is the property of CUSSEN CONSTRUCTION and shall remain the property of CUSSEN CONSTRUCTION. No part of this drawing is to be copied, reproduced, or in part without the prior consent in writing of CUSSEN CONSTRUCTION CONSULTANTS (Fyne Designs Ltd).

IF IN DOUBT - ASK!

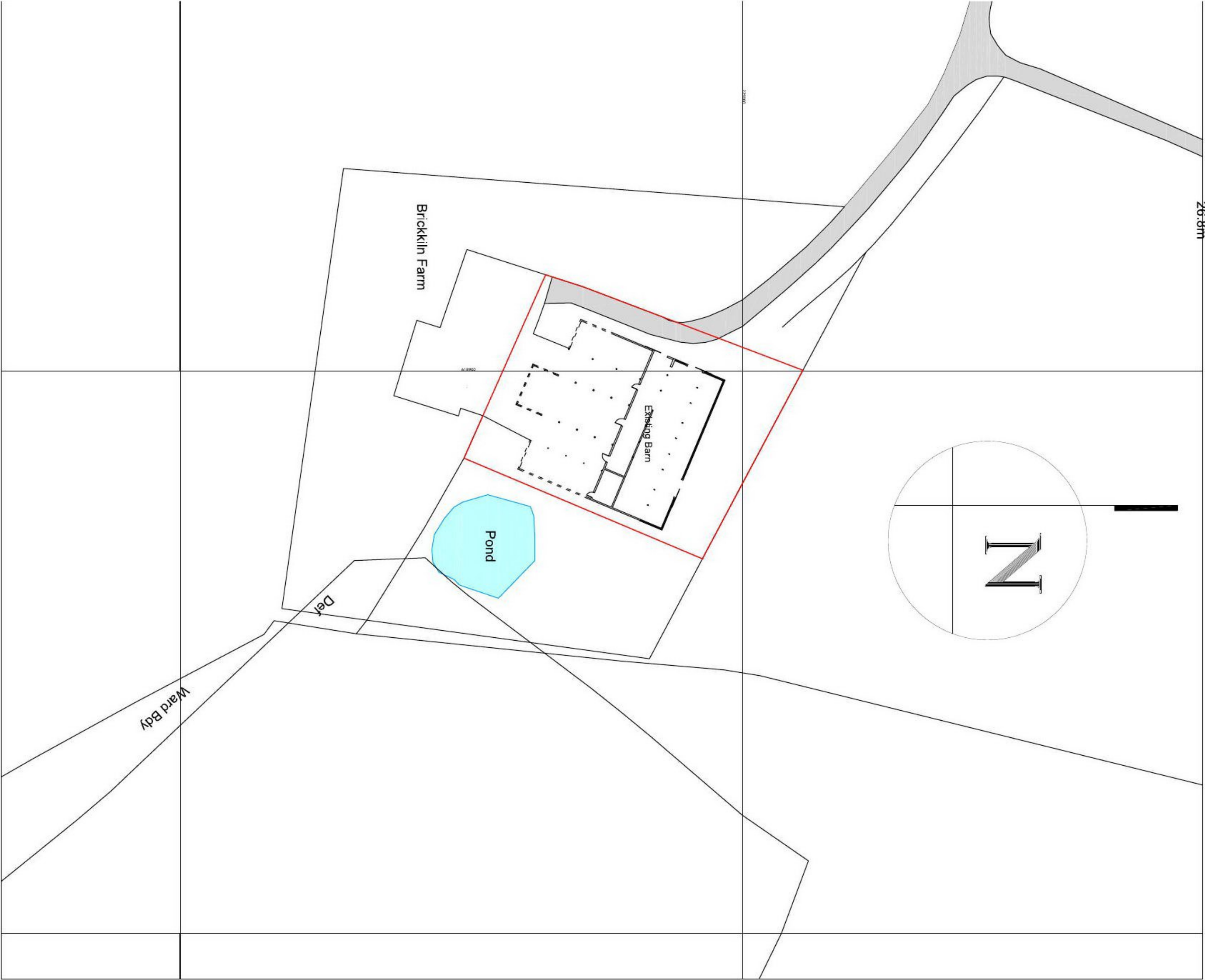

Existing Site Plan

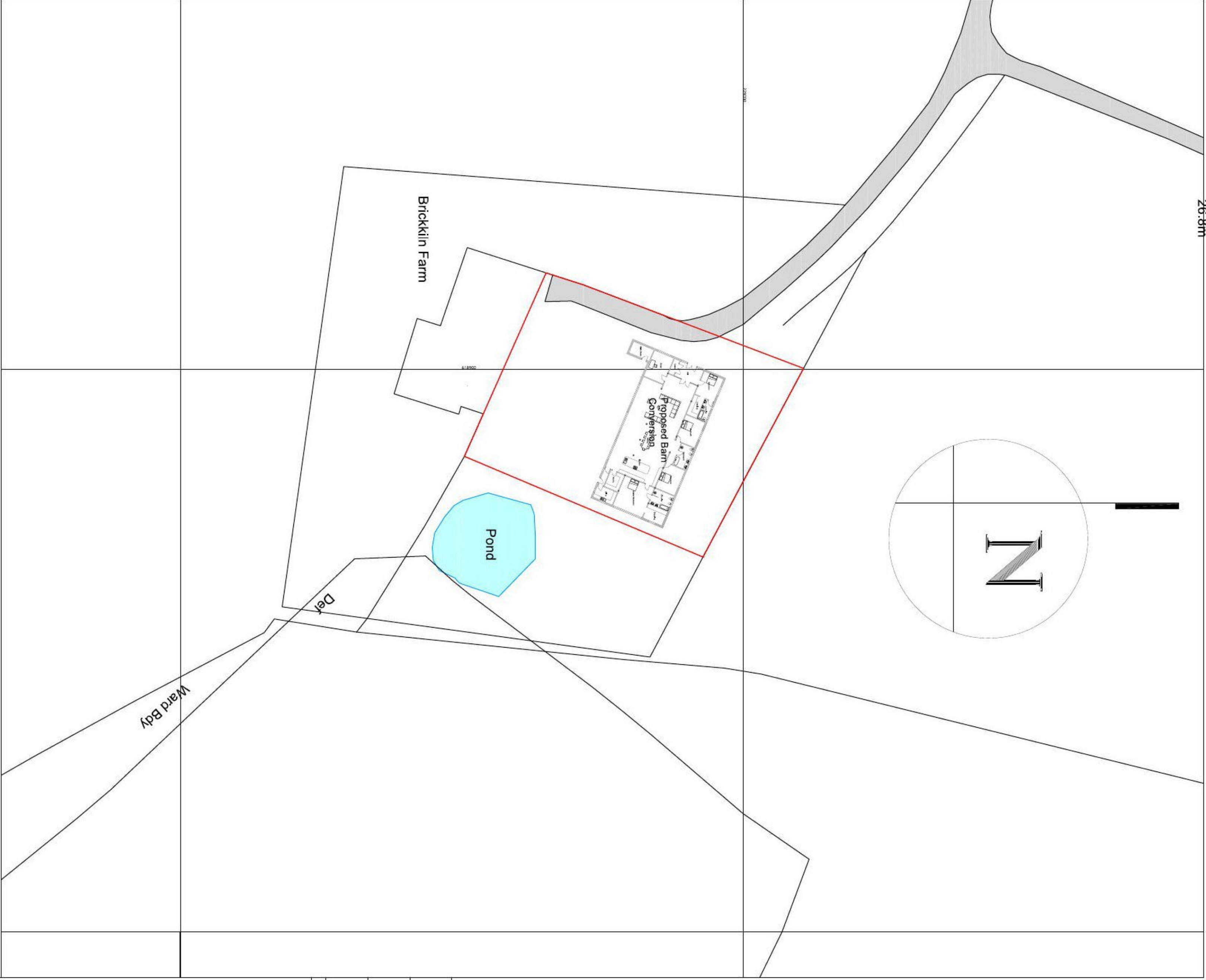

Proposed Site Plan

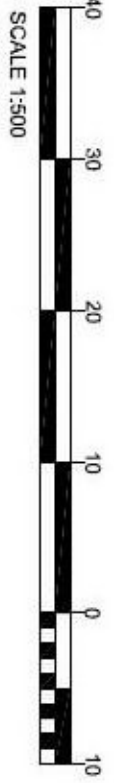

REVISION	DATE

Construction Consultants
Proprietors - Fyne Designs Ltd
U
Fyne Designs
S The Poplars
Mill End
Brundwell on Sea
Essex CM8 7HU
S
CIOB

Project: Proposed change of use to residential dwelling
dwelling
Brick Kiln Barn, Brick Kiln Farm
Tinker Street, Ramsey, Essex.

Drawing

Proposed Elevations

Client: Damien Emmond

Drawn: T.C Date: September 2021

Scale: 1:500 @ A1 Drawing No: 1202/ 03