

Riverside Energy Park

Construction Traffic Management Plan

Electrical Connection – London Borough of Bexley

In accordance with Requirement 13, Schedule 2, of the Riverside Energy Park Order (2020) as amended

Appendix A EC Route Alignment Plans FS-100



Appendix A Electrical Connection Route Alignment Plans

A.1 Overall Route

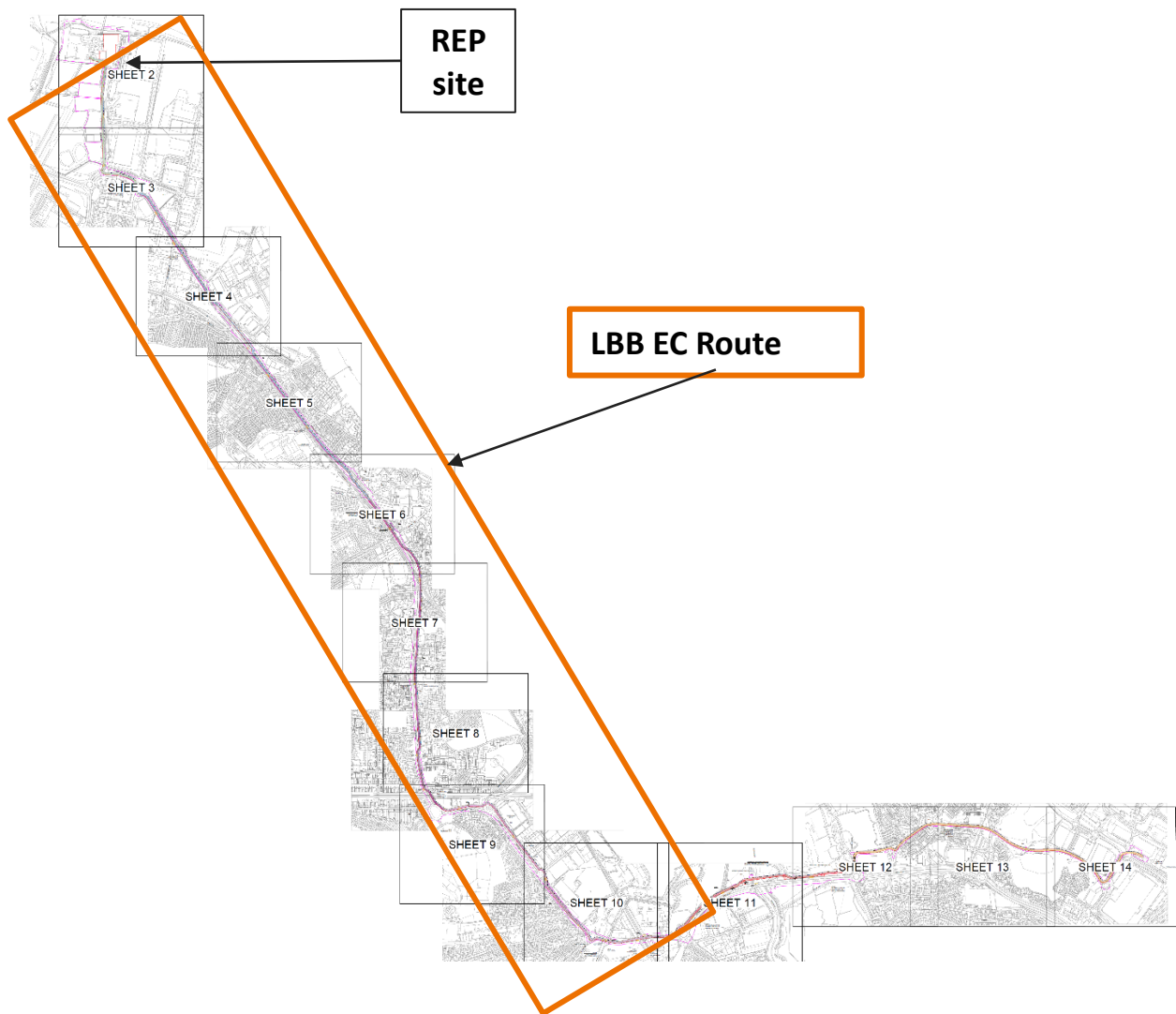

A.2 Route alignment within Borough of Dartford

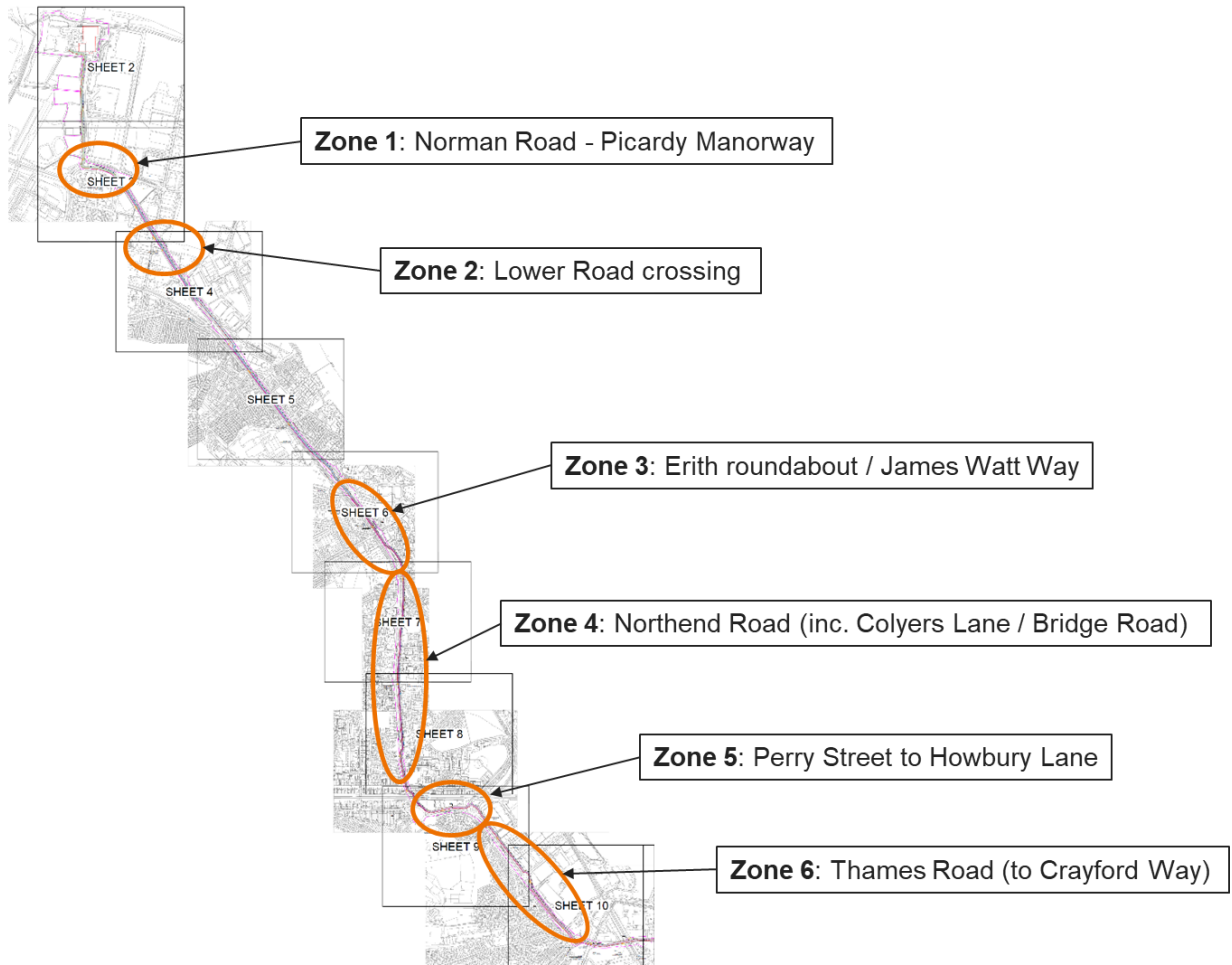

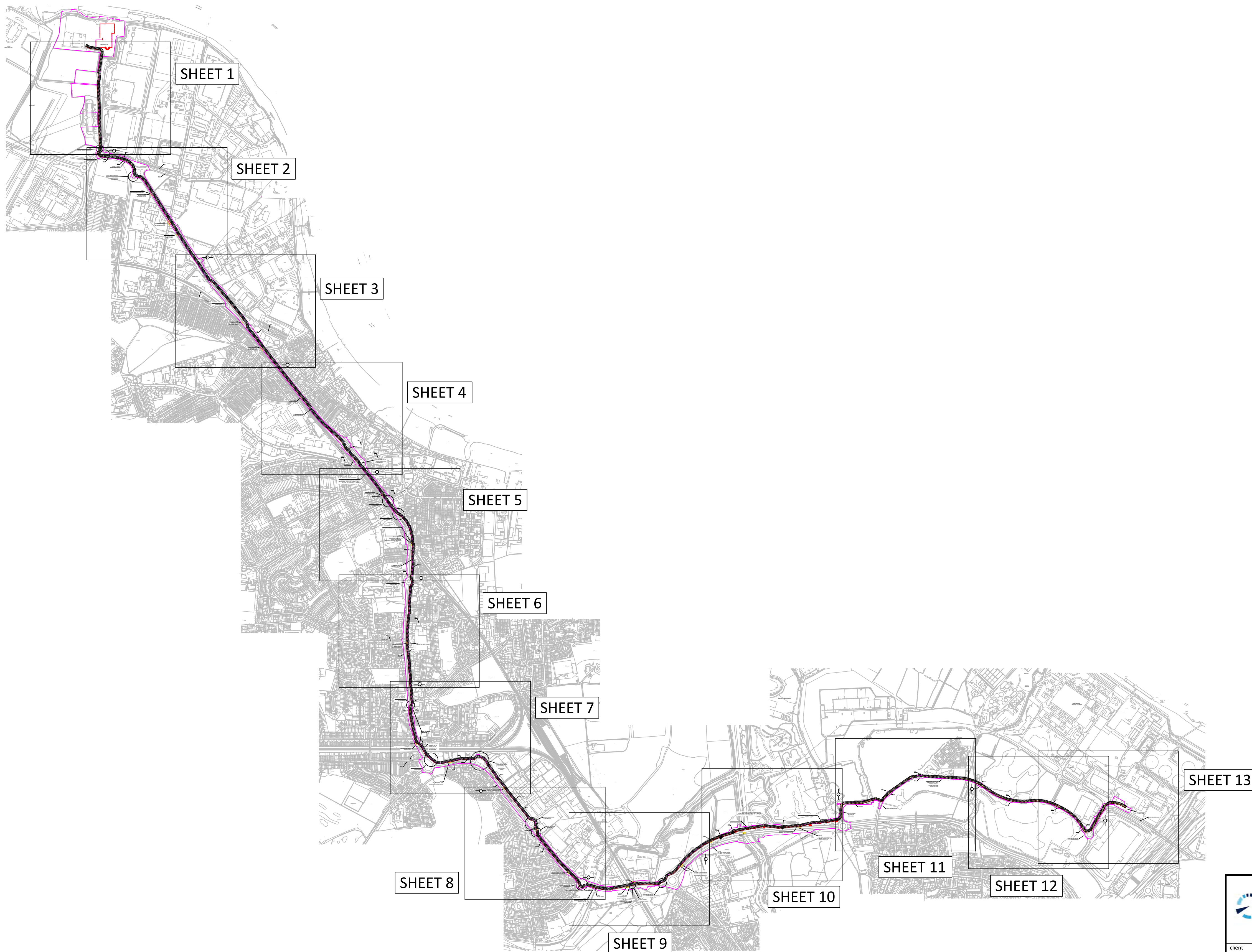
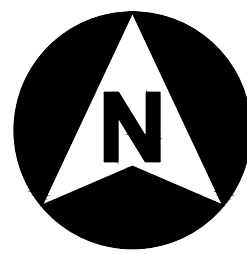

LEGEND:

WORKING HOURS SCHEDULE

WEEKDAY WORKING
 NORMAL HOURS: 8AM - 6PM
 NORMAL PLUS EXTENDED: 7AM - 8PM
 NIGHT WORKING: 8PM - 6AM

WEEKEND HOURS
 NORMAL HOURS: 8AM - 6PM
 NORMAL PLUS EXTENDED: 7AM - 8PM
 NIGHT WORKING: 8PM - 6AM

INDICATES DCO BOUNDARY

		Compass Infrastructure UK Ltd. 7 Maitland Road Lion Barn Industrial Estate Needham Market Suffolk, IP6 8NZ Tel: +44(0)1449 727 600 Web: www.ci-uk.com			
client		UK POWER NETWORKS			
description		RIVERSIDE ENERGY FS 2 DETAILED DESIGN SAP No. 530014536			
drawn	JHY	d.d	08/04/21	initials	size: A1
reviewed	JBA	d.d	08/04/21	initials	scale: NTS
approved	JBA	d.d	08/04/21	initials	units: -
status stamp		version	projectno	Compass	sheetdescription
FEASIBILITY		Rev14	20-0517	-	FS - 001 -0/14



REP DEVELOPMENT SITE

RRRL FACILITY

LEGEND:

TH1 INDICATES LOCATION OF TRIAL HOLE

INDICATES PHASE 1 WORKS

PHASE 1
COMMENCEMENT DATE: 16/05/22
COMPLETION DATE: 01/08/22

STR1
COMMENCEMENT DATE: 16/05/22
COMPLETION DATE: 03/06/22

INDICATES DCO BOUNDARY

INDICATES VEGETATION TO BE REMOVED

INDICATES CROSS SECTION NUMBERS, EVERY 5m

TYPICAL REINSTATEMENT - FOOTWAY

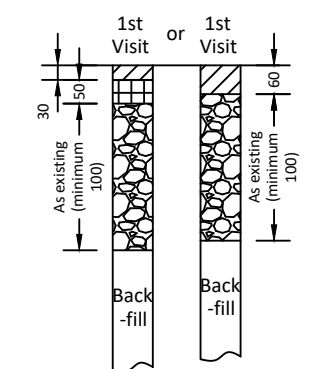

TYPICAL REINSTATEMENT - CARRIAGEWAY

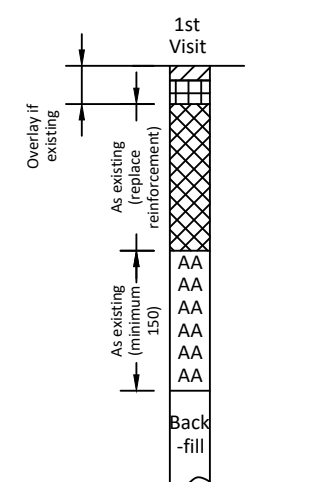

STR1 NORMAN ROAD
DURATION 15 DAYS

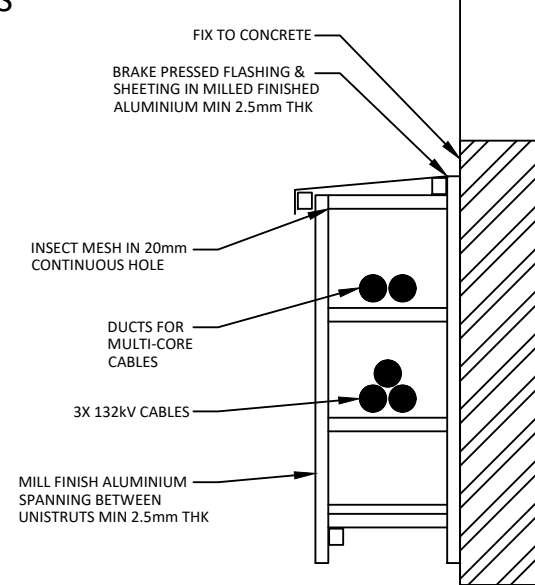

INDICATIVE PROFILE

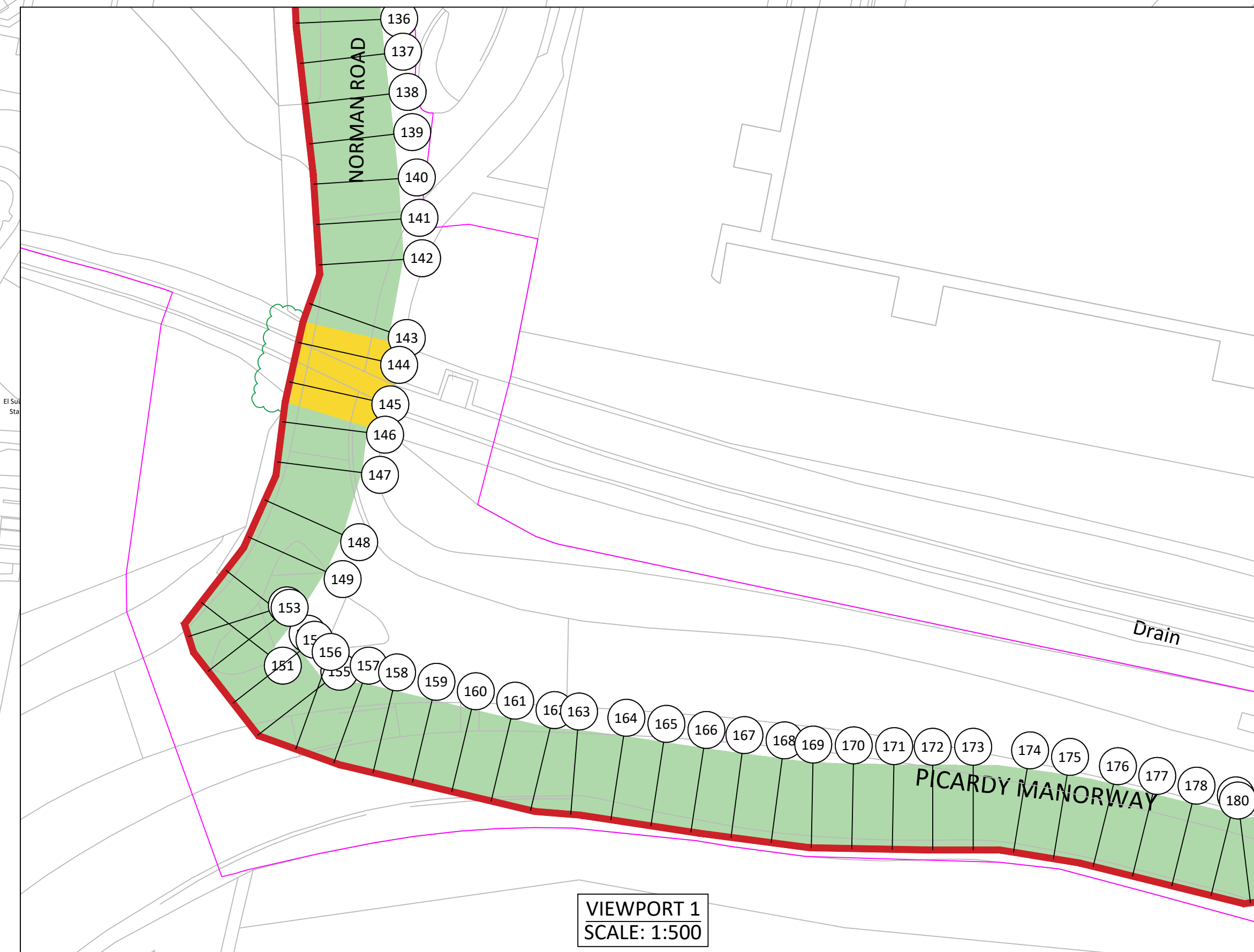

VIEWPORT 1
SCALE: 1:500

TH1
OUT OF HOURS WORKING

CUTLINE 'A'

B2



Compass Infrastructure UK Ltd.
7 Maitland Road
Lion Barn Industrial Estate
Needham Market
Suffolk, IP6 8NZ
Tel: +44(0)1449 727 600
Web: www.ci-uk.com

client
UK POWER NETWORKS

description
RIVERSIDE ENERGY FS 2
DETAILED DESIGN
SAP No. 530014536

drawn	JHY	d.d	08/04/21	initials	size:	A1	specifications number:
reviewed	JBA	d.d	08/04/21	initials	scale:	1:1250	
approved	JBA	d.d	08/04/21	initials	units:	-	
status stamp	version	projectno	Compass	sheetdescription	sheet		
FEASIBILITY	Rev14	20-0517	-	FS - 001	-1/14		

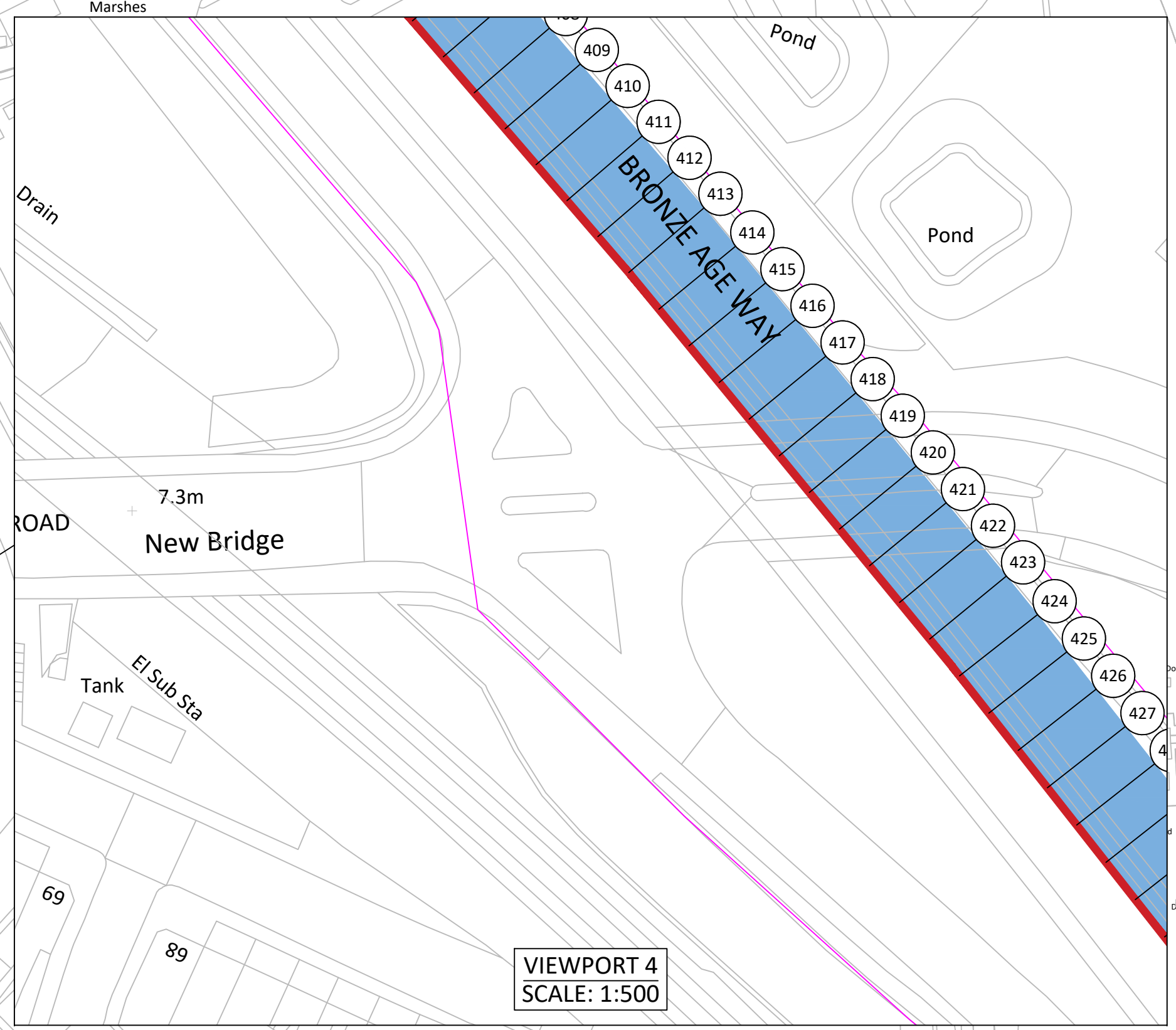
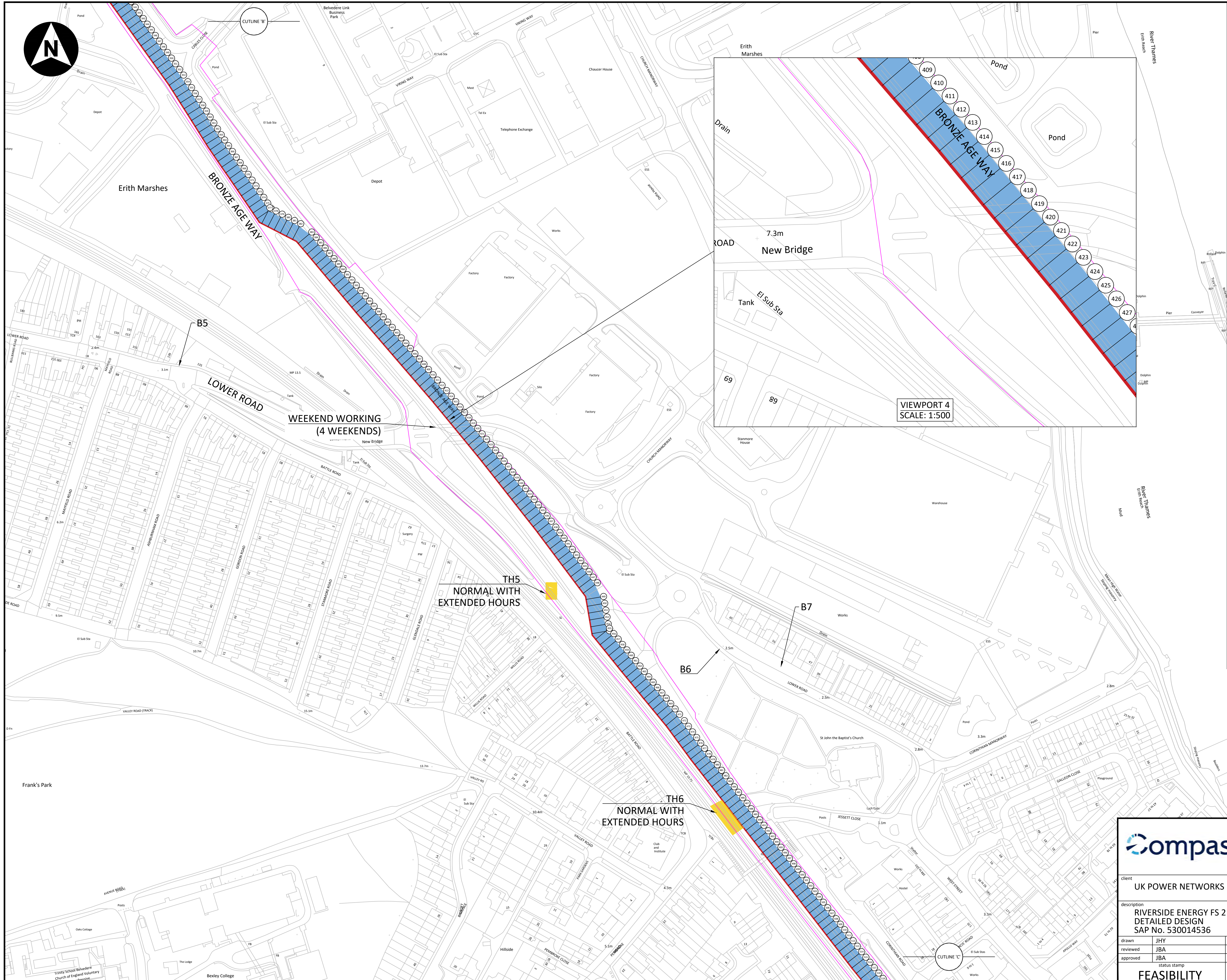

LEGEND:

TH1 INDICATES LOCATION OF TRIAL HOLE
 B1 etc. INDICATES EXISTING BUS STOPS
 TB1 INDICATES TEMPORARY BUS STOPS

INDICATES PHASE 2 WORKS

PHASE 2
 COMMENCEMENT DATE: 05/12/22
 COMPLETION DATE: 16/05/23

STR2
 COMMENCEMENT DATE: 06/06/22
 COMPLETION DATE: 10/06/22

INDICATES DCO BOUNDARY

INDICATES CROSS SECTION NUMBERS, EVERY 5m

TYPICAL REINSTATEMENT - FOOTWAY

TYPICAL REINSTATEMENT - CARRIAGEWAY

Compass

Compass Infrastructure UK Ltd.
 7 Maitland Road
 Lion Barn Industrial Estate
 Needham Market
 Suffolk, IP6 8NZ
 Tel: +44(0)1449 727 600
 Web: www.ci-uk.com

client
UK POWER NETWORKS

description
**RIVERSIDE ENERGY FS 2
 DETAILED DESIGN
 SAP No. 530014536**

drawn	JHY	d.d. 08/04/21	initials	size: A1	specifications number:
reviewed	JBA	d.d. 08/04/21	initials	scale: 1:1250	
approved	JBA	d.d. 08/04/21	initials	units: -	
status stamp	version	projectno. Compass	sheetdescription	sheet	

FEASIBILITY Rev14 20-0517 - FS - 001 -3/14

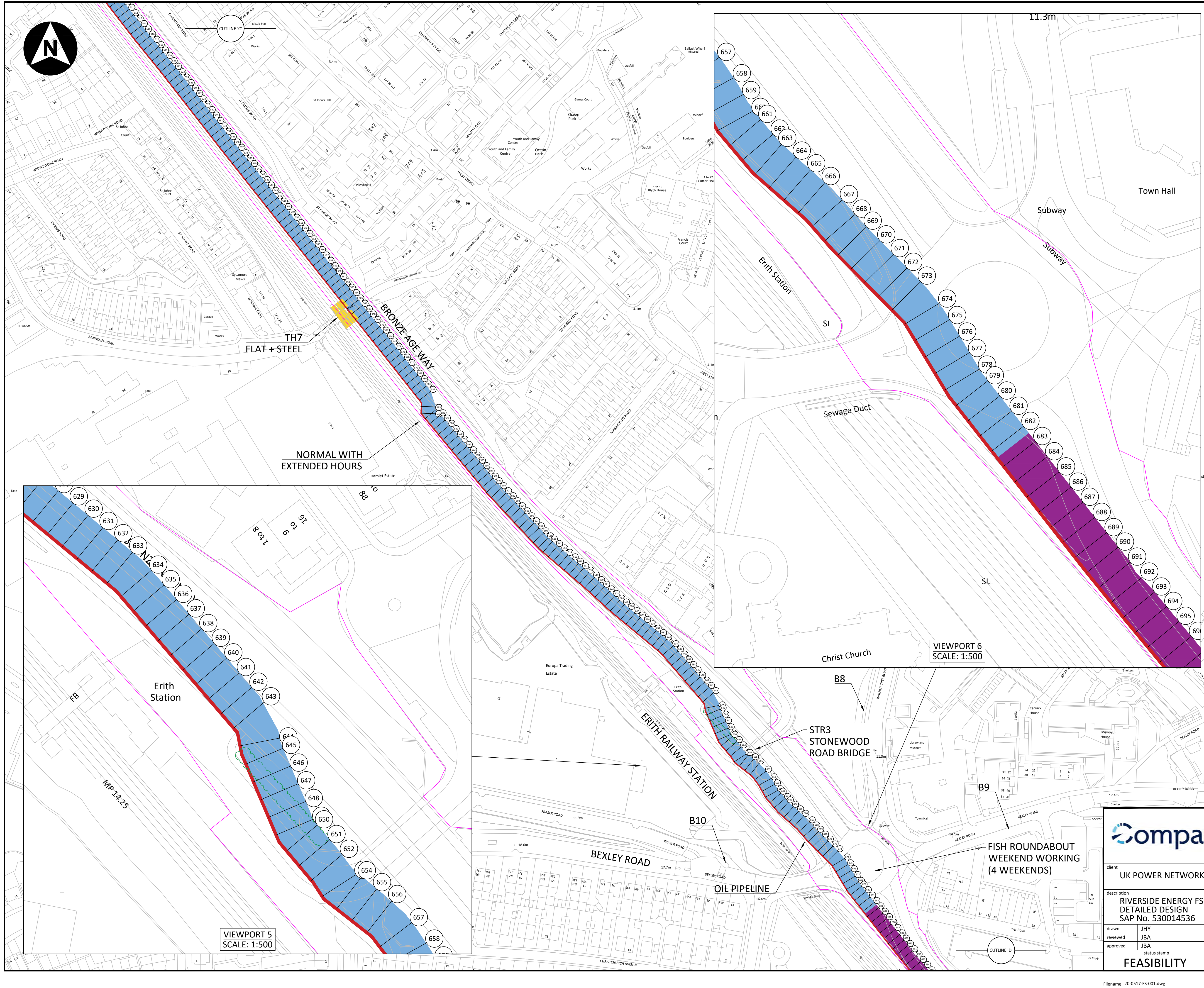

- LEGEND:**
- TH1 INDICATES LOCATION OF TRIAL HOLE
B1 etc. INDICATES EXISTING BUS STOPS
TB1 INDICATES TEMPORARY BUS STOPS
 - INDICATES PHASE 2 WORKS
 - PHASE 2 COMMENCEMENT DATE: 05/12/22
COMPLETION DATE: 16/05/23
 - INDICATES PHASE 3 WORKS
 - PHASE 3 COMMENCEMENT DATE: 22/07/22
COMPLETION DATE: 19/12/22
 - INDICATES DCO BOUNDARY
 - INDICATES VEGETATION TO BE REMOVED
 - INDICATES CROSS SECTION NUMBERS, EVERY 5m

TYPICAL REINSTATEMENT - FOOTWAY

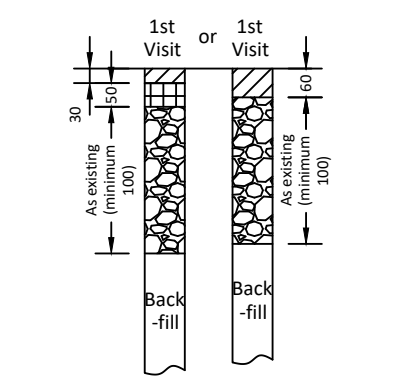

TYPICAL REINSTATEMENT - CARRIAGEWAY

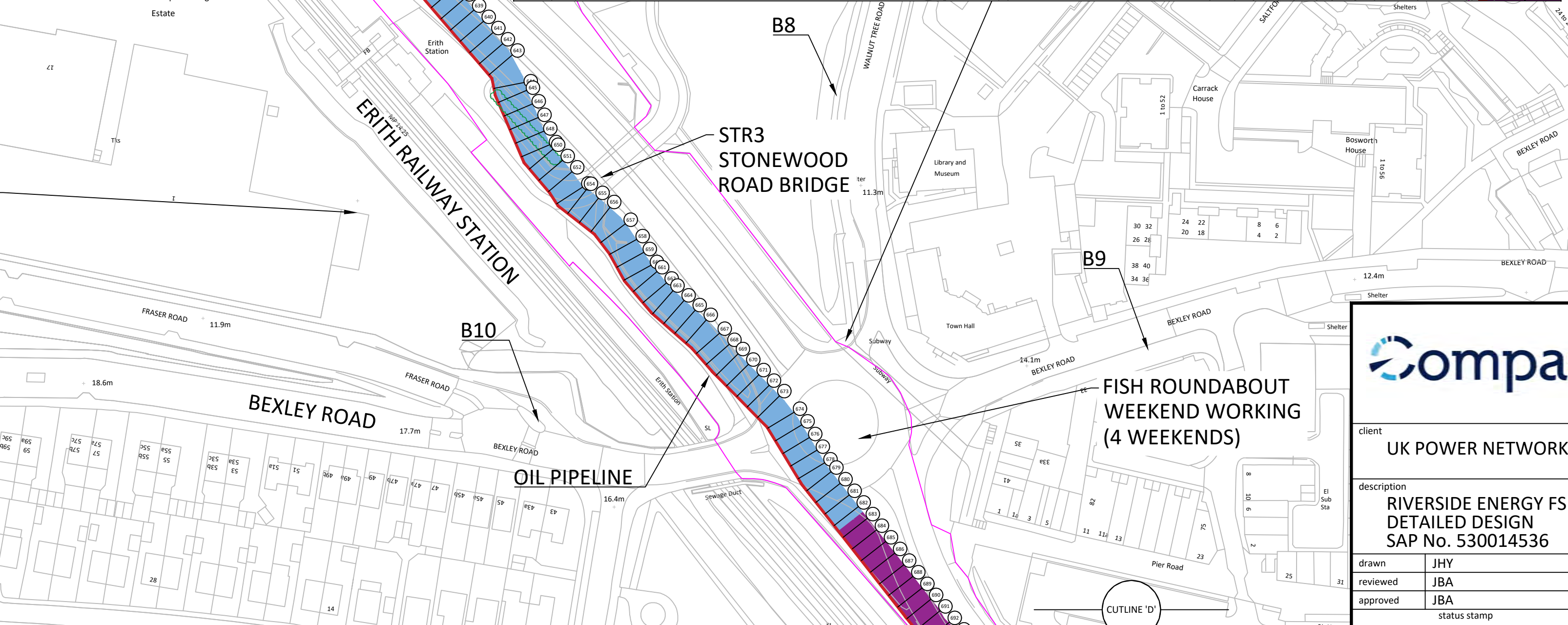
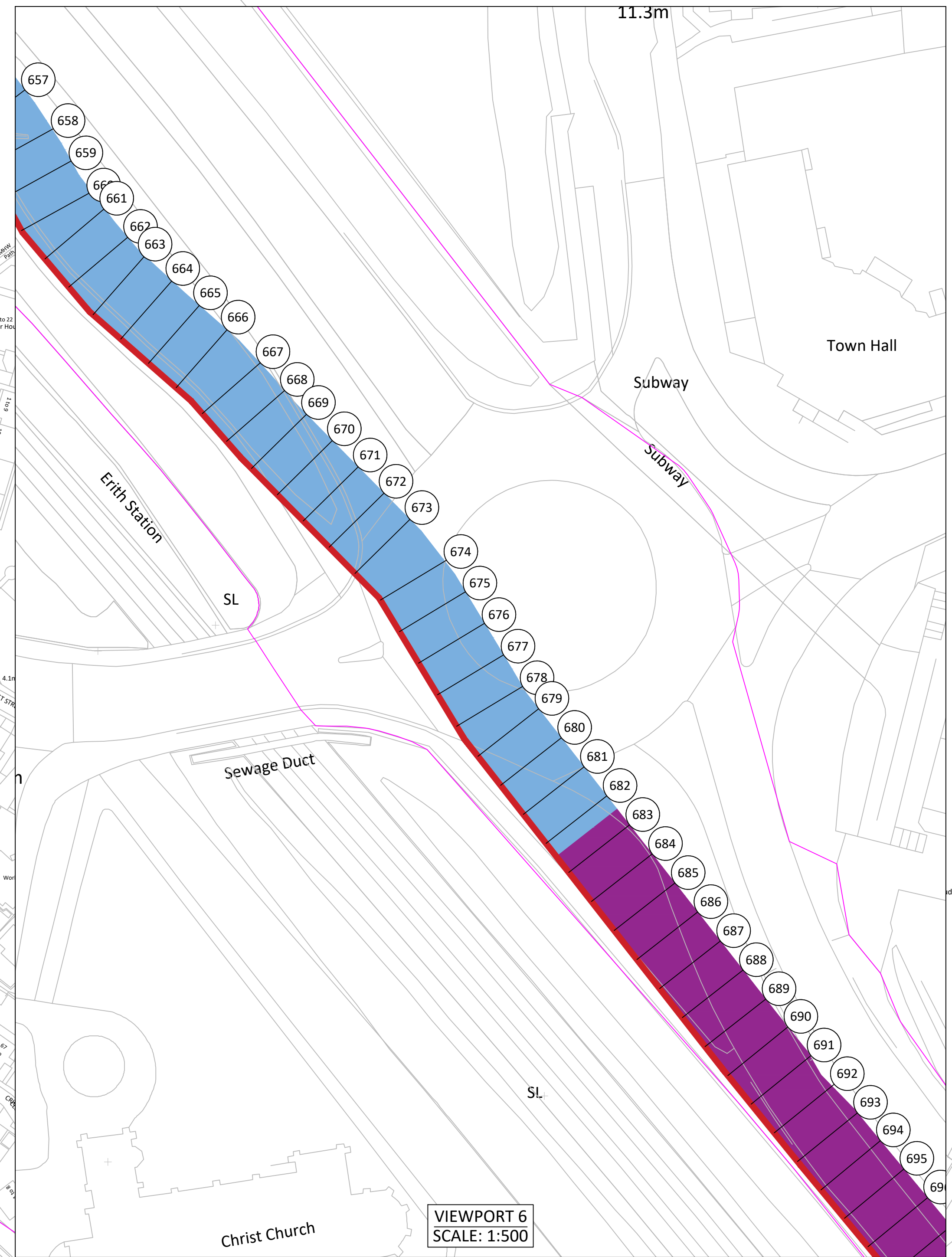
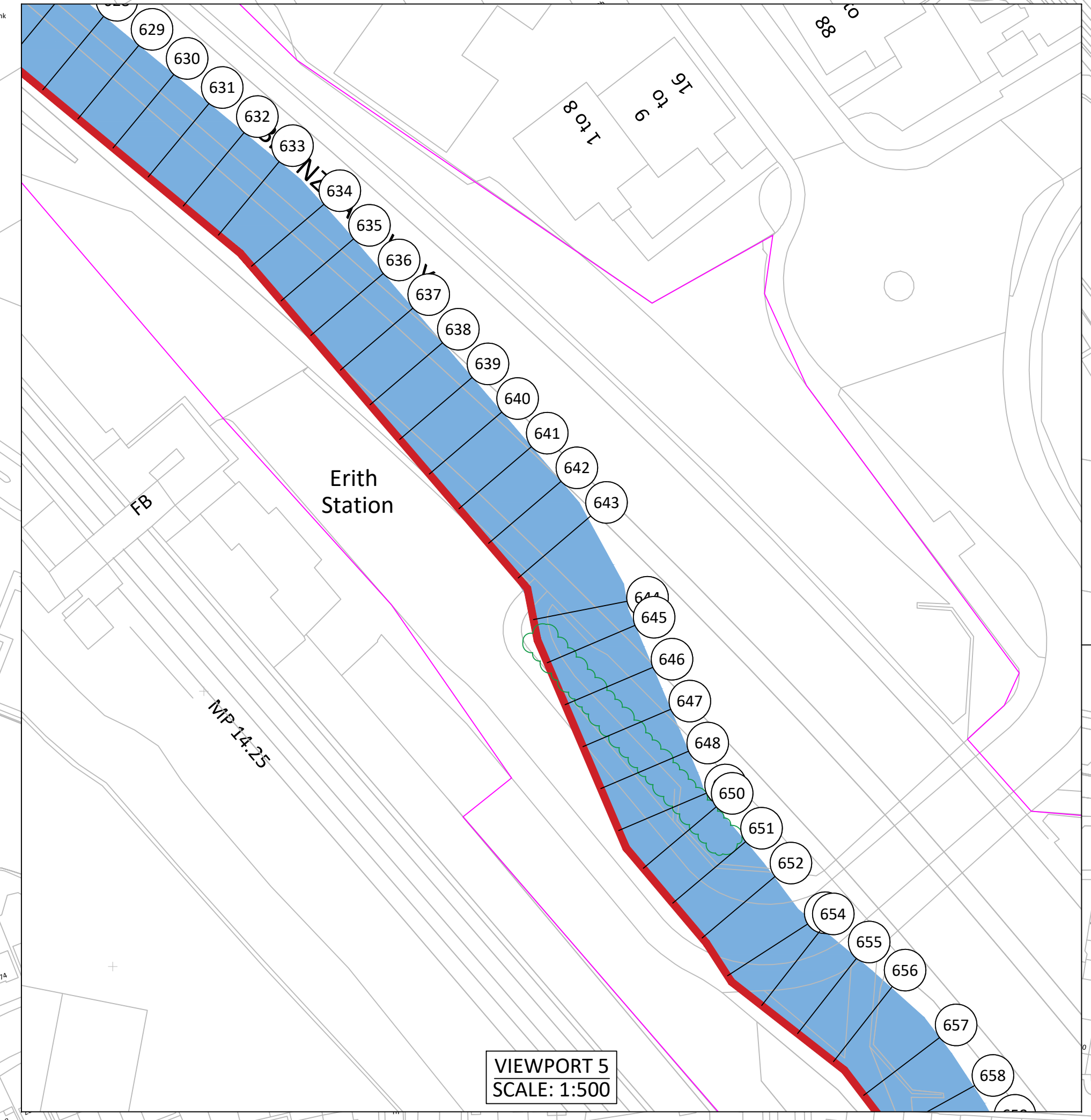
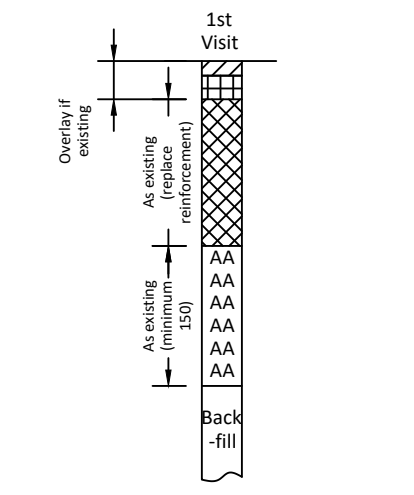

Compass
Compass Infrastructure UK Ltd.
7 Maitland Road
Lion Barn Industrial Estate
Needham Market
Suffolk, IP6 8NZ
Tel: +44(0)1449 727 600
Web: www.ci-uk.com

client
UK POWER NETWORKS

description
**RIVERSIDE ENERGY FS 2
DETAILED DESIGN
SAP No. 530014536**

drawn	JHY	d.d. 08/04/21	initials	size: A1	specifications number:
reviewed	JBA	d.d. 08/04/21	initials	scale: 1:1250	
approved	JBA	d.d. 08/04/21	initials	units: -	
status stamp	version	projectno. Compass	sheetdescription	sheet	

FEASIBILITY Rev14 20-0517 - FS - 001 -4/14



STR5
SUBWAY NO SW10 (NOTED AS BEING REDUNDANT, POTENTIAL USE AS UTILITY TUNNEL IF UKPN WOULD ADOPT)

STR4
SUBWAY No. SW9

TH9
FLAT + STEEL

WEEKEND WORKING
(2 WEEKENDS)

WEEKEND WORKING
(2 WEEKENDS)

STR6
BRITANNIA BRIDGE OVER RAIL NO 7

TH10
CABLE TROUGH
STEEL CONSTRUCTION -
EXACT DESIGN TBC
BETWEEN SECTIONS 785 & 797

STR7
FOOTBRIDGE OVER
RAIL NO FB28

NORMAL WITH
EXTENDED HOURS

VIEWPORT 8
SCALE: 1:500

VIEWPORT 7
SCALE: 1:500

LEGEND:
TH1 INDICATES LOCATION OF TRIAL HOLE
B1 INDICATES EXISTING BUS STOPS
TB1 INDICATES TEMPORARY BUS STOPS
INDICATES PHASE 3 WORKS
PHASE 3
COMMENCEMENT DATE: 22/07/22
COMPLETION DATE: 19/12/22
STR7
COMMENCEMENT DATE: 13/06/22
COMPLETION DATE: 01/07/22
INDICATES DCO BOUNDARY

INDICATES CROSS SECTION NUMBERS, EVERY 5m

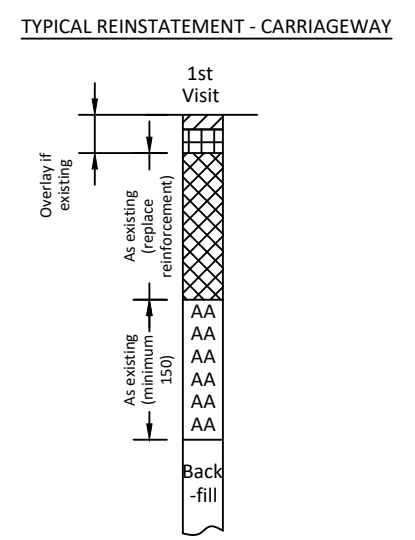
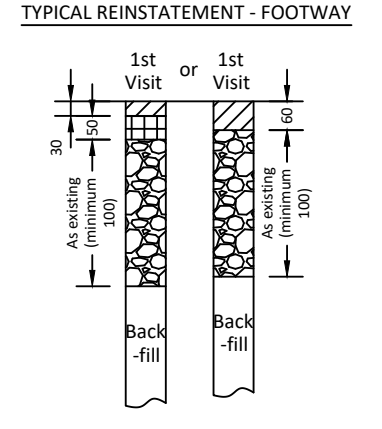

Compass
Compass Infrastructure UK Ltd.
7 Maitland Road
Lion Barn Industrial Estate
Needham Market
Suffolk, IP6 8NZ
Tel: +44(0)1449 727 600
Web: www.ci-uk.com

client
UK POWER NETWORKS

description
**RIVERSIDE ENERGY FS 2
DETAILED DESIGN
SAP No. 530014536**

drawn	JHY	d.d	08/04/21	initials	size:	A1	specifications number:
reviewed	JBA	d.d	08/04/21	initials	scale:	1:1250	
approved	JBA	d.d	08/04/21	initials	units:	-	
status stamp	version	project no.	Compass	sheet description	sheet		
FEASIBILITY	Rev14	20-0517	-	FS - 001	-5/14		

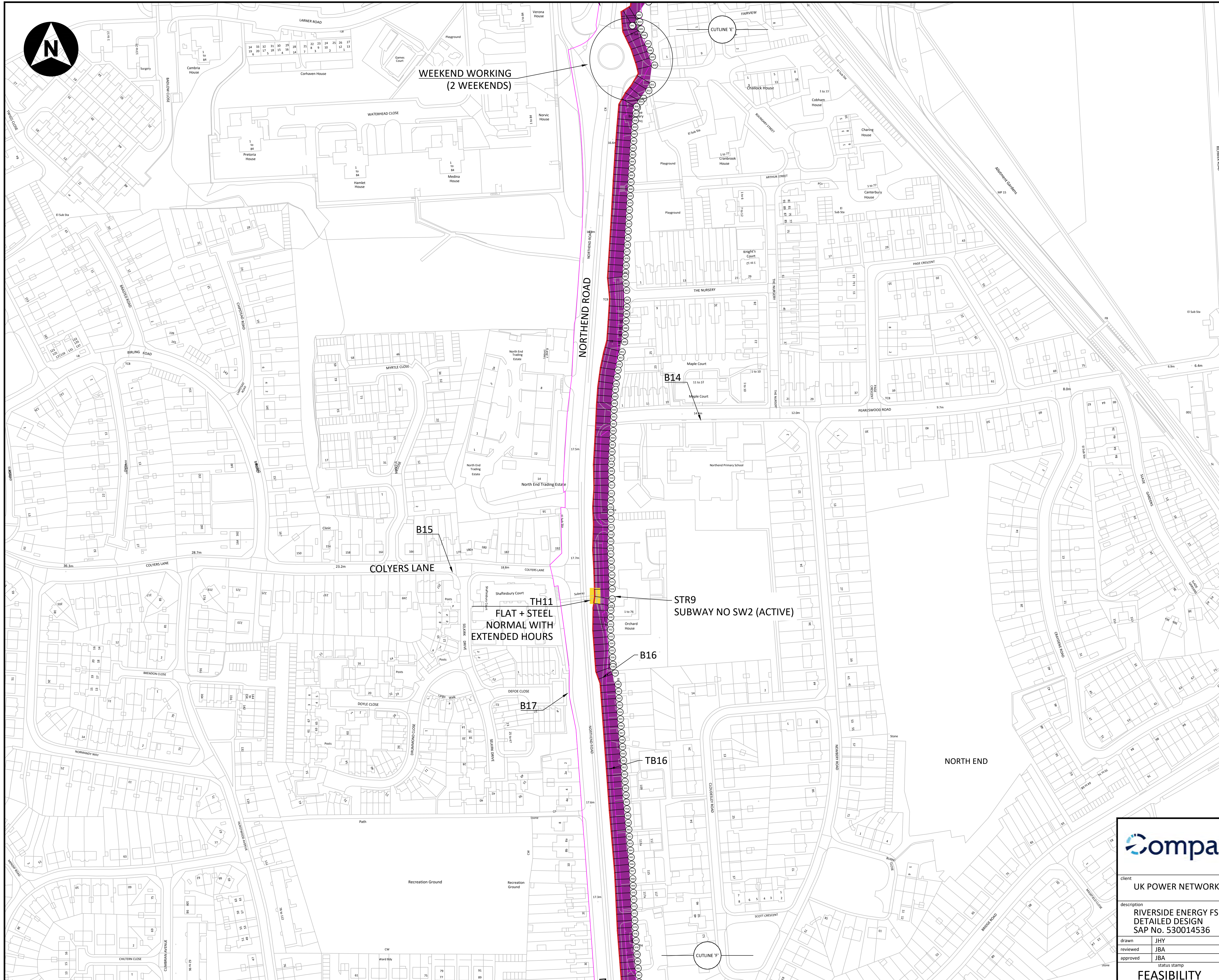
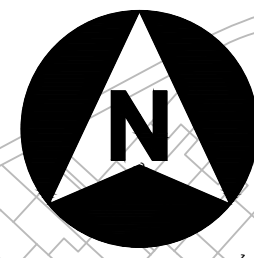

- LEGEND:**
- TH1 INDICATES LOCATION OF TRIAL HOLE
 - B1 etc. INDICATES EXISTING BUS STOPS
 - TB1 INDICATES TEMPORARY BUS STOPS
 - INDICATES PHASE 3 WORKS
 - PHASE 3 COMMENCEMENT DATE: 22/07/22
 - COMPLETION DATE: 19/12/22
 - INDICATES DCO BOUNDARY
 - INDICATES CROSS SECTION NUMBERS, EVERY 5m

TYPICAL REINSTATEMENT - FOOTWAY

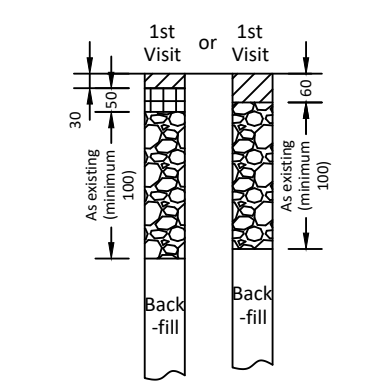

TYPICAL REINSTATEMENT - CARRIAGEWAY

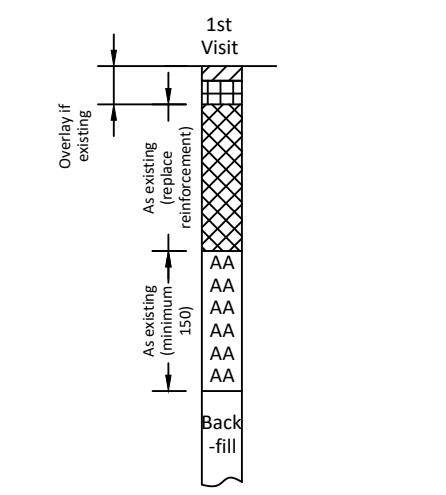

Compass
 Compass Infrastructure UK Ltd.
 7 Maitland Road
 Lion Barn Industrial Estate
 Needham Market
 Suffolk, IP6 8NZ
 Tel: +44(0)1449 727 600
 Web: www.ci-uk.com

client
UK POWER NETWORKS

description
**RIVERSIDE ENERGY FS 2
 DETAILED DESIGN
 SAP No. 530014536**

drawn	JHY	d.d. 08/04/21	initials	size: A1	specifications number:
reviewed	JBA	d.d. 08/04/21	initials	scale: 1:1250	
approved	JBA	d.d. 08/04/21	initials	units: -	
status stamp	version	projectno. Compass	sheetdescription	sheet	

FEASIBILITY Rev14 20-0517 - FS - 001 -6/14



CUTLINE 'G'

TH15
NORMAL WORKING HOURS

THAMES ROAD

TB23 / TB25

B25

WEEKEND WORKING
(4 WEEKENDS)

OUT OF HOURS
WORKING

TH16

TB26

B26

B27

TH17
NORMAL WORKING HOURS

WEEKEND WORKING
(4 WEEKENDS)

DEEP - 1.2m COVER

TH18
FLAT + STEEL

CRAYFORD WAY

STR 11

- LEGEND:**
- TH1 INDICATES LOCATION OF TRIAL HOLE
 - B1 etc. INDICATES EXISTING BUS STOPS
 - TB1 INDICATES TEMPORARY BUS STOPS
 - INDICATES PHASE 4 WORKS
 - PHASE 4 COMMENCEMENT DATE: 15/12/22
 - COMPLETION DATE: 25/04/23
 - INDICATES DCO BOUNDARY
 - INDICATES CROSS SECTION NUMBERS, EVERY 5m

TYPICAL REINSTATEMENT - FOOTWAY

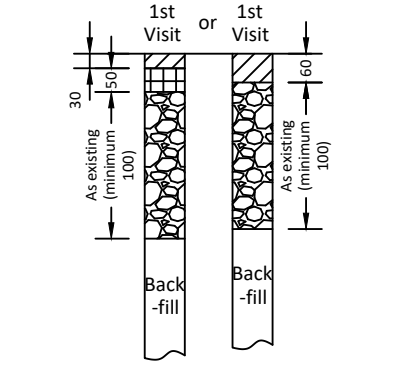

TYPICAL REINSTATEMENT - CARRIAGEWAY

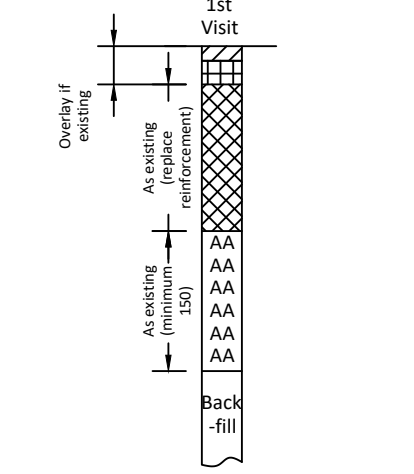

Compass
Compass Infrastructure UK Ltd.
7 Maitland Road
Lion Barn Industrial Estate
Needham Market
Suffolk, IP6 8NZ
Tel: +44(0)1449 727 600
Web: www.ci-uk.com

client
UK POWER NETWORKS

description
**RIVERSIDE ENERGY FS 2
DETAILED DESIGN
SAP No. 530014536**

drawn	JHY	d.d. 08/04/21	initials	size: A1	specifications number:
reviewed	JBA	d.d. 08/04/21	initials	scale: 1:1250	
approved	JBA	d.d. 08/04/21	initials	units: -	
status stamp		version	projectno. Compass	sheetdescription	sheet

FEASIBILITY Rev14 20-0517 - FS - 001 -8/14

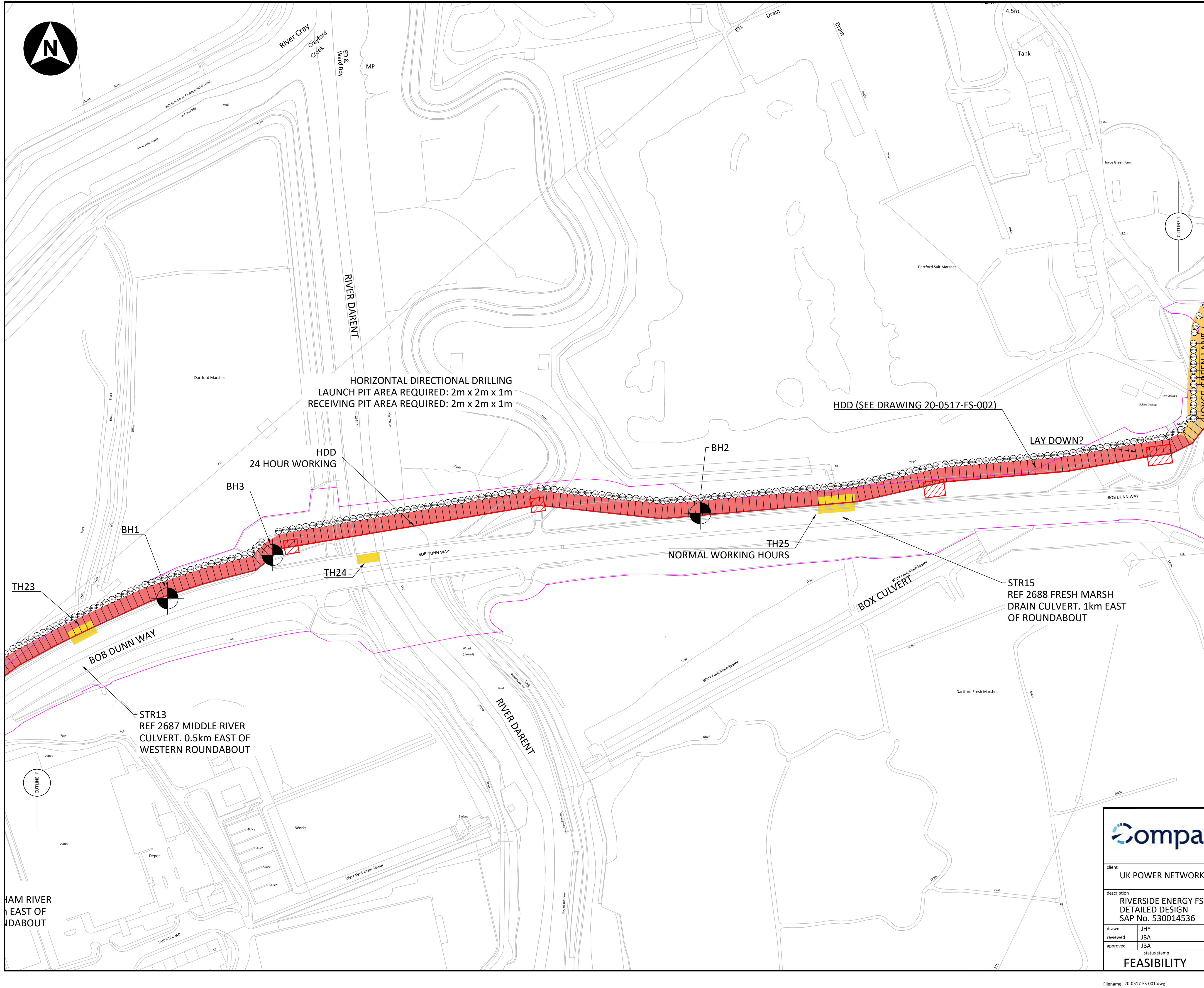
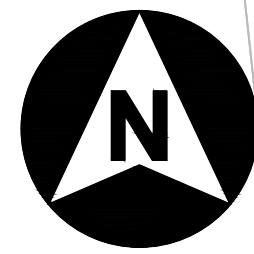

- LEGEND:**
- TH1 INDICATES LOCATION OF TRIAL HOLE
 - INDICATES LOCATION OF BORE HOLES
 - INDICATES HDD SITE SET-UP
 - INDICATES PHASE 5 WORKS
 - INDICATES PHASE 6 WORKS
 - PHASE 5
COMMENCEMENT DATE: 13/09/22
COMPLETION DATE: 26/12/22
 - STR14/15
COMMENCEMENT DATE: 15/08/22
COMPLETION DATE: 19/08/22
 - PHASE 6
COMMENCEMENT DATE: 16/05/22
COMPLETION DATE: 27/09/22
 - INDICATES DCO BOUNDARY
 - INDICATES CROSS SECTION NUMBERS, EVERY 5m

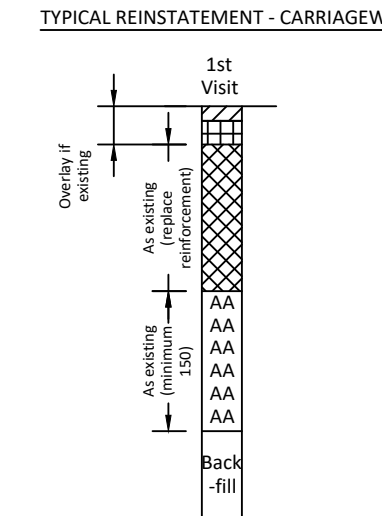
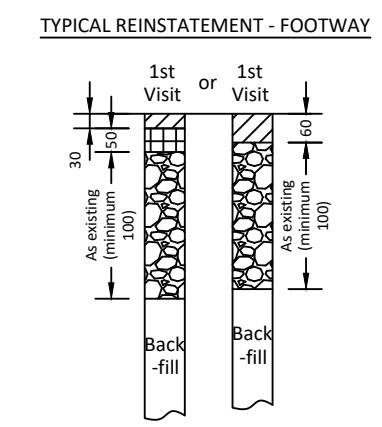

HORIZONTAL DIRECTIONAL DRILLING
 LAUNCH PIT AREA REQUIRED: 2m x 2m x 1m
 RECEIVING PIT AREA REQUIRED: 2m x 2m x 1m

HDD (SEE DRAWING 20-0517-FS-002)

LAY DOWN?

TH25
NORMAL WORKING HOURS

STR15
REF 2688 FRESH MARSH
DRAIN CULVERT. 1km EAST
OF ROUNDABOUT

STR13
REF 2687 MIDDLE RIVER
CULVERT. 0.5km EAST OF
WESTERN ROUNDABOUT

Compass
 Compass Infrastructure UK Ltd.
 7 Maitland Road
 Lion Barn Industrial Estate
 Needham Market
 Suffolk, IP6 8NZ
 Tel: +44(0)1449 727 600
 Web: www.ci-uk.com

client: **UK POWER NETWORKS**

description: **RIVERSIDE ENERGY FS 2
 DETAILED DESIGN
 SAP No. 530014536**

drawn	JHY	d.d	08/04/21	initials	size:	A1	specifications number:
reviewed	JBA	d.d	08/04/21	initials	scale:	1:1250	
approved	JBA	d.d	08/04/21	initials	units:	-	
status stamp		version	projectno.	Compass	sheetdescription	sheet	
FEASIBILITY		Rev14	20-0517	- FS - 001	-10/14		

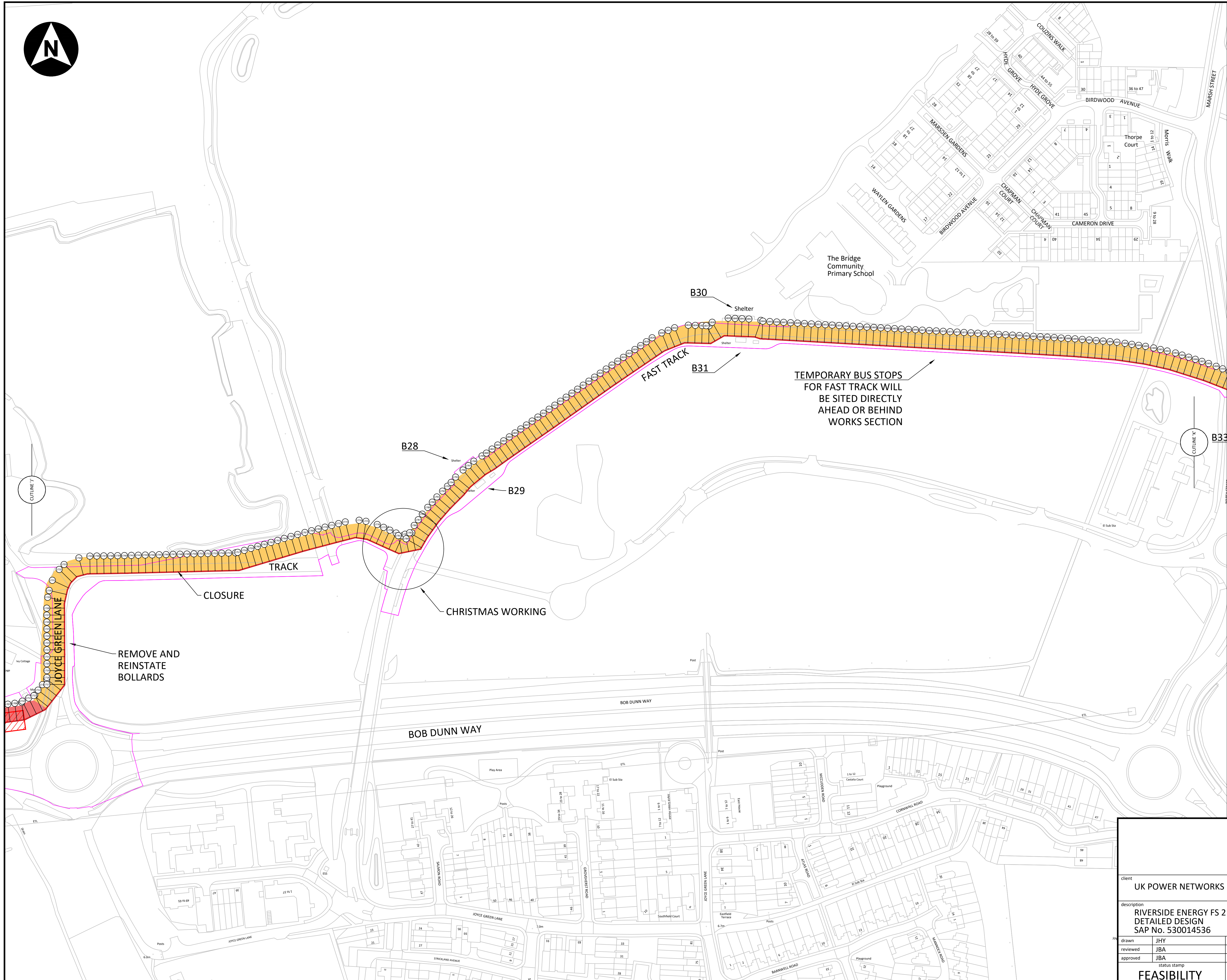
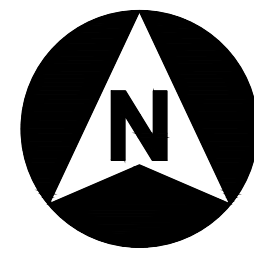

- LEGEND:**
- B1 etc. INDICATES EXISTING BUS STOPS
 - TB1 INDICATES TEMPORARY BUS STOPS
 - INDICATES PHASE 5 WORKS
 - PHASE 5 COMMENCEMENT DATE: 13/09/22
 - COMPLETION DATE: 26/12/22
 - INDICATES PHASE 6 WORKS
 - PHASE 6 COMMENCEMENT DATE: 16/05/22
 - COMPLETION DATE: 27/09/22
 - INDICATES DCO BOUNDARY
 - INDICATES CROSS SECTION NUMBERS, EVERY 5m

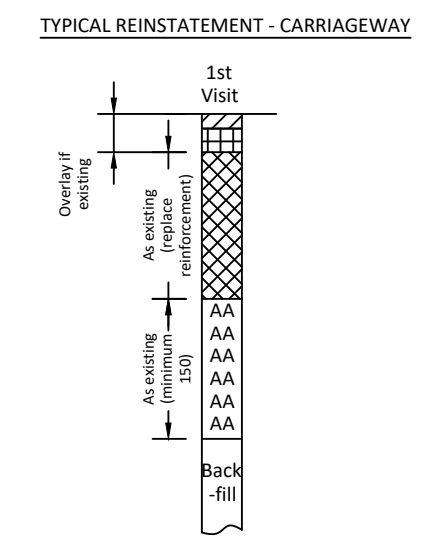
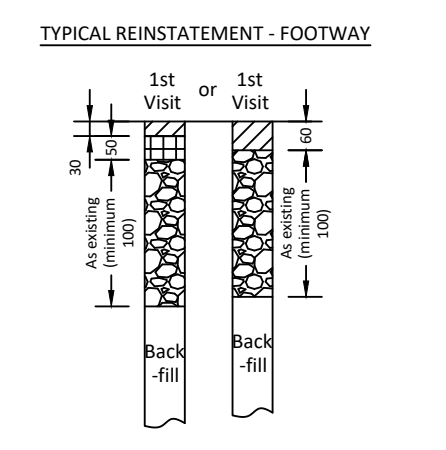

Compass Infrastructure UK Ltd. 7 Maitland Road Lion Barn Industrial Estate Needham Market Suffolk, IP6 8NZ Tel: +44(0)1449 727 600 Web: www.ci-uk.com					
client UK POWER NETWORKS					
description RIVERSIDE ENERGY FS 2 DETAILED DESIGN SAP No. 530014536					
drawn	JHY	d.d. 08/04/21	initials	size: A1	specifications number:
reviewed	JBA	d.d. 08/04/21	initials	scale: 1:1250	
approved	JBA	d.d. 08/04/21	initials	units: -	
status stamp		version	projectno. Compass	sheetdescription	sheet
FEASIBILITY		Rev14	20-0517 - FS - 001	-11/14	

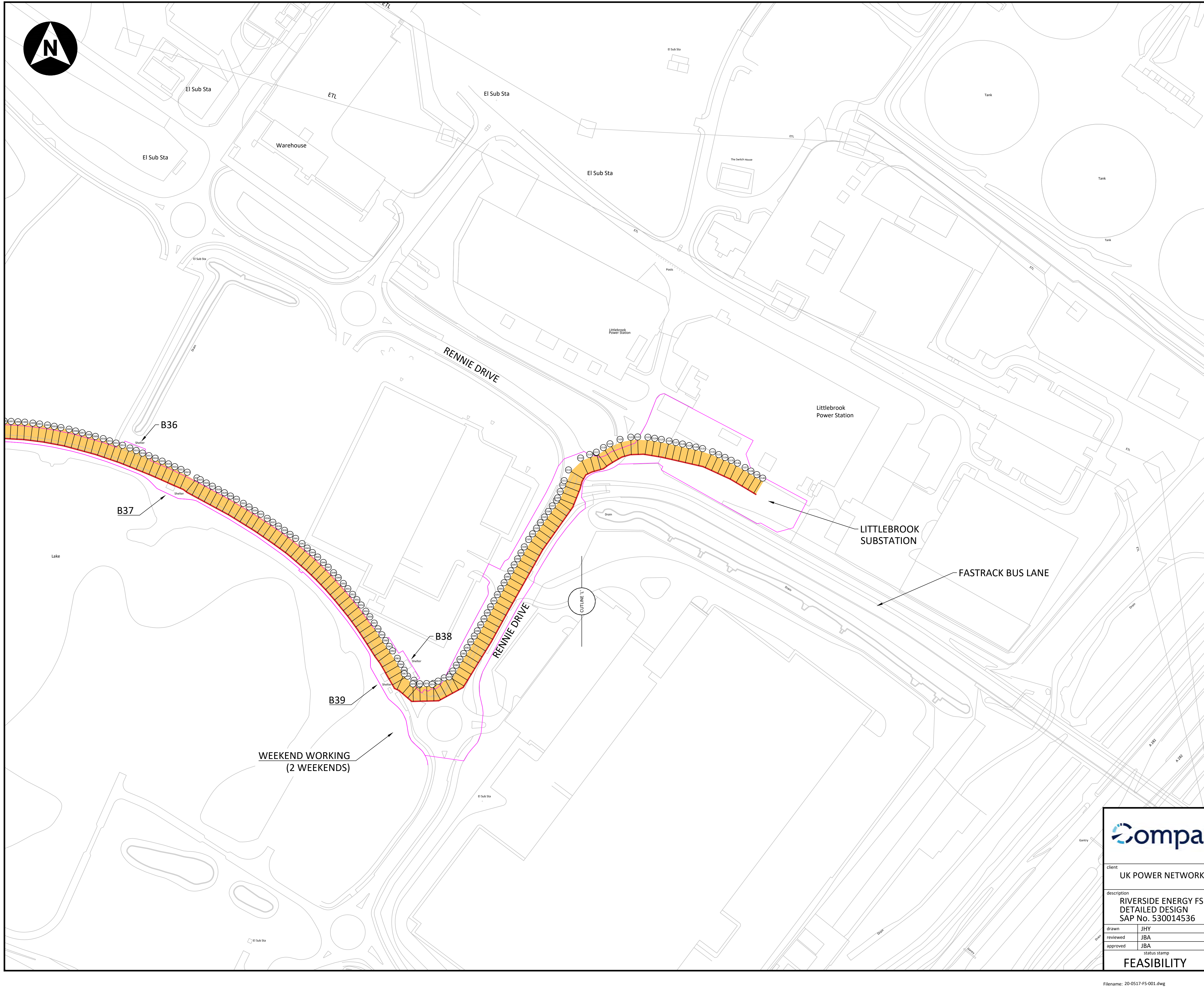

- LEGEND:**
- B1 etc. INDICATES EXISTING BUS STOPS
 - TB1 INDICATES TEMPORARY BUS STOPS
 - INDICATES PHASE 6 WORKS
 - PHASE 6 COMMENCEMENT DATE: 16/05/22
 - COMPLETION DATE: 27/09/22
 - INDICATES DCO BOUNDARY
 - INDICATES CROSS SECTION NUMBERS, EVERY 5m

TYPICAL REINSTATEMENT - FOOTWAY

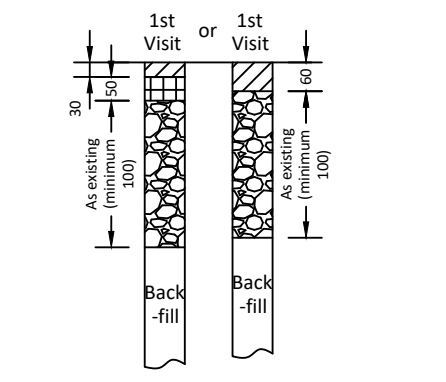

TYPICAL REINSTATEMENT - CARRIAGEWAY

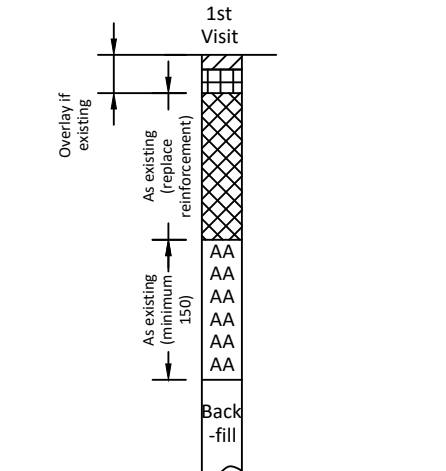

Compass
 Compass Infrastructure UK Ltd.
 7 Maitland Road
 Lion Barn Industrial Estate
 Needham Market
 Suffolk, IP6 8NZ
 Tel: +44(0)1449 727 600
 Web: www.ci-uk.com

client
UK POWER NETWORKS

description
**RIVERSIDE ENERGY FS 2
 DETAILED DESIGN
 SAP No. 530014536**

drawn	JHY	d.d	08/04/21	initials	size:	A1	specifications number:
reviewed	JBA	d.d	08/04/21	initials	scale:	1:1250	
approved	JBA	d.d	08/04/21	initials	units:	-	
status stamp	version	projectno.	Compass	sheetdescription	sheet		
FEASIBILITY	Rev14	20-0517	- FS - 001	-13/14			

1-142
145-200
211-297
300-554
559-715
718-788
793-915
918-1125
1153-1339
1359-1363
1366-1367
1370-1562
1620-1662
1700-2130

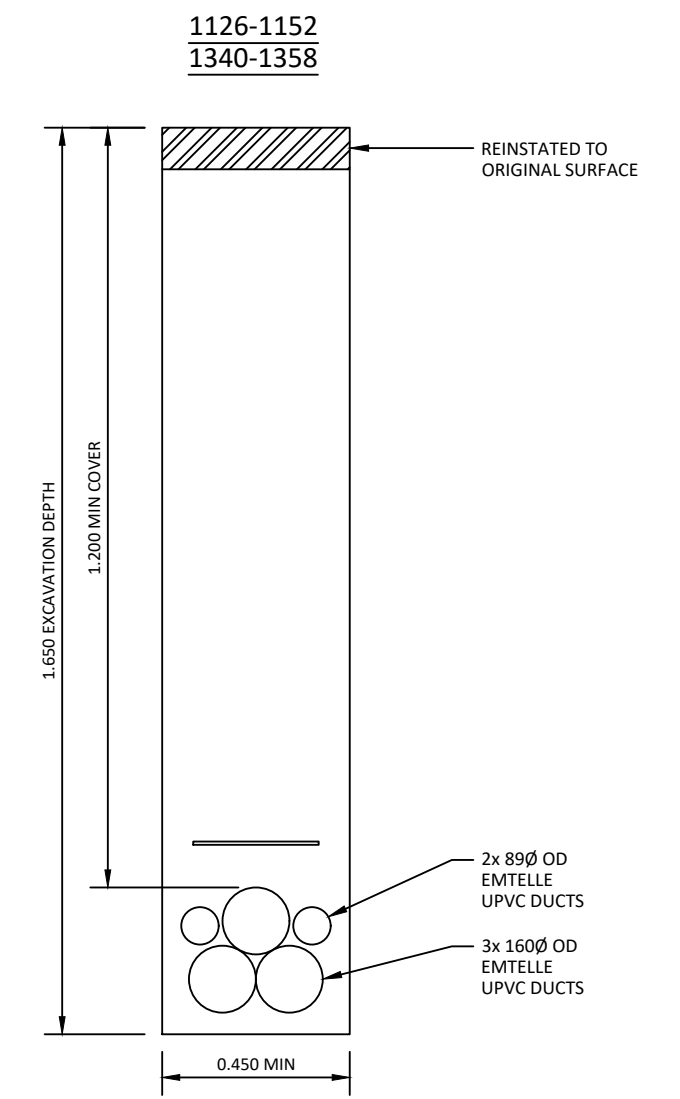
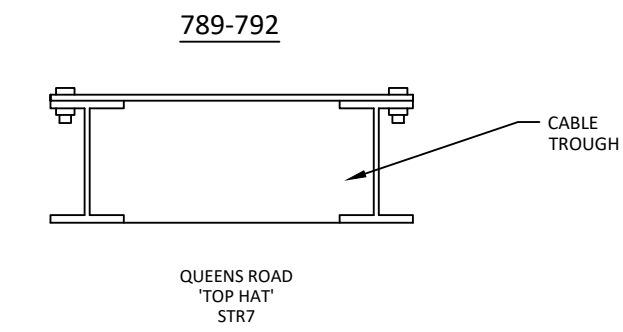
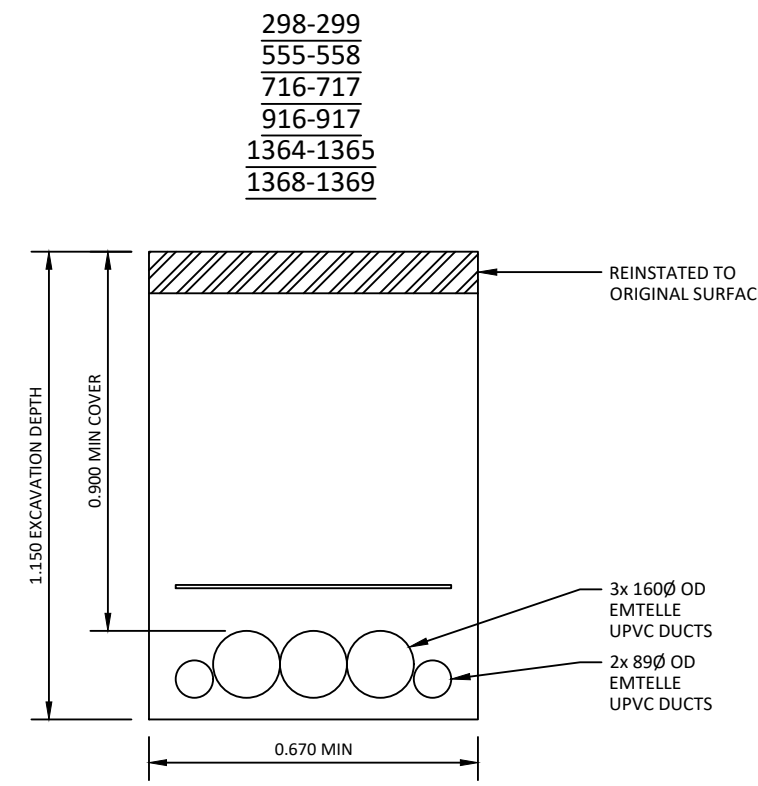
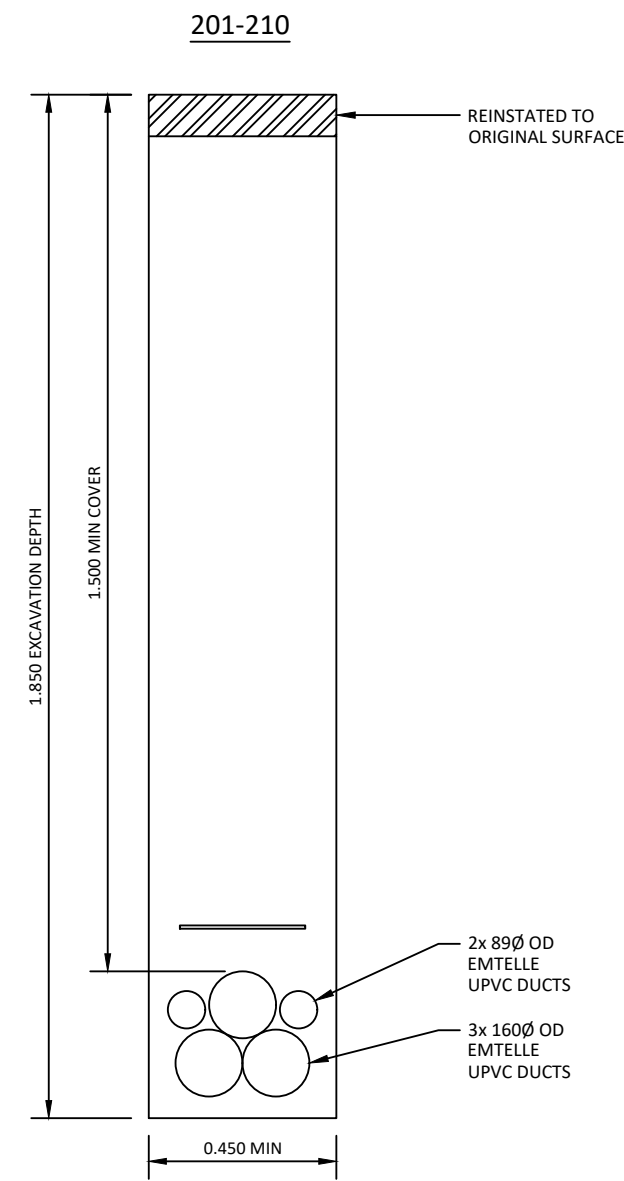
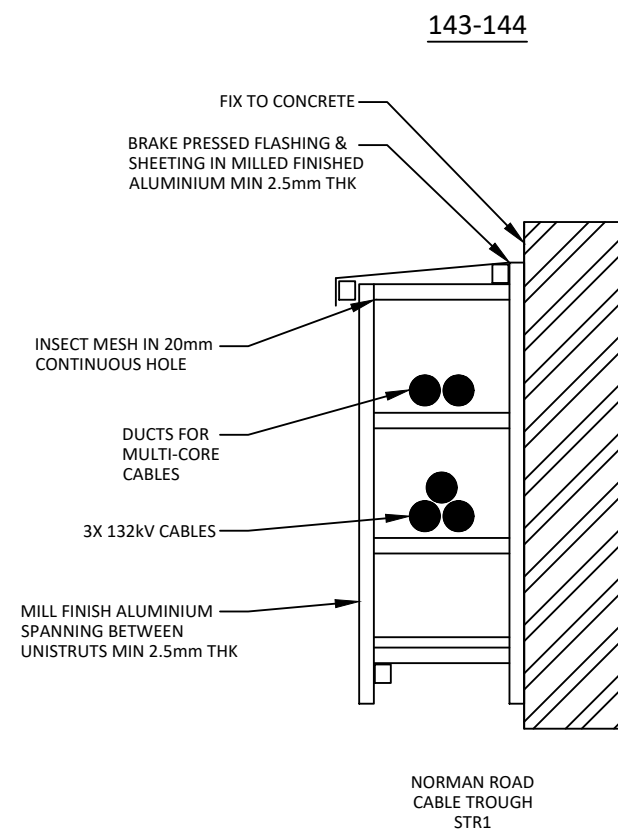
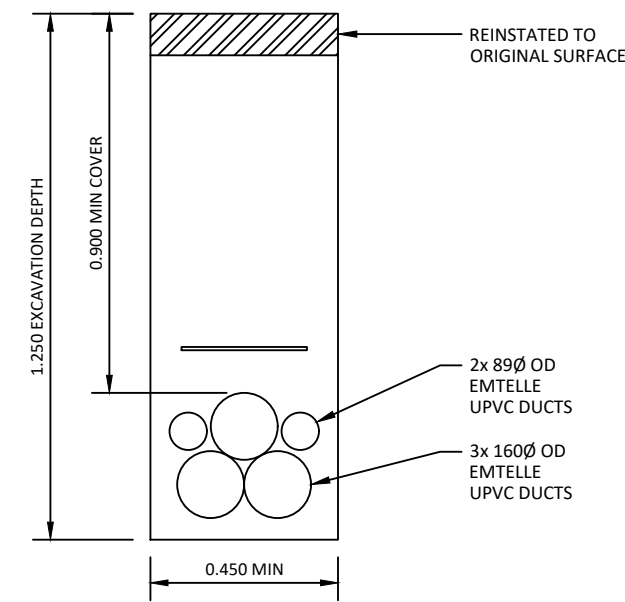

1563-1619
1663-1699

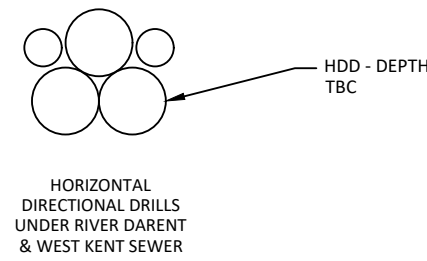

LEGEND:
1-142 INDICATES TRENCH CROSS SECTION DETAIL BETWEEN VARIOUS LOLLIPOP NUMBERS



Compass Infrastructure UK Ltd.
7 Maitland Road
Lion Barn Industrial Estate
Needham Market
Suffolk, IP6 8NZ
Tel. +44(0)1449 727 600
Web www.ci-uk.com

client					
UK POWER NETWORKS					
description					
RIVERSIDE ENERGY FS 2 DETAILED DESIGN SAP No. 530014536					
drawn	JHY	d.d	08/04/21	initials	size: A1
reviewed	JBA	d.d	08/04/21	initials	scale: NTS
approved	JBA	d.d	08/04/21	initials	units: -
status stamp		version	projectno. Compass	sheetdescription	sheet
FEASIBILITY		Rev14	20-0517 - FS - 001	-14/14	