

Type 1
Quantity: 10

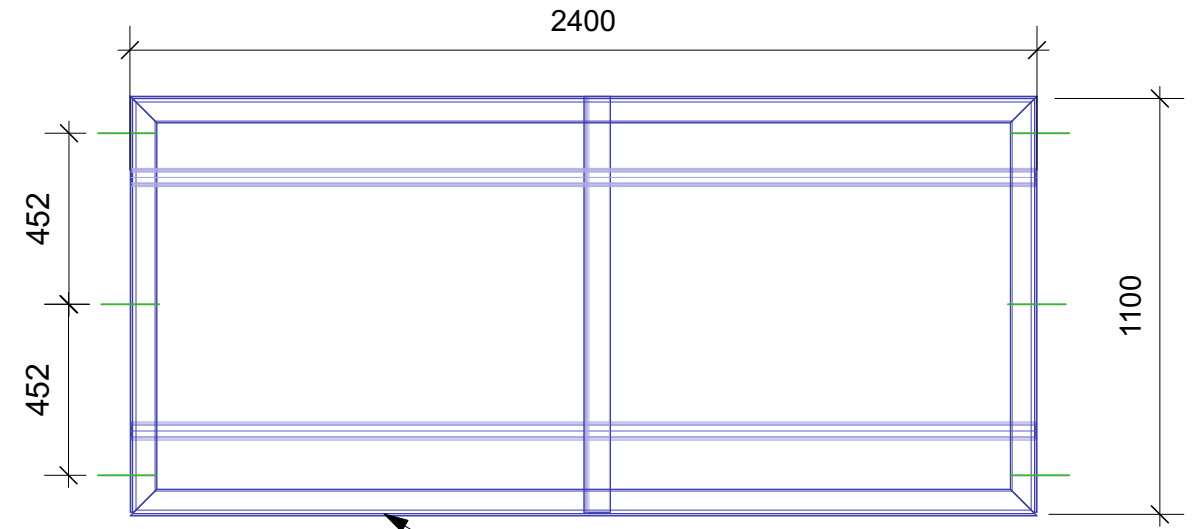

Type 2
Quantity: 2

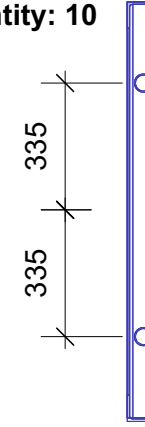
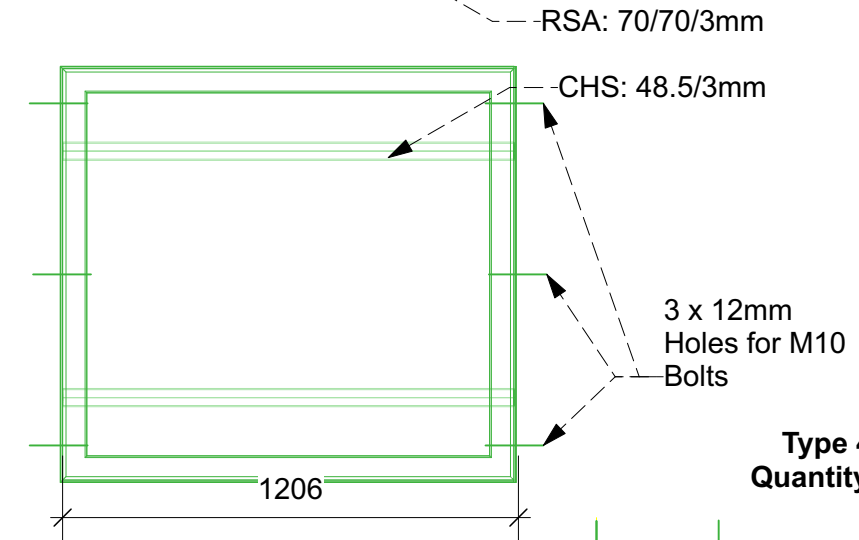
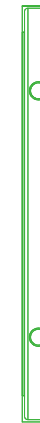

Type 3
Quantity: 1



CHS 48.5/3
flush with back
edge of frame

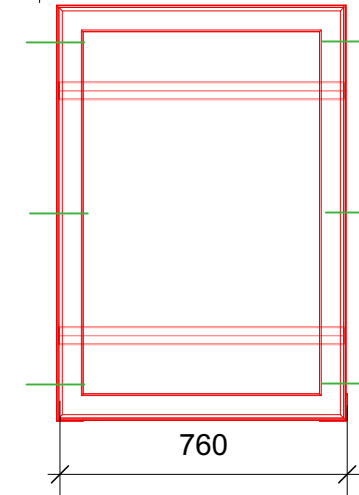

Type 4
Quantity: 1

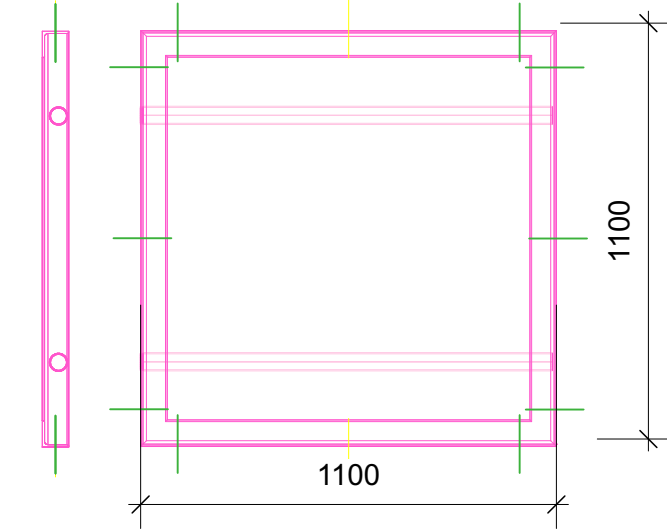

Scale 1:20

General Notes

1. Frame colour: Gray
2. All Frames to be fitted with 5mm marine ply board with chamfered corners on all sides
Fixings to be counter sunk to leave a flat face.



www.ambarinstallations.com

This drawing is the property of Ambar Installations Ltd. It may not be copied or disclosed to any third party for any purpose, except as authorised in writing by the company. Do not scale from this drawing. All measurements are to be checked on site prior to the commencement of works. Any errors or omissions to be reported to the draught office. All work remains the copyright of the company.

PROJECT TITLE		Cartier Christmas	
SHEET TITLE		RitRibbon Framerts	
CLIENT		InGenious Productions	LOCATION Cartier New Bond St
DRAWING NO.	AMB281 - D02	DATE	15/09/2021
REVISION	1	DRAWN BY	TR
PROJECT MANAGER	TR	REVIEWED BY	N/A
SCALE	1:100 @ A3	TOLERANCE (unless specified)	+/- 0.5mm
		DIMENSIONS (unless specified) mm	