

KEY TO MATERIALS

- 1 horizontal softwood weatherboarding
- 2 galvanised steel corrugated roof
- 3 galvanised steel field gate
- 4 close boarded softwood fence
- 5 plain clay tiling
- 6 part brick part stone plinth
- 7 existing brickwork
- 8 existing painted concrete blockwork
- 9 existing timber stable doors

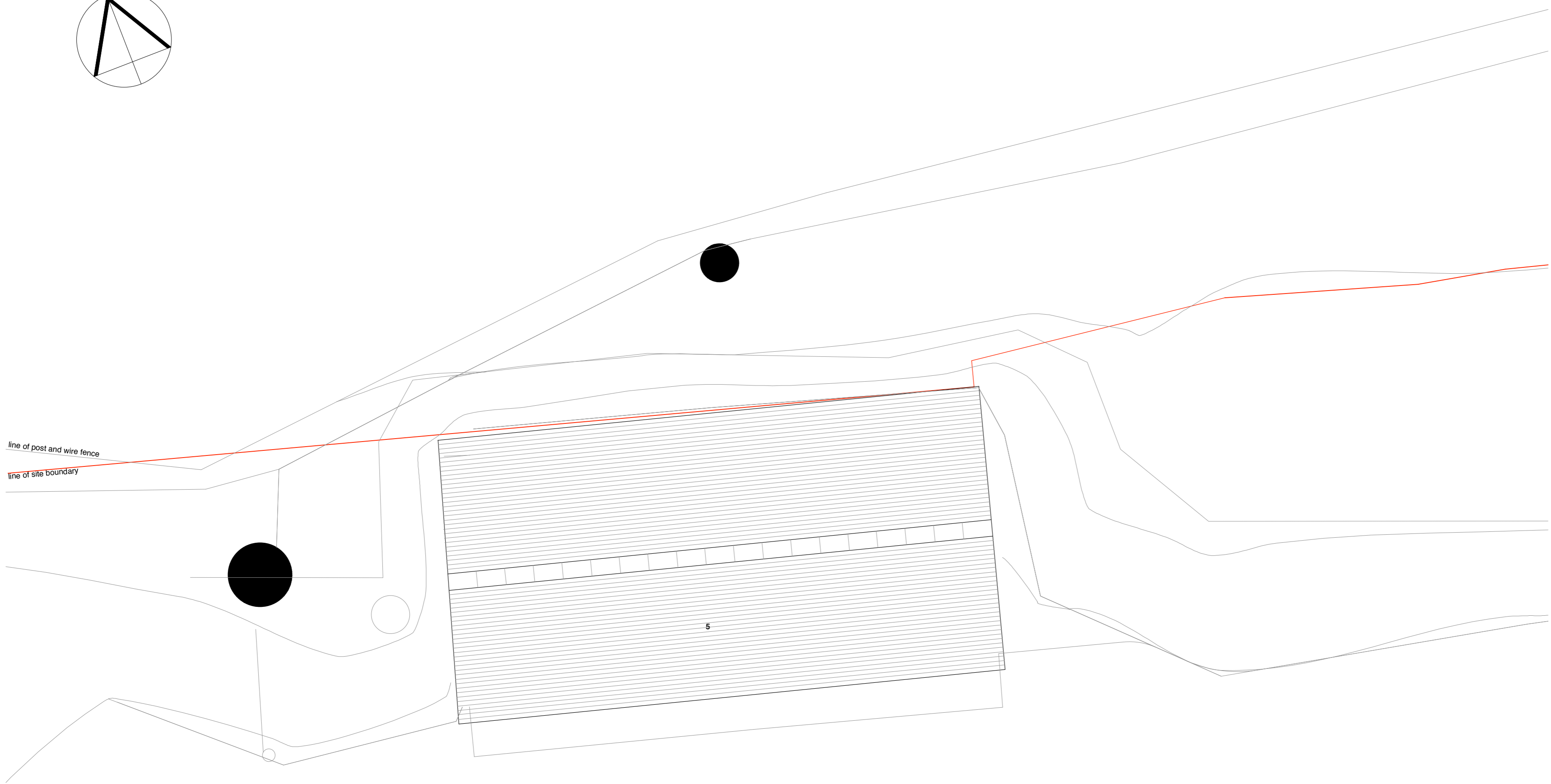

remove plain clay tiling, battens and felt underlay

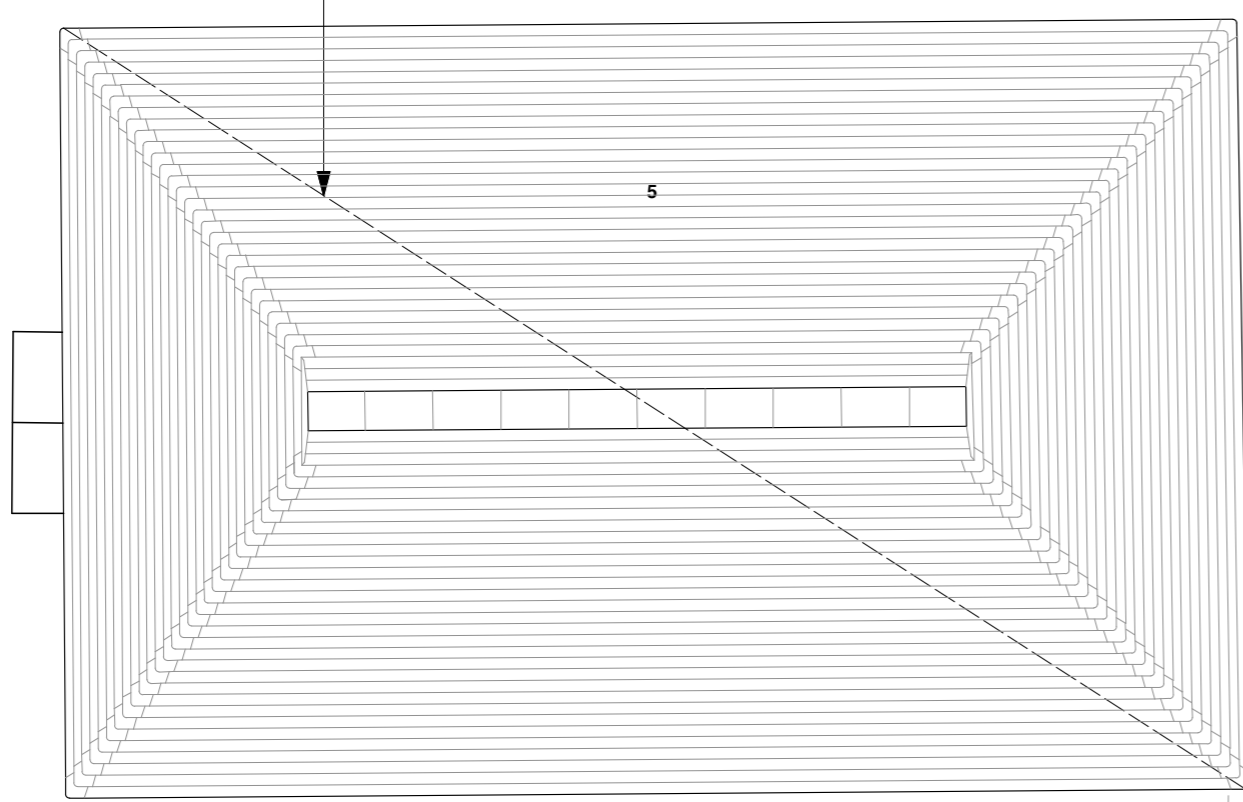

demolish woodshed entirely

relocate greenhouse

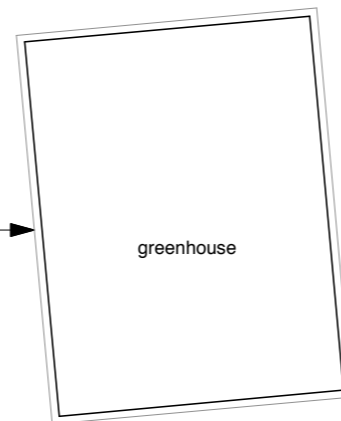

**BARN, STABLES and WOODSHED
ROOF PLAN
AS EXISTING**

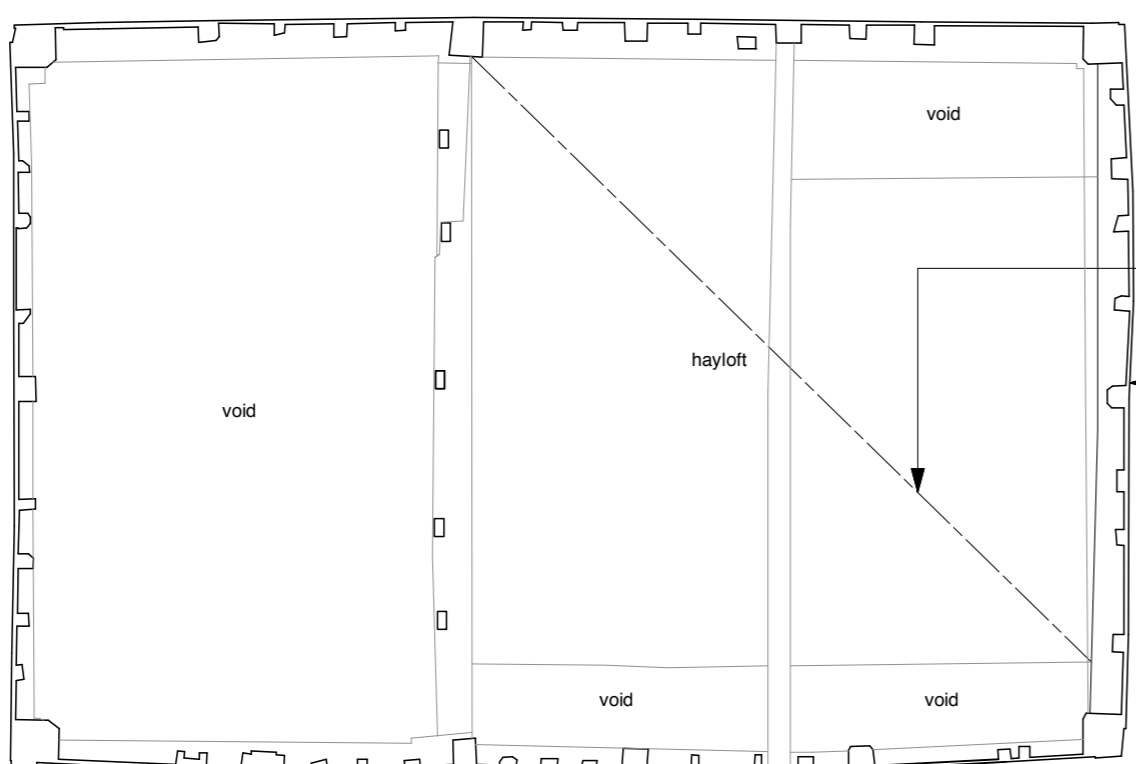

**BARN
PLAN - HAY LOFT
AS EXISTING
timber frame to existing barn to be retained**

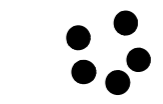

JOB	HARBOROUGH FARM BOUGH BEECH KENT TN8 7PP		
DRG. TITLE	BARN, STABLES and WOODSHED PLAN AS EXISTING		
DRG. NO.	95-00/28/P05		
SCALE	1:50 @ A1	DATE	Aug 2021
REVISION			
READING + WEST ARCHITECTS LLP HARBOROUGH FARM CLINTON LANE BOUGH BEECH KENT TN8 7PP TEL: 020 8940 0700 gary@readingandwest.co.uk www.readingandwestarchitects.co.uk			