

# SITE LOCATION 1:1250



THE SITE - 74 SOUTH STREET MANNINGTREE

# Block Plan 1:200



SOUTH STREET

EXISTING DRAINAGE  
AND VEHICULAR ACCESS

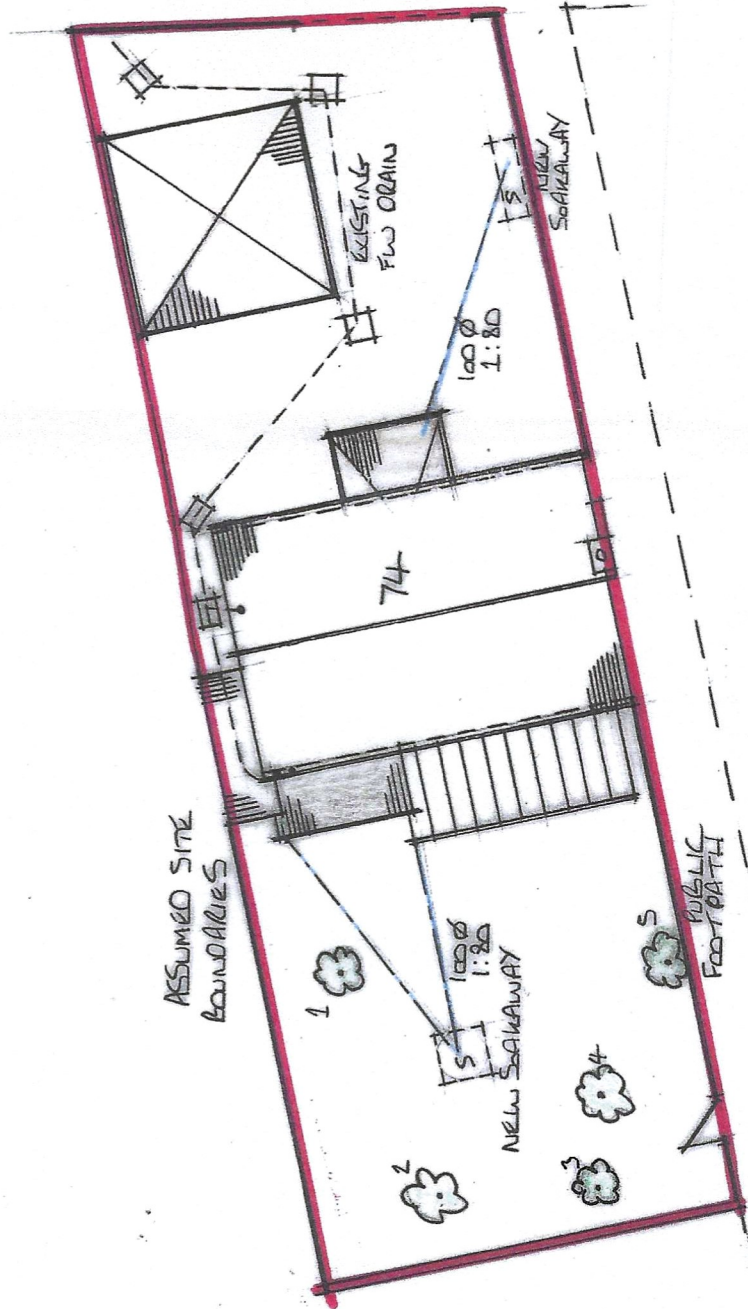

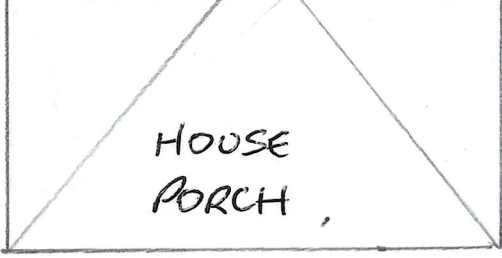

HOUSE  
PORCH,

DRIVEWAY

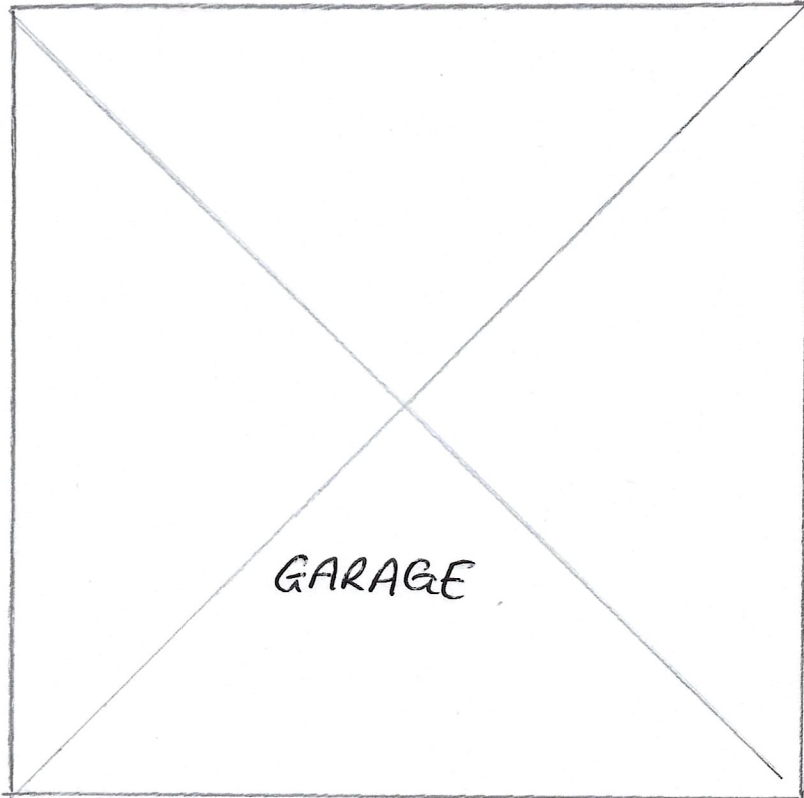

GARAGE

BOUNDARY WITH 72 SOUTH STREET.



TRUNK OF  
DEAD MAPLE



MAPLE SUBJECT  
OF APPLICATION

FOOTWAY

ROAD