

MapServe

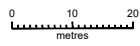

© Crown copyright 2021 Ordnance Survey 100053143

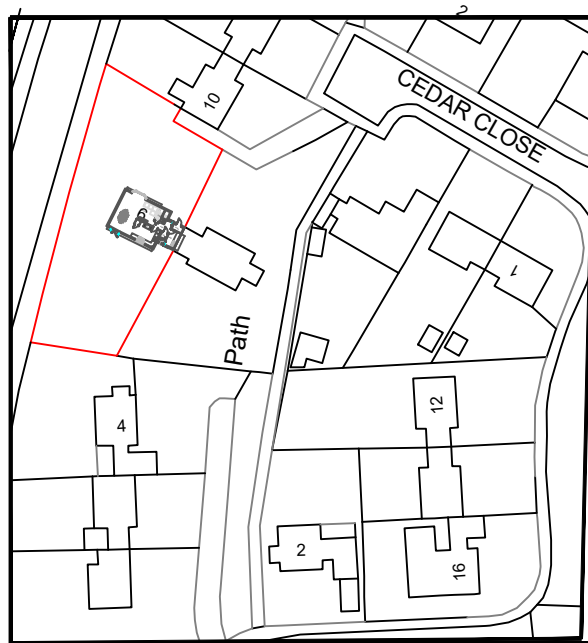

These drawings are for DESIGN purposes only, 2 TDB are not liable for unforeseen problems in build. Please DO NOT Scale this drawing, dimensions must be checked on site before building works commence & any discrepancies reported

Chestnut Close, Barton Mills, Suffolk, IP28 6AF

1-1250

9 Cedar Close RAF Lakenheath IP279QN

Nathaniel Cohn

No:	Revision:	Date:	Date:	3-08-2021
			Scale:	1-1250
			Drawn By:	KK
			Drawing No:	056
			Paper Size	A4