

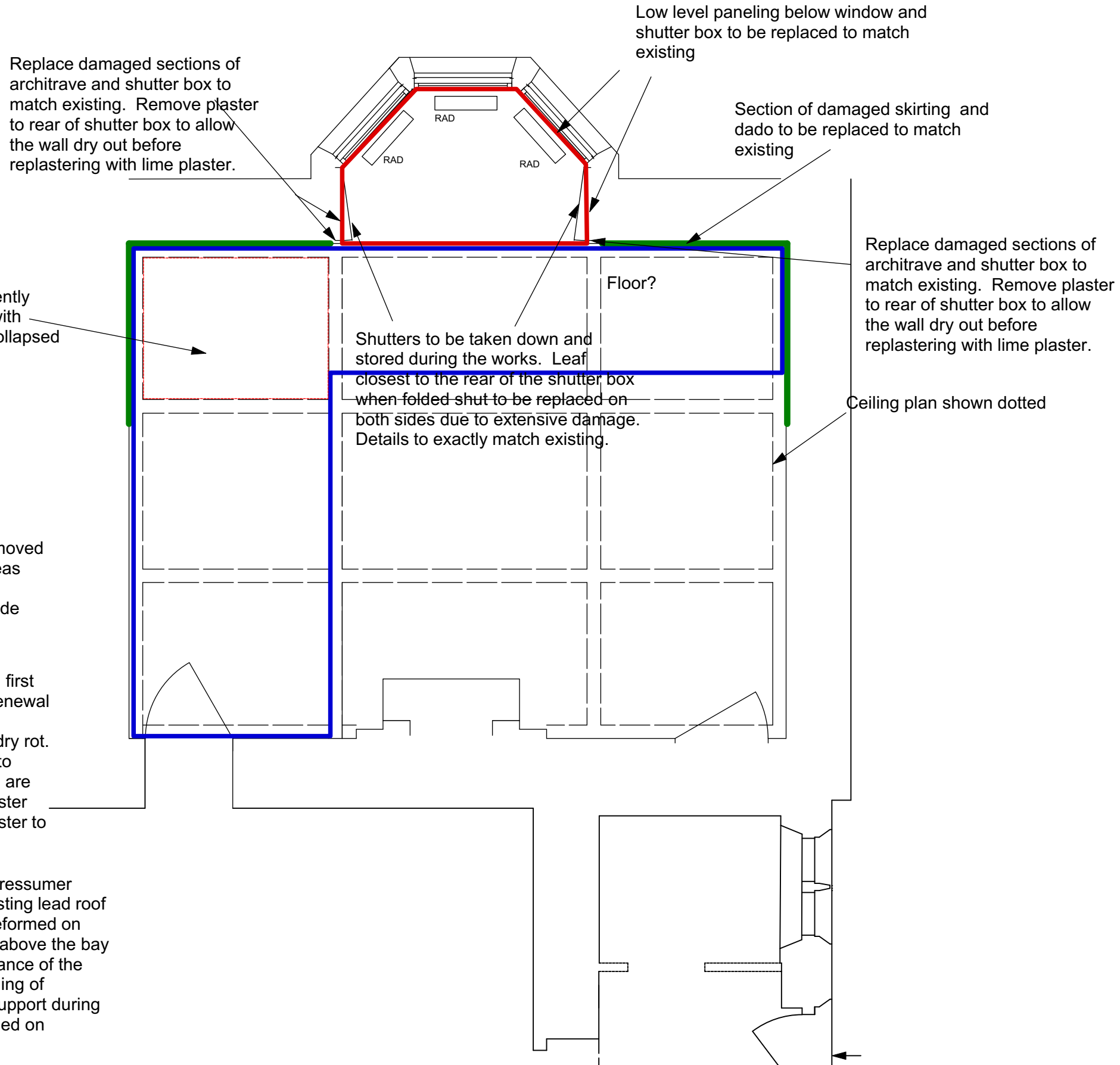

0

5M

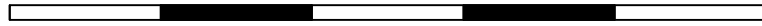

KEY

 Plaster, laths and battens removed to approx 1 - 1.5m high in areas affected by dry rot to remove damaged material. Walls made good using lime plaster.

 Area on both the ground and first floor where joist and beam renewal is expected to be required to replace timber damaged by dry rot. Floor boards to be replaced to match existing where boards are damaged beyond repair. Plaster ceiling repairs using lime plaster to match existing.

 All timbers in bay renewed. bressumer beam replaced in timber. Existing lead roof lifted to provide access and reformed on completion. Individual stones above the bay window to be removed in advance of the works to enable needling/pinning of stonework above to provide support during the works. Stonework rebbed on completion.

All dimensions should be checked on site.
Do not scale from this drawing

Please note that due to access limitations there have had to be some assumptions made on thickness of external walls etc

**EMBLETON TOWER
EMBLETON
ALNWICK**

**PLAN OF DINING ROOM SHOWING
WORKS REQUIRED TO REPAIR
DAMAGE DUE TO DRY ROT**

Scales 1:50

Date May 2018

BR

Spence and Dower LLP,
Chartered Architects
25 Main Street
Ponteland
Newcastle upon Tyne NE20 9NH
Tel: (01661) 820071
Fax: (01661) 823788
architects@spenceanddower.co.uk

M631 / 08

Rev.