

SITE ACCESS / DRIVE .

Widen existing access to 4.5m for first 10m . min = tarmac surface .
1 in 15 max . gradient for first 5m .

Drive 3.5m wide - gravel surface .

Patio - paving slabs .

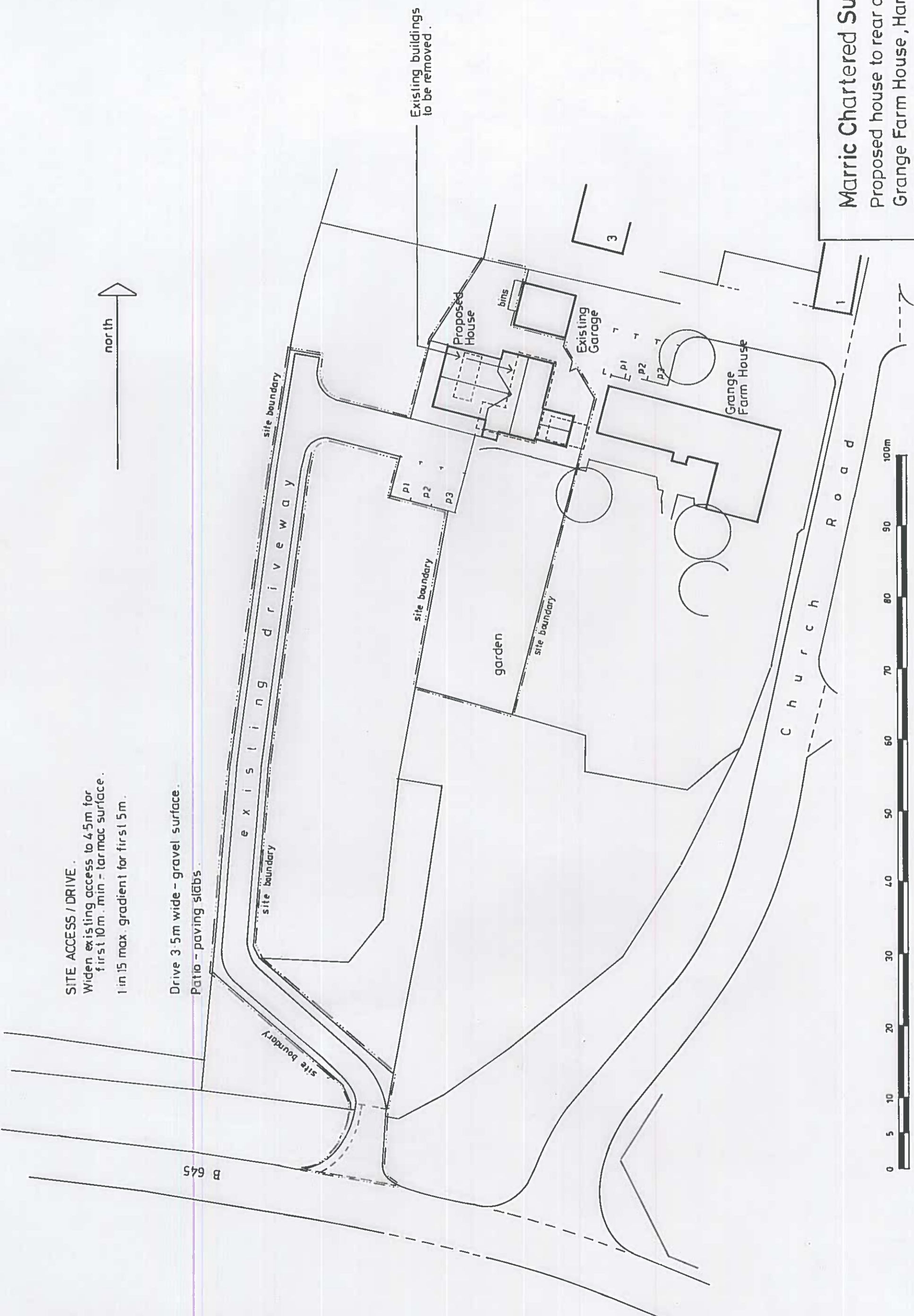

Site Plan 1:500 at A3 .

Marric Chartered Surveyors

Proposed house to rear of
Grange Farm House , Hargrave .
Site Plan .
Job No . 20/43 . Drg . No . 8 rev . 2 .
May 2021 .