

**NOTES**  
 This drawing is considered to be approved by HGN Design immediately. This drawing and design is the copyright of HGN Design Limited and must not be used for any purpose without their consent. Challenging Planning and Building Regulation approvals does not remove a building owner's responsibilities under the Party Wall special provisions where your proposals might require Party Wall Act notices or require a Rights of Light Agreement.

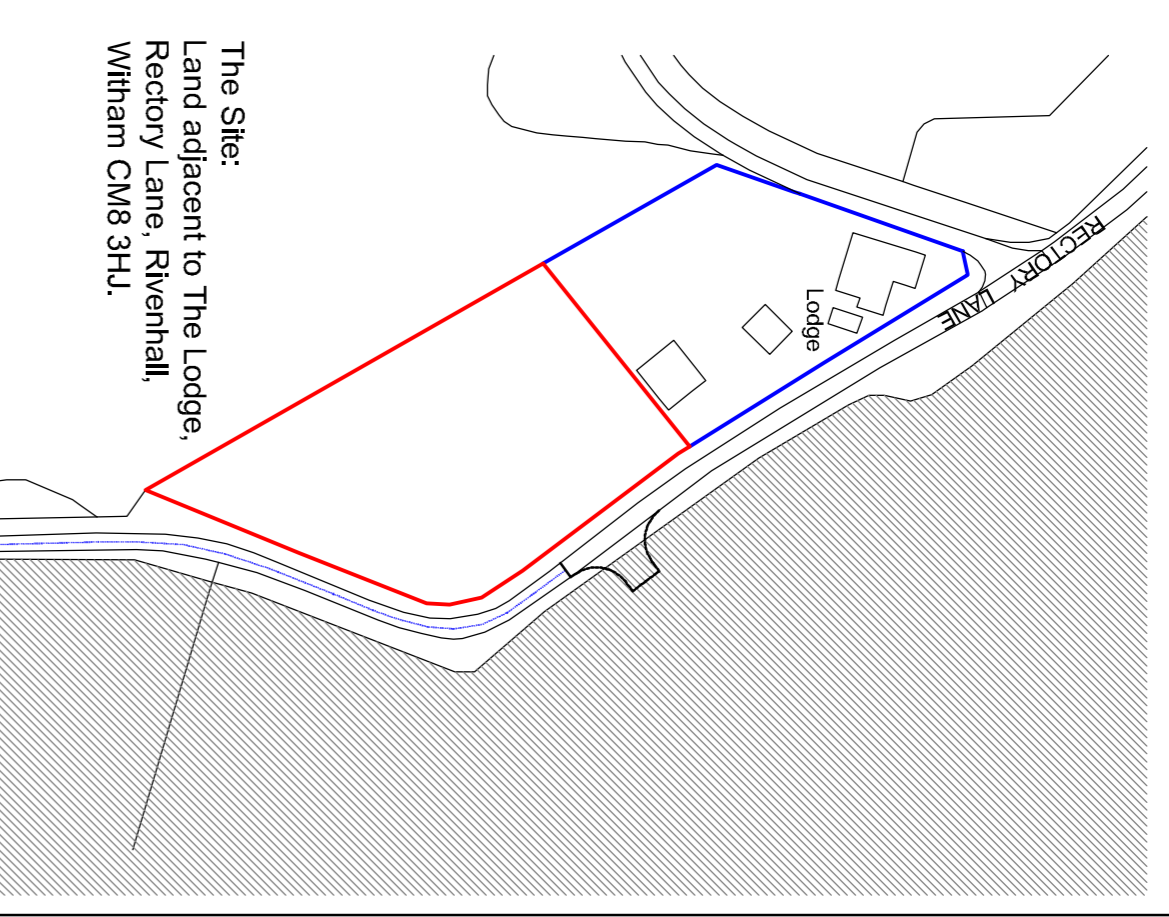

The Site:  
 Land adjacent to The Lodge,  
 Rectory Lane, Rivenhall,  
 Witham CM8 3HU.

**Location Plan 1:1250**

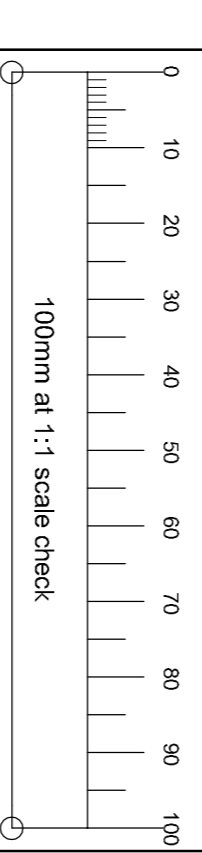
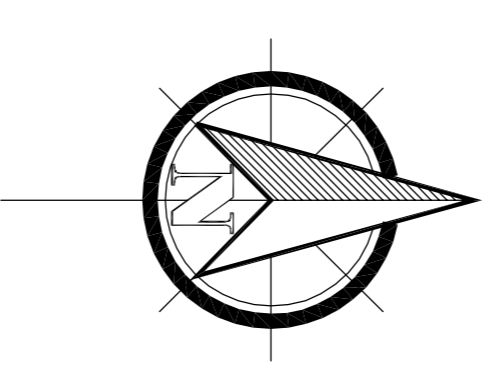

Rev.	date	drawn	approved

**HGN design limited**  
 architectural design  
 T e l : 0 1 2 0 6 6 2 5 5 2 6  
 E m a i l : i n f o @ h g n - d e s i g n . c o m  
 w e b : w w w . h g n - d e s i g n . c o m

Client  
**HW DEVELOPMENTS LTD.**  
 Project  
**PROPOSED RESIDENTIAL DEVELOPMENT  
 ON LAND ADJACENT TO THE LODGE,  
 RECTORY LANE, RIVENHALL, WITHAM  
 CM8 3HU**  
 Subject  
**EXISTING SITE PLAN**

Scale	Sheet Size	Drawn
1:200; 1:1250	A1	SJH
	Approved	Date
		NOV 19

Project Ref.	Drawing No.	Revision
	<b>9 1 8 0 . 0 0 1</b>	

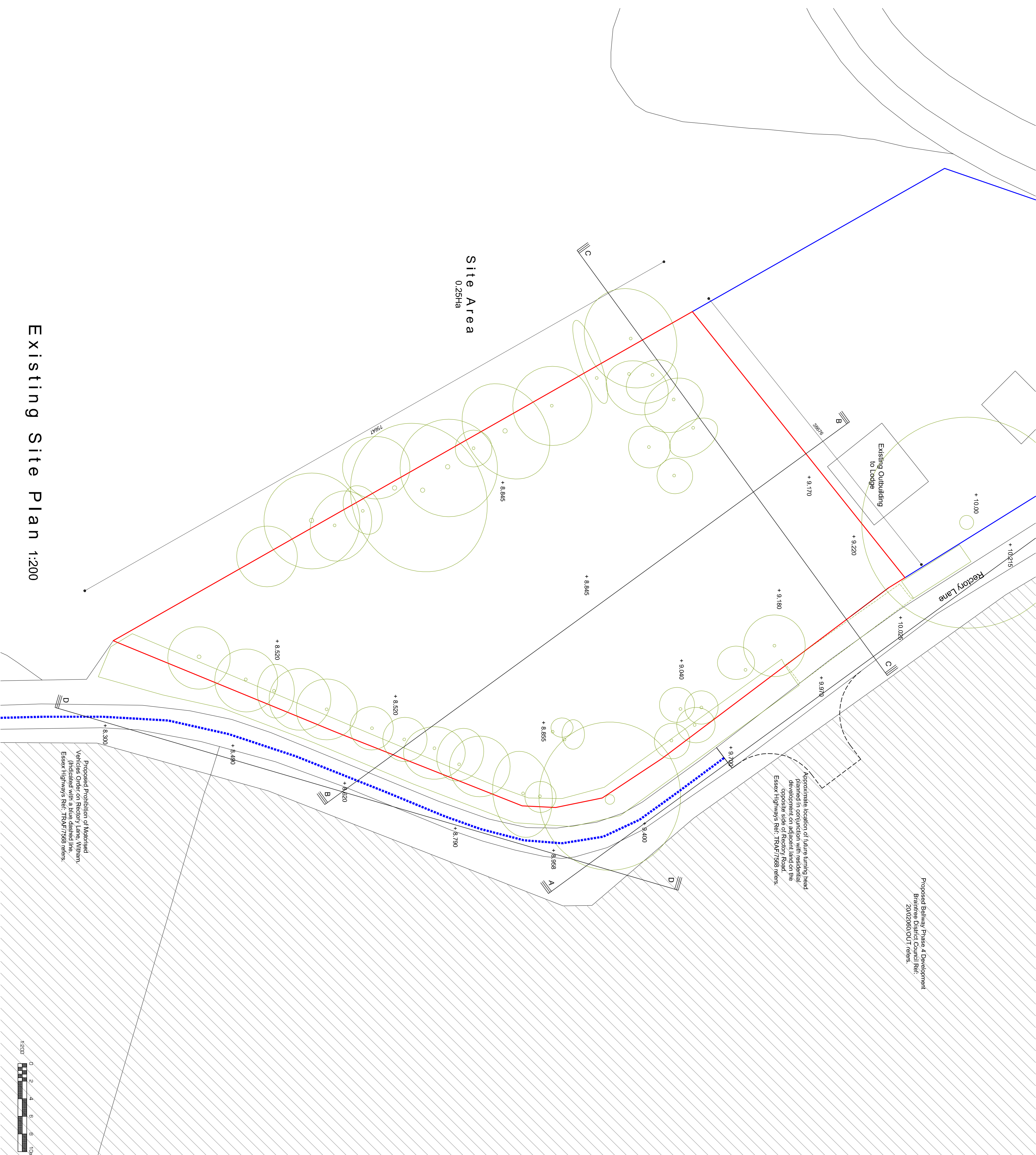

**Existing Site Plan 1:200**