

① EXISTING GROUND PLAN

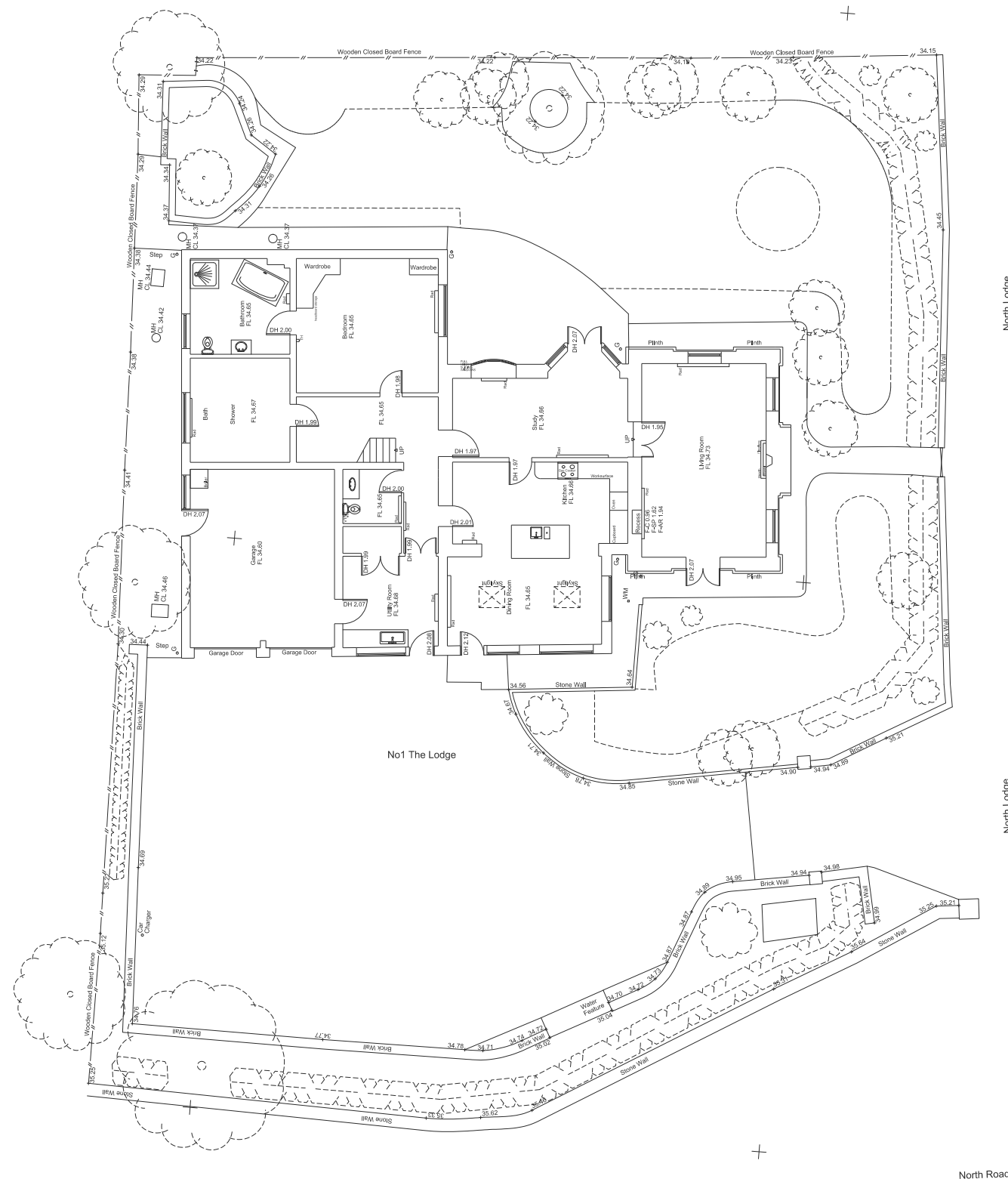

DATE	PURPOSE	REVISION	NOTES
28.05.21	ISSUED FOR CLIENT COMMENT	A	Corrections are not to be made outside of the building footprint.
09.07.21	ISSUED FOR CLIENT COMMENT	B	Dimensions should be verified from the Engineer or Architect. All structural and any dimensions to them should be verified.
	ISSUED FOR PLANNING CONSENT		The design and these drawings are the sole copyright of Draper Studio Ltd. Unless otherwise stated all items to be in situ. Proposed all Round, Reproduction, Comment, Planning, Interior, Construction.

PROJECT:
1 North Lodge

DRAWING TITLE:
EXISTING GROUND PLAN

REVISION	DATE	SCALE
A	JUL 21	@ A3 1:200
Draw No: 21020_50	P OF #	DIB: AD
		CR: AD

Draper Studio