

© Crown Copyright. All Rights Reserved. License Number 100022432



Combined Surface Geology

The Combined Surface Geology map combines all the previous maps into one combined geological overview of your site.

Please consult the legends to the previous maps to interpret the Combined "Surface Geology" map.

Additional Information

More information on 1:50,000 Geological mapping and explanations of rock classifications can be found on the BGS website. Using the LEX Codes in this report, further descriptions of rock types can be obtained by interrogating the 'BGS Lexicon of Named Rock Units'. This database can be accessed by following the 'Information and Data' link on the BGS website.

Contact

British Geological Survey
 Kingsley Dunham Centre
 Keyworth
 Nottingham
 NG12 5GG
 Telephone: 0115 936 3143
 Fax: 0115 936 3276
 email: enquires@bgs.ac.uk
 website: www.bgs.ac.uk

Combined Geology Map - Slice A

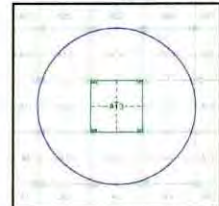

Order Details:

Order Number: 215248176_1_1
 Customer Reference: J19229
 National Grid Reference: 527010, 183500
 Slice: A
 Site Area (Ha): 0.1
 Search Buffer (m): 1000

Site Details:

17, Acacia Road, LONDON, NW8 6AN



Tel: 0844 844 9952
 Fax: 0844 844 9951
 Web: www.landmark.co.uk

v15.0 20-Aug-2019

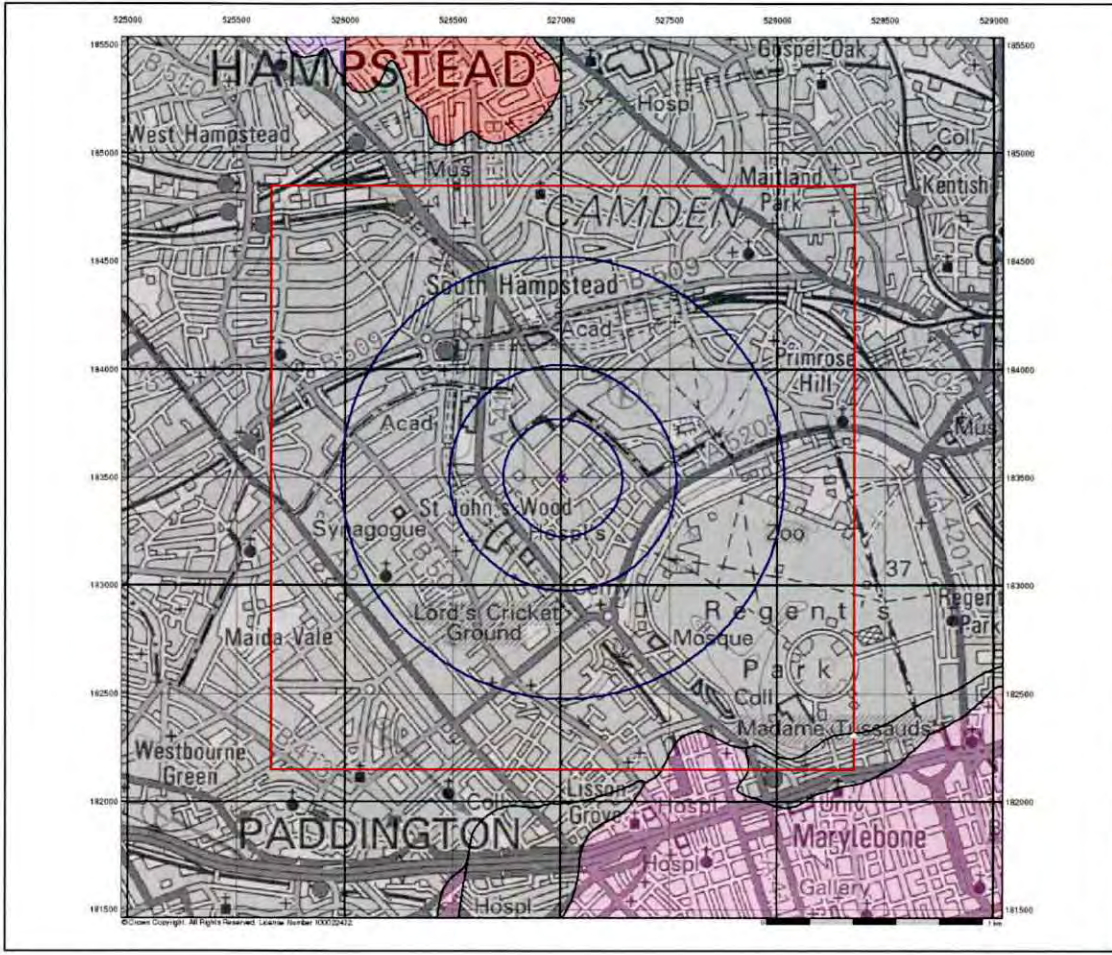

Groundwater Vulnerability

General

- Specified Site
- Specified Buffer(s)
- Slice
- Map ID
- X Bearing Reference Point

Agency and Hydrological

Bedrock Aquifers	Superficial Aquifers
 High Vulnerability, Principal Aquifer	 High Vulnerability, Principal Aquifer
 High Vulnerability, Secondary Aquifer	 High Vulnerability, Secondary Aquifer
 Medium Vulnerability, Principal Aquifer	 Medium Vulnerability, Principal Aquifer
 Medium Vulnerability, Secondary Aquifer	 Medium Vulnerability, Secondary Aquifer
 Low Vulnerability, Principal Aquifer	 Low Vulnerability, Principal Aquifer
 Low Vulnerability, Secondary Aquifer	 Low Vulnerability, Secondary Aquifer

Unproductive Aquifer
 Soluble Rock

Site Sensitivity Context Map - Slice A

Order Details

Order Number	215248178_1_1
Customer Ref	J16229
National Grid Reference	527910, 183500
Slice	A
Site Area (Ha)	0.1
Search Buffer (m)	1000

Site Details
 17, Acacia Road, LONDON, NW6 6AN

Landmark Tel: 0844 844 992
 Fax: 0844 344 991
 Web: www.landmark.co.uk

A Landmark Information Group Service v15.0 20-Aug-2019 Page 1 of 6

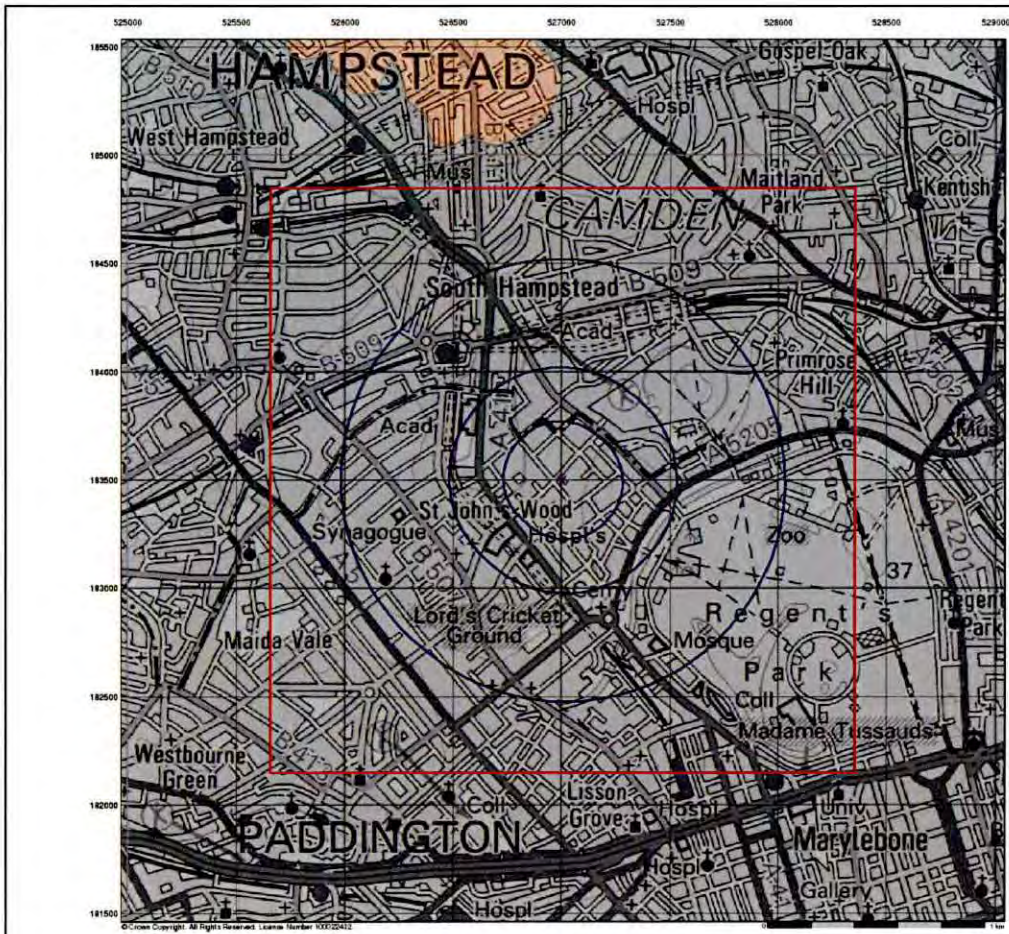

Bedrock Aquifer Designation

General

- Specified Site
- Specified Buffer(s)
- Bearing Reference Point
- Slice
- Map ID

Agency and Hydrological

Geological Classes

- Principal Aquifer
- Secondary A Aquifer
- Secondary B Aquifer
- Secondary Undifferentiated
- Unproductive Strata
- Unknown
- Unknown (Lakes and Landslip)

Site Sensitivity Context Map - Slice A

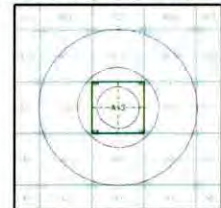

Order Details

Order Number: 215248178_1_1
 Customer Ref: J19229
 National Grid Reference: 527010, 183500
 Slice: A
 Site Area (Ha): 0.1
 Search Buffer (m): 1000

Site Details

17, Acacia Road, LONDON, NW8 6AN



Tel: 0844 344 9952
 Fax: 0844 344 9951
 Web: www.landmark.co.uk

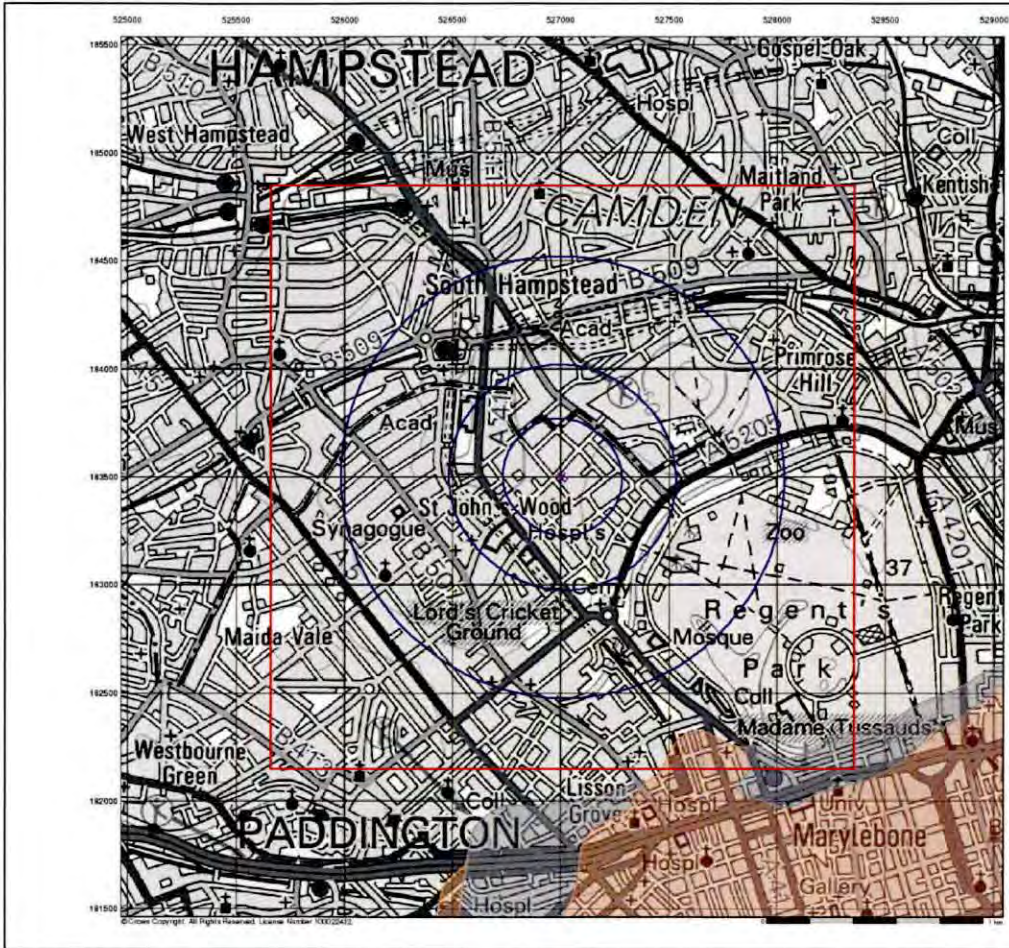

Superficial Aquifer Designation

General

- Specified Site
- Specified Buffer(s)
- Slice
- Map ID
- X Bearing Reference Point

Agency and Hydrological

Geological Classes

- Principal Aquifer
- Secondary A Aquifer
- Secondary B Aquifer
- Secondary Undifferentiated
- Unproductive Strata
- Unknown
- Unknown (Lakes and Landfill)

Site Sensitivity Context Map - Slice A

Order Details

Order Number:	215248178_1_1
Customer Ref:	J19229
National Grid Reference:	527010, 183500
Slice:	A
Site Area (Ha):	0.1
Search Buffer (m):	1000

Site Details

17, Acacia Road, LONDON, NW6 6AN

Landmark INFORMATION GROUP

Tel: 0844 344 9922
Fax: 0844 344 9921
Web: www.landmark.co.uk

A Landmark Information Group Service v15.0 20-Aug-2019 Page 3 of 8

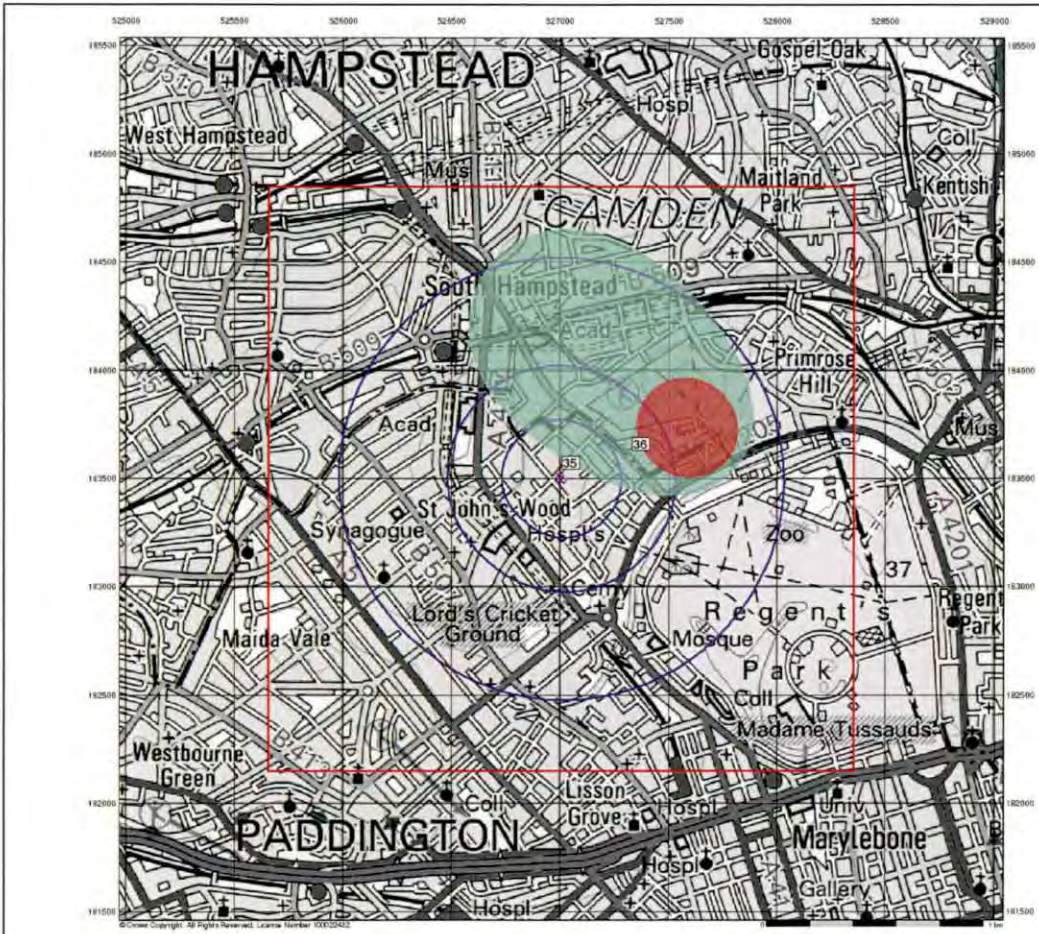

Source Protection Zones

- General**
- Specified Site
 - Specified Buffers
 - ✕ Bearing Reference Point
 - Slice
 - Mas IC
- Agency and Hydrological**
- Inner zone (Zone 1)
 - Inner zone - subsurface activity only (Zone 1c)
 - Outer zone (Zone 2)
 - Outer zone - subsurface activity only (Zone 2c)
 - Total catchment (Zone 3)
 - Total catchment - subsurface activity only (Zone 3c)
 - Special Interest (Zone 4)

Site Sensitivity Context Map - Slice A

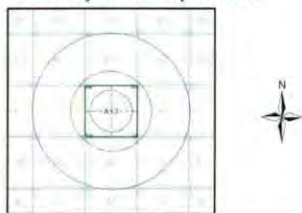

Order Details
 Order Number: 215248178_1_1
 Customer Ref: J19229
 National Grid Reference: 527010, 183500
 Slice: A
 Site Area (Ha): 0.1
 Search Buffer (m): 1000

Site Details
 17, Acacia Road, LONDON, NW8 5AN

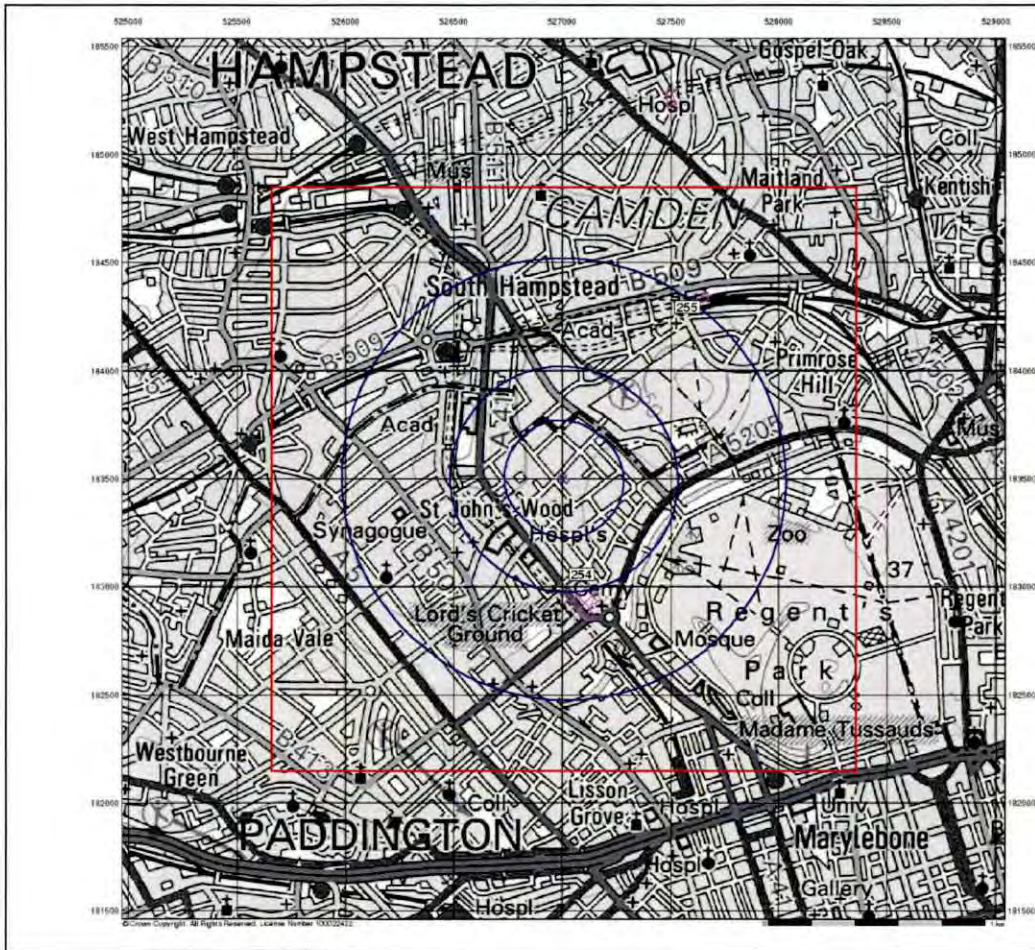

Sensitive Land Uses

- General**
- Specified Site
 - Specified Buffer(s)
 - Bearing Reference Point
 - Site
 - Map ID
- Sensitive Land Uses**
- Ancient Woodland
 - Area of Adopted Green Belt
 - Area of Unadopted Green Belt
 - Area of Outstanding Natural Beauty
 - Environmentally Sensitive Area
 - Forest Park
 - Local Nature Reserve
 - Marine Nature Reserve
 - National Nature Reserve
 - National Park
 - Nitrate Sensitive Area
 - Nitrate Vulnerable Zone
 - Ramsar Site
 - Site of Special Scientific Interest
 - Special Area of Conservation
 - Special Protection Area
 - World Heritage Sites

Site Sensitivity Context Map - Slice A



Order Details

Order Number: 215248178_1_1
 Customer Ref: J19229
 National Grid Reference: 527010, 183500
 Slice: A
 Site Area (Ha): 0.1
 Search Buffer (m): 1000

Site Details

17, Acacia Road, LONDON, NW8 5AN

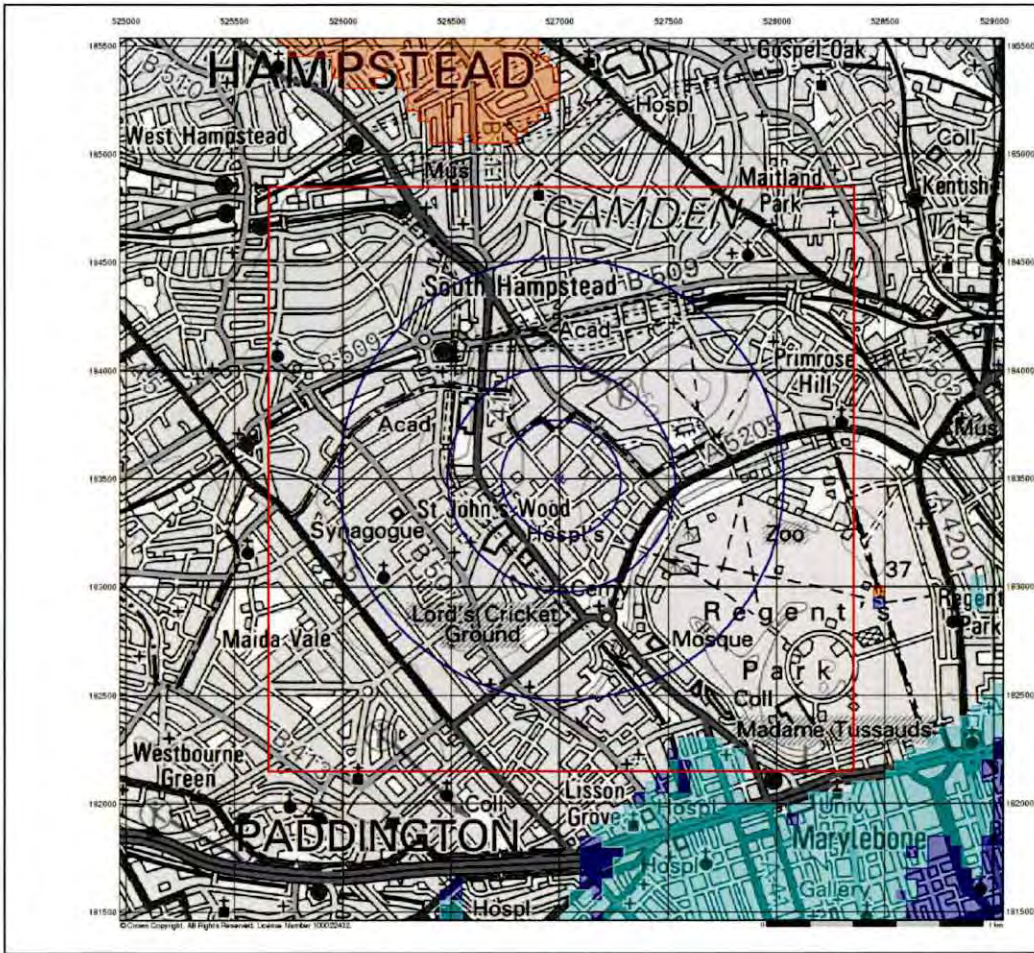

BGS Flood GFS Data

General

- Specified Site
- Specified Buffer(s)
- Bearing Reference Point
- Slice

Agency and Hydrological (Flood)

- Limited Potential for Groundwater Flooding to Occur
- Potential for Groundwater Flooding of Property Situated Below Ground Level
- Potential for Groundwater Flooding to Occur at Surface

Site Sensitivity Context Map - Slice A



Order Details

Order Number: 215248178_1_1
 Customer Ref: J19229
 National Grid Reference: 527010, 183500
 Slice: A
 Site Area (Ha): 0.1
 Search Buffer (m): 1000

Site Details

17, Acacia Road, LONDON, NW8 6AN



Tel: 0244 844 992
 Fax: 0244 844 993
 Web: www.landmark.co.uk

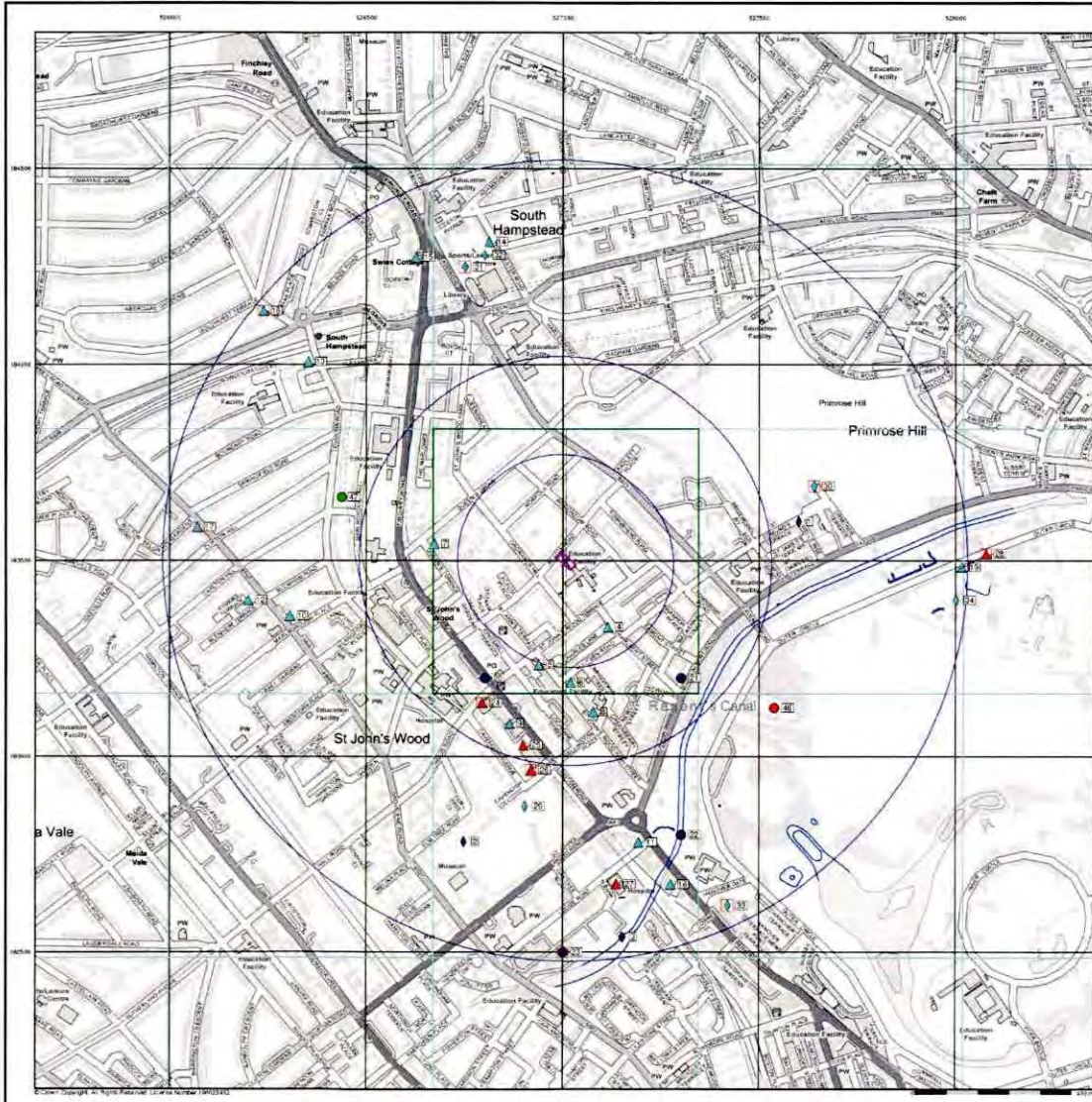

- General**
- Specified Site
 - Specified Buffer(s)
 - Beams Reference Point
 - Map ID
- Agency and Hydrological**
- Contaminated Land Register Entry or Notice (General)
 - Discharge Consent
 - Enforcement or Prohibition Notice
 - Integrated Pollution Control
 - Local Authority Integrated Pollution Prevention and Control
 - Local Authority Pollution Prevention and Control Enforcement
 - Pollution Incident to Controlled Waters
 - Prosecution Relating to Authorised Processes
 - Prosecution Relating to Controlled Waters
 - Registered Reactive Substance
 - River Quality Sampling Point
 - Substantiated Pollution Incident Register
 - Water Abstraction
 - Water Industry Act Release
- Waste**
- BGS Recorded Landfill Site (Location)
 - BGS Recorded Landfill Site
 - EA Historic Landfill (Burial Risk)
 - EA Historic Landfill (Proven)
 - Integrated Pollution Control Registered Waste Site
 - Licensed Waste Management Facility (General Business)
 - Licensed Waste Management Facility (Location)
 - Local Authority Recorded Landfill Site (Location)
 - Local Authority Recorded Landfill Site (Non-water)
 - Potentially Infilled Land (Non-water)
 - Potentially Infilled Land (Water)
 - Potentially Infilled Land (Water)
 - Potentially Infilled Land (Water)
 - Registered Landfill Site (Location)
 - Registered Landfill Site (Non-water > 10m)
 - Registered Landfill Site (Non-water > 25m)
 - Registered Waste Treatment Site (Location)
 - Registered Waste Treatment Site
 - Registered Waste Treatment or Disposal Site (Location)
 - Registered Waste Treatment or Disposal Site
- Hazardous Substances**
- TOXMAP Site
 - Exposure Site
 - HEMS Site
 - Planning Hazardous Substance Consent
 - Planning Hazardous Substance Enhancement
- Geological**
- BGS Recorded Mineral Site

Site Sensitivity Map - Slice A

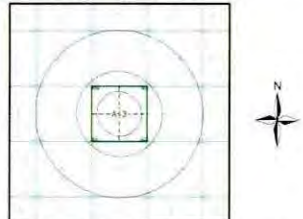

Order Details

Order Number: 215248178_1_1
 Customer Ref: J19229
 National Grid Reference: 527010, 183500
 Slice: A
 Site Area (Ha): 0.1
 Search Buffer (m): 1000

Site Details
 17, Acacia Road, LONDON, NW8 6AN

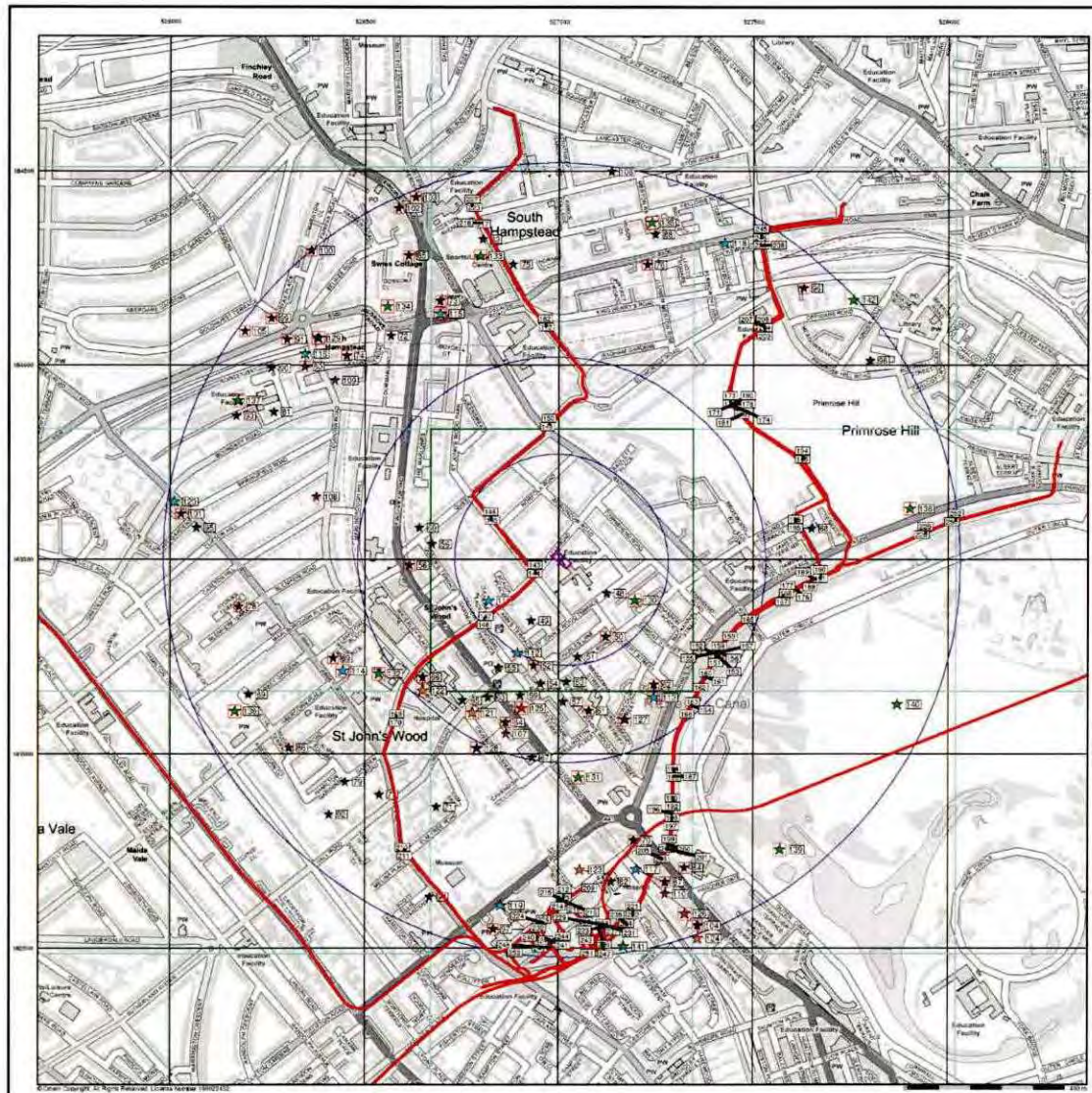

Industrial Land Use Map

- General**
- Specified Site
 - Buffer
 - Specified Buffer(s)
 - Map ID
 - ✕ Bearing Reference Point
- Industrial Land Use**
- ★ Companies Trade Directory Entry
 - ★ Fuel Station Entry
 - Gas Pipeline
 - ★ Points of Interest - Commercial Services
 - ★ Points of Interest - Education and Health
 - ★ Points of Interest - Manufacturing and Production
 - ★ Points of Interest - Public Infrastructure
 - ★ Points of Interest - Recreational and Environmental
 - Underground Electrical Cables

Industrial Land Use Map - Slice A

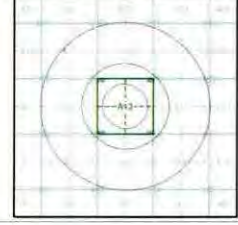

Order Details
 Order Number: 215248178_1_1
 Customer Ref: J19229
 National Gnd Reference: 527010, 183500
 Slice: A
 Site Area (Ha): 0.1
 Search Buffer (m): 1000

Site Details
 17, Acacia Road, LONDON, NW8 6AN

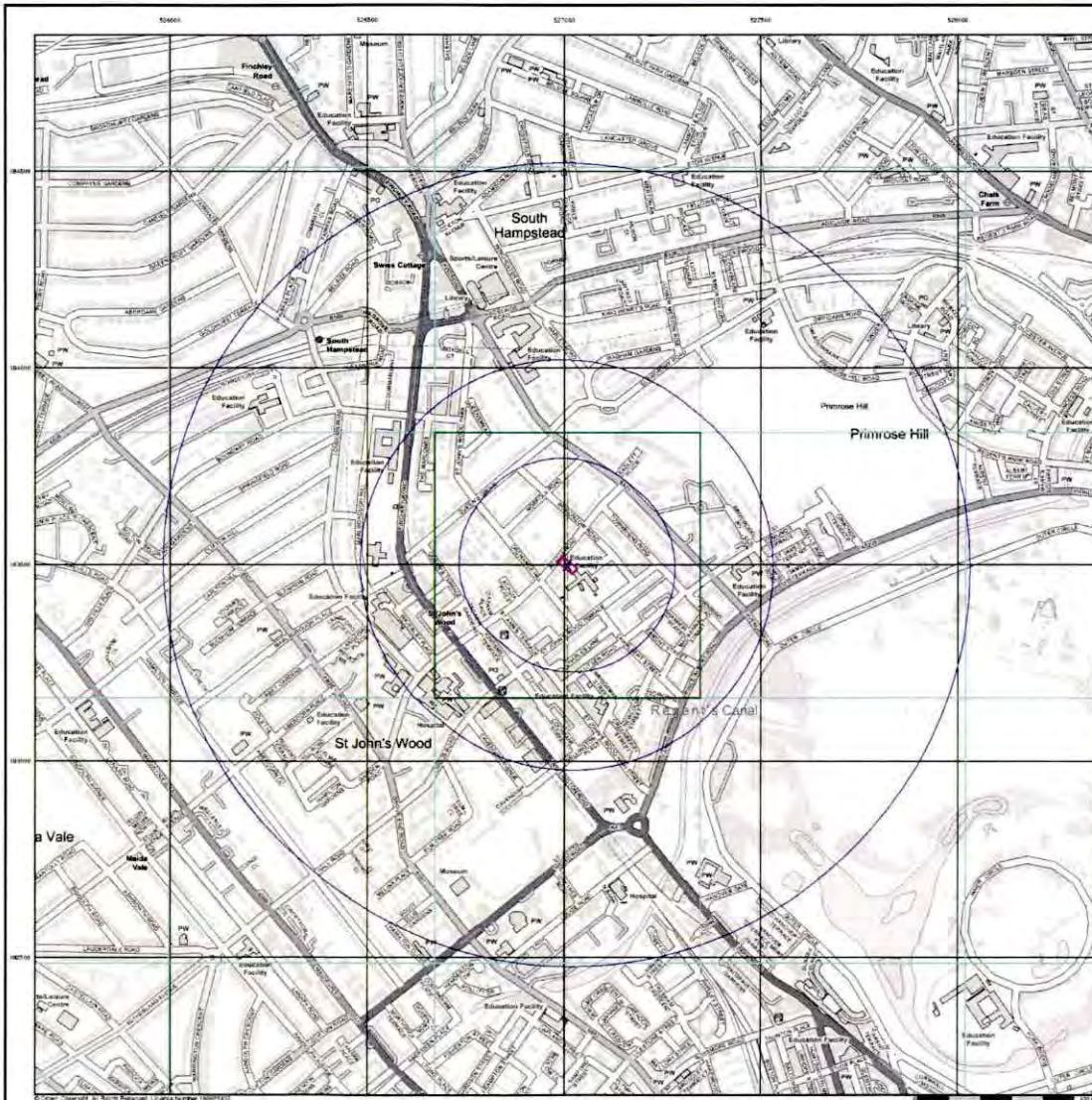

General

- Selected Site
- Selected Buffer(s)
- X Drawing Reference Point

Agency and Hydrological (Flood)

- Extreme Flooding from Rivers or Sea without Defences (Zone 2)
- Flooding from Rivers or Sea without Defences (Zone 3)
- Area Benefiting from Flood Defence
- Flood Water Storage Areas
- - - Flood Defence

Flood Map - Slice A

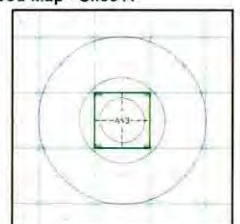

Order Details

Order Number: 215248178_1_1
 Customer Ref: J19229
 National Grid Reference: 527010, 183500
 Slice: A
 Site Area (Ha): 0.1
 Search Buffer (m): 1000

Site Details

17, Acacia Road, LONDON, NW8 6AN

Landmark INFORMATION GROUP
 TEL: 0844 844 9952
 FAX: 0844 844 9851
 WEB: www.landmark.co.uk

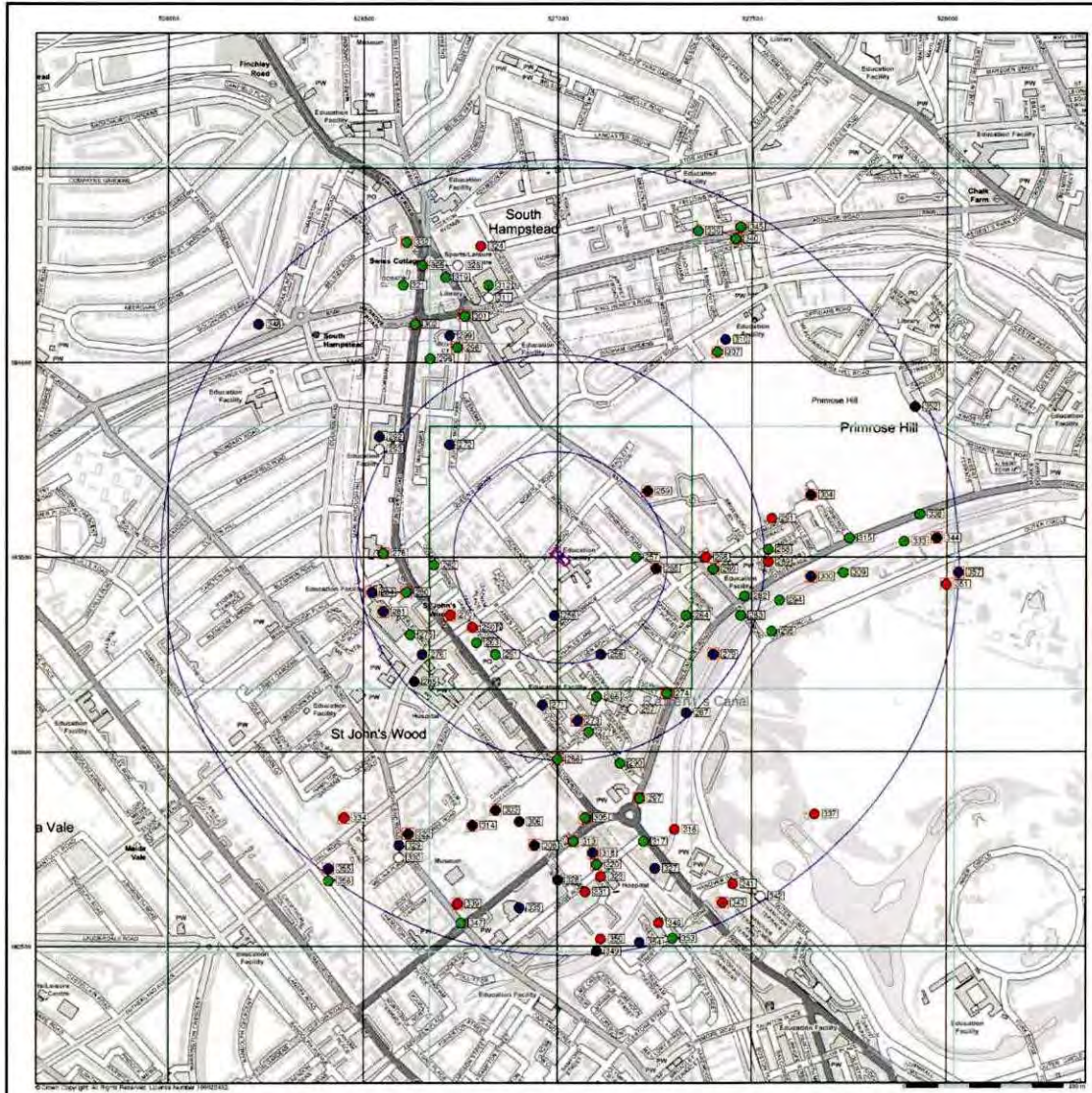

- General**
- Specified Site
 - Specified Buffer(s)
 - X Bearing Reference Point
 - Map ID
 - Several of Type at Location
- Agency and Hydrological (Boreholes)**
- BGS Borehole Depth 0 - 10m
 - BGS Borehole Depth 10 - 20m
 - BGS Borehole Depth 20m +
 - Confidential
 - Other

For Borehole information please refer to the Borehole .csv file which accompanied this slice

A copy of the BGS Borehole Ordering Form is available to download from the Support section of www.envirocheck.co.uk

Borehole Map - Slice A

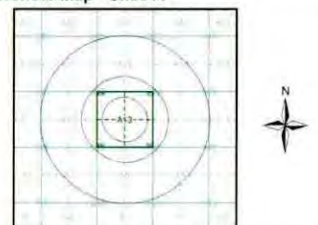

Order Details

Order Number: 215248178_1_1
 Customer Ref: J19229
 National Grid Reference: 527010, 183500
 Slice: A
 Site Area (Ha): 0.1
 Search Buffer (m): 1000

Site Details

17, Acacia Road, LONDON, NW8 6AN

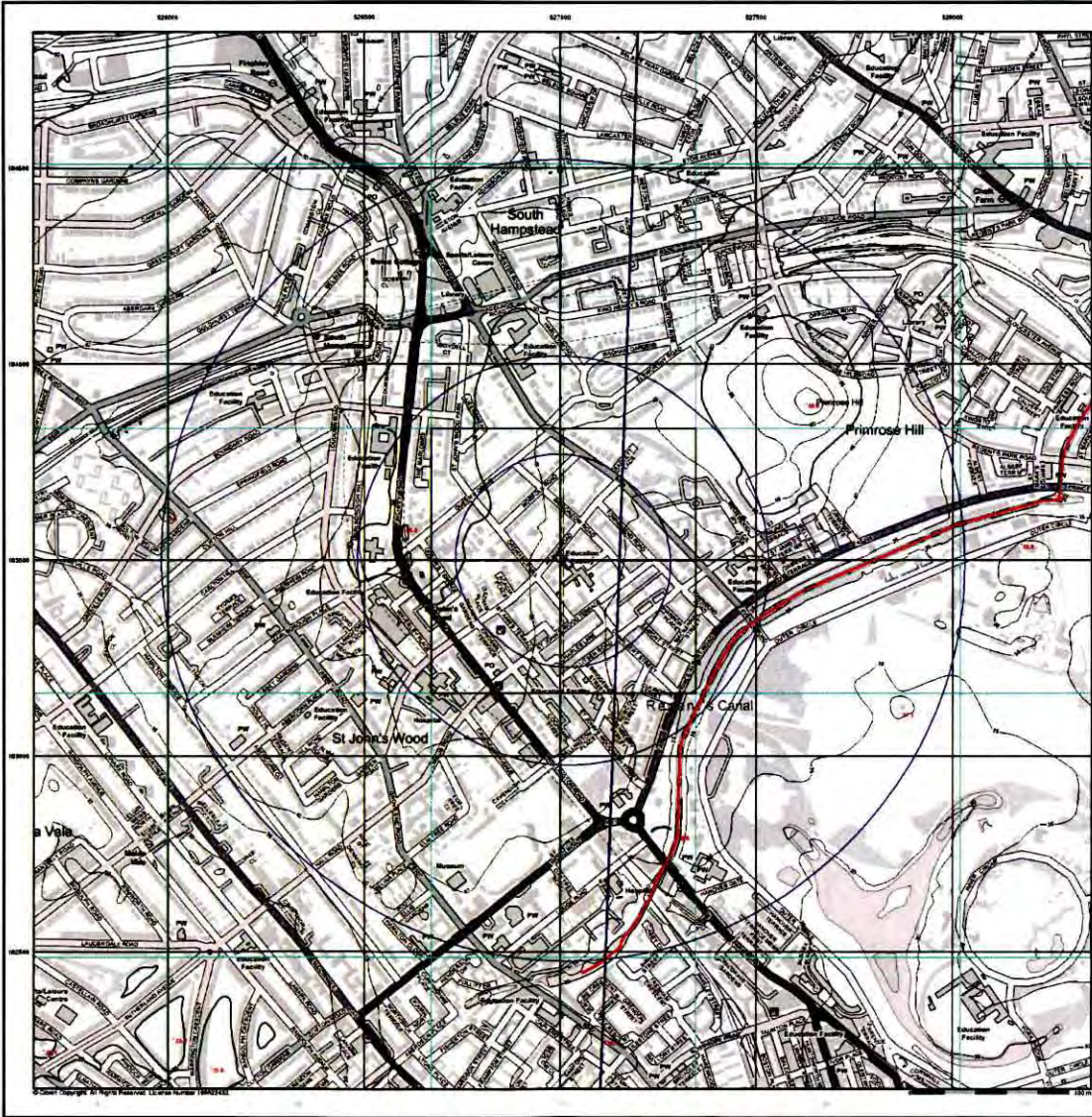

General
 ○ Specified Site
 ⊖ Specified Buffer(s)
 X Bearing Reference Point

OS Water Network Data

— Canal	— Drain
— Reservoir	— Other
— Foreshore	- - - Lake
— Marsh	- · - · Transfer
— Tidal River	- · - · Lock Or Flight Of Locks
— Inland River	- - - Sea

Contours (height in meters)

Standard Contour — 1:1000
 Master Contour — 1:500
 Spot Height — 1:100

— MLW — Mean Low Water
 — MHW — Mean High Water

OS Water Network Map - Slice A

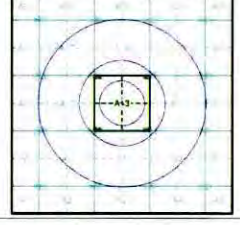

Order Details
 Order Number: 215248178_1_1
 Customer Ref: J19229
 National Grid Reference: 527010, 183500
 Slice: A
 Site Area (Ha): 0.1
 Search Buffer (m): 1000

Site Details
 17, Acacia Road, LONDON, NW8 6AN

Landmark INFORMATION GROUP
 Tel: 0844 944 9952
 Fax: 0844 944 9951
 Web: www.landmark.co.uk

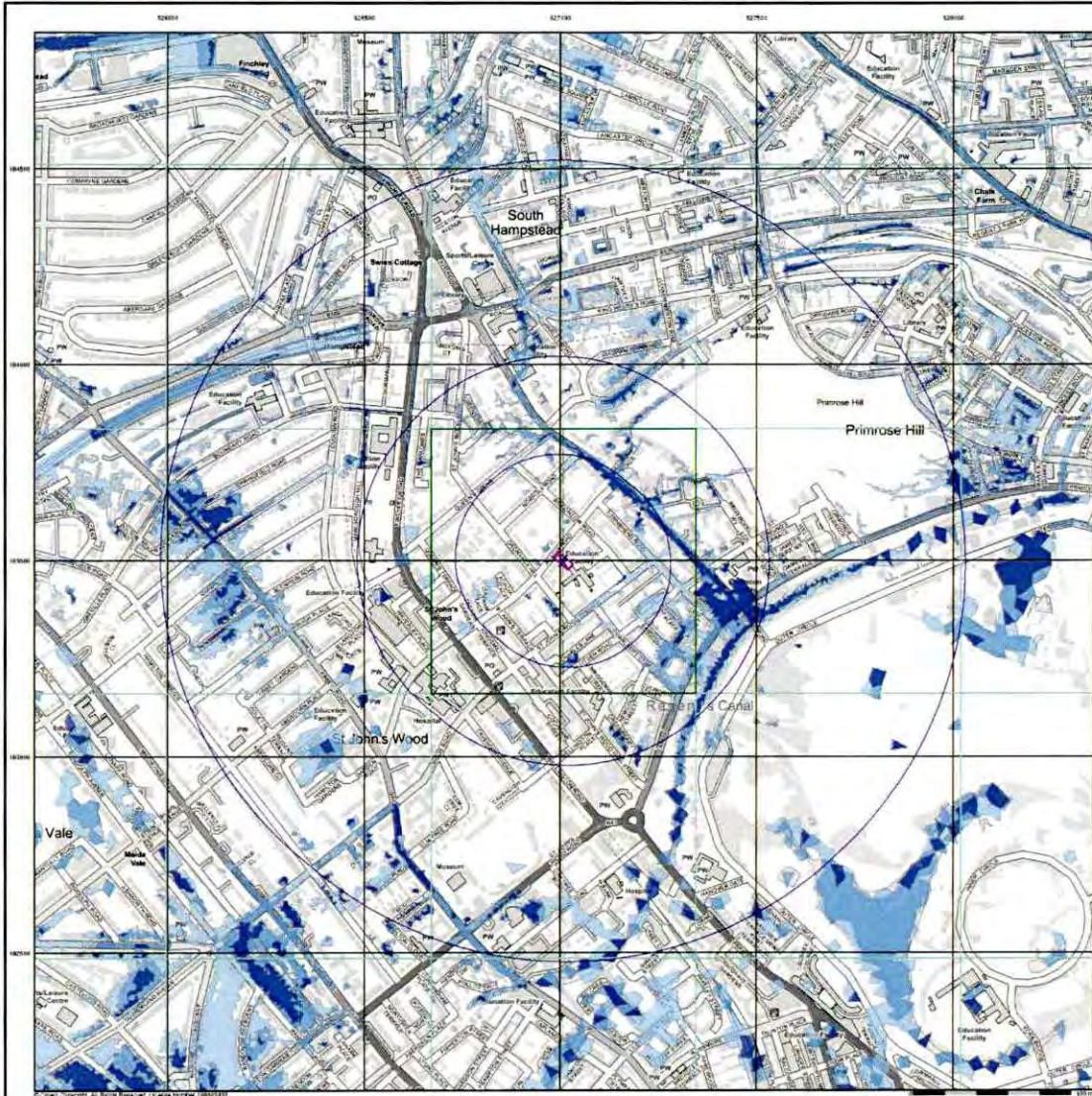

- General**
- Specified Site
 - Specified Buffer(s)
 - X Bearing Reference Point

- Risk of Flooding from Surface Water**
- High - 30 Year Return
 - Medium - 100 Year Return
 - Low - 1000 Year Return

- Suitability**
- See the suitability map below
- Neighbour to county
 - County to town
 - Town to street
 - Street to parcels of land
 - Property

EA/NRW Suitability Map - Slice A



Order Details

Order Number: 215248178_1_1
 Customer Ref: J19229
 National Grid Reference: 527010, 183500
 Slice: A
 Site Area (Ha): 0.1
 Search Buffer (m): 1000

Site Details
 17, Acacia Road, LONDON, NW8 6AN

Landmark INFORMATION GROUP
 Tel: 0844 844 9952
 Fax: 0844 844 9951
 Web: www.landmark.co.uk

Historical Mapping Legends

Ordnance Survey County Series and Ordnance Survey Plan 1:2,500

Ordnance Survey Plan, Additional SIMs and Supply of Unpublished Survey Information 1:2,500 and 1:1,250

Large-Scale National Grid Data 1:2,500 and 1:1,250



Historical Mapping & Photography included:

Mapping Type	Scale	Date	Pg
London	1:2,500	1871 - 1880	2
London	1:2,500	1896	3
London	1:2,500	1915	4
London	1:2,500	1935 - 1936	5
Historical Aerial Photography	1:1,250	1946	6
Ordnance Survey Plan	1:2,500	1954 - 1954	7
Ordnance Survey Plan	1:2,500	1954 - 1955	8
Additional SIMs	1:2,500	1954	9
Ordnance Survey Plan	1:1,250	1960 - 1962	10
Additional SIMs	1:1,250	1960 - 1978	11
Ordnance Survey Plan	1:1,250	1969 - 1973	12
Supply of Unpublished Survey Information	1:1,250	1974	13
Additional SIMs	1:1,250	1985	14
Large-Scale National Grid Data	1:1,250	1991	15
Large-Scale National Grid Data	1:1,250	1992	16
Large-Scale National Grid Data	1:1,250	1996	17
Historical Aerial Photography	1:2,500	1999	18

Historical Map - Segment A13

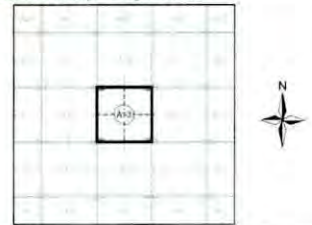

Order Details
 Order Number: 215248178_1_1
 Customer Ref: J19229
 National Grid Reference: 527010, 183500
 Slice: A
 Site Area (Ha): 0.1
 Search Buffer (m): 100

Site Details
 17, Acacia Road, LONDON, NW6 6AN

Landmark Information Group
 Tel: 0844 944 9832
 Fax: 0844 944 9901
 Web: www.landmark.co.uk